



SURVEYOR/ENGINEER: 1-304-933-3463
2361 DAVISSON RUN ROAD, SUITE 103
CLARKSBURG, WV 26301

SURFACE HOLE LOCATION (SHL):

GEOGRAPHIC (NAD83):
LATITUDE: 39.0410920°
LONGITUDE: -80.9336483°
UTM (NAD83, ZONE 17, FEET):
NORTHING: 14,177,592.107
EASTING: 1,659,255.820
UTM (NAD83, ZONE 17, METERS):
NORTHING: 4,321,338.721
EASTING: 505,742.185

LATITUDE 39° 02' 30"

SURFACE HOLE 4824'

LONGITUDE RD' 55' 00" SURFACE HOLE 210'

11-02-0002-0005-0000
NEW MOUNT OLIVE
UNITED CHURCH-TRUSTEES
DB 447, PG 443

11-02-0002-0003-0000
SARAH E. REED
DB 277, PG 672

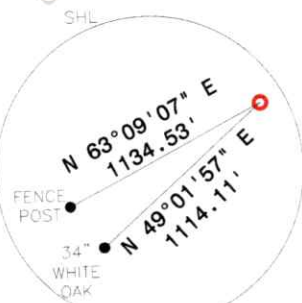

REFERENCES NTS



WELL RESTRICTIONS

1. THERE ARE DWELLINGS > 2500 SQ FT. WITHIN 625 FEET OF CENTER OF PAD.
2. THERE ARE AGRICULTURE BUILDINGS > 2500 SQ FT. WITHIN 625 FEET OF CENTER OF PAD.
3. THERE ARE WATER WELLS OR DEVELOPED SPRINGS ARE WITHIN 250 FEET OF PROPOSED WELL.
4. NO PERENNIAL STREAMS, LAKES, PONDS, OR RESERVOIRS WITHIN 100 FEET OF THE LIMITS OF DISTURBANCE.
5. NO NATURALLY PRODUCING TROUT STREAM WITHIN 300 FEET OF LIMITS OF DISTURBANCE.
6. NO GROUND INTAKE OR PUBLIC WATER SUPPLY WITHIN 1000 FEET OF WELL PAD, LIMITS OF DISTURBANCE, E & S CONTROLS OR PUBLIC WATER SUPPLY.

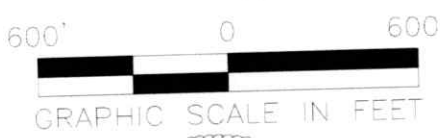

NOTES ON SURVEY

1. TIES TO WELLS AND CORNERS ARE BASED ON STATE PLANE WV NORTH ZONE NAD '83.
2. WELL LAT /LONG ESTABLISHED BY DIRECT GPS NAD '83.
3. BOUNDARIES SHOWN ARE TAKEN FROM TAX MAPS, DEEDS, AND FIELD SURVEY. THIS DRAWING IS NOT REPRESENTATIVE OF A FULL BOUNDARY SURVEY.
4. SURFACE OWNER INFORMATION TAKEN FROM THE ASSESSOR AND COUNTY CLERK RECORDS OF HARRISON COUNTY IN OCTOBER OF 2021.
5. WELLS SHOWN ARE TAKEN FROM RECORDS OF WVDEP.

I, THE UNDERSIGNED, HEREBY CERTIFY THAT THIS PLAT IS CORRECT TO THE BEST OF MY KNOWLEDGE AND BELIEF AND SHOWS ALL THE INFORMATION REQUIRED BY LAW AND REGULATIONS ISSUED AND PRESCRIBED BY THE DEPARTMENT OF ENVIRONMENTAL PROTECTION.



EXISTING WELLS WITHIN 3000' SCALE: 1"=3000'

Eastern Gas Transmission and Storage, Inc.

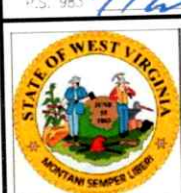

(+) DENOTES LOCATION OF WELL ON UNITED STATES TOPOGRAPHIC MAPS

MINIMUM DEGREE OF ACCURACY: 1/200
PROVEN SOURCE OF ELEVATION: SURVEY GRADE GPS (NAVD 88, US FT)

OPERATOR'S WELL #: **10505**
API WELL #: **47** **021** **03109w**
STATE COUNTY PERMIT

WELL TYPE: OIL WASTE DISPOSAL PRODUCTION DEEP GAS LIQUID INJECTION STORAGE SHALLOW

WATERSHED: LITTLE KANAWHA COUNTY: GILMER ELEVATION: 993.44'

DISTRICT: DEKALB QUADRANGLE: BURNT HOUSE

SURFACE OWNER: LLOYD SHANE GRAGG ACREAGE: 76.33 ±

OIL & GAS ROYALTY OWNER: LLOYD SHANE, RODGER D., CHARLES W. GRAGG, VELMA JEAN, ARRAH W. RUSS, & ED BROOME, INC. ACREAGE: 76.33 ±

DRILL DRILL DEEPER REDRILL FRACTURE OR STIMULATE PLUG OFF OLD FORMATION PERFORATE NEW FORMATION

CONVERT PLUG & ABANDON CLEAN OUT & REPLUG OTHER CHANGE (SPECIFY) RECASE ESTIMATED DEPTH: 2364 TVD

TARGET FORMATION: BERA

WELL OPERATOR: Eastern Gas Transmission and Storage, Inc. DESIGNATED AGENT: Jann M. Love
ADDRESS: 925 White Oaks Blvd. ADDRESS: 925 White Oaks Blvd.
CITY: Bridgeport STATE: WV ZIP CODE: 26330 CITY: Bridgeport STATE: WV ZIP CODE: 26330

LEGEND:	PROPOSED SURFACE HOLE / BOTTOM HOLE	SURVEYED BOUNDARY	REVISIONS:	DATE: 05/24/2022
	EXISTING / PRODUCING WELLHEAD	DRILLING UNIT		FILE NO:
LPL* LANDING POINT LOCATION	LEASE BOUNDARY	PROPOSED PATH		DRAWN BY: TMF
EXISTING WATER WELL				SCALE: 1" = 600'
EXISTING SPRING				DRAWING NO: 2889
				WELL LOCATION PLAT

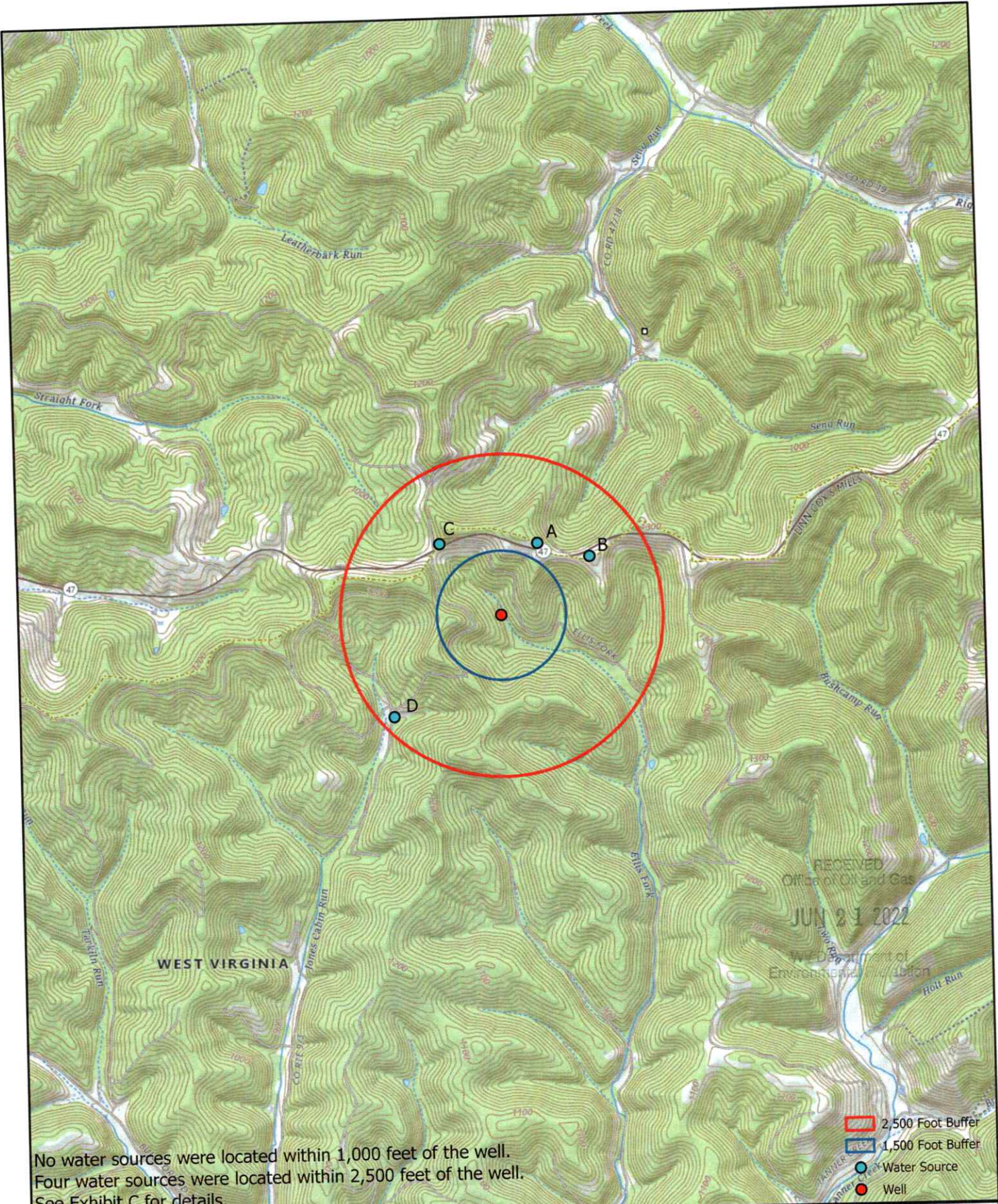

No water sources were located within 1,000 feet of the well.
 Four water sources were located within 2,500 feet of the well.
 See Exhibit C for details.

- 2,500 Foot Buffer
- 1,500 Foot Buffer
- Water Source
- Well



EXHIBIT B
 BHE REWORK - WELL 10505
 WATER PURVEYOR MAP
 GILMER COUNTY, WV

DATE: 5/25/2022	DRAWN BY: MWV
PROJECT #: 2889	APPROVED BY: AW
2361 DAVISSON RUN ROAD CLARKSBURG, WV 26301 WWW.ASCENTCONSULTINGENGINEERS.COM	

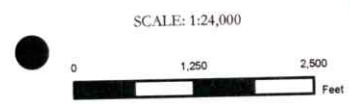

RECEIVED
 Office of Oil and Gas
 JUN 21 2022
 WV Department of
 Environmental Protection