



STATE OF WEST VIRGINIA  
DEPARTMENT OF MINES

RECEIVED  
JUL 15 1977  
OIL & GAS DIVISION  
DEPT. OF MINES

Oil and Gas Division

OIL AND GAS WELL PERMIT APPLICATION

TO THE DEPARTMENT OF MINES,  
Charleston, W. Va.

DATE July 14, 1977

Surface Owner S.C. Bennett Heirs Company Pacific States Gas & Oil

Address C/o Bessie Hall/851 King St. Akron, Ohio Address P.O. Box 67, Glenville, W.Va.

Mineral Owner Jacob Moore etal Farm Jacob Moore Acres 50

Address Gilmer Co.; W.Va. Location (waters) Lynch Run

Coal Owner S.C. Bennett Heirs Well No. P.S. 1 Elevation 1106

Address Same District Glenville County Gilmer

Coal Operator None Quadrangle Glenville

Address \_\_\_\_\_

**THIS PERMIT MUST BE POSTED AT THE WELL SITE**

All provisions being in accordance with Chapter 22, of the W. Va. Code, the location is hereby approved for drilling. This permit shall expire if operations have not commenced by 11-19-77.

INSPECTOR TO BE NOTIFIED Paul Good night

ADDRESS Smithville, W.Va.

PHONE 477-3660

[Signature]  
Deputy Director - Oil & Gas Division

GENTLEMEN:

The undersigned well operator is entitled to drill upon the above named farm or tract of land for oil and gas, having fee title thereto, (or as the case may be) under grant or lease dated April. 24 1935 by Jacob Moore made to \_\_\_\_\_ and recorded on the 10 day of Aug. 1936, in Gilmer County, Book 131 Page 87

NEW WELL  DRILL DEEPER  REDRILL  FRACTURE OR STIMULATE  
 OIL AND GAS WELL ORIGINALLY DRILLED BEFORE JUNE 5, 1969.

The enclosed plat was prepared by a registered engineer or licensed land surveyor and all coal owners and/or operators have been notified as of the above date.

The above named coal owners and/or operator are hereby notified that any objection they wish to make, or are required to make by Section 3 of the Code, must be received by, or filed with the Department of Mines within ten (10) days. \*

Copies of this notice and the enclosed plat were mailed by registered mail, or delivered to the above named coal operators or coal owners at their above shown respective address \_\_\_\_\_ day \_\_\_\_\_ before, or on the same day with the mailing or delivery of this copy to the Department of Mines at Charleston, West Virginia.

PLEASE SUBMIT COPIES OF ALL GEOPHYSICAL LOGS DIRECTLY TO:

WEST VIRGINIA GEOLOGICAL AND ECONOMIC SURVEY  
P. O. BOX 879  
MORGANTOWN, WEST VIRGINIA 26505  
AC-304 - 292-6331

Very truly yours,  
(Sign Name) [Signature]  
Well Operator

Address of Well Operator P.O. Box 67  
Street Glenville, W.Va.  
City or Town West Virginia  
State

\*SECTION 3 . . . . If no objections are filed or found by the Department of mines, within said period of ten (10) days from the receipt of notice and plat by the department of mines, to said proposed location, the department shall forthwith issue to the well operator a permit reciting the filing of such plat, that no objections have been made by the coal operators or found thereto by the department and that the same is approved and the well operator authorized to proceed.

**BLANKET BOND**

GIL-2869 PERMIT NUMBER

47-021

"I have read and understand the reclamation requirements as set forth in Chapter 22, Article 4, Section 12-b and will carry out the specified requirements."

Signed by [Signature]



**THIS IS AN ESTIMATE ONLY  
ACTUAL INFORMATION WILL BE SUBMITTED ON OG-10 UPON COMPLETION**

PROPOSED WORK ORDER TO X DRILL \_\_\_\_\_ DEEPEN \_\_\_\_\_ FRACTURE-STIMULATE \_\_\_\_\_  
 DRILLING CONTRACTOR: (If Known) \_\_\_\_\_ RESPONSIBLE AGENT: \_\_\_\_\_  
 NAME S.W. Jack Drilling Inc. NAME J.M. Mork  
 ADDRESS Buckhannon, W.Va. ADDRESS P.O. Box 67, Glenville, W.Va.  
 TELEPHONE 472-2161 TELEPHONE 462-8118  
 ESTIMATED DEPTH OF COMPLETED WELL: 4800 ROTARY X CABLE TOOLS \_\_\_\_\_  
 PROPOSED GEOLOGICAL FORMATION: Benson  
 TYPE OF WELL: OIL \_\_\_\_\_ GAS X COMB. \_\_\_\_\_ STORAGE \_\_\_\_\_ DISPOSAL \_\_\_\_\_  
 RECYCLING \_\_\_\_\_ WATER FLOOD \_\_\_\_\_ OTHER \_\_\_\_\_

TENTATIVE CASING PROGRAM:

CASING AND TUBING SIZE	USED FOR DRILLING	LEFT IN WELL	CEMENT FILL UP OR SACKS - CUBIC FT.
20 - 16			
13 - 10			
9 - 5/8			
8 - 5/8	500	500	Surface
7			
5 1/2			
4 1/2	4800	4800	250 Sks.
3			Perf. Top
2			Perf. Bottom
Liners			Perf. Top
			Perf. Bottom

APPROXIMATE FRESH WATER DEPTHS 50 FEET \_\_\_\_\_ SALT WATER none FEET \_\_\_\_\_  
 APPROXIMATE COAL DEPTHS unknown \_\_\_\_\_  
 IS COAL BEING MINED IN THE AREA? No BY WHOM? \_\_\_\_\_

TO DRILL:

SUBMIT FIVE (5) COPIES OF OG - 1, \$100.00 PERMIT FEE, PERFORMANCE BOND AND PERMANENT COPY OF PLAT.

TO DRILL DEEPER OR REDRILL:

SUBMIT FIVE (5) COPIES OF OG - 1, SHOWING ORIGINAL PERMIT NUMBER AND PERFORMANCE BOND. ON WELLS DRILLED PRIOR TO 1929, A PERMANENT COPY OF THE PLAT AND THE ORIGINAL WELL RECORD MUST ALSO BE SUBMITTED.

TO FRACTURE - STIMULATE:

OIL AND/OR GAS WELL ORIGINALLY DRILLED BEFORE JUNE 5, 1929, FIVE (5) COPIES OG - 1, PERFORMANCE BOND, PERMANENT PLAT AND ORIGINAL WELL RECORD.

OIL AND/OR GAS WELL ORIGINALLY DRILLED ON AND/OR AFTER JUNE 5, 1929, FIVE COPIES OG - 1, SHOWING ORIGINAL PERMIT NUMBER, AND PERFORMANCE BOND.

Required forms must be filed within ninety (90) days of completion for bond release. Inspector to be notified twenty-four (24) hours in advance.

The following waiver must be completed by the coal operator if the permit is to be issued within ten days of receipt thereof.

WAIVER: I the undersigned, Agent for \_\_\_\_\_ Coal Company, Owner or Operator of the coal under this lease have examined and place on our mine maps this proposed well location.

We the \_\_\_\_\_ Coal Company have no objections to said well being drilled at this location, providing operator has complied with all rules and regulations in Articles 4, 5, and 7, Chapter 22 of the West Virginia Code. 02/16/2024

\_\_\_\_\_  
For Coal Company

\_\_\_\_\_  
Official Title





RECEIVED

JUN - 7 1978

OIL & GAS DIVISION  
DEPT. OF MINES

STATE OF WEST VIRGINIA  
DEPARTMENT OF MINES

Oil and Gas Division

WELL RECORD

Quadrangle Glennville

Permit No. GIL-2869

Rotary X Oil \_\_\_\_\_  
Cable \_\_\_\_\_ Gas X \_\_\_\_\_  
Recycling \_\_\_\_\_ Comb. \_\_\_\_\_  
Water Flood \_\_\_\_\_ Storage \_\_\_\_\_  
Disposal \_\_\_\_\_ (Kind) \_\_\_\_\_

Company <u>Pacific States Gas &amp; Oil, Inc.</u>	Casing and Tubing	Used in Drilling	Left in Well	Cement fill up Cu. ft. (Sks.)
Address <u>P.O. Box 67, Glennville, WV 26351</u>	Size			
Farm <u>Jacob Moore</u> Acres <u>50</u>	20-16			
Location (waters) <u>Lynch Run</u>	Cond.			
Well No. <u>P.S. #1</u> Elev. <u>1106</u>	13-10"			
District <u>Glennville</u> County <u>Gilmer</u>	9 5/8			
The surface of tract is owned in fee by _____	8 5/8	402	402	Surface
<u>S.C. Bennett Heirs</u>	7			
Address <u>Akron, Ohio</u>	5 1/2			
Mineral rights are owned by <u>Jacob Moore et al</u>	4 1/2	4810	4810	100 sks Class "A"
Address <u>Gilmer Co. W.Va.</u>	3			
Drilling Commenced <u>11-8-77</u>	2			
Drilling Completed <u>11-15-77</u>	Liners Used			
Initial open flow <u>N/A</u> cu. ft. <u>--</u> bbls.				
Final production <u>1,200</u> mcu. ft. per day <u>-</u> bbls.				
Well open <u>4</u> hrs. before test <u>1800</u> RP.				

Well treatment details:

Attach copy of cementing record.

PERF: w/ 10 - .41" Diameter Holes from 4688 - 4694

FRAC: w/ 453 BBl H<sub>2</sub>O; 15000 80/100 lbs. sand and 28000 lbs. 20/40 lbs. sand; 400 lbs. water gel agent; 500 gal. HCl.

Coal was encountered at N/A Feet \_\_\_\_\_ Inches \_\_\_\_\_  
Fresh water N/A Feet \_\_\_\_\_ Salt Water N/A Feet \_\_\_\_\_  
Producing Sand Benson Depth 4678'-4701'

Formation	Color	Hard or Soft	Top Feet	Bottom Feet	Oil, Gas or Water	* Remarks
Surface			0	181		
Shale			181	319		
Sand			319	420		
Sand and Shale			420	723		
Shale			723	906		
Sand and Shale			906	1294		
Shale			1294	1730		
Sand and Shale			1730	1860		
Big Lime			1860	1965	E Log Top	
Big Injun			1965	2039		
Shale			2039	2096		
Weir			2096	2204		
Shale			2204	2810		
5th Sand			2810	2828		
Shale			2828	4678		
Benson			4678	4700		
Shale			4700	4843		

02/16/2024

(over)

\* Indicates Electric Log tops in the remarks section.

Formation	Color	Hard or Soft	Top Feet	Bottom Feet	Oil, Gas or Water	* Remarks

02/16/2024

Date 6-2 1978

APPROVED John Mark  
Executive Vice President

By \_\_\_\_\_  
(Title)

General



STATE OF WEST VIRGINIA  
DEPARTMENT OF MINES  
OIL AND GAS WELLS DIVISION

RECEIVED

NOV 16 1977

INSPECTOR'S WELL REPORT DEPT. OF MINES

Permit No. 61-2869

Oil or Gas Well \_\_\_\_\_  
(KIND)

Company	CASING AND TUBING	USED IN DRILLING	LEFT IN WELL	PACKERS
<u>Pacific States Gas &amp; Oil Inc</u>	Size			
Address _____	16			Kind of Packer _____
Farm <u>Jacob Moore</u>	13			
Well No. <u>P.S. 1</u>	10			Size of _____
District <u>Glenville</u> County <u>Calaver</u>	8 1/4 <u>5 7/8</u>		<u>403</u>	
Drilling commenced <u>11-9-77</u>	6 3/4			Depth set _____
Drilling completed _____ Total depth _____	5 3/16			
Date shot _____ Depth of shot _____	3			Perf. top _____
Initial open flow _____ /10ths Water in _____ Inch	2			Perf. bottom _____
Open flow after tubing _____ /10ths Merc. in _____ Inch	Liners Used			Perf. top _____
Volume _____ Cu. Ft.				Perf. bottom _____
Rock pressure _____ lbs. _____ hrs.	CASING CEMENTED <u>8 7/8</u> SIZE <u>403</u> No. FT. _____ Date _____ <u>Open to Surface 125 SKS</u>			
Oil _____ bbls., 1st 24 hrs.	NAME OF SERVICE COMPANY <u>Halliburton</u>			
Fresh water _____ feet _____ feet	COAL WAS ENCOUNTERED AT _____ FEET _____ INCHES			
Salt water _____ feet _____ feet	_____ FEET _____ INCHES _____ FEET _____ INCHES			
	_____ FEET _____ INCHES _____ FEET _____ INCHES			

Drillers' Names Bifford  
Cont - S. W. JACK Inc Rotary Air

Remarks:  
SURFACE Csg Plug down - 11-15 am

11-10-77  
DATE

[Signature]  
DISTRICT WELL INSPECTOR

02/16/2024







RECEIVED  
DEPARTMENT OF ENERGY  
OIL AND GAS

State of West Virginia  
Department of Mines  
Oil and Gas Division  
Charleston 25305

APR 1 1986

FINAL INSPECTION REPORT  
INSPECTORS COMPLIANCE REPORT  
March 1, 1984

COMPANY Pacific States Gas & Oil  
P. O. Box 67  
Glenville, West Virginia 26351

PERMIT NO 021-2869 (7-19-77)  
FARM & WELL NO Jacob Moore #1  
DIST. & COUNTY Glenville/Gilmer

RULE	DESCRIPTION	IN COMPLIANCE	
		YES	NO
23.06	Notification Prior to Starting Work	_____	_____
25.04	Prepared before Drilling to Prevent Waste	_____	_____
25.03	High-Pressure Drilling	_____	_____
16.01	Required Permits at Wellsite	_____	_____
15.03	Adequate Fresh Water Casing	_____	_____
15.02	Adequate Coal Casing	_____	_____
15.01	Adequate Production Casing	_____	_____
15.04	Adequate Cement Strenght	_____	_____
15.05	Cement Type	_____	_____
23.02	Maintained Access Roads	_____	_____
25.01	Necessary Equipment to Prevent Waste	_____	_____
23.04	Reclaimed Drilling Pits	_____	_____
23.05	No Surface or Underground Pollution	_____	_____
23.07	Requirements for Production & Gathering Pipelines	_____	_____
16.01	Well Records on Site	_____	_____
16.02	Well Records Filed	_____	_____
7.05	Identification Markings	_____	_____

I HAVE INSPECTED THE ABOVE CAPTIONED WELL AND RECOMMEND THAT IT BE RELEASED:

SIGNED Craig Duckworth  
DATE 3/26/86

Your well record was received and reclamation requirements approved. In accordance with Chapter 22, Article 4, Section 2, the above well will remain under bond coverage for the life of the well.

T. L. ...  
-Oil & Gas Division

April 2, 1986  
DATE

ENERGY  
GAS

APR 1 1988

*[Handwritten signature]*



RECEIVED

JAN 15 1982

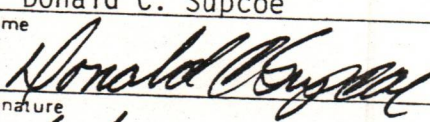
1.0 API well number: (If not available, leave blank. 14 digits.)	47-021-2869												
2.0 Type of determination being sought: (Use the codes found on the front of this form.)	107 Section of NGPA												
3.0 Depth of the deepest completion location: (Only needed if sections 103 or 107 in 2.0 above.)	4853 feet												
4.0 Name, address and code number of applicant: (35 letters per line maximum. If code number not available, leave blank.)	Pacific States Gas & Oil, Inc. <span style="float:right">14358</span> Name <span style="float:right">Seller Code</span> P. O. Box 67 Street Glenville <span style="float:right">WV</span> <span style="float:right">26351</span> City <span style="float:right">State</span> <span style="float:right">Zip Code</span>												
5.0 Location of this well: [Complete (a) or (b).] (a) For onshore wells (35 letters maximum for field name.)	Glenville Field Name Gilmer <span style="float:right">WV</span> County <span style="float:right">State</span>												
(b) For OCS wells:	Area Name <span style="float:right">Block Number</span> Date of Lease: _____ Mo. Day Yr. <span style="float:right">OCS Lease Number</span>												
(c) Name and identification number of this well: (35 letters and digits maximum.)	J. Moore #1												
(d) If code 4 or 5 in 2.0 above, name of the reservoir: (35 letters maximum.)													
6.0 (a) Name and code number of the purchaser: (35 letters and digits maximum. If code number not available, leave blank.)	Equitable Gas Company <span style="float:right">5939</span> Name <span style="float:right">Buyer Code</span>												
(b) Date of the contract:	10 17 75 Mo. Day Yr.												
(c) Estimated annual production:	22.0 MMcf.												
7.0 Contract price: (As of filing date. Complete to 3 decimal places.)	<table border="1" style="width:100%; border-collapse: collapse;"> <thead> <tr> <th style="width:40%;">(a) Base Price (\$/MMBTU)</th> <th style="width:15%;">(b) Tax</th> <th style="width:25%;">(c) All Other Prices [Indicate (+) or (-).]</th> <th style="width:20%;">(d) Total of (a), (b) and (c)</th> </tr> </thead> <tbody> <tr> <td style="text-align:center;">1.510</td> <td style="text-align:center;">---</td> <td style="text-align:center;">---</td> <td style="text-align:center;">---</td> </tr> <tr> <td style="text-align:center;">DEREGULATED</td> <td style="text-align:center;">---</td> <td style="text-align:center;">---</td> <td style="text-align:center;">---</td> </tr> </tbody> </table>	(a) Base Price (\$/MMBTU)	(b) Tax	(c) All Other Prices [Indicate (+) or (-).]	(d) Total of (a), (b) and (c)	1.510	---	---	---	DEREGULATED	---	---	---
(a) Base Price (\$/MMBTU)	(b) Tax	(c) All Other Prices [Indicate (+) or (-).]	(d) Total of (a), (b) and (c)										
1.510	---	---	---										
DEREGULATED	---	---	---										
8.0 Maximum lawful rate: (As of filing date. Complete to 3 decimal places.)	DEREGULATED												
9.0 Person responsible for this application:	Donald C. Supcoe <span style="float:right">Designated Agent</span> Name <span style="float:right">Title</span>  Signature 1/4/80 <span style="float:right">462-7744</span> Date Application is Completed <span style="float:right">Phone Number</span>												

Agency Use Only
Date Received by Juris. Agency
JAN 15 1982
Date Received by FERC



DATE: MAY 31 1982

BUYER-SELLER CODE

PARTICIPANTS:

WELL OPERATOR: Pacific States Gas & Oil, Inc.

014358

FIRST PURCHASER: Equitable Gas Co.

005939

OTHER: \_\_\_\_\_

W. Va. Department of Mines, Oil & Gas Division  
 WELL DETERMINATION FILE NUMBER  
82 0115 -107-021-2869  
 Use Above File Number on all Communications  
 Relating to Determination of this Well

*Checked 6-5-80  
 wrong affidavit on 10-55 etc.*

*Deferred for the record IV-65  
 [Signature]*

CHECK EACH ITEM AS COMPLETE OR NOTE WHAT IS MISSING

ITEM NO.

1. FERC -121  Items not completed - Line No. 7.0 b.s.d, 8.0 Deregulated

2. IV-1 Agent  Donald C. Supcoe

3. IV-2 Well Permit

4. IV-6 Well Plat

5. IV-35 Well Record  Drilling  Deepening

6. IV-36 Gas-Oil Test: Gas Only  Was Oil Produced?  Ratio

7. IV-39 Annual Production \_\_\_\_\_ years

8. IV-40 90 day Production \_\_\_\_\_ Days off line: \_\_\_\_\_

9. IV-48 Application for certification. Complete?

10-17. IV Form 51 - 52 - 53 - 54 - (55) 56 - 57 - 58 Complete?  Affidavit Signed

18-28. Other: Survey \_\_\_\_\_ Logs \_\_\_\_\_ Geological Charts \_\_\_\_\_

Structure Map \_\_\_\_\_ 1: 4000 Map \_\_\_\_\_ Well Tabulations \_\_\_\_\_  
 Gas Analyses \_\_\_\_\_

(5) Date commenced: 11-8-77 Date completed 11-15-77 Deepened \_\_\_\_\_

(5) Production Depth: 4678-4701

(5) Production Formation: Benson

(5) Final Open Flow: 1200 MCF

(5) After Frac. R. P. 1800# 4 hrs.

(6) Other Gas Test: \_\_\_\_\_

(7) Avg. Daily Gas from Annual Production: \_\_\_\_\_

(8) Avg. Daily Gas from 90-day ending w/1-120 days \_\_\_\_\_

(8) Line Pressure: \_\_\_\_\_ PSIG from Daily Report \_\_\_\_\_

(5) Oil Production: \_\_\_\_\_ From Completion Report \_\_\_\_\_

10-17. Does lease inventory indicate enhanced recovery being done NO

10-17. Is affidavit signed?  Notarized?  02/16/2024

Does official well record with the Department confirm the submitted information? yes

Additional information \_\_\_\_\_ Does computer program confirm? \_\_\_\_\_

Was Determination Objected to \_\_\_\_\_ By Whom? \_\_\_\_\_

5



Operator's Well No. Moore #1

API Well No. 47 - 021 - 2869  
State County Permit

Previous File No. (If Applicable)

STATE APPLICATION FOR WELL CLASSIFICATION

WELL OPERATOR Pacific States Gas & Oil, Inc.

DESIGNATED AGENT Donald C. Supcoe

ADDRESS P. O. Box 67  
Glenville, WV 26351

ADDRESS P. O. Box N  
Glenville, WV 26351

Gas Purchase Contract No. 6645-B and Date October 17, 1975  
(Month, day and year)

Water Chart Code 2-43-25-219099-0

Name of First Purchaser Equitable Gas Company  
420 Boulevard of the Allies  
(Street or P. O. Box)  
Pittsburgh, PA 15219  
(City) (State) (Zip Code)

FERC Seller Code 14358 FERC Buyer Code 5939

TYPE OF DETERMINATION BEING SOUGHT:

- (1) Initial determination (See FERC Form 121.) Section of NGPA 107 Category Code
- (2) Determination that increased production is the result of enhanced recovery technology.
- (3) Determination of a seasonally affected well.

F. H. McCullough, III Vice President  
Name (Print) Title

*F. H. McCullough, III*  
Signature

P. O. Box 67  
Street or P. O. Box

Glenville, WV 26351  
City State (Zip Code)

(304) 462-7744/462-5781  
Area Code Phone Number

(Certificate of Proof of Service to Purchaser)

I hereby certify that on the 4th day of January, 1982, I served FERC Form 121, together with Form IV-48WC, State Application for Well Certification, with attachments upon Equitable Gas Company, by depositing true copies thereof in the United States mail, postage prepaid, in an envelope addressed to Equitable Gas Company, 420 Blvd. of the Allies Pittsburgh, Pennsylvania 15219.

*Donald C. Supcoe*  
Donald C. Supcoe  
Designated Agent

(All of the above to be completed by the Operator/Applicant)

(To be completed by Jurisdictional Agency. Executed copy to be returned to Operator/Applicant and purchaser, if known).

The Department of Mines has received a request  for certification of the above described well as meeting the requirements of Section 107 under the Natural Gas Policy Act of 1978, (NGPA);  or for determination that increased production is the result of enhanced recovery technology under Section 108 of (NGPA);  or for determination of a seasonally affected well under Section 105 of (NGPA)

All interested parties are hereby notified that on the \_\_\_\_\_ day of \_\_\_\_\_, 19\_\_\_\_, at the office of the Oil and Gas Division in Charleston, West Virginia, or as soon thereafter as it may be heard, there will be a public hearing, if requested, or if objection is filed.

This Application is assigned File No. \_\_\_\_\_

Initial review of information submitted indicates the well  is,  is not entitled to certification as claimed under the Natural Gas Policy Act (NGPA). A review of this evidence and any additional evidence will be made at the time appointed for a public hearing or as soon thereafter as the matter may be heard.

Unless objections are timely filed or a request for a hearing is made within fifteen (15) days, a hearing will not be held except on ex parte motion of the department and the matter will go to determination.

WEST VIRGINIA DEPARTMENT OF MINES

JAN 15 1982

Date received by  
Jurisdictional Agency

By *J. E. Murray*  
Title

02/16/2024



WELL CLASSIFICATION FORM

HIGH COST GAS WELL - DEVONIAN SHALE

NGPA Section 107

DESIGNATED AGENT Donald C. Supcoe

ADDRESS P. O. Box N  
Glenville, WV 26351

LOCATION Elevation 1106'

Watershed Lynch Run

Dist. Glenville County Gilmer Quad. Glenville

Gas Purchase  
Contract No. 6645-B

Meter Chart Code 2-43-25-219099-0

Date of Contract October 17, 1975

WELL OPERATOR Pacific States  
Gas & Oil, Inc.  
ADDRESS P. O. Box 67  
Glenville, WV 26351

GAS PURCHASER Equitable Gas Company  
ADDRESS 420 Boulevard of the Allies  
Pittsburgh, PA 15219

\* \* \* \* \*  
Date surface drilling began: November 8, 1977

Indicate the bottom hole pressure of the well and explain how this was calculated.

The bottom hole pressure of this well is 2052 psig and was calculated by gauging the static surface pressure and using the standard gas deviation formula to extrapolate surface pressure to bottom hole pressure.

$BHP = P_w + P_w \cdot e^{(GL/53.34T-1)}$

$P_w =$  1800  
 $L =$  4691       $G =$  .75  
 $T =$  120       $BHP =$  2052

AFFIDAVIT

I, F. H. McCullough, III, having been first sworn according to law, state that I have calculated the percentage of footage of the producing interval which is not Devonian Shale as indicated by a Gamma Ray index of less than 0.7 if a Gamma Ray log described in subparagraph (3)(i) or (3)(ii)(A) has been filed, or as indicated by the report described in subparagraph (3)(ii)(B); I have demonstrated that the percentage of potentially disqualifying non-shale footage is equal to or less than five (5) percent of the gross Devonian age interval; and I have no knowledge of any information not described in the application which is inconsistent with a conclusion that the well qualifies as a high-cost natural gas well.

F. H. McCullough III

STATE OF WEST VIRGINIA

COUNTY OF Gilmer, TO-WIT:

I, Donald C. Supcoe, a Notary Public in and for the state and county aforesaid, do certify that F. H. McCullough, III, whose name is signed to the writing above, bearing date the 4th day of January, 1982, has acknowledged the same before me, in my county aforesaid.

02/16/2024

Given under my hand and official seal this 4th day of January, 1982.  
My term of office expires on the 6th day of November, 1991.

(NOTARIAL SEAL)

Donald C. Supcoe  
Notary Public



Surface: - Gilbert A. Jones.

7 1/2 +

LONGITUDE 80° 45'

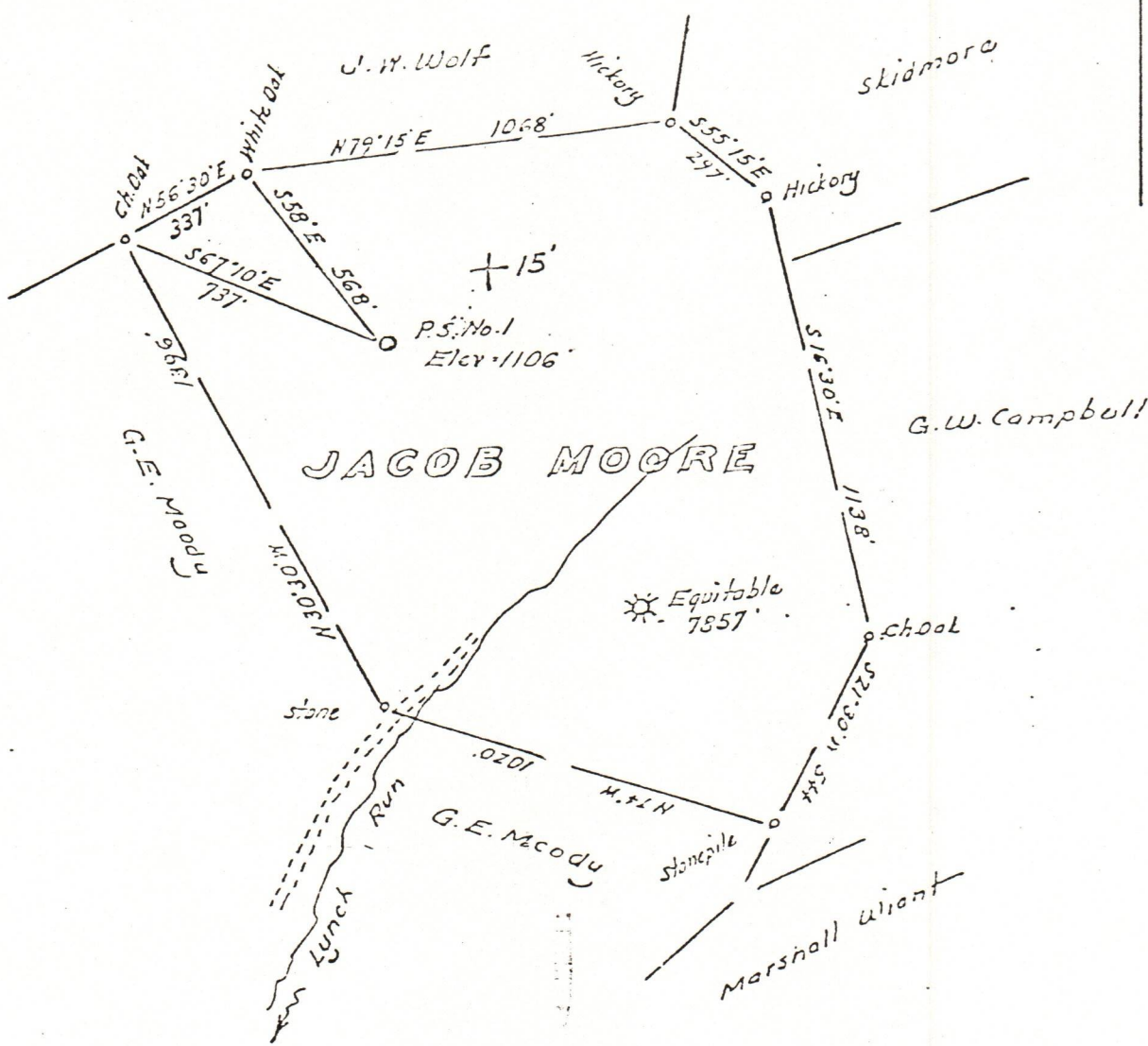

Minimum Error of Closure 1 in 200

Source of Elevation Equitable Well No. 7557 = 1093

I, the undersigned, hereby certify that this map is correct to the best of my knowledge and belief and shows all the information required by paragraph 6 of the rules and regulations of the oil and gas section of the mining laws of West Virginia.

- Fracture.....
- New Location.....
- Drill Deeper.....
- Abandonment.....

Signed: [Signature]  
Squares: N S E W

Map No.

Company Pacific States Gas and Oil  
 Address P.O. Box 67, Glenville, W. Va.  
 Farm Jacob Moore, et al  
 Tract \_\_\_\_\_ Acres 50 Lease No. \_\_\_\_\_  
 Well (Farm) No. PS No. 1 Serial No. \_\_\_\_\_  
 Elevation (Spirit Level) 1106  
 Quadrangle Glenville  
 County Gilmer District Glenville  
 Engineer [Signature]  
 Engineer's Registration No. 1277 LLS 200  
 File No. \_\_\_\_\_ Drawing No. \_\_\_\_\_  
 Date 02/16/2024 Scale 1" = 500'

STATE OF WEST VIRGINIA  
 DEPARTMENT OF MINES  
 OIL AND GAS DIVISION  
 CHARLESTON

WELL LOCATION MAP  
 02/16/2024  
 FILE NO. 470212869

+ Denotes location of well on United States Topographic Maps, scale 1 to \_\_\_\_\_, latitude and longitude lines being represented by border lines as shown.

- Denotes one inch spaces on border line of original tracing.