



---

**west virginia** department of environmental protection

---

Office of Oil and Gas  
601 57th Street SE  
Charleston, WV 25304  
(304) 926-0450  
(304) 926-0452 fax

Earl Ray Tomblin, Governor  
Randy C. Huffman, Cabinet Secretary  
www.dep.wv.gov

September 27, 2013

**WELL WORK PLUGGING PERMIT**

**Plugging**

This permit, API Well Number: 47-2102595, issued to EQT PRODUCTION COMPANY, is evidence of permission granted to perform the specified well work at the location described on the attached pages and located on the attached plat, subject to the provisions of Chapter 22 of the West Virginia Code of 1931, as amended, and all rules and regulations promulgated thereunder, and to all conditions and provisions outlined in the pages attached hereto. Notification shall be given by the operator to the Oil and Gas Inspector at least 24 hours prior to the construction of roads, locations, and/or pits for any permitted work. In addition, the well operator shall notify the same inspector 24 hours before any actual well work is commenced and prior to running and cementing casing. Spills or emergency discharges must be promptly reported by the operator to 1-800-642-3074 and to the Oil and Gas inspector.

Upon completion of the plugging well work, the above named operator will reclaim the site according to the provisions of WV Code 22-6-30. The above named operator will also file, as required in WV Code 22-6-23, an affidavit on form WR-38 by two experienced persons in the operator's employment and the Oil and Gas inspector that the work authorized under this permit was performed and a description given. Failure to abide by all statutory and regulatory provisions governing all duties and operations here under may result in suspensions or revocation of this permit and in addition may result in civil and/or criminal penalties being imposed upon the operator.

This permit will expire in two (2) years from date of issue. If there are any questions, please free to contact me at (304) 926-0499 ext. 1654

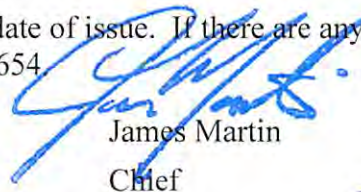

James Martin  
Chief

Operator's Well No: WV161281 WHITING #3A-W176(4)  
Farm Name: CENTRAL ENERGY CORPORATI  
**API Well Number: 47-2102595**  
**Permit Type: Plugging**  
Date Issued: 09/27/2013

# PERMIT CONDITIONS

West Virginia Code § 22-6-11 allows the Office of Oil and Gas to place specific conditions upon this permit. Permit conditions have the same effect as law. Failure to adhere to the specified permit conditions may result in enforcement action.

## CONDITIONS

---

1. All pits must be lined with a minimum of 20 mil thickness synthetic liner.
2. In the event of an accident or explosion causing loss of life or serious personal injury in or about the well or while working on the well, the well operator or its contractor shall give notice, stating the particulars of the accident or explosion, to the oil and gas inspector and the Chief within twenty-four (24) hours.
3. Well work activities shall not constitute a hazard to the safety of persons.

Date: September 10, 2013  
Operator's Well  
Well No. WV 161281(Whiting #3A-W176)  
API Well No.: 47 021 - 02595

*JKH  
16378  
40000*

**STATE OF WEST VIRGINIA  
DIVISION OF ENVIRONMENTAL PROTECTION  
OFFICE OF OIL AND GAS**

**APPLICATION FOR A PERMIT TO PLUG AND ABANDON**

4) Well Type: Oil \_\_\_\_\_ Gas X Liquid Injection \_\_\_\_\_ Waste Disposal: \_\_\_\_\_  
If Gas, Production \_\_\_\_\_ X Or Underground storage \_\_\_\_\_ Deep \_\_\_\_\_ Shallow X

5) Elevation: 780' Watershed: Little Kanawha River  
Location: Glennville 03 County: Gilmer 21 Quadrangle: Gilmer 7.5' 365  
District: \_\_\_\_\_

6) Well Operator EQT Production Company  
120 Professional Place  
Address: Bridgeport, WV 26330

7) Designated Agent: Rex C. Ray  
Address: 120 Professional Place  
Bridgeport, WV 26330

8) Oil & Gas Bryan Harris  
Name: P.O. Box 157  
Address: Volga, WV 26238

9) Plugging Contractor:  
Name: HydroCarbon Well Service  
Address: PO BOX 995  
Buckhannon, WV 26201

10) Work Order: The work order for the manner of plugging this well is as follows:  
**See Attachment for details and procedures.**

*OK gwm*

OFFICE USE ONLY

Notification must be given to the district oil and gas inspector 24 hours before permitted work can commence.

Work order approved by inspector \_\_\_\_\_

Date RECEIVED  
Office of Oil & Gas

SEP 12 2013

WV Department of  
Environmental Protection  
09/27/2013



Plugging Prognosis – Madison District  
**Whiting #3A W - 176 (161281)**  
**API # 47-021-02595**

Gilmer Co,  
 Burnsville, Quad

ELRU, 803'

Prepared by Doug Fry 8/30/2013

Current Status;

13 3/8" 163' CMT W/60 sks

8 5/8" @ 800'

4 1/2" @ 2654' CMT w/ 250 sks

FW @ 95' Coal Shows None Reported Salt Sand Estimated depth 1540'  
 Gas Shows @ 2600' – 2633' Fifth Sand  
 Oil Shows @ None Reported  
 Completion: Perfs @ 2600'

- 1) Notify State Inspector **Bryan Harris 304 553 6087** 24 hrs prior to commencing operations.
- 2) TOOH w/ 2" tubing and check condition.
- 3) TIH w/ 2" tubing, Tallying pipe on the way in @ 2600', set 200' C1A cement plug @ 2600' to 2400'. (Fifth Sand Perfs Perfs).
- 4) TOOH w/ tubing @ 2400', Gel Hole @ 2400' to 1800'.
- 5) TOOH w/ 2" tubing, Free point 4 1/2" csg, Cut 4 1/2" csg @ free point, TOOH w/ 4 1/2" "csg unless casing is needed to stay in the hole to stabilize while setting any bottom hole plugs and then pull 4 1/2" csg.
- 6) Set 100' C1A cement plug 50' In/Out of cut. Perf all, Coal, Gas, Oil & FW shows below 4 1/2" cut do not omit any plugs shown below.
- 7) TIH w/ tubing @ 1800', set 100' C1A cement plug @ 1800' to 1700'. (Insurance Plug)
- 8) TOOH w/ tubing @ 1700', Gel Hole @ 1700' to 1540'.
- 9) TOOH w/ tubing @ 1540', set 100' C1A cement plug @ 1540' to 1440'. (Salt Sand)
- 10) TOOH w/ tubing @ 1440', Gel Hole @ 1440' to 850'.
- 11) TOOH w/ tubing @ 850', set 100' C1A cement plug @ 850' to 750'. (8 5/8" csg pt)
- 12) TOOH w/ tubing @ 750', Gel Hole @ 750' to 210'.
- 13) TOOH w/ 2" tubing, Free point 8 5/8" csg, Cut 8 5/8" csg @ free point, TOOH w/ 8 5/8" "csg unless casing is needed to stay in the hole to stabilize while setting any bottom hole plugs and then pull 8 5/8" csg.
- 14) Set 100' C1A cement plug 50' In/Out of cut. Perf all, Coal, Gas, Oil & FW shows below 8 5/8" cut do not omit any plugs shown below.
- 15) TIH w/ tubing @ 210', set 210' Cement Plug to Surface. (FW show, 13 3/8" csg pt)
- 16) Top off as needed.
- 17) Set Monument to WV – DEP Specifications
- 20) Reclaim Location & Roads to WV-DEP Specifications.

WELL RECORDS DO NOT SHOW  
 THAT 8 5/8" WAS LEFT IN WELL.

OK JAW

RECEIVED  
 Office of Oil & Gas

SEP 12 2013

WV Department of  
 Environmental Protection

09/27/2013



STATE OF WEST VIRGINIA  
DEPARTMENT OF MINES

RECEIVED

JAN 12 1976

Oil and Gas Division

OIL & GAS DIVISION  
DEPT. OF MINES

WELL RECORD

Quadrangle Burnsville  
Permit No. GIL-2595

Rotary \_\_\_\_\_ Oil \_\_\_\_\_  
Cable X \_\_\_\_\_ Gas \_\_\_\_\_  
Recycling \_\_\_\_\_ Comb. X \_\_\_\_\_  
Water Flood \_\_\_\_\_ Storage \_\_\_\_\_  
Disposal \_\_\_\_\_ (Kind) \_\_\_\_\_

Company Waco Oil & Gas Co., Inc.  
Address Box 4, Glenville, WV 26351  
Farm A. E. Whiting Acres 242  
Location (waters) Little Kanawha River  
Well No. 3-A Elev. 803'  
District Glenville County Gilmer  
The surface of tract is owned in fee by \_\_\_\_\_  
R. A. Darnall  
Address Gilmer, W. Va.  
Mineral rights are owned by A. E. Whiting, et al  
Address Glenville, WV 26351  
Drilling Commenced 11/7/75  
Drilling Completed 12/22/75  
Initial open flow \_\_\_\_\_ cu. ft. \_\_\_\_\_ bbls.  
Final production 200,000 cu. ft. per day 25 bbls.  
Well open \_\_\_\_\_ hrs. before test \_\_\_\_\_ RP.

| Casing and Tubing | Used in Drilling | Left in Well | Cement fill up Cu. ft. (Sks.) |
|-------------------|------------------|--------------|-------------------------------|
| Size 20-16        |                  |              | 60 sks.                       |
| Cond. 13-10"      | 163'             | 163'         |                               |
| 9 5/8             |                  |              |                               |
| 8 5/8             | 800'             |              |                               |
| 7                 |                  |              |                               |
| 5 1/2             |                  |              | 250 sks.                      |
| 4 1/2             |                  | 2654'        |                               |
| 3                 |                  |              |                               |
| 2                 |                  |              |                               |
| Liners Used       |                  |              |                               |

Well treatment details:  
Attach copy of cementing record.  
Allegheny Nuclear Surveys perforated 12/30/75. Dowell fractured Fifth Sand 12/30/75 w/582 bbl. water, 30,000# 20/40 sand. BD-2100 psig. TP-1500 to 2100 psig. ISIP-1200 psig.

Coal was encountered at -0- Feet \_\_\_\_\_ Inches \_\_\_\_\_  
Fresh water 95 Feet \_\_\_\_\_ Salt Water -0- Feet \_\_\_\_\_  
Producing Sand Fifth Depth 2600 - 2633

| Formation                | Color | Hard or Soft | Top Feet | Bottom Feet | Oil, Gas or Water | * Remarks |
|--------------------------|-------|--------------|----------|-------------|-------------------|-----------|
| Clay, Sand & Slate       |       |              | 0        | 110         |                   |           |
| Slate, & Red Rock        |       |              | 110      | 250         |                   |           |
| Sand & Slate             |       |              | 250      | 370         |                   |           |
| Red Rock, Slate & Shells |       |              | 370      | 545         |                   |           |
| Sand, Slate & Shells     |       |              | 545      | 795         |                   |           |
| Sand                     |       |              | 795      | 960         |                   |           |
| Slate & Sand             |       |              | 960      | 1420        |                   |           |
| Sand                     |       |              | 1420     | 1525        |                   |           |
| Shale                    |       |              | 1525     | 1602        |                   |           |
| Sand                     |       |              | 1602     | 1690        |                   |           |
| Red Rock, Slate & Shells |       |              | 1690     | 1715        |                   |           |
| Lime                     |       |              | 1715     | 1750        |                   |           |
| Sand                     |       |              | 1750     | 1762        |                   |           |
| Slate                    |       |              | 1762     | 1775        |                   |           |
| Lime                     |       |              | 1775     | 1915        |                   |           |
| Sand                     |       |              | 1915     | 1973        |                   |           |
| Shale                    |       |              | 1973     | 2600        |                   |           |
| Fifth Sand               |       |              | 2600     | 2633        |                   |           |
| Slate & Shells           |       |              | 2633     | 2685        |                   |           |
| TD                       |       |              |          | 2685        |                   |           |

Show of gas & oil @ 2612'  
RECEIVED  
Office of Oil & Gas  
SEP 12 2013

\* Indicates Electric Log tops in the remarks section.

(over)

WV Department of Environmental Protection  
09/27/2013





2102595P

WW-4-A  
Revised 6/07

1) Date: September 10, 2013  
2) Operator's Well Number  
WV 161281(Whiting #3A-W176)  
3) API Well No.: 47 021 - 02595  
State County Permit

**STATE OF WEST VIRGINIA - BUREAU OF ENVIRONMENT  
DIVISION OF ENVIRONMENTAL PROTECTION, OFFICE OF OIL & GAS  
NOTICE AND APPLICATION TO PLUG AND ABANDON WELL**

4) Surface Owner(s) to be served:  
(a) Name Central Energy Corporation ✓  
Address C/O Waco Oil & Gas Co. Inc.  
P.O. Box 297  
Glenville, WV 26351  
(b) Name \_\_\_\_\_  
Address \_\_\_\_\_  
(c) Name \_\_\_\_\_  
Address \_\_\_\_\_  
6) Inspector Bryan Harris ✓  
Address P.O. Box 157  
Volga, WV 26238  
Telephone 304-553-6087

5) (a) Coal Operator:  
Name None  
Address \_\_\_\_\_  
(b) Coal Owner(s) with Declaration ✓  
Name Central Energy Corporation  
C/O Waco Oil & Gas Co. Inc.  
Address P.O. Box 297  
Glenville, WV 26351  
Name \_\_\_\_\_  
Address \_\_\_\_\_  
(c) Coal Lessee with Declaration  
Name None  
Address \_\_\_\_\_

**TO THE PERSONS NAMED ABOVE:** You should have received this Form and the following documents:

- (1) The application to Plug and Abandon a Well on Form WW-4B, which sets out the parties involved in the work and describes the well its and the plugging work order; and
  - (2) The plat (surveyor's map) showing the well location on Form WW-6.
- The reason you received these documents is that you have rights regarding the application which are summarized in the instructions on the reverses side. However, you are not required to take any action at all.

Take notice that under Chapter 22-6 of the West Virginia Code, the undersigned well operator proposes to file or has filed this Notice and Application and accompanying documents for a permit to plug and abandon a well with the Chief of the Office of Oil and Gas, West Virginia Division of Environmental Protection, with respect to the well at the location described on the attached Application and depicted on the attached Form WW-6. Copies of this Notice, the Application, and the plat have been mailed by registered or certified mail or delivered by hand to the person(s) named above (or by publication in certain circumstances) on or before the day of mailing or delivery to the Chief.

Well Operator: \_\_\_\_\_  
By \_\_\_\_\_  
Notary Public, State Of West Virginia  
NICHOLAS L. BUMGARDNER Address: \_\_\_\_\_  
Rt. 1 Box 4  
Liberty, WV 25124 Telephone: \_\_\_\_\_  
My Commission Expires June 27, 2018  
Subscribed and sworn before me this \_\_\_\_\_ day of \_\_\_\_\_, 2013  
My Commission Expires: \_\_\_\_\_

**EQT Production Company**  
Victoria J. Roark  
**Permitting Supervisor**  
PO Box 280  
Bridgeport, WV 26330  
(304) 848-0076

The Office of Oil & Gas processes your personal information, such as name, address and phone number, as part of our regulatory duties. Your personal information may be disclosed to other State agencies or third parties in the normal course of business or as needed to comply with statutory or regulatory requirements, including Freedom of Information Act requests. Our office will appropriately secure your personal information. If you have any questions about our use of your personal information, please contact DEP's Chief Privacy Officer at [depprivacyofficer@wv.gov](mailto:depprivacyofficer@wv.gov).

RECEIVED  
Office of Oil & Gas  
SEP 12 2013  
WV Department of  
Environmental Protection  
09/27/2013



**STATE OF WEST VIRGINIA**  
**DEPARTMENT OF ENVIRONMENTAL PROTECTION, OFFICE OF OIL & GAS**  
**CONSTRUCTION AND RECLAMATION PLAN AND SITE REGISTRATION APPLICATION FORM**  
**GENERAL PERMIT FOR OIL AND GAS PIT WASTE DISCHARGE**

Operator Name: EQT PRODUCTION COMPANY OP ID: \_\_\_\_\_  
Watershed: Little Kanawha River Quadrangle: Gilmer 7.5'  
Elevation: 780' County: Gilmer District: Glennville

Description of anticipated Pit Waste: Formation Fluids

Do you anticipate using more than 5,000 bbls of water to complete the proposed well work? Yes\_\_\_ No X  
Will synthetic liner be used in the pit? Yes Is so, what ml.? 30 ml

Proposed Disposal Method for Treated Pit Wastes:  
X Land Application  
\_\_\_\_ Underground Injection - UIC Permit Number \_\_\_\_\_  
\_\_\_\_ Reuse (at API Number) \_\_\_\_\_  
\_\_\_\_ Offsite Disposal Permit #. \_\_\_\_\_  
\_\_\_\_ Other: Explain \_\_\_\_\_

Drilling medium anticipated for this well? Air, freshwater, oil based, etc. \_\_\_\_\_  
If oil based, what type? Synthetic, petroleum, etc. \_\_\_\_\_

Additives to be used? \_\_\_\_\_

Will closed loop system be used? \_\_\_\_\_

Drill Cuttings disposal method? Leave in pit, landfill, remove offsite, etc. \_\_\_\_\_  
If left in pit and plan to solidify what medium will be used? Cement, Lime, sawdust \_\_\_\_\_  
Landfill or offsite name/permit number? \_\_\_\_\_

I certify that I understand and agree to the terms and conditions of the GENERAL WATER POLLUTION PERMIT issued on August 1, 2005, by the Office of Oil and Gas of the West Virginia Division of Environmental Protection. I understand that the provisions of the permit are enforceable by law. Violations of any terms or condition of the general permit and/or other applicable law or regulation can lead to enforcement action.  
I certify under penalty of law that I have personally examined and am familiar with the information submitted on this application form and all attachments thereto and that, based on my inquiry of those individuals immediately responsible for obtaining the information, I believe that the information is true, accurate and complete. I am aware that there are significant penalties for submitting false information, including the possibility of fine or imprisonment.

Company Official Signature \_\_\_\_\_  
Company Official (Typed or Printed) Victoria Roark  
Company Official Title Permitting Supervisor-WV  
Subscribed and sworn before me this 10 day of SEPTEMBER, 2013

RECEIVED  
Office of Oil & Gas  
SEP 12 2013

\_\_\_\_\_  
My Commission Expires 6/27/2018 Notary Public

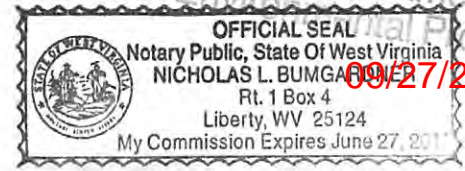

WV Department of Environmental Protection



**OPERATOR'S WELL NO.:**  
**WV 161281(Whiting #3A-W176)**

**LEGEND**

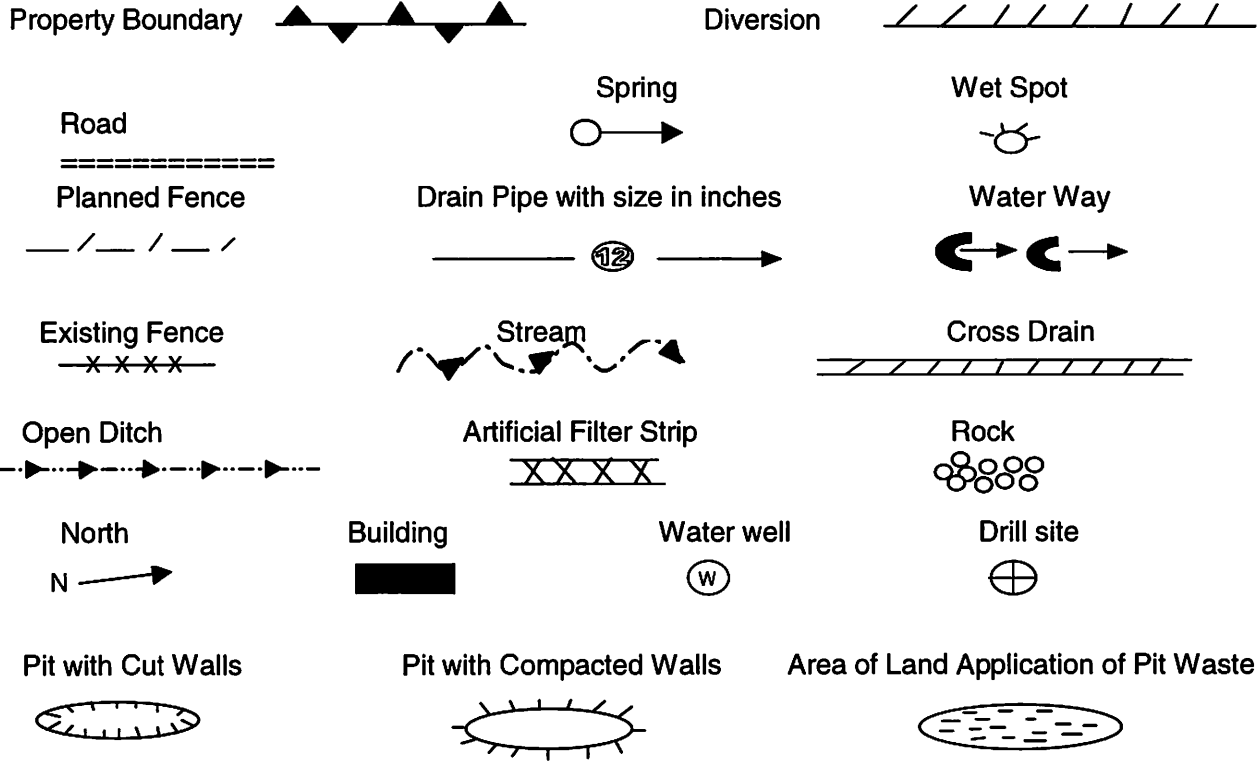

Proposed Revegetation Treatment: Acres Disturbed: 1± Prevegetation pH 5.8

Lime 3 Tons/acre or to correct to pH 6.5

Fertilizer (10-20-20) or equivalent 1/3 ton lbs/acre (500 lbs minimum)

Mulch 2 Tons/acre or hydroseed.

**SEED MIXTURES**

| Area I        |          | Area II       |          |
|---------------|----------|---------------|----------|
| Seed Type     | lbs/acre | Seed Type     | lbs/acre |
| KY-31         | 40       | Orchard Grass | 15       |
| Alsike Clover | 5        | Alsike Clover | 5        |
| Annual Rye    | 15       |               |          |
|               |          |               |          |

**ATTACH:**

Drawing(s) of road, location, pit and proposed area for land application.  
Photocopies section of involved 7.5' topographic sheet.

Plan approved by: \_\_\_\_\_

Comments: \_\_\_\_\_

Title: \_\_\_\_\_  
Field Reviewed?        Yes        No

Date: \_\_\_\_\_

**RECEIVED**  
Office of Oil & Gas

SEP 12 2013

WV Department of  
Environmental Protection  
09/27/2013



2102595 P

Topo Quad: Gilmer 7.5' Scale: 1" = 2000'  
 County: Gilmer Date: August 20, 2013  
 District: Glennville Project No: 25-19-00-07

47-021-02595 WV 161281 (Whiting #3A-W176)

Topo

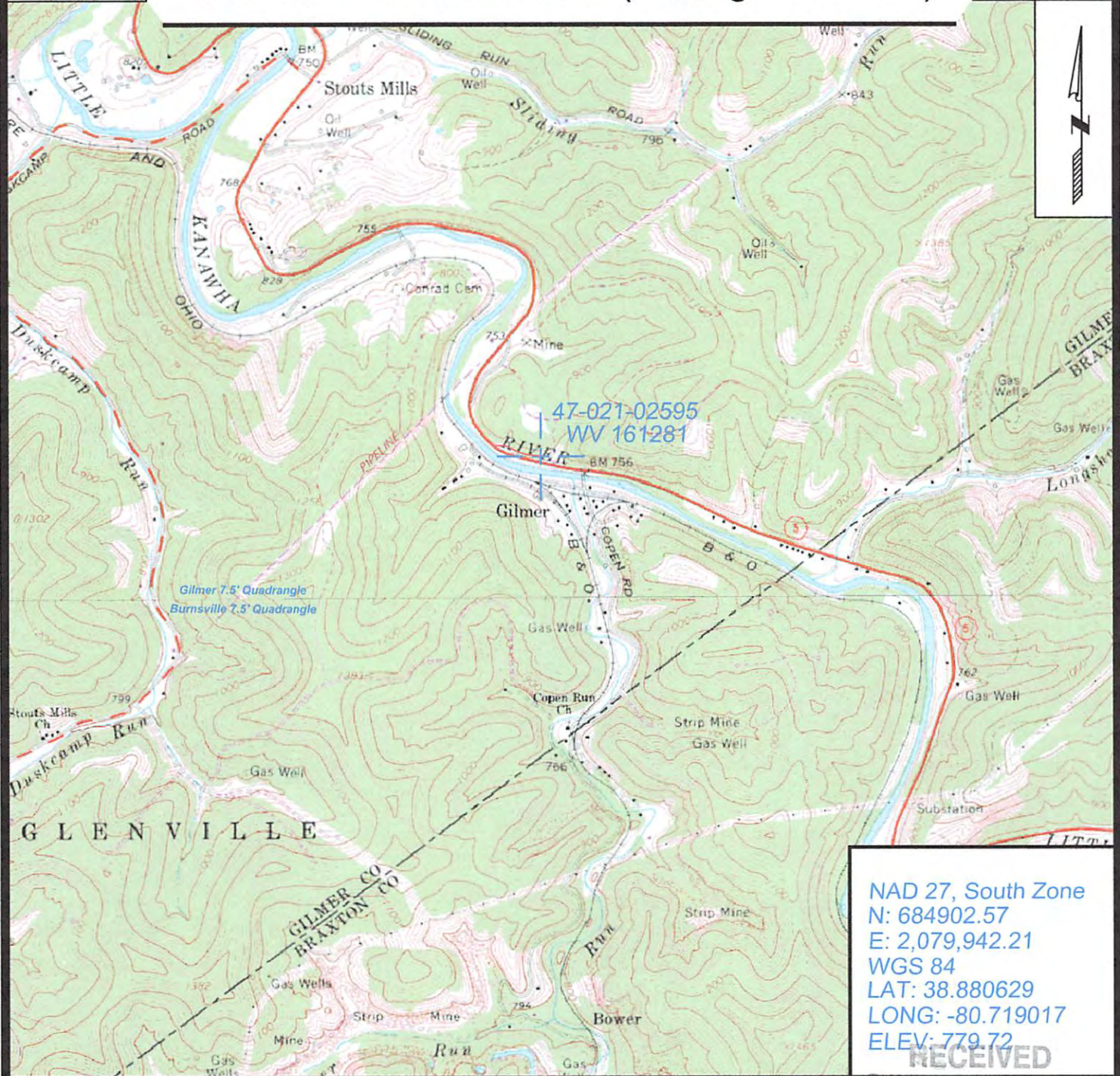

47-021-02595  
WV 161281

NAD 27, South Zone  
 N: 684902.57  
 E: 2,079,942.21  
 WGS 84  
 LAT: 38.880629  
 LONG: -80.719017  
 ELEV: 779.72

RECEIVED

Office of Oil & Gas



SURVEYING AND MAPPING SERVICES PERFORMED BY:  
**ALLEGHENY SURVEYS, INC.**  
 1-800-482-8606  
 P.O. BOX 438  
 BIRCH RIVER, WV 26610  
 PH: (304) 649-8606  
 FAX: (304) 649-8608

PREPARED FOR:  
**EQT Production Company**  
 P.O. Box 280  
 Bridgeport, WV 26330  
 WV Department of Environment  
 09/27/2013



21 02595 P

WW-7  
8-30-06



West Virginia Department of Environmental Protection  
Office of Oil and Gas  
**WELL LOCATION FORM: GPS**

API: 47-021-02595 WELL NO.: WV 161281 (Whiting #3A-W176)  
FARM NAME: Whiting  
RESPONSIBLE PARTY NAME: EQT Production Company  
COUNTY: Gilmer DISTRICT: Glenville  
QUADRANGLE: Gilmer 7.5'  
SURFACE OWNER: Central Energy Corporation  
ROYALTY OWNER: Cayenne Investment LTD, et al.  
UTM GPS NORTHING: 4303568  
UTM GPS EASTING: 524372 GPS ELEVATION: 237 m (780 ft)

The Responsible Party named above has chosen to submit GPS coordinates in lieu of preparing a new well location plat for a plugging permit or assigned API number on the above well. The Office of Oil and Gas will not accept GPS coordinates that do not meet the following requirements:

1. Datum: NAD 1983, Zone: 17 North, Coordinate Units: meters, Altitude: height above mean sea level (MSL) – meters.
2. Accuracy to Datum – 3.05 meters
3. Data Collection Method:  
Survey grade GPS     : Post Processed Differential       
Real-Time Differential       
Mapping Grade GPS X: Post Processed Differential X  
Real-Time Differential

4. **Letter size copy of the topography map showing the well location.**

I the undersigned, hereby certify this data is correct to the best of my knowledge and belief and shows all the information required by law and the regulations issued and prescribed by the Office of Oil and Gas.

Signature [Handwritten Signature]  
Date 9/22/13

Title PS#2180

RECEIVED  
Office of Oil & Gas  
SEP 12 2013

WV Department of Environmental Protection  
09/27/2013





### POTENTIAL WATER SAMPLE DATA SHEET

CLIENT: EQT PRODUCTION COMPANY  
LEASE NAME AND WELL No. Whiting WV 161281 (47-021-02595)

The initial mapping review of the area surrounding the proposed well site revealed the below listed surface owner(s) that were potentially utilizing groundwater (potable) for Human Consumption or other purposes within 1000' of the existing well site. The following landowners will be notified of the opportunity to request a water sample.

\*Please note that the following information is subject to change upon field inspection.

#### POTENTIAL SAMPLE LOCATIONS

Site: 1 Spacing: 990' +/- Owner: National Timber Partners WV 3 LLC  
Address: 471 B&O Overpass Road, Hedgesville, WV 25427 Phone No. \_\_\_\_\_  
Comments:

Site: 2 Spacing: 990' +/- Owner: CSX Corporation  
Address: 500 Water Street, Jacksonville, FL 32202 Phone No. 904.359.3200  
Comments:

Site: 3 Spacing: 900' +/- Owner: James and Lois Waldeck/Michael Kelley  
Address: 138 Darnell Drive, Glenville, WV 26351 Phone No. 304.853.2768  
Comments:

**BIRCH RIVER OFFICE**  
P.O. Box 438 • 237 Birch River Road  
Birch River, WV 26610  
phone: 304-649-8606  
fax: 304-649-8608

**BRIDGEPORT OFFICE**  
172 Thompson Drive  
Bridgeport, WV 26330  
phone: 304-848-5035  
fax: 304-848-5037

**CALDWELL OFFICE**  
212 Cumberland Street  
Caldwell, OH 43724  
phone: 740-305-5007  
fax: 740-305-5126

**RECEIVED**  
**Oil & Gas**  
ALUM CREEK OFFICE  
P.O. Box 108 • 1415 Childress Road  
Alum Creek, WV 25003  
phone: 304-756-2948  
SEP 27 2013



Topo Quad: Gilmer 7.5' Scale: 1" = 2000'  
 County: Gilmer Date: August 20, 2013  
 District: Glennville Project No: 25-19-00-07

Water

### 47-021-02595 WV 161281 (Whiting #3A-W176)

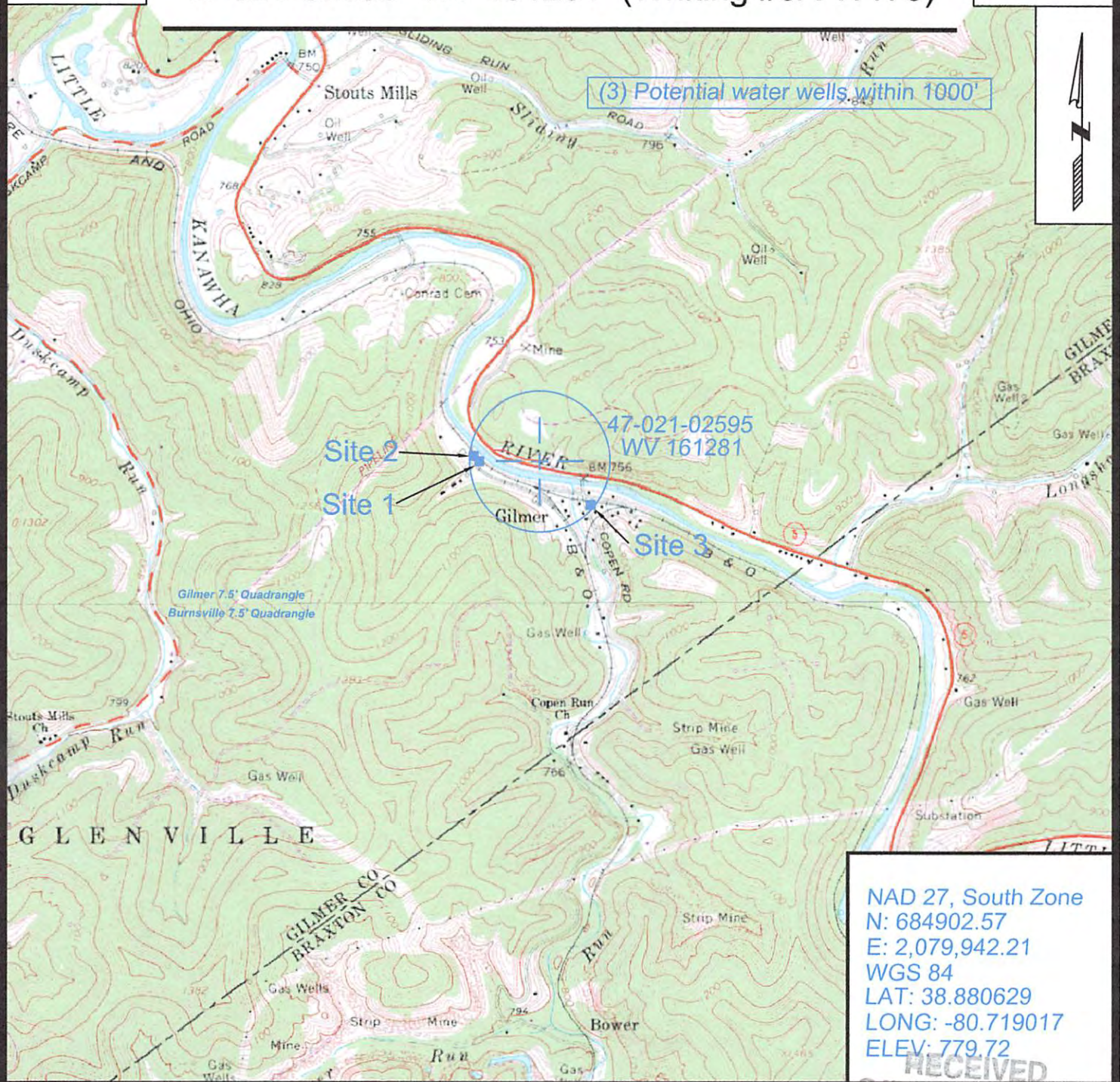

NAD 27, South Zone  
 N: 684902.57  
 E: 2,079,942.21  
 WGS 84  
 LAT: 38.880629  
 LONG: -80.719017  
 ELEV: 779.72



SURVEYING AND MAPPING SERVICES PERFORMED BY:  
**ALLEGHENY SURVEYS, INC.**  
 1-800-482-8606  
 P.O. BOX 438  
 BIRCH RIVER, WV 26610  
 PH: (304) 649-8606  
 FAX: (304) 649-8608

PREPARED FOR:  
**EQT Production Company**  
 P.O. Box 280  
 Bridgeport, WV 26330