



RECEIVED

JAN 2 1974

STATE OF WEST VIRGINIA  
DEPARTMENT OF MINES

OIL & GAS DIVISION  
DEPT. OF MINES

Oil and Gas Division

OIL AND GAS WELL PERMIT APPLICATION

TO THE DEPARTMENT OF MINES,  
Charleston, W. Va.

DATE December 31, 1974  
Company Basin Petroleum Corp  
Address P.O. Box 37, Glenville, WV 26351  
Farm Trio Acres 50  
Location (waters) Mike's Run  
Well No. 1 Elevation 1091'  
District Glenville County Gilmer  
Quadrangle Burnsville

Surface Owner Trio Petroleum Corp  
Address P.O. Box 37, Glenville, WV 26351  
Mineral Owner Trio Petroleum Corp, etal  
Address P.O. Box 37, Glenville, WV 26351  
Coal Owner Eastern Associated Coal Company  
Address Kopper's Bld., Pittsburgh, PA 19107  
Coal Operator None  
Address \_\_\_\_\_

INSPECTOR TO BE NOTIFIED Robert Bates  
Weston PH: 269-4846  
W.Va.

THIS PERMIT MUST BE POSTED AT THE WELL SITE

All provisions being in accordance with Chapter 22, of the W. Va. Code, the location is hereby approved for drilling. This permit shall expire if operations have not commenced by 5-3-75.

Robert H. Hoad  
Deputy Director - Oil & Gas Division

GENTLEMEN:

The undersigned well operator is entitled to drill upon the above named farm or tract of land for oil and gas, having fee title thereto, (or as the case may be) under grant or lease dated December 12 19 74 by Russell King, etux made to I.L. Morris, etal and recorded on the 31st day of December 19 74 in Gilmer County, Book 275 Page 66  
XXX NEW WELL DRILL DEEPER REDRILL FRACTURE OR STIMULATE  
OIL AND GAS WELL ORIGINALLY DRILLED BEFORE JUNE 5, 1969.

The enclosed plat was prepared by a registered engineer or licensed land surveyor and all coal owners and/or operators have been notified as of the above date.

The above named coal owners and/or operator are hereby notified that any objection they wish to make, or are required to make by Section 3 of the Code, must be received by, or filed with the Department of Mines within ten (10) days. \*

Copies of this notice and the enclosed plat were mailed by registered mail, or delivered to the above named coal operators or coal owners at their above shown respective address \_\_\_\_\_ day \_\_\_\_\_ before, or on the same day with the mailing or delivery of this copy to the Department of Mines at Charleston, West Virginia.

PLEASE SUBMIT COPIES OF ALL  
GEOPHYSICAL LOGS DIRECTLY TO:

West Virginia Geological and Economic Survey  
P. O. Box 879  
Morgantown, W. Va. 26505  
AC 304-296-4461

Address  
of  
Well Operator

Very truly yours, BASIN PETROLEUM CORP  
(Sign Name) by: [Signature]  
Well Operator  
P. O. Box 37  
Street  
Glenville  
City or Town  
West Virginia 26351  
State

10/06/2023

\*SECTION 3 . . . . If no objections are filed or found by the Department of mines, within said period of ten days from the receipt of notice and plat by the department of mines, to said proposed location, the department shall forthwith issue to the well operator a permit reciting the filing of such plat, that no objections have been made by the coal operators or found thereto by the department and that the same is approved and the well operator authorized to proceed.

BLANKET BOND

GIL- 2520 PERMIT NUMBER

47-021

**THIS IS AN ESTIMATE ONLY  
ACTUAL INFORMATION WILL BE SUBMITTED ON OG-10 UPON COMPLETION**

PROPOSED WORK ORDER TO XXX DRILL \_\_\_\_\_ DEEPEN \_\_\_\_\_ FRACTURE-STIMULATE \_\_\_\_\_  
 DRILLING CONTRACTOR: (If Known) RESPONSIBLE AGENT:  
 NAME Unknown NAME Trio Petroleum Corp  
 ADDRESS \_\_\_\_\_ ADDRESS P.O. Box 37, Glenville, WV 26351  
 TELEPHONE \_\_\_\_\_ TELEPHONE 462-8496  
 ESTIMATED DEPTH OF COMPLETED WELL: 2900' ROTARY \_\_\_\_\_ CABLE TOOLS \_\_\_\_\_  
 PROPOSED GEOLOGICAL FORMATION: Fifth & Injun  
 TYPE OF WELL: OIL \_\_\_\_\_ GAS \_\_\_\_\_ COMB. XXX STORAGE \_\_\_\_\_ DISPOSAL \_\_\_\_\_  
 RECYCLING \_\_\_\_\_ WATER FLOOD \_\_\_\_\_ OTHER \_\_\_\_\_

**TENTATIVE CASING PROGRAM:**

CASING AND TUBING SIZE	USED FOR DRILLING	LEFT IN WELL	CEMENT FILL UP OR SACKS - CUBIC FT.
20 - 16			
13 - 10	30	30	
9 - 5/8			
8 - 5/8	250	250	50 sacks
7			
5 1/2			
4 1/2		2,900	200 sacks
3			Perf. Top
2			Perf. Bottom
Liners			Perf. Top
			Perf. Bottom

APPROXIMATE FRESH WATER DEPTHS 50 FEET \_\_\_\_\_ SALT WATER \_\_\_\_\_ FEET \_\_\_\_\_  
 APPROXIMATE COAL DEPTHS None \_\_\_\_\_  
 IS COAL BEING MINED IN THE AREA? None BY WHOM? \_\_\_\_\_

**TO DRILL:**

SUBMIT FIVE (5) COPIES OF OG - 1, \$100.00 PERMIT FEE, PERFORMANCE BOND AND PERMANENT COPY OF PLAT.

**TO DRILL DEEPER OR REDRILL:**

SUBMIT FIVE (5) COPIES OF OG - 1, SHOWING ORIGINAL PERMIT NUMBER AND PERFORMANCE BOND. ON WELLS DRILLED PRIOR TO 1929, A PERMANENT COPY OF THE PLAT AND THE ORIGINAL WELL RECORD MUST ALSO BE SUBMITTED.

**TO FRACTURE - STIMULATE:**

OIL AND/OR GAS WELL ORIGINALLY DRILLED BEFORE JUNE 5, 1929, FIVE (5) COPIES OG - 1, PERFORMANCE BOND, PERMANENT PLAT AND ORIGINAL WELL RECORD.

OIL AND/OR GAS WELL ORIGINALLY DRILLED ON AND/OR AFTER JUNE 5, 1929, FIVE COPIES OG - 1, SHOWING ORIGINAL PERMIT NUMBER, AND PERFORMANCE BOND.

Required forms must be filed within ninety (90) days of completion for bond release. Inspector to be notified twenty-four (24) hours in advance.

The following waiver must be completed by the coal operator if the permit is to be issued within ten days of receipt thereof.

WAIVER: I the undersigned, Agent for \_\_\_\_\_ Coal Company, Owner or Operator of the coal under this lease have examined and place on our mine maps this proposed well location.  
 We the \_\_\_\_\_ Coal Company have no objections to said well being drilled at this location, providing operator has complied with all rules and regulations in Articles 4, 5, and 7, Chapter 22 of the West Virginia Code.

\_\_\_\_\_  
 For Coal Company

\_\_\_\_\_  
 Official Title

10/06/2023



STATE OF WEST VIRGINIA  
DEPARTMENT OF MINES  
**Oil and Gas Division**  
**WELL RECORD**

RECEIVED

MAY 27 1975

OIL & GAS DIVISION  
DEPT. OF MINES

Quadrangle Burnsville  
Permit No. GIL-2520

Rotary \_\_\_\_\_ Oil \_\_\_\_\_  
Cable X Gas \_\_\_\_\_  
Recycling \_\_\_\_\_ Comb. X  
Water Flood \_\_\_\_\_ Storage \_\_\_\_\_  
Disposal \_\_\_\_\_ (Kind)

Company Basin Petroleum Corp.  
Address P. O. Box 37, Glenville, WV 26351  
Farm Trio Acres 50  
Location (waters) Mike's Run  
Well No. 1 Elev. 1091'  
District Glenville County Gilmer  
The surface of tract is owned in fee by Trio Petroleum Corp, etal  
Address P. O. Box 37, Glenville, WV 26351  
Mineral rights are owned by Trio Petroleum Corp, etal Address P.O. Box 37, Glenville, WV  
Drilling Commenced 3-28-75  
Drilling Completed 4-29-75  
Initial open flow 335,000 cu. ft. show bbls.  
Final production 1,007,000 cu. ft. per day show bbls.  
Well open 5 hrs. before test 705 RP.

Casing and Tubing	Used in Drilling	Left in Well	Cement fill up Cu. ft. (Sks.)
Size 20-16			
Cond. 13-10"	20	20	100 sacks
9 5/8			
8 5/8	862		
7			
5 1/2			
4 1/2	2817	2817	275 sacks
3			
2			
Liners Used			

Well treatment details:

Attach copy of cementing record.

Fifth Sand - 30,000#20-40 sand, 646 bbls. gelled water, BDP-1750 psi, Avg. Inj. Rate, 30.2 BPM.  
Injun Sand - 60,000#20-40 sand, 892 bbls. gelled water, BDP-2200 psi, Avg. Inj. Rate, 41.0 BPM.  
Blue Monday Sand - 30,000#20-40 sand, 646 bbls. gelled water, BDP-2600 psi, Ave. Inj. Rate, 28.3 BPM.

Coal was encountered at \_\_\_\_\_ Feet \_\_\_\_\_ Inches  
Fresh water 110' Feet \_\_\_\_\_ Salt Water \_\_\_\_\_ Feet \_\_\_\_\_  
Producing Sand Fifth, Injun and Blue Monday Depth 2760', 2010' and 1864'

Formation	Color	Hard or Soft	Top Feet	Bottom Feet	Oil, Gas or Water	* Remarks
Red Rock			0	40		
Sand			40	100		
Slate & Shells			100	207		Water - 110'
Red Rock			207	224		
Slate & Shells			224	315		
Red Rock			315	465		
Sandy Slate			465	540		
Slate			540	585		
Red Rock			585	662		
Slate			662	720		
Red Rock			720	745		
Sand			745	830		
Slate & Shells			830	895		
Sand			895	1030		
Slate			1030	1040		
Sand			1040	1290		
Slate & Shells			1290	1385		
Sand			1385	1480		Show of gas - 1460-1480'
Slate & Shells			1480	1544		
Sand			1544	1622		
Slate & Shells			1622	1654		
Sand			1654	1760		Gas - 1730'-1743'
Slate & Red Rock			1760	1810		Show of Oil - 1743'-1752'
Lime			1810	1843		

(over)

\* Indicates Electric Log tops in the remarks section.

Formation	Color	Hard or Soft	Top Feet	Bottom Feet	Oil, Gas or Water	* Remarks
Sand			1843	1886		
Lime			1886	1950		Show of Oil - 1947'
Sand			1950	1968		
Lime			1968	1986		
Sand			1986	2055		
Sand			2055	2165		
Slate & Shells			2165	2447		
Sand			2447	2455		
Slate & Shells			2455	2741		Show Oil & Gas - 2741'
Sand			2741	2755		
Slate & Shells			2755	2846		
TD			2846			

10/06/2023

Date May 2, 19 75

APPROVED Basin Petroleum Corp. Owner

By E. A. Broome

(Title)

STATE OF WEST VIRGINIA  
DEPARTMENT OF MINES  
OIL AND GAS WELLS DIVISION

RECEIVED

MAY 5 1975

OIL & GAS DIVISION  
DEPT. OF MINES

INSPECTOR'S WELL REPORT

Permit No. GIL-2520

Oil or Gas Well \_\_\_\_\_  
(KIND)

Company <u>Basin Petroleum Co.</u>	CASING AND TUBING	USED IN DRILLING	LEFT IN WELL	PACKERS
Address <u>Box 37 Glenville, W.Va.</u>	Size			
Farm <u>Trio</u>	16			Kind of Packer _____
Well No. <u>one</u>	13			
District <u>Glenville</u> County <u>Gilmer</u>	10 <sup>3/4</sup> "		<u>226'</u>	Size of _____
Drilling commenced <u>3-27-75</u>	8 1/4	<u>862'</u>		Depth set _____
Drilling completed <u>4-30-75</u> Total depth <u>2830'</u> (Log 2846')	6 5/8			
Date shot _____ Depth of shot _____	5 3/16			
Initial open flow _____ /10ths Water in _____ Inch	3 <sup>4/5</sup> "		<u>2817'</u>	<u>4-30-75</u> Perf. top _____
Open flow after tubing _____ /10ths Merc. in _____ Inch	2			Perf. bottom _____
Volume _____ Cu. Ft.	Liners Used			Perf. top _____
Rock pressure _____ lbs. _____ hrs.				Perf. bottom _____
Oil _____ bbls., 1st 24 hrs.	CASING CEMENTED <u>10 <sup>3/4</sup>"</u> SIZE <u>226'</u> No. FT. <u>3-30-75</u> Date			
Fresh water <u>110'</u> feet _____ feet	NAME OF SERVICE COMPANY <u>100515</u> <u>Dowell</u>			
Salt water _____ feet _____ feet	COAL WAS ENCOUNTERED AT _____ FEET _____ INCHES			
	_____ FEET _____ INCHES _____ FEET _____ INCHES			
	_____ FEET _____ INCHES _____ FEET _____ INCHES			

Drillers' Names "Ed" Williams  
Central Well Service

Remarks: Pulling 8 5/8" casing

5-1-75  
DATE

Robert B. [Signature]  
10/06/2023  
DISTRICT WELL INSPECTOR





**RECEIVED**  
DEPARTMENT OF ENERGY  
OIL AND GAS

**State of West Virginia**  
**Department of Mines**  
**Oil and Gas Division**  
**Charleston 25305**

**JAN 8 1986**

FINAL INSPECTION REPORT  
INSPECTORS COMPLIANCE REPORT  
February 24, 1984

COMPANY Basin Petroleum Corporation

PERMIT NO 021-2520 (1-03-75)

P. O. Box 37

FARM & WELL NO Trio Petroleum #1

Glenville, West Virginia 26351

DIST. & COUNTY Glenville/Gilmer

RULE	DESCRIPTION	IN COMPLIANCE	
		YES	NO
23.06	Notification Prior to Starting Work	_____	_____
25.04	Prepared before Drilling to Prevent Waste	_____	_____
25.03	High-Pressure Drilling	_____	_____
16.01	Required Permits at Wellsite	_____	_____
15.03	Adequate Fresh Water Casing	_____	_____
15.02	Adequate Coal Casing	_____	_____
15.01	Adequate Production Casing	_____	_____
15.04	Adequate Cement Strenght	_____	_____
15.05	Cement Type	_____	_____
23.02	Maintained Access Roads	_____	_____
25.01	Necessary Equipment to Prevent Waste	_____	_____
23.04	Reclaimed Drilling Pits	_____	_____
23.05	No Surface or Underground Pollution	_____	_____
23.07	Requirements for Production & Gathering Pipelines	_____	_____
16.01	Well Records on Site	_____	_____
16.02	Well Records Filed	_____	_____
7.05	Identification Markings	_____	_____

I HAVE INSPECTED THE ABOVE CAPTIONED WELL AND RECOMMEND THAT IT BE RELEASED:

SIGNED *Wes Moore*

DATE 1-4-86

Your well record was received and reclamation requirements approved. In accordance with Chapter 22, Article 4, Section 2, the above well will remain under bond coverage for the life of the well.

*T. H. ...*

Administrator-Oil & Gas Division

January 16, 1986

DATE

**RECEIVED**  
DEPARTMENT OF ENERGY  
OIL AND GAS



JAN 8 1986

Office of Oil and Gas  
Department of Energy  
Washington, D.C. 20585

*[Faint, mostly illegible typed text, likely a memorandum or letter body]*

*[Handwritten signature]*



**RECEIVED**  
 FEB 21 1979

OIL & GAS DIVISION  
 DEPT. OF MINES

1.0 API well number (If not available, leave blank. 14 digits.)	47-021-2520			
2.0 Type of determination being sought (Use the codes found on the front of this form.)	108 Section of NGPA		NA Category Code	
3.0 Depth of the deepest completion location (Only needed if sections 103 or 107 in 2.0 above.)	NA feet			
4.0 Name, address and code number of applicant (35 letters per line maximum. If code number not available, leave blank.)	Reserve Oil, Inc. Name 1000 Oil Center, 2601 N.W. Expressway Street Oklahoma City City		N/A Seller Code OK 73112 State Zip Code	
5.0 Location of this well (Complete (a) or (b).) (a) For onshore wells (35 letters maximum for field name)	Glenville South Field Name Gilmer County W. Virginia State			
(b) For OCS wells	Area Name _____ Block Number _____ Date of Lease Mo Day Yr _____ OCS Lease Number _____			
(c) Name and identification number of this well (35 letters and digits maximum.)	Trio #1			
(d) If code 4 or 5 in 2.0 above, name of the reservoir (35 letters maximum.)	_____			
6.0 (a) Name and code number of the purchaser (35 letters and digits maximum. If code number not available, leave blank.)	Equitable Gas Co. Name		005939 Buyer Code	
(b) Date of the contract	0,5,1,1,7,6 Mo Day Yr.			
(c) Estimated annual production:	23 MMcf.			
	(a) Base Price (\$/MMBTU)	(b) Tax	(c) All Other Prices (Indicate (+) or (-).)	(d) Total of (a), (b) and (c)
7.0 Contract price (As of filing date. Complete to 3 decimal places.)	2.264	---	0.346	2.610
8.0 Maximum lawful rate (As of filing date. Complete to 3 decimal places.)	2.264	---	0.346	2.610
9.0 Person responsible for this application:	Jerry R. Crocker Name Div. Oper. Manager Title Signature <i>Jerry R. Crocker</i> February 9, 1979 Date Application is Completed (405) 840-2911 Phone Number			

Agency Use Only
Date Received by Juris. Agency <b>FEB 21 1979</b>
Date Received by FERC

10/06/2023

9-27-79

Reserve Oil, Inc  
Equitable Gas Co.

N/A  
005939

W. Va. Department of Mines, Oil & Gas Division  
WELL DETERMINATION FILE NUMBER  
221-103-021-2520  
The Above File Number on all Communications  
Relating to Determination of this Well

revised  
Deferred for production for 12 months below 6000 ft pending  
Form 229

Deferred for 12 months production less than  
60 MCF average  
Rejected - must be J. J. Huzzey  
refilled with new production for this classification

CHECK EACH ITEM AS COMPLETE OR NOTE WHAT IS MISSING

221-103-021-2520

- 1. FEPC-171  Items not completed - Line No. \_\_\_\_\_
- 2. 17-1 - A - 17-1 E. A. Broome
- 3. 17-2 - Well Permit
- 4. 17-6 - Well Plat
- 5. 17-35 - Well Record  Drilling  Deepening \_\_\_\_\_
- 6. 17-36 - Gas-Oil Test: Gas Only  Gas Oil Ratio  \_\_\_\_\_
- 7. 17-39 - Annual Production 2 years
- 8. 17-40 - 90 day Production 86 Days on line: \_\_\_\_\_
- 9. 17-48 - Application for Certification. Complete?
- 10. 17-49 - 17 Form 51 - 52 - 53 - 54 - 55 - 56 - 57 - 58. Complete  Affidavit Signed
- 11. 17-53 - Other: Survey \_\_\_\_\_ Logs \_\_\_\_\_ Geological Charts \_\_\_\_\_ Structure Map \_\_\_\_\_
- 1:4000 Map \_\_\_\_\_ Well Tabulations \_\_\_\_\_ Gas Analyses \_\_\_\_\_
- (5) Date Completed: 3-28-75 Deepened \_\_\_\_\_  
Date Expired: 4-29-75
- (5) Production Depth: 1654-1760, 1385-1480, 2741-2755, 2755-2846, 1986-2055 (2760)
- (5) Production Formation: Sand, Sandy Blue Monday, (In Jun) SLATE & shells Fish
- (5) Final Open Flow: 1,007 MCF
- (5) Final Rock Pressure: 705 #
- (6) Other Gas Test: \_\_\_\_\_
- (7) Avg. Daily Gas from Annual Production:  $(\frac{22038}{366}) = 60.1$  MCF No. 01
- (8) Avg. Daily Gas from 90-day ending w/1-120 days  $\frac{5358}{92} = 58.2$  MCF No. 01
- (4) Mine Pressure: NA PSIG from Daily Report
- (5) Oil Productive: yes From Completion Report 1743-1752', 1947', 2741'
- (6) Does lease inventory indicate enhanced recovery being done: NO **10/06/2023**
- (7) Is affidavit signed?  Notarized?
- (8) Official Well record with the Department and/or the affected jurisdiction: yes
- (9) Information \_\_\_\_\_ Does computer program contain? \_\_\_\_\_

MK

STATE OF WEST VIRGINIA  
 DEPARTMENT - MINES  
 DIVISION - OIL AND GAS

ANNUAL REPORT OF MONTHLY PRODUCTION-1978  
 GAS VOLUMES IN MFC @ 14.73  
 OIL IN BARRELS @ 60 DEGREES  
 ID # 18  
 OPERATOR: ROI

REPORT NO. CCA101P1 PG 00002  
 CURRENT DATE - 12/19/78  
 REPORT DATE - 12/19/78

47-021 FARM 1 Tr. # 1  
 API 2520

	COUNTY: <u>Gilmer</u>		AVG. FLOW PRESSURE		SHUT-IN PRESSURE		TOTALS					
GAS MFC	0	1914	2562	1855	2128	1008	1967	1627	1159	2410	22217	
OIL BBL	J-0	F-0	M-28	A-0	M-20	J-0	J-0	A-0	S-0	0-0	0-0	48
DAYS ONLINE	0	28	31	30	31	30	31	31	30	31		

ANNUAL REPORT OF MONTHLY PRODUCTION-1979

GAS MFC	3409	2845	2521	2541	1906	1638	2435	1348	1261	2562	2341	1717	26654
OIL BBL	J-0	F-0	M-0	A-51	M-0	J-0	J-0	A-0	S-0	0-0	N-0	0-0	51
DAYS ONLINE	31	28	31	30	31	30	31	31	30	31	30	31	

243250 210701 01000

**Reviewed**  
 JUN 8 1981

Purchaser: Equitable Gas Co.  
 GPC Agreement No: 6697  
 Meter/Station No: 027375  
 Chart Code: 01000

OIL & GAS DIVISION  
 DEPT. OF MINES

24445

22191

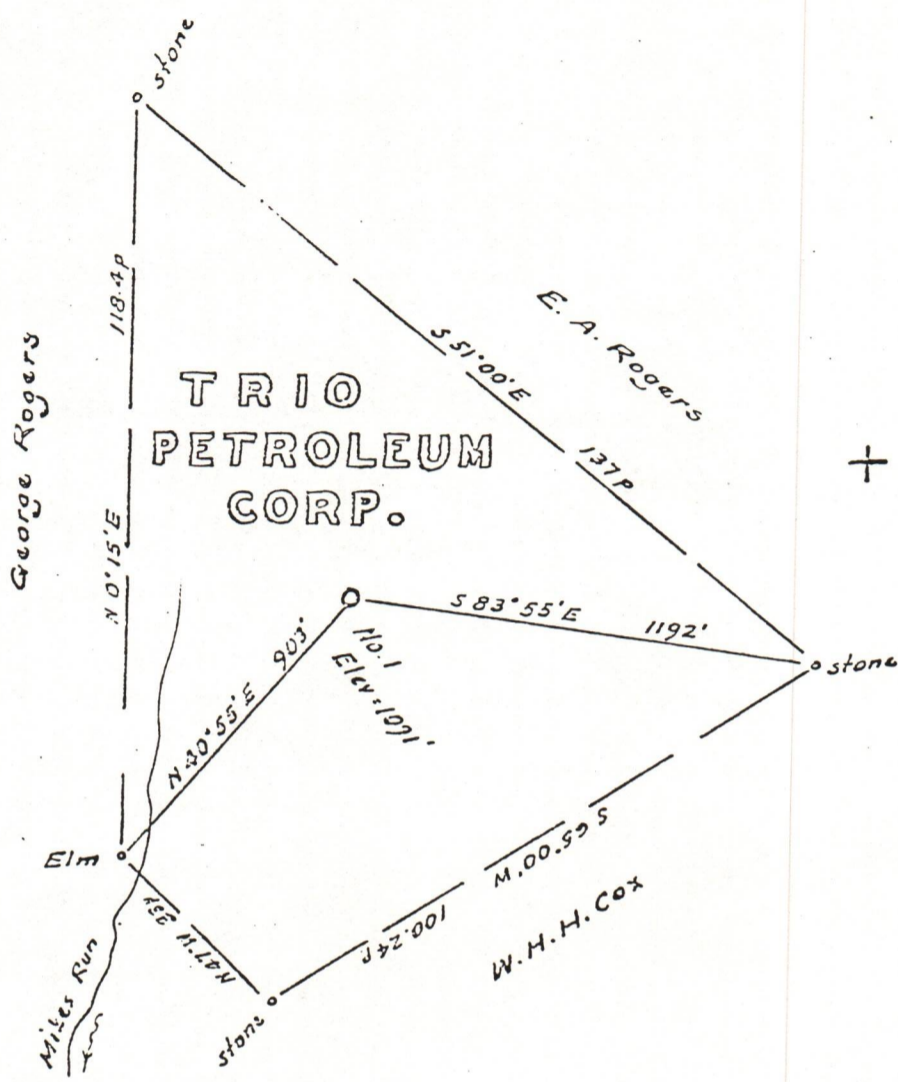

Minimum Error of Closure 1 in 200

Source of Elevation U.S.G.S. elev. at mouth of Little Ellis Run = 741'

I, the undersigned, hereby certify that this map is correct to the best of my knowledge and belief and shows all the information required by paragraph 6 of the rules and regulations of the oil and gas section of the mining laws of West Virginia.

- Fracture.....
- New Location.....
- Drill Deeper.....
- Abandonment.....

Signed: *M. H. H. Cox*  
 Squares: N S E W

Map No. \_\_\_\_\_

Company BASIN PETROLEUM CORP.

Address P.O. Box 37, Glenville, West Va.

Farm Trio Petroleum Corp.

Tract \_\_\_\_\_ Acres 50 Lease No. \_\_\_\_\_

Well (Farm) No. One Serial No. \_\_\_\_\_

Elevation (Spirit Level) 1091

Quadrangle Burnsville

County Gilmer District Glenville

Surveyor *M. H. H. Cox*

Surveyor's Registration No. 1227

File No. \_\_\_\_\_ Drawing No. \_\_\_\_\_

Date December 2, 1974 Scale 1" = 302 = 495'

STATE OF WEST VIRGINIA  
 DEPARTMENT OF MINES  
 OIL AND GAS DIVISION  
 CHARLESTON

WELL LOCATION MAP

FILE NO. Dil-2520 **10/06/2023**

+ Denotes location of well on United States Topographic Maps, scale 1 to \_\_\_\_\_, latitude and longitude lines being represented by border lines as shown.

— Denotes one inch spaces on border line of original tracing.