

Latitude 38° 50'

Longitude 80° 50'

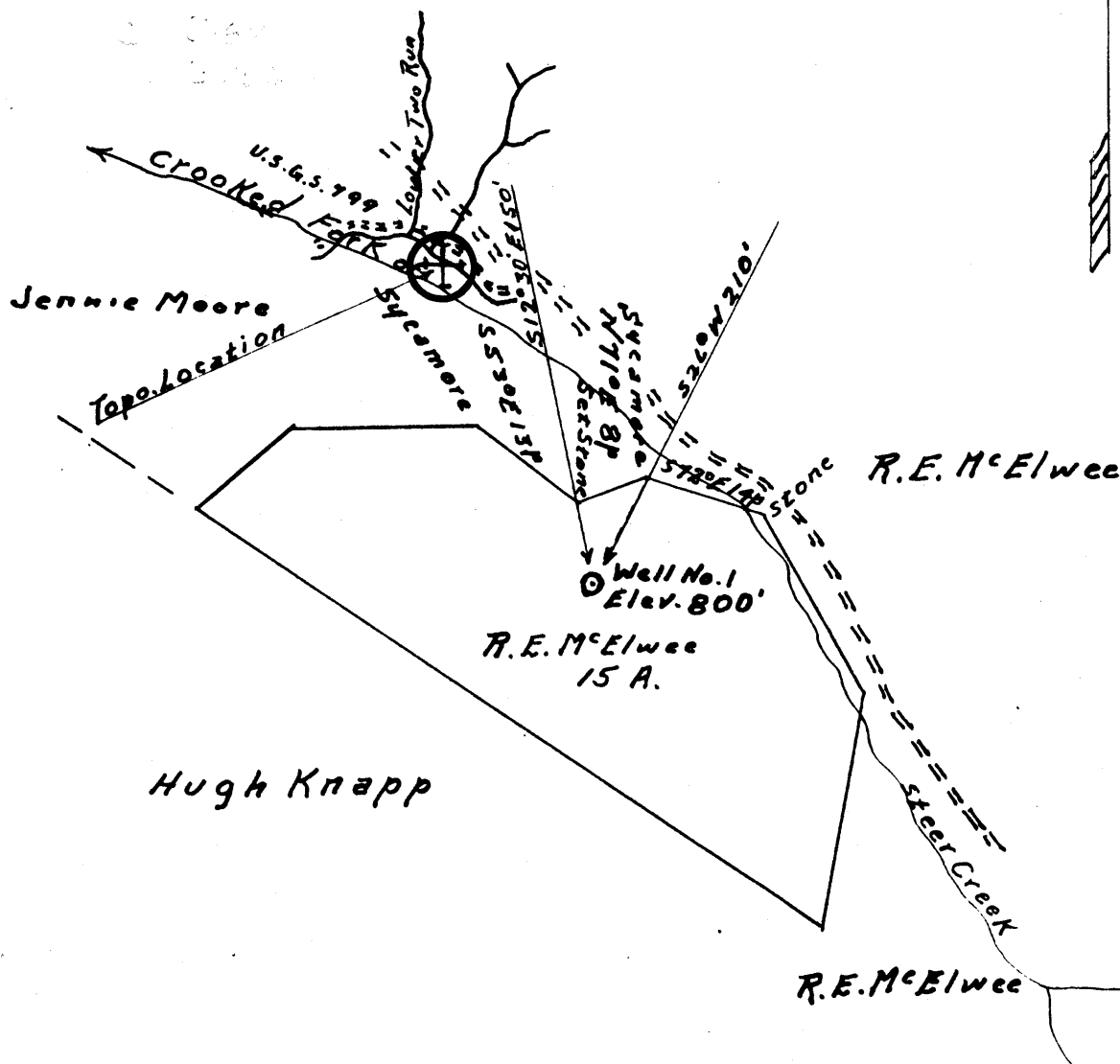

I, the undersigned, hereby certify that this map is correct to the best of my knowledge, belief and shows all the information required by paragraph 6 of the rules and regulations of the oil and gas section of the mining laws of West Virginia.

New Location
 Drill Deeper
 Abandonment

MINIMUM ERROR OF CLOSURE 1" IN 200 FEET.

Company Deo Mace
 Address Sandridge, W. Va.
 Farm R. E. McElwee
 Tract _____ Acres 15 Lease No. _____
 Well (Farm) No. 1 Serial No. _____
 Elevation (Spirit Level) 800
 Quadrangle Glenville SC
 County Gilmer District Center
 Engineer Jogan McElwee
 Engineer's Registration No. 610
 File No. _____ Drawing No. _____
 Date 6/8/63 Scale 1" = 40p

STATE OF WEST VIRGINIA
 DEPARTMENT OF MINES
 OIL AND GAS DIVISION
 CHARLESTON

WELL LOCATION MAP

FILE NO. G11-1542-C
NEVER DRILLED

+ Denotes location of well on United States Topographic Maps, scale 1 to 62,500, latitude and longitude lines being represented by border lines as shown.

- Denotes one inch spaces on border line of original tracing.

AUG 19 1976

58 50

Latitude 38° 50'

Longitude 80° 50'

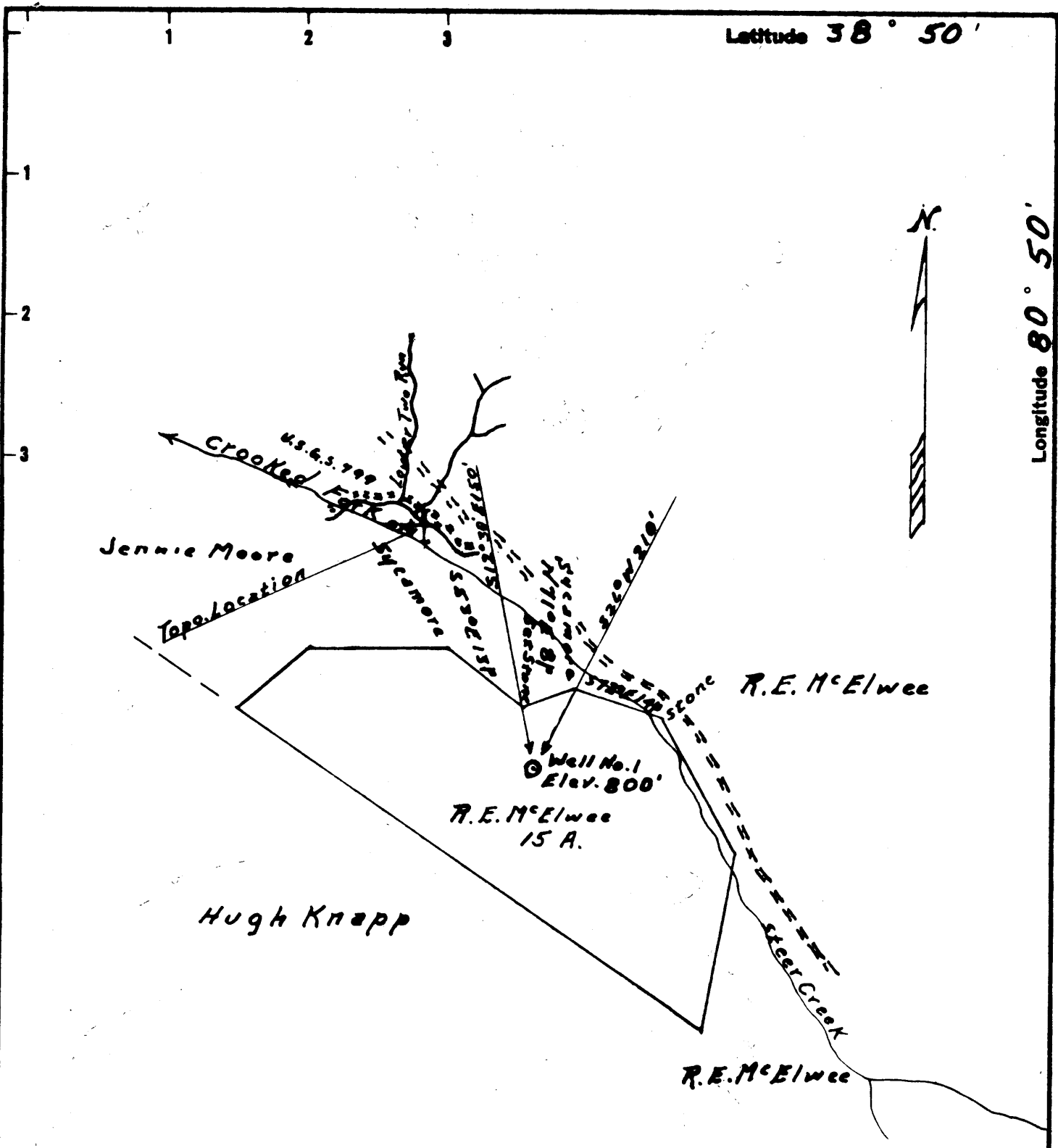

I, the undersigned, hereby certify that this map is correct to the best of my knowledge and belief and shows all the information required by paragraph 6 of the rules and regulations of the oil and gas section of the mining laws of West Virginia.

New Location
 Drill Deeper
 Abandonment

MINIMUM ERROR OF CLOSURE 1" IN 200 FEET.

Company	<u>Deo Mace</u>
Address	<u>Sandridge, W. Va.</u>
Farm	<u>R. E. McElwee</u>
Tract	Acres <u>15</u> Lease No. _____
Well (Farm) No.	<u>1</u> Serial No. _____
Elevation (Spirit Level)	<u>800</u>
Quadrangle	<u>Glennville SC</u>
County	<u>Gilmer</u> District <u>Center</u>
Engineer	<u>Fogor Mc Donnell</u>
Engineer's Registration No.	<u>610</u>
File No.	_____ Drawing No. _____
Date	<u>4/8/63</u> Scale <u>1" = 400'</u>

STATE OF WEST VIRGINIA
 DEPARTMENT OF MINES
 OIL AND GAS DIVISION
 CHARLESTON

WELL LOCATION MAP
 FILE NO. G11-1542

+ Denotes location of well on United States Topographic Maps, scale 1 to 82,500, latitude and longitude lines being represented by border lines as shown.
 - Denotes one inch spaces on border line of original tracing.