

2101035P

WW-7
8-30-06



West Virginia Department of Environmental Protection
Office of Oil and Gas
WELL LOCATION FORM: GPS

API: 47-021-01035 WELL NO.: WV 656531 (Keith #1681)

FARM NAME: James W. Keith, et al.

RESPONSIBLE PARTY NAME: EQT Production Company

COUNTY: Gilmer DISTRICT: Glenville

QUADRANGLE: Glenville 7.5'

SURFACE OWNER: Parker and Wilma Tallhamer

ROYALTY OWNER: J. W. Keith Estate, et al.

UTM GPS NORTHING: 4304789

UTM GPS EASTING: 518080 GPS ELEVATION: 318 m (1044 ft)

The Responsible Party named above has chosen to submit GPS coordinates in lieu of preparing a new well location plat for a plugging permit or assigned API number on the above well. The Office of Oil and Gas will not accept GPS coordinates that do not meet the following requirements:

- Datum: NAD 1983, Zone: 17 North, Coordinate Units: meters, Altitude: height above mean sea level (MSL) – meters.
- Accuracy to Datum – 3.05 meters
- Data Collection Method:
Survey grade GPS ; Post Processed Differential
Real-Time Differential
Mapping Grade GPS ; Post Processed Differential
Real-Time Differential
- Letter size copy of the topography map showing the well location.**

I the undersigned, hereby certify this data is correct to the best of my knowledge and belief and shows all the information required by law and the regulations issued and prescribed by the Office of Oil and Gas.

Signature

PS # 2180
Title

7/8/15
Date

RECEIVED
Office of Oil and Gas
JUL 24 2015
08/14/2015
WV Department of
Environmental Protection

Topo Quad: Glenville 7.5' Scale: 1" = 2000'
 County: Gilmer Date: July 6, 2015
 District: Glenville Project No: 25-19-00-07

47-021-01035 WV 656531 (Keith #1681)

Topo

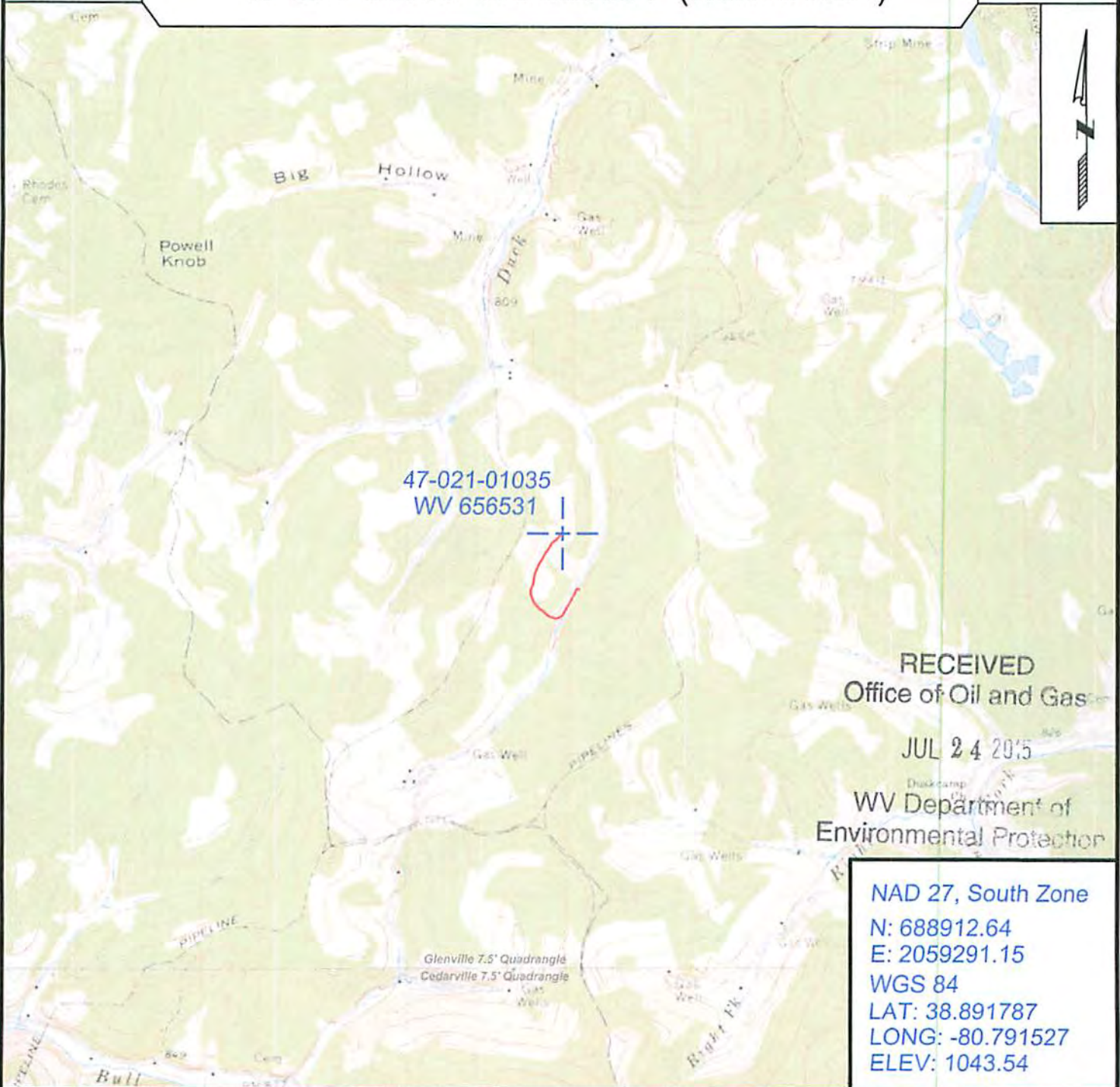

47-021-01035
WV 656531

RECEIVED
Office of Oil and Gas

JUL 24 2015

WV Department of
Environmental Protection

NAD 27, South Zone
 N: 688912.64
 E: 2059291.15
 WGS 84
 LAT: 38.891787
 LONG: -80.791527
 ELEV: 1043.54



SURVEYING AND MAPPING SERVICES PERFORMED BY:
ALLEGHENY SURVEYS, INC.

1-800-482-8606
 237 Birch River Road
 Birch River, WV 26610
 PH: (304) 649-8606
 FAX: (304) 649-8608

PREPARED FOR:

EQT Production Company

P.O. Box 280
 Bridgeport, WV 26330

08/14/2015