



---

**west virginia** department of environmental protection

---

Office of Oil and Gas  
601 57th Street SE  
Charleston, WV 25304  
(304) 926-0450  
(304) 926-0452 fax

Earl Ray Tomblin, Governor  
Randy C. Huffman, Cabinet Secretary  
www.dep.wv.gov

August 13, 2015

**WELL WORK PLUGGING PERMIT**

**Plugging**

This permit, API Well Number: 47-2100547, issued to EQT PRODUCTION COMPANY, is evidence of permission granted to perform the specified well work at the location described on the attached pages and located on the attached plat, subject to the provisions of Chapter 22 of the West Virginia Code of 1931, as amended, and all rules and regulations promulgated thereunder, and to all conditions and provisions outlined in the pages attached hereto. Notification shall be given by the operator to the Oil and Gas Inspector at least 24 hours prior to the construction of roads, locations, and/or pits for any permitted work. In addition, the well operator shall notify the same inspector 24 hours before any actual well work is commenced and prior to running and cementing casing. Spills or emergency discharges must be promptly reported by the operator to 1-800-642-3074 and to the Oil and Gas inspector.

Upon completion of the plugging well work, the above named operator will reclaim the site according to the provisions of WV Code 22-6-30. The above named operator will also file, as required in WV Code 22-6-23, an affidavit on form WR-38 by two experienced persons in the operator's employment and the Oil and Gas inspector that the work authorized under this permit was performed and a description given. Failure to abide by all statutory and regulatory provisions governing all duties and operations here under may result in suspensions or revocation of this permit and in addition may result in civil and/or criminal penalties being imposed upon the operator.

This permit will expire in two (2) years from date of issue. If there are any questions, please free to contact me at (304) 926-0499 ext. 1654.

James Martin  
Chief

Operator's Well No: 1-1571  
Farm Name: McDONALD, J. A.  
**API Well Number: 47-2100547**  
**Permit Type: Plugging**  
Date Issued: 08/13/2015

**Promoting a healthy environment.**

**08//14/2015**

## PERMIT CONDITIONS

West Virginia Code §22-6-11 allows the Office of Oil and Gas to place specific conditions upon this permit. Permit conditions have the same effect as law. Failure to adhere to the specified permit conditions may result in enforcement action.

### CONDITIONS

---

1. All pits must be lined with a minimum of 20 mil thickness synthetic liner.
2. In the event of an accident or explosion causing loss of life or serious personal injury in or about the well or while working on the well, the well operator or its contractor shall give notice, stating the particulars of the accident or explosion, to the oil and gas inspector and the Chief within twenty-four (24) hours.
3. Well work activities shall not constitute a hazard to the safety of persons.
4. This well is under a consent order and must be plugged under the terms of that agreement.

2100547A

Form WW-4 (B)  
Permit Copy  
(Rev 2/01)

Date: July 21, 2015  
Operator's Well  
Well No. 656186 (McDonald #1571)  
API Well No.: 47 021 - 00547

**STATE OF WEST VIRGINIA  
DIVISION OF ENVIRONMENTAL PROTECTION  
OFFICE OF OIL AND GAS**

**APPLICATION FOR A PERMIT TO PLUG AND ABANDON**

4) Well Type: Oil \_\_\_\_\_ Gas X Liquid Injection \_\_\_\_\_ Waste Disposal:  
If Gas, Production \_\_\_\_\_ X Or Underground storage \_\_\_\_\_ Deep \_\_\_\_\_ Shallow X

5) Elevation: 1105 ft. Watershed: Paddy Run  
Location: Center County: Gilmer Quadrangle: Tanner  
District: \_\_\_\_\_

6) Well Operator EQT Production Company  
120 Professional Place  
Address: Bridgeport, WV 26330

7) Designated Agent: Rex C. Ray  
Address: 120 Professional Place  
Bridgeport, WV 26330

8) Oil & Gas Danny Mullins  
Name: 124 Big Trace Fork Road  
Address: Harts, WV 25524

9) Plugging Contractor:  
Name: HydroCarbon Well Service  
Address: PO BOX 995  
Buckhannon, WV 26201

10) Work Order: The work order for the manner of plugging this well is as follows:  
**See Attachment for details and procedures.**

**OFFICE USE ONLY**

Notification must be given to the district oil and gas inspector 24 hours before permitted work can commence.

Work order approved by inspector

Danny Mullins

Date

7-24-15

08/14/2015

## PLUGGING PROGNOSIS - Weston

**McDonald, J.A # 1571 (656186)**

Gilmer, County, WV  
 API # 47-021-00547-D  
 Center District

BY: Craig Duckworth  
 DATE: 2/6/14

**CURRENT STATUS:**

10" csg @ 180'  
 8 1/4" csg @ 1019'  
 6 5/8" csg @ 1776' (packer @ 1655')  
 4 1/2" csg @ 1961' (25 sks cement)

TD @ 1961'

Fresh Water @ 155' & 670'      Salt Water @ None reported  
 1" Salt Sand @ 1352'      Coal @ None reported  
 Gas shows @ 670', 1749'-1774 Blue Monday, 1888'-1894' & 1917'-1926' Big Injum,  
 Oil Shows @ 670'  
 Stimulation: Perfs. 1907'- 1912' & 1916'- 1924'  
 Elevation @ 1100'

1. Notify State Inspector, Danny Mullins, 304-932-6844, 24 hrs. Prior to commencing operations.
2. TIH w/ tbg @ 1961'; Set 261' C1A Cement Plug @ 1961' to 1700' ( Gas shows @ 1749'-1774 Blue Monday, 1888'-1894' & 1917'-1926' Big Injum)
3. TOOH w/ tbg & Attempt to pull 4 1/2" if unable to pull free point and cut at free point.
4. TOOH w/ tbg @ 1700'; gel hole @ 1700' to 1600'
5. TIH w/tbg @ 4 1/2" csg cut; Set 100' C1A Cement Plug @ 1600' to 1500' (4 1/2" csg)
6. Set a 100' C1A Cement Plug 50' In/Out of cut. Perf. All FW, Coal, Oil and Gas shows below 4 1/2" cut. Do not omit any plugs
7. TOOH w/ 4 1/2" csg & Attempt to pull 6 5/8" if unable to pull free point and cut at free point.
8. Set a 100' C1A Cement Plug 50' In/Out of cut. Perf. All FW, Coal, Oil and Gas shows below 6 5/8" cut. Do not omit any plugs.
9. TIH w/tbg @ 1400'; Set 148' C1A Cement Plug @ 1400' to 1252' (6 5/8" csg @ 1776' & Salt Sand @ 1352'.
10. TOOH w/ tbg @ 1252'; gel hole @ 1252' to 1100'.
11. TOOH w/ tbg @ 1100'; Set 200' C1A Cement Plug @ 1100' to 900' (Elevation @ 1100' & 8 1/4" csg @ 1019'
12. Set a 100' C1A Cement Plug 50' In/Out of cut. Perf. All FW, Coal, Oil and Gas shows below 8 1/4" cut do not omit any plugs
13. TOOH w/ tbg @ 900'; gel hole @ 900' to 670'
14. TOOH w/ tbg @ 670'; Set 100' C1A Cement Plug @ 670' to 570' (Fresh Water @ 670')
15. TOOH w/ tbg @ 570'; gel hole @ 570' to 230'
16. TOOH w/ tbg @ 230'; Set 230' C1A Cement Plug @ 230' to Surface (10" csg @ 180')
17. Top off as needed
18. Set Monument to WV-DEP Specifications
19. Reclaim Location & Road to WV-DEP Specifications

Quadrangle Glenville N. W.

**WELL RECORD**

Permit No. Oil-547 Drill Deeper

Oil or Gas Well Gas

Company Carnegie Natural Gas Company,  
 Address 3904 Main Street, Munhall, Pa.  
 Farm J. A. McDonald Acres 65  
 Location (waters) Paddys Run  
 Well No. 1-1571 Elev. 1100  
 District Center County Gilmer  
 The surface of tract is owned in fee by \_\_\_\_\_  
 Address \_\_\_\_\_  
 Mineral rights are owned by \_\_\_\_\_  
 Address \_\_\_\_\_  
 Drilling commenced Deeper June 25, 1963  
 Drilling completed Deeper July 5, 1963  
 Date Shot \_\_\_\_\_ From \_\_\_\_\_ To \_\_\_\_\_  
 With \_\_\_\_\_  
 Open Flow /10ths Water in \_\_\_\_\_ Inch  
 /10ths Merc. in \_\_\_\_\_ Inch  
 Volume 25,830 Cu. Ft.  
 Rock Pressure 100 lbs. \_\_\_\_\_ hrs.  
 Oil \_\_\_\_\_ bbls., 1st 24 hrs.  
 WELL ACIDIZED \_\_\_\_\_

Casing and Tubing	Used in Drilling	Left in Well	Packers
Size			Kind of Packer
16			
13			Size of
10			
8 1/2			Depth set
6 1/2			
5 3/16			Perf. top <u>1907'</u>
<del>4 1/2</del>	<u>1961</u>	<u>1961</u>	Perf. bottom <u>1912'</u>
2			Perf. top <u>1916'</u>
Liners Used			Perf. bottom <u>1924'</u>

CASING CEMENTED 4 1/2 SIZE No. Ft. \_\_\_\_\_ Date \_\_\_\_\_  
25 bags of cement  
 COAL WAS ENCOUNTERED AT \_\_\_\_\_ FEET \_\_\_\_\_ INCHES  
 \_\_\_\_\_ FEET \_\_\_\_\_ INCHES FEET \_\_\_\_\_ INCHES  
 \_\_\_\_\_ FEET \_\_\_\_\_ INCHES FEET \_\_\_\_\_ INCHES

WELL FRACTURED July 25, 1963 - 30,000# of sand and 702 bbls. of water

RESULT AFTER TREATMENT 600,000 cu. ft.

ROCK PRESSURE AFTER TREATMENT 450#

Fresh Water \_\_\_\_\_ Feet Salt Water \_\_\_\_\_ Feet

Formation	Color	Hard or Soft	Top	Bottom	Oil, Gas or Water	Depth	Remarks
Lime	Gray	Hard	1776	1837	Gas 8,000 cu. ft. Gas 1917-26' Increased to 25,830 cu. ft.	1888-94'	Big Lime Big Injun Sand
Sand	Gray	Hard	1837	1926			
Slate	Dark	Soft	1926				
Total Depth				1946			
Steel Line Measurements at			1776'	- 1930'			
Commenced drilling deeper at			1776'				

RECEIVED  
 Office of Oil and Gas  
 JUL 24 1963

RECEIVED  
 West Virginia  
 Dept. of Mines



Company Carnegie Natural Gas Company  
 Address 1014 Frick Bldg., Pittsburgh, Pa.  
 Farm J. A. McDonald Acres 65  
 Location (waters) Paddy's Run  
 J No. 1 - 1571 Elev. 1100  
 District Center County Gilmer  
 The surface of tract is owned in fee by OTHA KRIER,  
 Address ALLISON, W. VA.  
 Mineral rights are owned by MINNIE McDONALD, BLANCHE  
McDONALD & OPRA DOBBINS Address GLENNVILLE, W. VA.  
 Drilling commenced June 6th 1942  
 Drilling completed July 3rd 1942  
 Date shot \_\_\_\_\_ Depth of shot \_\_\_\_\_  
 Open Flow \_\_\_\_\_ /10ths Water in \_\_\_\_\_ Inch  
20 /10ths Merc. in 5 Inch  
 Volume 1,565,000 Cu. Ft.  
 Rock Pressure 585 lbs. 72 hrs.  
 Oil \_\_\_\_\_ bbls., 1st 24 hrs.  
 Fresh water 155 feet 670 feet  
 Salt water \_\_\_\_\_ feet \_\_\_\_\_ feet

Casing and Tubing	Used in Drilling	Left in Well	Packers
Size			
16			Kind of Packer
19			<u>Anchor</u>
10	<u>180</u>	<u>180</u>	Size of <u>6 5/8" x 8 1/2"</u>
8 3/4	<u>1019</u>	<u>1019</u>	
6 5/8	<u>1776</u>	<u>1776</u>	Depth set <u>1655</u>
6 3/16			
3			Perf. top <u>1666</u>
2			Perf. bottom <u>1676</u>
Liners Used			Perf. top <u>1749</u>
			Perf. bottom <u>1775</u>

CASING CEMENTED \_\_\_\_\_ SIZE \_\_\_\_\_ No. FT. \_\_\_\_\_ Date \_\_\_\_\_  
 COAL WAS ENCOUNTERED AT \_\_\_\_\_ FEET \_\_\_\_\_ INCHES  
 \_\_\_\_\_ FEET \_\_\_\_\_ INCHES FEET \_\_\_\_\_ INCHES  
 \_\_\_\_\_ FEET \_\_\_\_\_ INCHES FEET \_\_\_\_\_ INCHES

Formation	Color	Hard or Soft	Top	Bottom	Oil Gas or Water	Depth Found	Remarks
Clay	Red	Soft	0	10			
Sand	Yellow	Soft	10	30			
Clay	Blue	Soft	30	50			
Lime	Gray	Hard	50	70			
Red Rock	Red	Soft	70	75			
Lime	Gray	Hard	75	108			
Red Rock	Red	Soft	108	155			
Sand	Gray	Hard	155	180	Water	155	Fresh
Red Rock	Red	Soft	180	200			
Slate	Black	Soft	200	250			
Red Rock	Red	Soft	250	345			
Lime	Gray	Hard	345	358			
Red Rock	Red	Soft	358	433			
Lime	Blue	Hard	433	444			
Red Rock	Red	Soft	444	478			
Shells	Gray	Hard	478	660	Water	670	
Sand	White	Soft	660	682	Oil	670 Show	
Slate	Black	Soft	682	683	Gas	670 Show	
Sand	White	Soft	683	700			
Slate	Black	Soft	700	727			
Sand	White	Hard	727	742			
Slate Shls.	White	Medium	742	800			
Sand	White	Hard	800	875			Little Dunkard
Slate	White	Soft	875	930			
Sand	Gray	Hard	930	985			Big Dunkard
Slate	Black	Soft	985	1005			
Sand	White	Hard	1005	1059			Gas Sand
Slate	Gray	Soft	1059	1128			
Sand	White	Hard	1128	1352			1st Salt Sand
Slate	White	Soft	1352	1368			
Sand	Dark	Hard	1368	1388			2nd Salt Sand
Slate Shells	Dark	Medium	1388	1425			
Sand	White	Hard	1425	1445			3rd Salt Sand
Slate Shells	Dark	Medium	1445	1475			
Lime	Dark	Hard	1475	1508			
Slate	Dark	Soft	1508	1513			
Lime	Dark	Hard	1513	1531			
Sand	White	Hard	1531	1570			

RECEIVED  
 Office of Oil and Gas  
 JUL 24 1942  
 Wv Department of  
 Environmental Protection



08/14/2015

Sand  
Line

White  
White

Hard  
Hard

1748  
1775

1770  
1775

Gas 1749-74'  
20/10 Mercury in 3"  
1,565,000 Cu ft.  
16/10 Mercury in 3"  
1,400,000 Cu ft. When shut in.

Blue Monday

Total Depth

1776

Steel Line Measurements at 675' 1019' - 1305' - 1668' - 1750' - 1775'

RECEIVED  
Office of Oil and Gas

JUL 24 1985

WV Department of  
Environmental Protection

08/14/2015





WW-4-A  
Revised 6/07

1) Date: July 21, 2015  
2) Operator's Well Number  
666186 (McDonald #1571)  
3) API Well No.: 47 021 - 00547  
State County Permit

**STATE OF WEST VIRGINIA - BUREAU OF ENVIRONMENT  
DIVISION OF ENVIRONMENTAL PROTECTION, OFFICE OF OIL & GAS  
NOTICE AND APPLICATION TO PLUG AND ABANDON WELL**

4) Surface Owner(s) to be served:  
(a) Name Danny Hayward Furr  
Address 3913 Lower Cedar Creek Rd.  
Glenville, WV 26351  
(b) Name \_\_\_\_\_  
Address \_\_\_\_\_  
(c) Name \_\_\_\_\_  
Address \_\_\_\_\_

5) (a) Coal Operator:  
Name None  
Address \_\_\_\_\_

(b) Coal Owner(s) with Declaration  
Name Danny Hayward Furr  
Address 3913 Lower Cedar Creek Rd.  
Glenville, WV 26351

Name \_\_\_\_\_  
Address \_\_\_\_\_

6) Inspector  
Address Danny Mullins  
124 Big Trace Fork Road  
Harts, WV 25524  
Telephone (304) 932-6844  
1. Danny Mullins  
220 Jack Acres  
Buckhannon WV  
932-6844

(c) Coal Lessee with Declaration  
Name None  
Address \_\_\_\_\_

**TO THE PERSONS NAMED ABOVE:** You should have received this Form and the following documents:

- (1) The application to Plug and Abandon a Well on Form WW-4B, which sets out the parties involved in the work and describes the well its and the plugging work order, and
  - (2) The plat (surveyor's map) showing the well location on Form WW-6.
- The reason you received these documents is that you have rights regarding the application which are summarized in the instructions on the reverses side. However, you are not required to take any action at all.

Take notice that under Chapter 22-6 of the West Virginia Code, the undersigned well operator proposes to file or has filed this Notice and Application and accompanying documents for a permit to plug and abandon a well with the Chief of the Office of Oil and Gas, West Virginia Division of Environmental Protection, with respect to the well at the location described on the attached Application and depicted on the attached Form WW-6. Copies of this Notice, the Application, and the plat have been mailed by registered or certified mail or delivered by hand to the person(s) named above (or by publication in certain circumstances) on or before the day of mailing or delivery to the Chief.

Well Operator: EQT Production Company  
By: Victoria J. Roark  
Its: Permitting Supervisor  
Address: PO Box 280  
Bridgeport, WV 26330  
Telephone: (304) 848-0076

Subscribed and sworn before me this 21<sup>st</sup> day of July, 2015  
My Commission Expires: 2/20/18  
Misty S. Christie Notary Public

The Office of Oil & Gas processes your personal information, such as name, address and phone number, as part of our regulatory duties. Your personal information may be disclosed to other State agencies or third parties in the normal course of business or as needed to comply with statutory or regulatory requirements, including Freedom of Information Act requests. Our office will appropriately secure your personal information. If you have any questions about our use of your personal information, please contact DEP's Chief Privacy Officer at [depprivacyofficer@wv.gov](mailto:depprivacyofficer@wv.gov).

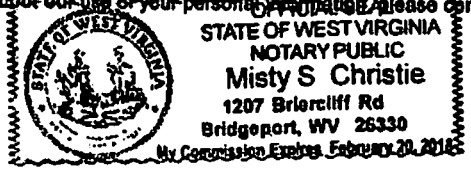

WW-9  
Revised 2/03

Page \_\_\_\_ of \_\_\_\_  
2) Operator's Well Number  
656186 (McDonald #1571)  
3) API Well No.: 47 021 - 00547

STATE OF WEST VIRGINIA  
DEPARTMENT OF ENVIRONMENTAL PROTECTION, OFFICE OF OIL & GAS  
CONSTRUCTION AND RECLAMATION PLAN AND SITE REGISTRATION APPLICATION FORM  
GENERAL PERMIT FOR OIL AND GAS PIT WASTE DISCHARGE

Operator Name: EQT PRODUCTION COMPANY OP ID: \_\_\_\_\_  
Watershed: Paddy Run Quadrangle: Tanner  
Elevation: 1105 ft. County: Gilmer District: Center

Description of anticipated Pit Waste: Formation Fluids

Do you anticipate using more than 5,000 bbls of water to complete the proposed well work? Yes \_\_\_ No X  
Will synthetic liner be used in the pit? Yes Is so, what ml.? 20ml - 10 ml

Proposed Disposal Method for Treated Pit Wastes:  
X Land Application  
\_\_\_\_ Underground Injection - UIC Permit Number \_\_\_\_\_  
\_\_\_\_ Reuse (at API Number) \_\_\_\_\_  
\_\_\_\_ Offsite Disposal Permit #. \_\_\_\_\_  
\_\_\_\_ Other: Explain \_\_\_\_\_

Drilling medium anticipated for this well? Air, freshwater, oil based, etc. \_\_\_\_\_  
If oil based, what type? Synthetic, petroleum, etc. \_\_\_\_\_  
Additives to be used? \_\_\_\_\_

Will closed loop system be used? \_\_\_\_\_  
Drill Cuttings disposal method? Leave in pit, landfill, remove offsite, etc. \_\_\_\_\_  
If left in pit and plan to solidify what medium will be used? Cement, Lime, sawdust \_\_\_\_\_  
Landfill or offsite name/permit number? \_\_\_\_\_

I certify that I understand and agree to the terms and conditions of the GENERAL WATER POLLUTION PERMIT issued on August 1, 2005, by the Office of Oil and Gas of the West Virginia Division of Environmental Protection. I understand that the provisions of the permit are enforceable by law. Violations of any terms or condition of the general permit and/or other applicable law or regulation can lead to enforcement action.  
I certify under penalty of law that I have personally examined and am familiar with the information submitted on this application form and all attachments thereto and that, based on my inquiry of those individuals immediately responsible for obtaining the information, I believe that the information is true, accurate and complete. I am aware that there are significant penalties for submitting false information, including the possibility of fine or imprisonment.

Company Official Signature *Victoria Roark*  
Company Official (Typed or Printed) Victoria Roark  
Company Official Title Permitting Supervisor-WV

Subscribed and sworn before me this 21st day of July, 2015  
*Misty S. Christie* Notary Public  
My Commission Expires 2/20/18

RECEIVED  
Office of Oil and Gas  
JUL 24 2015

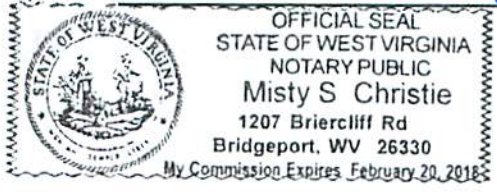

WV Department of Environmental Protection  
08/14/2015

**OPERATOR'S WELL NO.:**  
856186 (McDonald #1571)

**LEGEND**

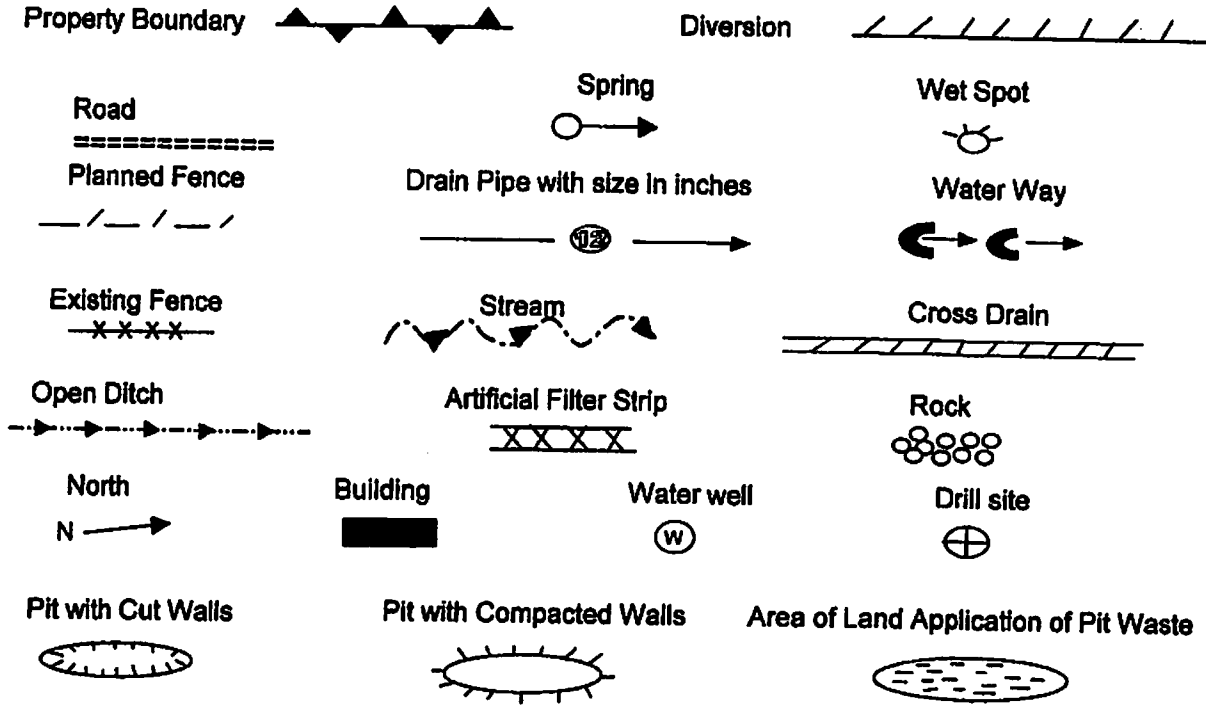

Proposed Revegetation Treatment: Acres Disturbed: 1± Prevegetation pH \_\_\_\_\_

Lime 3 Tons/acre or to correct to pH 6.5

Fertilizer (10-20-20) or equivalent 1/3 ton lbs/acre (500 lbs minimum)

Mulch 2 Tons/acre or hydroseed.

**SEED MIXTURES**

Area I		Area II	
Seed Type	lbs/acre	Seed Type	lbs/acre
Red Fescue	40	Red Fescue	15
Alsike Clover	5	Alsike Clover	5
Annual Rye	15		

**ATTACH:**

Drawing(s) of road, location, pit and proposed area for land application.  
 Photocopies section of involved 7.5' topographic sheet.

Plan approved by: \_\_\_\_\_

Comments: \_\_\_\_\_

Title: \_\_\_\_\_ Date: \_\_\_\_\_

Field Reviewed?        Yes        No



Topo Quad: Tanner 7.5' Scale: 1" = 2000'  
 County: Gilmer Date: July 2, 2015  
 District: Center Project No: 25-19-00-07

47-021-00547 WV 656186 (McDonald #1571)

Topo

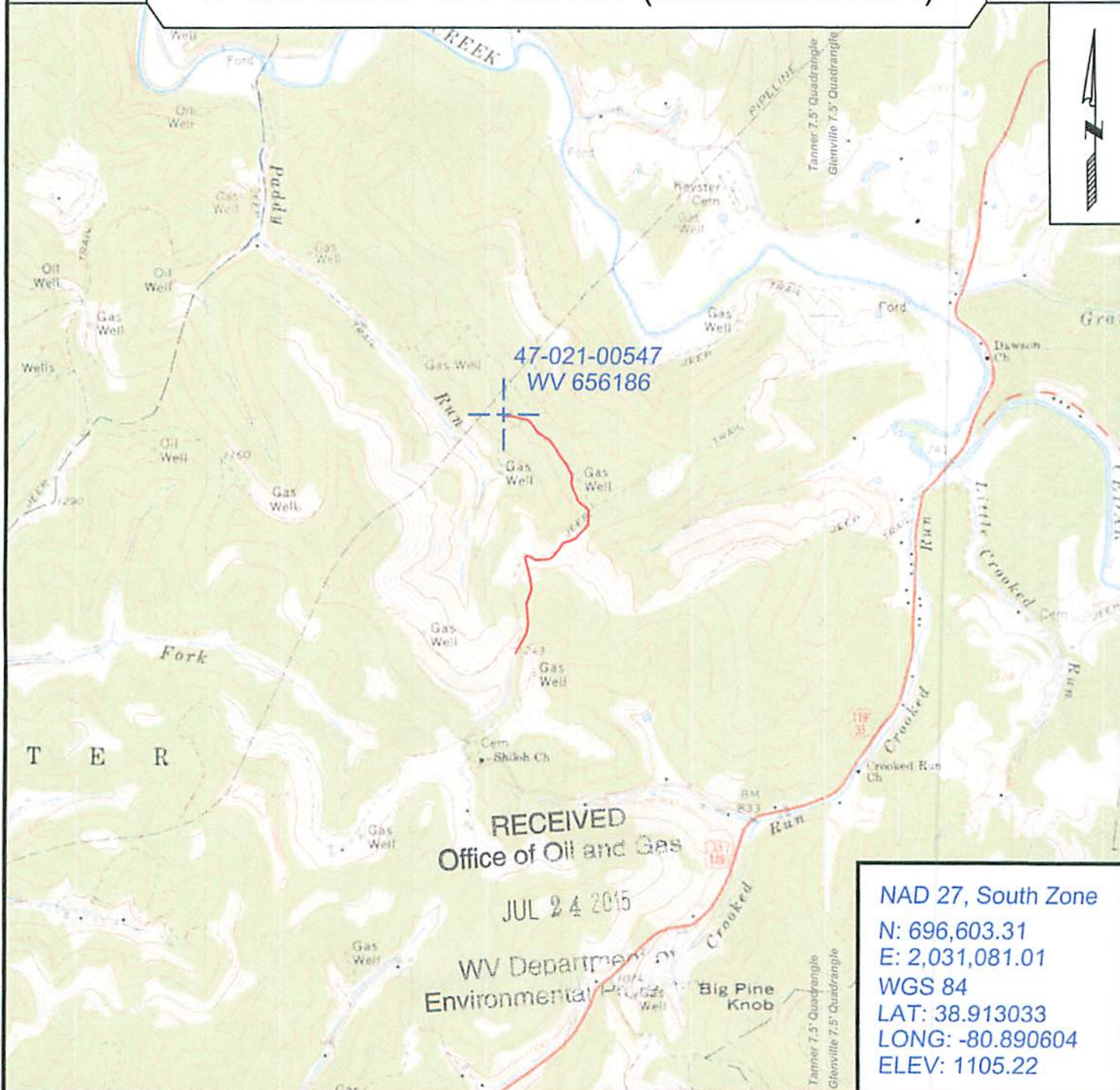

RECEIVED  
Office of Oil and Gas

JUL 24 2015

WV Department of  
Environmental Protection

NAD 27, South Zone  
 N: 696,603.31  
 E: 2,031,081.01  
 WGS 84  
 LAT: 38.913033  
 LONG: -80.890604  
 ELEV: 1105.22



SURVEYING AND MAPPING SERVICES PERFORMED BY:

**ALLEGHENY SURVEYS, INC.**

1-800-482-8606  
 237 Birch River Road  
 Birch River, WV 26610  
 PH: (304) 649-8606  
 FAX: (304) 649-8608

PREPARED FOR:

**EQT Production Company**

P.O. Box 280  
 Bridgeport, WV 26330

08/14/2015

2100547P

WW-7  
8-30-06



West Virginia Department of Environmental Protection  
Office of Oil and Gas  
**WELL LOCATION FORM: GPS**

API: 47-021-00547 WELL NO.: WV 656186 (McDonald #1571)

FARM NAME: J. A. McDonald

RESPONSIBLE PARTY NAME: EQT Production Company

COUNTY: Gilmer DISTRICT: Center

QUADRANGLE: Tanner 7.5'

SURFACE OWNER: Danny Hayward Furr

ROYALTY OWNER: Marjorie O. Dobbins, et al.

UTM GPS NORTHING: 4307132

UTM GPS EASTING: 509484 GPS ELEVATION: 337 m (1105 ft)

The Responsible Party named above has chosen to submit GPS coordinates in lieu of preparing a new well location plat for a plugging permit or assigned API number on the above well. The Office of Oil and Gas will not accept GPS coordinates that do not meet the following requirements:

- Datum: NAD 1983, Zone: 17 North, Coordinate Units: meters, Altitude: height above mean sea level (MSL) – meters.
- Accuracy to Datum – 3.05 meters
- Data Collection Method:  
Survey grade GPS     : Post Processed Differential       
Real-Time Differential       
Mapping Grade GPS X: Post Processed Differential X  
Real-Time Differential

4. Letter size copy of the topography map showing the well location.

I the undersigned, hereby certify this data is correct to the best of my knowledge and belief and shows all the information required by law and the regulations issued and prescribed by the Office of Oil and Gas.

RECEIVED  
Office of Oil and Gas

*Steph O'Brien*  
Signature

PS#2180  
Title

7/9/15  
Date

JUL 14 2015

08/14/2015





### POTENTIAL WATER SAMPLE DATA SHEET

**CLIENT:** EQT PRODUCTION COMPANY  
**LEASE NAME AND WELL No.** McDonald #1571 - WV 656186 - API No. 47-021-00547

#### POTENTIAL SAMPLE LOCATIONS

There appears to be no known water samples within the required 1000' of the existing well WV 656186.

**RECEIVED**  
Office of Oil and Gas  
JUL 24 2015

**BIRCH RIVER OFFICE**  
237 Birch River Road  
Birch River, WV 26610  
*phone:* 304-649-8606  
*fax:* 304-649-8608

**BRIDGEPORT OFFICE**  
172 Thompson Drive  
Bridgeport, WV 26330  
*phone:* 304-848-5035  
*fax:* 304-848-5037

**ALUM CREEK OFFICE**  
PO Box 108 • 1413 Childress Rd  
Alum Creek, WV 25003  
*phone:* 304-756-2949  
*fax:* 304-756-2948

**WV Department of**  
Environmental Protection  
RANSON OFFICE  
South Fairfax Blvd, Suite 3  
Ranson, WV 25438  
*phone:* 304-724-5008  
*fax:* 304-724-5010



2100547A

Topo Quad: Tanner 7.5'

Scale: 1" = 2000'

County: Gilmer

Date: July 2, 2015

District: Center

Project No: 25-19-00-07

Water

47-021-00547 WV 656186 (McDonald #1571)

No Potential Water Samples within 1000'

47-021-00547  
WV 656186



RECEIVED  
Office of Oil and Gas

JUL 24 2015

WV Department  
Environmental Protection

NAD 27, South Zone  
N: 696,603.31  
E: 2,031,081.01  
WGS 84  
LAT: 38.913033  
LONG: -80.890604  
ELEV: 1105.22



SURVEYING AND MAPPING SERVICES PERFORMED BY:  
**ALLEGHENY SURVEYS, INC.**  
1-800-482-8606  
237 Birch River Road  
Birch River, WV 26610  
PH: (304) 649-8606  
FAX: (304) 649-8608

PREPARED FOR:  
**EQT Production Company**  
P.O. Box 280  
Bridgeport, WV 26330

08/14/2015