

2100471P

Topo Quad: Auburn 7.5'

Scale: 1" = 2000'

County: Gilmer

Date: March 5, 2014

District: Troy

Project No: 25-19-00-07

47-021-00471 WV 158271 (B. S. Messenger #3)

Topo

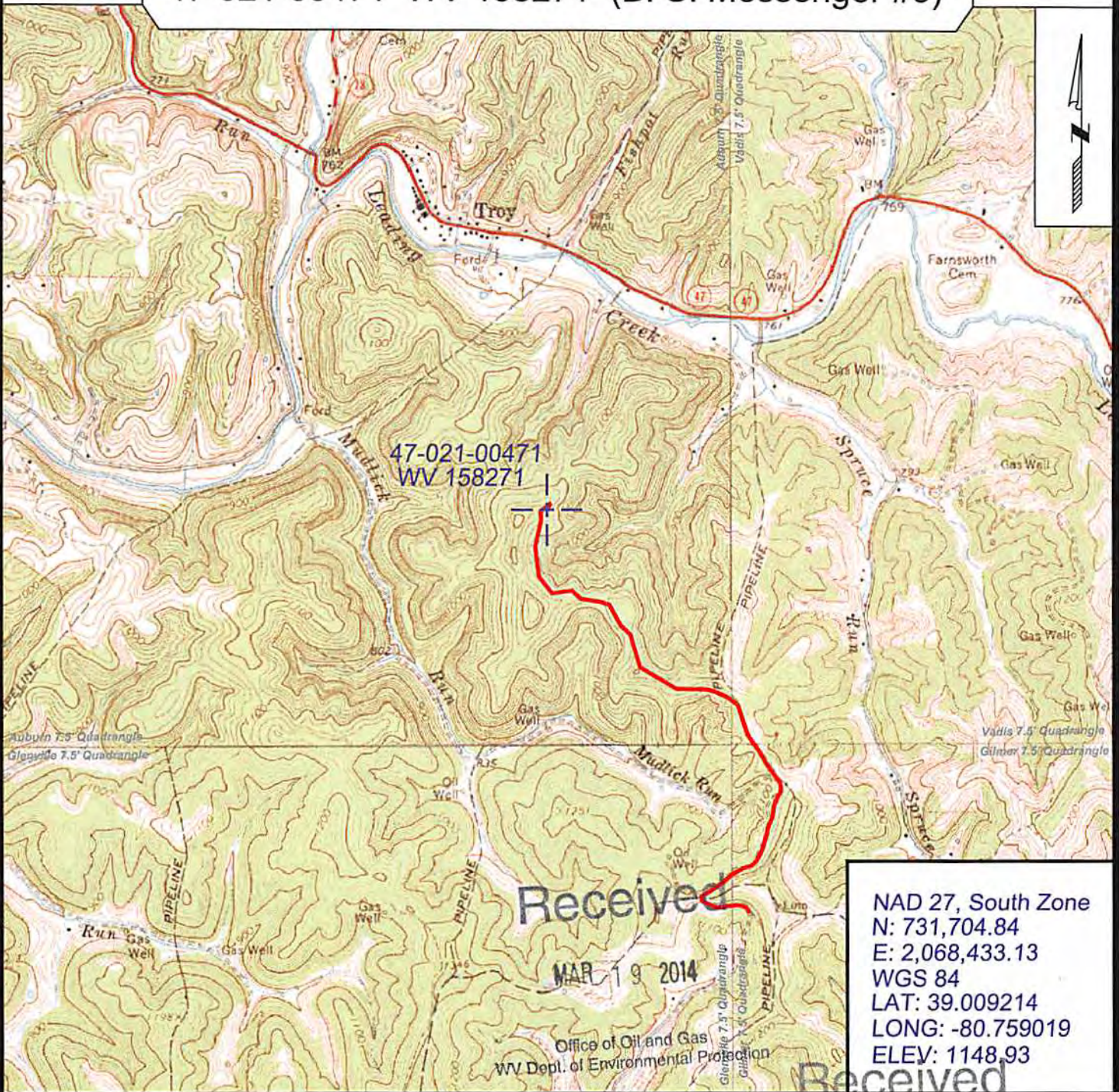

NAD 27, South Zone
 N: 731,704.84
 E: 2,068,433.13
 WGS 84
 LAT: 39.009214
 LONG: -80.759019
 ELEV: 1148.93

MAR 19 2014

Office of Oil and Gas
WV Dept. of Environmental Protection



SURVEYING AND MAPPING SERVICES PERFORMED BY:
ALLEGHENY SURVEYS, INC.

1-800-482-8606
 P.O. BOX 438
 BIRCH RIVER, WV 26610
 PH: (304) 649-8606
 FAX: (304) 649-8608

PREPARED FOR:

EQT Production Company

P.O. Box 280
 Bridgeport, WV 26330
 Office of Oil and Gas
 WV Dept. of Environmental Protection