

+ Topo Loc.

NOTE:
Topographic Sheet Slightly in error in vicinity of location

Feb. 1947

Magnetic Meridian

MUTTALL HEIRS

MUTTALL HEIRS
PORTION OF ALDERSON
693A.

Longitude 81 00

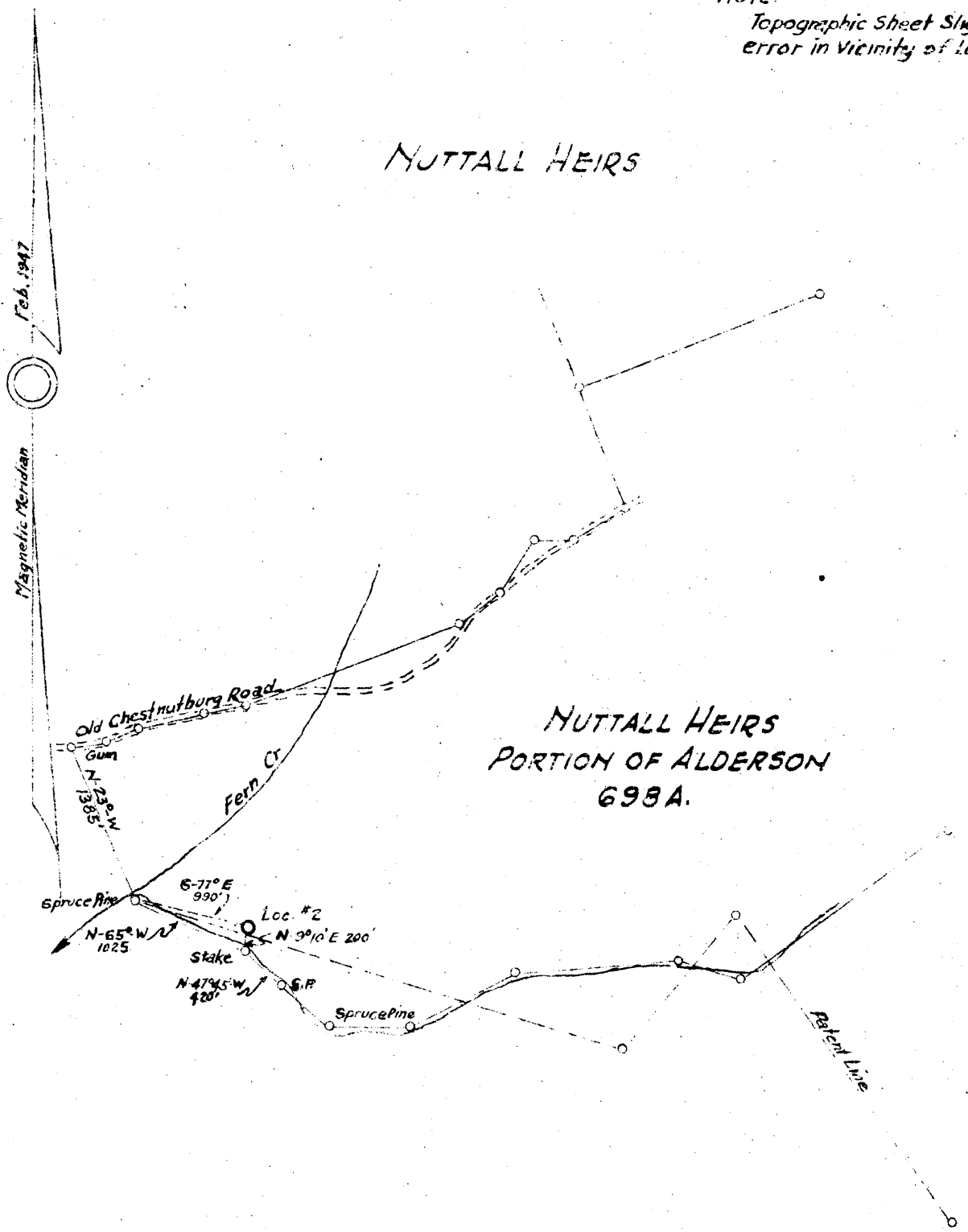

MUTTALL HEIRS

.475
1/3W

New Location X
Drill Deeper
Abandonment

Company COLUMBIAN CARBON CO.
 Address BOX 873 CHARLESTON W.VA.
 Farm MUTTALL HEIRS
 Tract 96 Acres 693 Lease No. C-2831
 Well (Farm) No. 2 Serial No. _____
 Elevation (Spirit Level) 1940
 Quadrangle FAYETTEVILLE-7-043-130 SE
 County FAYETTE District MUTTALL
 Engineer C.A. Crankam
 Engineer's Registration No. 683
 File No. _____ Drawing No. _____
 Date 2/20/47 Scale 1" = 1320'

STATE OF WEST VIRGINIA
DEPARTMENT OF MINES
OIL AND GAS DIVISION
CHARLESTON

WELL LOCATION MAP
FILE NO. FAY-63

+ Denotes location of well on United States Topographic Maps, scale 1 to 62,500, latitude and longitude lines being represented by border lines as shown.

- Denotes one inch spaces on border line of original tracing.

1-0 V

WEST VIRGINIA DEPARTMENT OF MINES
OIL & GAS DIVISION
W E L L R E C O R D

Permit No. Fay 63
Fayetteville Quad.

Dry Hole
CASING & TUBING

Company	Columbian Carbon Company
Address	Box 873, Charleston 23, W.Va. 18 9'2 9'2
Farm	Nuttall Heirs Acres 26,600 13 3/8 48# 420'2 Pld.
Location	Fern Creek 10 1/2 40# 1320'3 Pld.
Well No.	2 GW 943 Elev. 1940' G 8 1/2 2022'2 Same
District	Mt. Cove Fayette County
Surface	John Nuttall lll, 3226 Curlew St. Coal at 366' 48" San Diego, Calif. 205' 36"
Mineral	Maryland New River Coal Co. Winona, W.Va.
Commenced	3-14-47
Completed	7-11-47
Not shot	
Volume	Dry Hole
Fresh Water	120' 1-16" blr. per hr.; 171' 2-16" blr. per hr. 180' H.F.; 443' H.F.; 575' 7-13" blr. hr.

Sand	0	90	Lime	1903	1955
Slate	90	120	Pencil Cave	1955	2006
Sand	120	135	Lime	2006	2315
Slate	135	166	Big Injun Sand	2315	2390
Sand	166	200	Gray Sand	2390	2412
Slate	200	236	Gritty Slate & Shells	2412	2441
Sand	236	295	Sand	2441	2455
Slate	295	318	Slate & Shells	2455	2500
Sand	318	328	Lime	2500	2510 - Berea?
Slate 343'DLM-347' SLM	328	366	Slate & Shells	2510	2670
Coal	366	370	Gritty Grey Shale	2670	2892
Sand	370	387	Slate & Shells	2892	2980
Slate	387	410	Total Depth		2980
Lime Shells 414'DLM-415' SLM	410	416			
Slate	416	430	<u>CEMENT RECORD</u>		
Lime	430	443	3-27-47 13 3/8" casing- ran 8 bags		
Sand	443	487	aquagel with Fibertex. No circulation		
Slate	487	500	or returns.		
Lime	500	532			
Sand	532	595	5-16-47 10 1/2" casing. Ran 21 sacks		
Lime	595	638	aquagel with 50# fibertex. No circulation		
Slate	638	653	or returns.		
Lime	653	662			
Sand	662	799	6-14-47 8 5/8" casing. Ran 20 sacks		
Lime	799	805	aquagel. No circulation or returns.		
Coal	805	808			
Slate	808	823	C. Carbon Company Crew		
Sand	823	843			
Slate & Shells	843	850			
Sand	850	854			
Slate	854	872			
Lime	872	885			
Sand	885	914			
Lime	914	935			
Sand	935	1001			
Lime	1001	1030			
Slate & Shells	1030	1110			
Lime	1110	1122			
Red Rock	1122	1134			
Lime	1134	1152			
Red Rock	1152	1198			
Lime	1198	1215			
Red Rock	1215	1250			
Sand	1250	1265			
Red Rock	1265	1495			
Red Sand	1495	1718			
Gray Sandy Shale	1718	1762			
Lime	1762	1784			
Red Rock	1785	1814			
Grey Shale	1814	1850			
Slate	1850	1875			
Pencil Cave	1875	1903			