

Latitude 39°20'00"

88 45 00"

Longitude

75'  
+

Topo Location

7.5' Loc. 2.62S 15' Loc. 2.62S  
1.97W (calc.) 1.97W

Company \_\_\_\_\_ #5721

Farm J. M. Smith

15' Quad West Union SE  
(sec.)

7.5' Quad West Union

District West Union

WELL LOCATION PLAT

County 017 Permit 30931

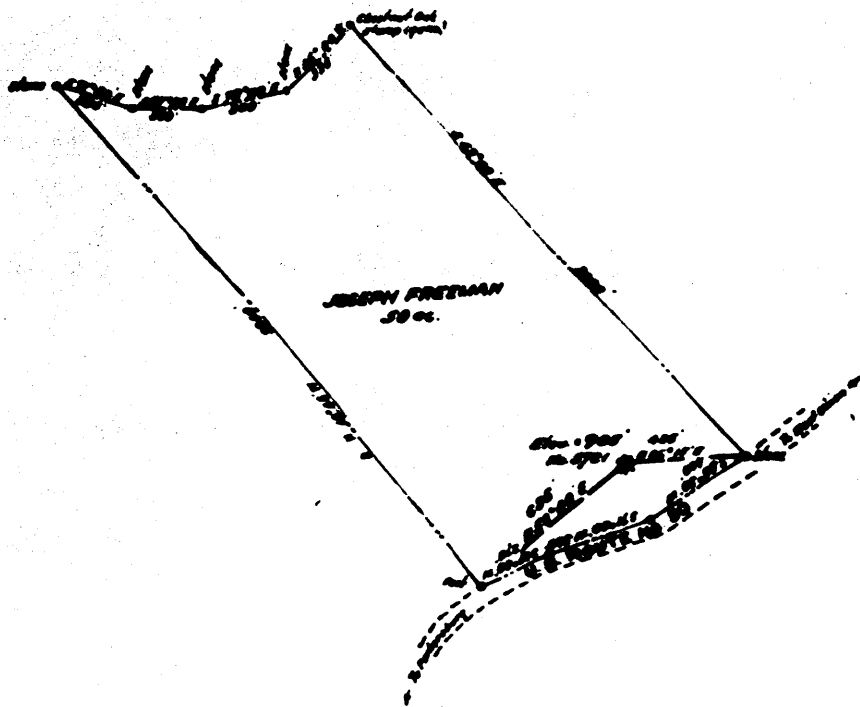

New Location   
 Drift Deeper   
 Abandonment

Company W. D. GRIBBLE  
 Address West Union, W.  
 Farm Joseph Freeman  
 Tract \_\_\_\_\_ Acres 50 Lease No. \_\_\_\_\_  
 Well (Farm) No. \_\_\_\_\_ Serial No. \_\_\_\_\_  
 Elevation (Spirit Level) 925  
 Quadrangle West Union  
 County Doddridge District West Union  
 Engineer W. D. Gribble

STATE OF WEST VIRGINIA  
 DEPARTMENT OF MINES  
 OIL AND GAS DIVISION  
 CHARLESTON

**WELL LOCATION MAP**

FILE NO. DOD-931-A-#5721

+ Denotes location of well on United States  
 Topographic Maps, scale 1 to 62,500, lat-  
 itude and longitude lines being represented



STATE OF WEST VIRGINIA  
DEPARTMENT OF MINES  
OIL AND GAS DIVISION

887

WELL RECORD

Permit No. 908-937-A

Oil or Gas Well Gas

Company C. O. Travis  
Address West Union, W. Va.  
Farm Joseph Freeman Acres 50  
Location (waters) Dee Run  
Well No. 5721 H.N.G. Co. Elev. 905  
District West Union County Doddridge  
The surface of tract is owned in fee by John Smith  
West Union, W. Va. Address \_\_\_\_\_  
Mineral rights are owned by \_\_\_\_\_  
Address \_\_\_\_\_  
Drilling commenced \_\_\_\_\_  
Drilling completed \_\_\_\_\_  
Date Shot \_\_\_\_\_ From \_\_\_\_\_ To \_\_\_\_\_  
With \_\_\_\_\_  
Open Flow \_\_\_\_\_ /10ths Water in \_\_\_\_\_ Inch  
\_\_\_\_\_ /10ths Merc. in \_\_\_\_\_ Inch  
Volume \_\_\_\_\_ Cu. Ft.  
Rock Pressure \_\_\_\_\_ lbs. \_\_\_\_\_ hrs.  
Oil \_\_\_\_\_ bbls., 1st 24 hrs.  
Fresh water \_\_\_\_\_ feet \_\_\_\_\_ feet  
Salt water \_\_\_\_\_ feet \_\_\_\_\_ feet

Casing and Tubing	Used in Drilling	Left in Well	Packers
Size			Kind of Packer
16			
13			
10	408	408	Size of
8 1/4	1256	1256	
6 5/8			Depth set
5 3/16			
3			Perf. top
2			Perf. bottom
Liners Used			Perf. top
			Perf. bottom

CASING CEMENTED \_\_\_\_\_ SIZE \_\_\_\_\_ No. Ft. \_\_\_\_\_ Date \_\_\_\_\_  
COAL WAS ENCOUNTERED AT 488 FEET \_\_\_\_\_ INCHES  
\_\_\_\_\_ FEET \_\_\_\_\_ INCHES FEET \_\_\_\_\_ INCHES  
\_\_\_\_\_ FEET \_\_\_\_\_ INCHES FEET \_\_\_\_\_ INCHES

Formation	Color	Hard or Soft	Top	Bottom	Oil, Gas or Water	Depth Found	Remarks
<b>Pgh. Coal</b>			488				
<b>Dunkard Sand</b>			1005	1117			
<b>Salt Sand</b>			1239	1471			
<b>Maxon</b>			1674	1705	Gas	1685	
<b>Total Depth</b>				1710			

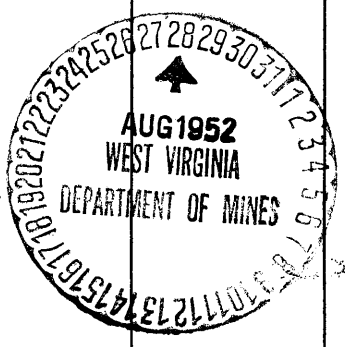



Well No. 5721 Lease No. Name Joseph Freeman District 096 State W. Va. County Doddridge

Location Made First Work Done Rig Commenced Rig Completed Drilling Commenced Drilling Completed 4-30-20 Rig Contractor { Drilling Contractor } if N. N. G. Co. Tools, String No. Tool Dressers.

Table with columns: FORMATION, Open or Close Hard or Soft, TOP, BOTTOM, Steel Line Measurements, Water Found Depth, Oil Found Depth, Gas Found Depth, REMARKS. Rows include Native Coal, Pittsburgh Coal, Little Dunkard, Big Dunkard, Gas Sand, First Salt, Second Salt, Third Salt, Maxon, Little Lime, Pencil Cave, Big Lime, Keener, Big Injun, Squaw, Weir, Berea, Gantz, Fifty Foot, Thirty Foot, Gordon Stray, Gordon, Fourth, Fifth. Total Depth 2578 filled to 1710 Elevation 918'

Table with columns: SIZE, Charged to Wall, Put in Well, Pulled Out, Left in Well, Transferred Before Completing, Left at Well Not in Use, Steel Line Measurement, If more than two strings of casing are left in hole, give reasons for leaving additional strings.

PACKER RECORD

Table with columns: SIZE, KIND, Amount Anchor, Amount Above Anchor, REMARKS.

SHOOTING RECORD (If shot before or upon completion of well)

Table with columns: DATE, Quarts, Top of Shell, Bottom of Shell, Diameter, Sand, TEST BEFORE SHOT (Reading, Liquid, Opening), TEST AFTER SHOT (Reading, Liquid, Opening), Test Taken After Shot No. Hours, By Whom Shot.

CEMENTING RECORD

Date Cemented Size Hole Cemented Size Casing Cemented Top Pittsburgh Coal Top Cementing Amount Cement Used Bottom Pittsburgh Coal Bottom Cementing Amount Sand Used Mr. of Coal Company on ground when coal was cemented Remarks: Signature of persons who cemented well

Approved Foreman

STATE OF WEST VIRGINIA  
DEPARTMENT OF MINES  
OIL AND GAS DIVISION

INSPECTOR'S PLUGGING REPORT

Plant No. 100-531 Well No. 5721  
 COMPANY C. O. Travis ADDRESS East Union, W. Va.  
 FARM John Smith - Joseph Freeman DISTRICT West Union West COUNTY Doddridge  
 Filling Material Used \_\_\_\_\_

Layer	Location	Amount	Packer	Location		
				BRIDGES	CASING AND TUBING	
PLUGS USED AND DEPTH PLUGGED				RECORDED	SIZE	LOG
CREAM-TYPE	WOOD-ONE	LEAD	CONSTRUCTION LOCATION			
				114'	8"	111'
				108'	10"	0'

Driller's Name C. O. Travis - C. F. Travis

Remarks: \_\_\_\_\_

Job completed - well record enclosed.

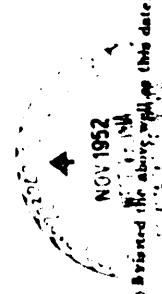

11/5/52

*Harry V. Mase*  
 Harry V. Mase  
 Constable of said County

*Harry V. Mase*

Subpoena - Witness  
 State of West Virginia, County of Doddridge, to-wit:  
 To any Constable of said County:  
 You are hereby commanded in the name of the State of West Virginia to summon  
 Harry V. Mase  
 to appear before me, a Justice of the Peace, at my office, in the District of West Union, in said  
 County, on the 8th day of Oct. 1952, at 8 o'clock A. M., in an action  
 to testify as a witness in behalf of C. O. Travis and Gerald Travis, is Plaintiff,  
 before me, in which State of West Va. is Plaintiff,  
 and C. O. Travis and Gerald Travis, Defendant.  
 Given under my hand this 5 day of Nov. 1952.  
*C. F. Travis*  
 Justice of the Peace

**AFFIDAVIT OF PLUGGING AND FILLING WELL**

AFFIDAVIT SHOULD BE MADE BY THE PERSON WHO HAS BEEN DESIGNATED AS THE OPERATOR OF THE WELL, OR BY THE PERSON WHO HAS BEEN DESIGNATED AS THE SUPERVISOR OF THE WELL, OR BY THE PERSON WHO HAS BEEN DESIGNATED AS THE ASSISTANT SUPERVISOR OF THE WELL, OR BY THE PERSON WHO HAS BEEN DESIGNATED AS THE ASSISTANT OPERATOR OF THE WELL, OR BY THE PERSON WHO HAS BEEN DESIGNATED AS THE ASSISTANT SUPERVISOR OF THE WELL, OR BY THE PERSON WHO HAS BEEN DESIGNATED AS THE ASSISTANT OPERATOR OF THE WELL.

NAME OF WELL OPERATOR  
 NAME OF WELL  
 COUNTY  
 DISTRICT  
 WELL AND LOCATION  
 DISTRICT  
 COUNTY  
 FARM  
 Well No. 111-10-100-00  
 West Union, W. Va.

STATE SUPERVISOR SUPERVISING PLUGGING AND FILLING

STATE OF WEST VIRGINIA

County of Doddridge  
 C. C. TRAVIS and C. C. TRAVIS  
 being first duly sworn according to law depose and say that they are experienced in the work of plugging and filling of coal gas wells and were employed by C. C. TRAVIS well operator, and participated in the work of plugging and filling the above well, that said work was commenced on the 27th day of October, 1954, and that the well was plugged and filled in the following manner:

SAND OR OTHER RECORD	FILLING MATERIAL		PLUGS USED		CASES
	CONTENT	WT	SIZE & SHAP	NO. OF PLUGS SET	
	Red Clay	1650			
	Cement, Stone-1650-1640				
	Red Clay	1260			
	Cement, Stone-1260-1256				
	1-1/4" Gas, set off and filled.			1145	1110
	Bridge set	500			
	2 bags cement, 3' stone of bridge				
	Red Clay	518			
	Cement	518, 468			
	Red Clay	408			
	10" Gas, pullic			408	408
	Cement, Stone 408	308			
	Red Clay to Surface				
COAL BEAMS					
DESCRIPTION OF MONUMENT					
Cement, 10" x 10" x 8" across					
extending 2' above surface					

and that the work of plugging and filling said well was completed on the 3rd day of November, 1954.

The Department of Mines  
 Oil and Gas Division,  
 Charleston, West Va.

Mr. C. H. Hall

Dear Sir-

In regard to your letter of August 4, 1954, I purchased from F. H. Gible estate on Date of June, 17 1955. Eight wells on leases, 8 cases.

Alexander, Well No. 111-10-100-00, Co. C. C. Travis  
 G. W. Siffert 200 acres, Well No. 111-10-100-00, Co. C. C. Travis  
 W. M. Shinn 104 acres, Well No. 111-10-100-00, Co. C. C. Travis

Of which are located in Doddridge District, Doddridge Co. W. Va., Joseph Freeman 50 acres, Well No. 111-10-100-00, Co. C. C. Travis, West Union, Dist. Dodd, Co. Eli Lutter 200 acres, Well No. 111-10-100-00, Co. C. C. Travis, West Union, Dist. Dodd, Co.

John Herder, Well No. 111-10-100-00, Tyler Co. W. Va.

Hiram Sweeney, Well No. 111-10-100-00, Dist. Dodd, Co. W. Va.

Ash Mrs. Well No. 111-10-100-00, Dodd, Co. W. Va.

I informed your Inspector, Harry W. Haze, sometime ago about this purchase, of above mentioned wells and leases, and showed him my deed for same, but did not leave my deed with him as I did not have it recorded, however if you need a copy of my deed for your records I will mail one to you, upon your request.

I have completed plugging and filling, The Ash Mrs. Well No. 1 and Hiram Sweeney Well No. 1, which you should have received by this date, an affidavit for each well.

If this is not information, though please let me know by return mail, as I may be able to furnish as possible before bad weather sets in, Thanks very much, I remain,

Yours Truly  
 C. C. Travis  
 West Union, W. Va.