

Latitude 35° 15'

Longitude 80° 45'

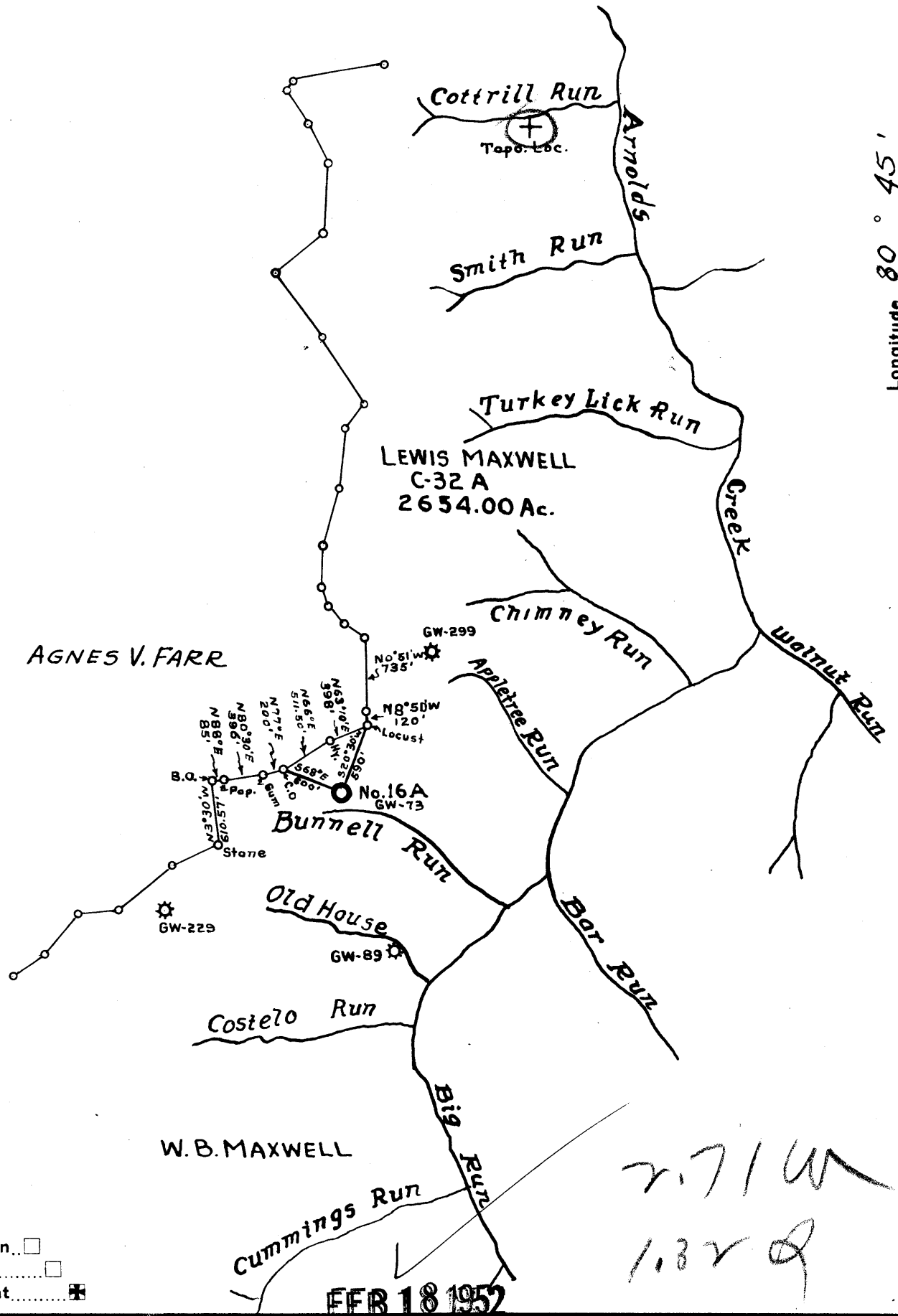

New Location

Drill Deeper

Abandonment

FEB 18 1952

Company Columbian Carbon Company

Address Box 873 Charleston W.Va.

Farm Lewis Maxwell

Tract 1#2 Acres 2654.00 Lease No. C-32 A

Well (Farm) No. 16-A Serial No. GW-73

Elevation (Spirit Level) 1097 **(NE)**

Quadrangle West Union HOLBROOK

Count Doddridge District West Union

Engineer R. B. ...

Engineer's Registration No. 2074

File No. _____ Drawing No. _____

Date Aug. 17 1951 Scale 1" = 1320'

STATE OF WEST VIRGINIA
DEPARTMENT OF MINES
OIL AND GAS DIVISION
CHARLESTON

WELL LOCATION MAP
FILE NO. DOD-895-A

+ Denotes location of well on United States Topographic Maps, scale 1 to 62,500, latitude and longitude lines being represented by border lines as shown.

- Denotes one inch spaces on border line of original tracing.

"IMPERIAL" TRACING CLOTH
K & E CO., N. Y.

LEWIS MAXWELL No. 16-A (GW-73) - COLUMBIAN CARBON Co. - DOD-895-A

STATE OF WEST VIRGINIA
DEPARTMENT OF MINES
OIL AND GAS DIVISION



780

Permit No. 000-895-A

WELL RECORD

Oil or Gas Well gas
(KIND)

Company Columbian Carbon Company
Address Box 873, Charleston, W. Va.
Farm Lewis Maxwell Acres 265 1/4
Location (waters) Arnolds Creek
Well No. 16A - GW-73 Elev. 1097'
District West Union County Doddridge
The surface of tract is owned in fee by Lewis Maxwell
Address West Union, W. Va.
Mineral rights are owned by same
Address _____

Drilling commenced _____
Drilling completed 10-8-16
Date Shot not shot From _____ To _____
With _____

Open Flow 1 1/4 /10ths Water in 2" Inch
1 1/4 /10ths Merc. in 2" Inch
Volume 158,000 (1-1-20) Cu. Ft.
Rock Pressure _____ lbs. _____ hrs.
Oil _____ bbls., 1st 24 hrs.
Fresh water _____ feet _____ feet
Salt water 1260' 1275' 1285' feet _____ feet

Casing and Tubing	Used in Drilling	Left in Well	Packers
Size			Kind of Packer
16"			
13"	<u>16'</u>	<u>16'</u>	
10"	<u>740'</u>	<u>pulled</u>	Size of
8 1/4"	<u>1280'</u>	<u>pulled</u>	
6 5/8"	<u>1742'</u>	<u>1742'</u>	Depth set
5 3/16"			
3"			Perf. top
2" tubing	<u>left in well</u>		Perf. bottom
Liners Used	<u>tubed at 2485'</u>		Perf. top
			Perf. bottom

CASING CEMENTED _____ SIZE _____ No. Ft. _____ Date _____

COAL WAS ENCOUNTERED AT _____ FEET _____ INCHES
_____ FEET _____ INCHES FEET _____ INCHES
_____ FEET _____ INCHES FEET _____ INCHES

Formation	Color	Hard or Soft	Top	Bottom	Oil, Gas or Water	Depth Found	Remarks
Big Dunkard Sand			1120	1150			
1st Salt Sand			1175	1224			
2nd Salt Sand			1246	1314	S. water	1260'	
Mason Sand			1490	1590	S. Water	1275'	
Little Lime			1706	1737	S. water	1285'	
Big Lime			1742	1820			
Big Injun Sand			1823	1902	Gas	1848-1851'	
Gantz Sand			2060	2170			
Gordon Sand			2466	2473			
TOTAL DEPTH - - - -				2485'			

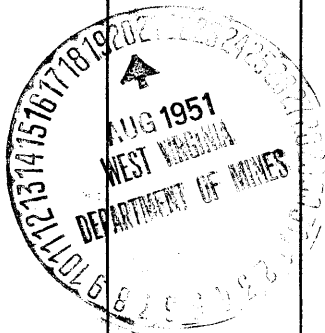

JAN 16 1952
(over)