

+ 0.77 S  
3.07 W

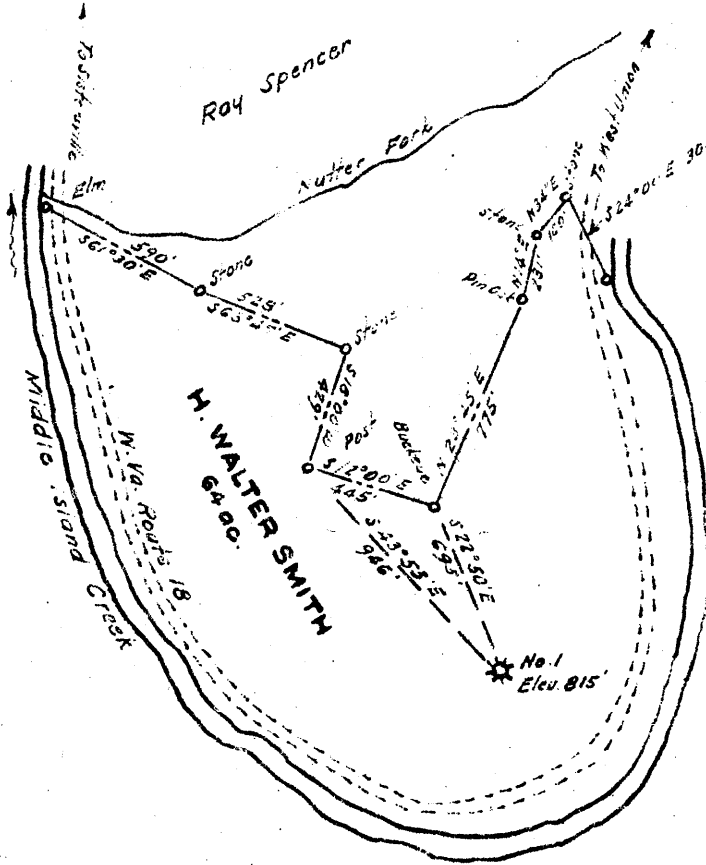

Herman Yeater

Joseph Erseman

7.5' loc 15' loc calc  
0.83 S 39.20 0.83 S kls a/k/a/98  
0.79 W 80.47 30 3.02 W

New Location   
Drill Deeper   
Abandonment

Company **CECIL W. SALISBURY**  
 Address **303 B - Bluhring Ave., Charleston, W. Va.**  
 Farm **H. Walter Smith**  
 Tract **Acres 64** Lease No. \_\_\_\_\_  
 Well (Farm) No. **One** Serial No. \_\_\_\_\_  
 Elevation (Spirit Level) **815'**  
 Quadrangle **West Union**  
 County **Doddridge** District **West Union**  
 Engineer \_\_\_\_\_  
 Engineer's Registration No. **1227**  
 File No. \_\_\_\_\_ Drawing No. \_\_\_\_\_  
 Date **June, 1948** Scale **1" = 620'**

STATE OF WEST VIRGINIA  
DEPARTMENT OF MINES  
OIL AND GAS DIVISION  
CHARLESTON

**WELL LOCATION MAP**  
FILE NO. **DOD-619-A**

Was 019 715 23, 70225

+ Denotes location of well on United States Topographic Maps, scale 1 to 62,500, latitude and longitude lines being represented by border lines as shown

- Denotes one inch spaces on border line of original tracing.



STATE OF WEST VIRGINIA  
DEPARTMENT OF MINES  
OIL AND GAS DIVISION

WELL RECORD

Permit No. 619 A

~~Oil or Gas Well~~ (KIND)

Company Cecil Salisbury  
 Address Charleston, W. Va.  
 Farm Smith Ash (H. Walter Smith) Acres 64  
 Location (waters) \_\_\_\_\_  
 Well No. \_\_\_\_\_ Elev. 815  
 District Union County Doddridge  
 The surface of tract is owned in fee by \_\_\_\_\_  
 Address \_\_\_\_\_  
 Mineral rights are owned by \_\_\_\_\_  
 Address \_\_\_\_\_  
 Drilling commenced August 14, 1913  
 Drilling completed September 16, 1913  
 Date Shot \_\_\_\_\_ From \_\_\_\_\_ To \_\_\_\_\_  
 With \_\_\_\_\_  
 Open Flow \_\_\_\_\_ /10ths Water in \_\_\_\_\_ Inch  
 \_\_\_\_\_ /10ths Merc. in \_\_\_\_\_ Inch  
 Volume \_\_\_\_\_ Cu. Ft.  
 Rock Pressure \_\_\_\_\_ lbs. \_\_\_\_\_ hrs.  
 Oil \_\_\_\_\_ bbls., 1st 24 hrs.  
 Fresh water \_\_\_\_\_ feet \_\_\_\_\_ feet  
 Salt water \_\_\_\_\_ feet \_\_\_\_\_ feet

Casing and Tubing	Used in Drilling	Left in Well	Packers
Size			Kind of Packer
16			
13			
10	420'	Pulled	Size of
8 1/4	945'	Pulled	
6 5/8	1718'	1718'	Depth set
<del>5 7/16</del> 1"	1878'	Pulled	
3	1878'	Pulled	Perf. top
2	1878'	1878'	Perf. bottom
Liners Used			Perf. top
			Perf. bottom

CASING CEMENTED \_\_\_\_\_ SIZE \_\_\_\_\_ No. Ft. \_\_\_\_\_ Date \_\_\_\_\_

COAL WAS ENCOUNTERED AT \_\_\_\_\_ FEET \_\_\_\_\_ INCHES  
 \_\_\_\_\_ FEET \_\_\_\_\_ INCHES \_\_\_\_\_ FEET \_\_\_\_\_ INCHES  
 \_\_\_\_\_ FEET \_\_\_\_\_ INCHES \_\_\_\_\_ FEET \_\_\_\_\_ INCHES

Formation	Color	Hard or Soft	Top	Bottom	Oil, Gas or Water	Depth Found	Remarks
Conductor				25			
Native coal			185	189			
Pittsburgh coal			460	465	Water	240'	
Little Dunkard sand			846	860	Water	340'	
Big Dunkard sand			970'	990			
1st salt sand			1120	1180	Gas	1120-80'	
2d salt sand			1260	1385			
2d salt sand			1430	1575			
Maxton sand			1630	1640			
Red rock			1660	1670			
Little lime			1674	1690			
Pencil cave			1690	1713			
Big lime			1713	1790			
Big Injun sand			1790	1860	Gas	1804	Small quantity
Squaw sand			1862	1875	Gas	1863-1875'	
Total depth				1878	Tubed with 3" tubing Perforation 5' off bottom Packer set at 1775' 5/10 Mercury thru 6-5/8" opening 4,152,333 Cu.ft. per 24 hrs. Rock pressure 680# Minute pressure 1-55 2-125 3-155 4-240 5-285 6-325 7-355 8-390 9-410 10-430 11-450 12-465 13-475 14-485 15-495 16-500 28-580  Tubed January 21, 1919 with 2" tubing Top of perforation 12' off bottom Packer set at 1785'		

SMITH-ASH (H. WALTER SMITH) NO. 1 WELL.

West Union District, Doddridge County, W. Va.

By.....  
J. E. Trainer, Contractor.

70225

Elevation.....  
Drilling commenced Aug. 14, 1913; completed Sept. 16, 1913.  
10" casing, 420' (pulled); 8 1/2" casing, 945' (pulled); 6 3/4" casing, 1718';  
3" tubing, 1878' (pulled); 1" tubing, 1878' (pulled);  
2" tubing, 1878'.

Tubed with 3" tubing.  
Perforation, 5' off bottom.  
Packer set at 1775'.

5/10 Mercury through 6 3/4" opening = 4,152,330 cu. ft. per 24 hrs.  
Rock pressure, 680 lbs.

Minute pressure: 1 min., 55 lbs.; 2 min., 125 lbs.; 3 min., 155 lbs.;  
4 min., 240 lbs.; 5 min., 285 lbs.; 6 min., 325 lbs.; 7 min.,  
355 lbs.; 8 min., 390 lbs.; 9 min., 410 lbs.; 10 min., 430 lbs.;  
11 min., 450 lbs.; 12 min., 465 lbs.; 13 min., 475 lbs.; 14 min.,  
485 lbs.; 15 min., 495 lbs.; 16 min., 500 lbs.; 28 min., 550 lbs.

Tubed Jan. 21, 1919, with 2" tubing. Top of perforation 12' off bottom.  
Packer set at 1785'.

Well connected with Jos. Freeman 12 with Strickling meter.  
Record in Eastern Petroleum Co. Well Record book of Clifton Oil & Gas Co.

	Top.	Bottom.
Conductor	0	25
Native coal	185	189
(water at 240') (more water at 340')		
Pittsburgh Coal	460	465
Little Dunkard Sand	846	860
Big Dunkard Sand	970	990
Gas Sand	1120	1180
First Salt Sand	1260	1335
Second Salt Sand	1430	1575
Morton Sand	1630	1640
Red rock	1660	1670
Little Mine	1674	1690
Pencil Cave	1690	1713
Big Mine	1713	1790
Big Injun Sand (gas, 1804', small quantity)	1790	1860
Squaw Sand (gas, 1863-1875')	1862	1875
Total depth		1878

MEMORANDUM attached to record dated Dec. 30, 1927, reads:  
Enclosed please find the open flow test of H. Walter Smith No. 1  
taken to-day after it had blowed open one hour: 50/10 water in 1" opening:

Minute	1/2	1	2	3	4	5	10	15	20	30
	10	19	27	42	54	57	72	75	78	80 #