

1.55 S  
2.38 W

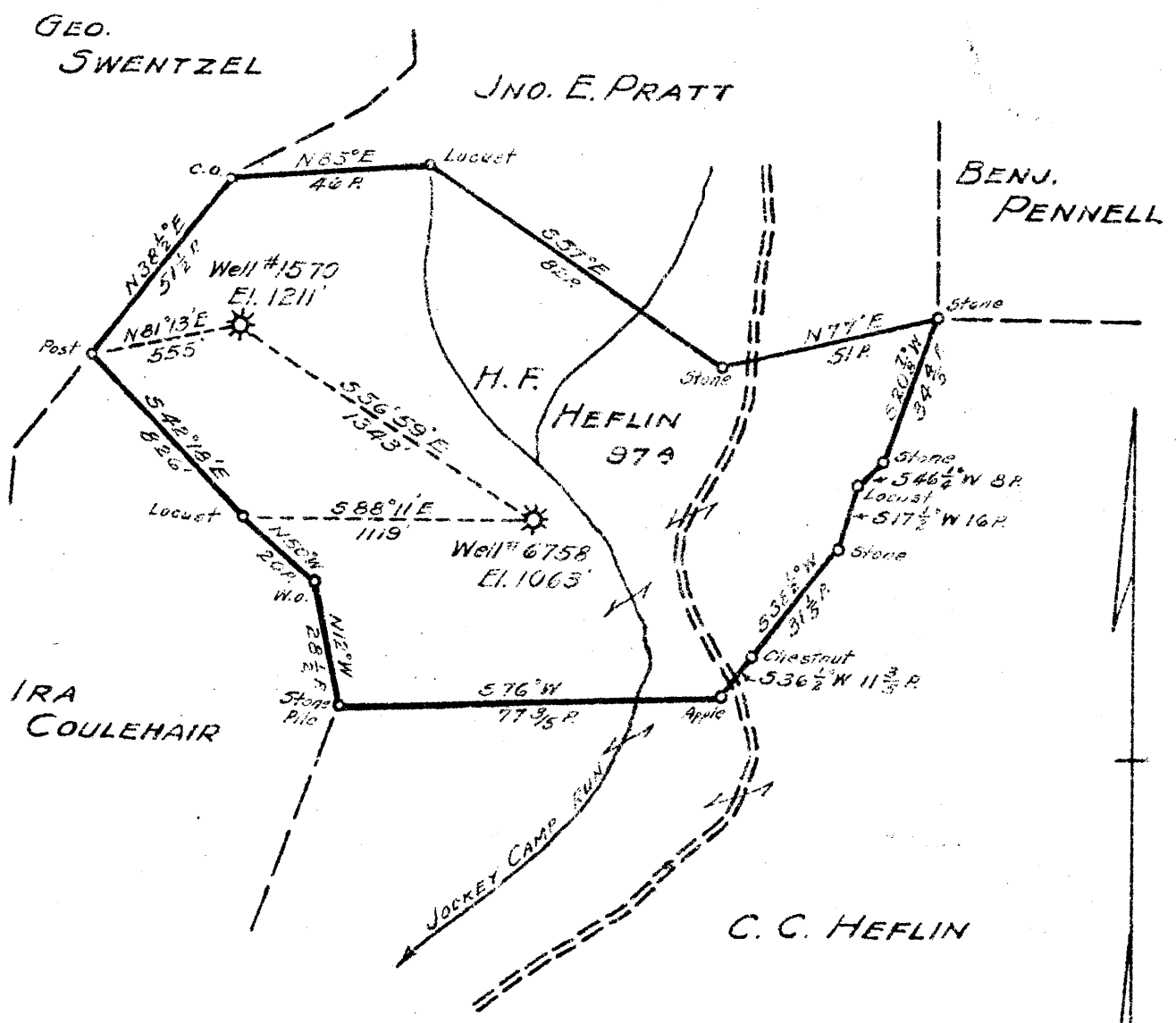

New Location   
 Drill Deeper   
 Abandonment

7.5 loc      calc 15' loc  
 1.57 S 39 20      1.57 S  
 9.11 W 80 42 30      0.34 W  
 Da al 12 12

Map 5h.54 Sq. 5-10 W-6 F.B. 777 P. 546

Company	HOPE NATURAL GAS CO.
Address	CLARKSBURG, W. VA.
Farm	H. F. HEFLIN
Tract	Acres 97 Lesse No. 10383
Well (Farm) No.	Serial No. AS SHOWN
Elevation (Spirit Level)	AS SHOWN
Quadrangle	CENTERPOINT
County	DODDRIDGE District WEST UNION
Engineer	W. M. Powers
Engineer's Registration No.	900
File No.	Drawing No.
Date	MAY 7, 1946 Scale 1" = 40 R.

STATE OF WEST VIRGINIA  
 DEPARTMENT OF MINES  
 OIL AND GAS DIVISION  
 CHARLESTON

**WELL LOCATION MAP**  
 FILE NO. DOD-519-A (6758)

+ Denotes location of well on United States Topographic Maps, scale 1 to 62,500, latitude and longitude lines being represented by border lines as shown.

- Denotes one inch spaces on border line of original tracing.



423

STATE OF WEST VIRGINIA  
DEPARTMENT OF MINES  
OIL AND GAS DIVISION

Permit No. **519-A**

WELL RECORD

**XXX**  
Oil or Gas Well (KIND)

Company **Hope Natural Gas Company**  
 Address **445 West Main St. Clarksburg, W.Va.**  
 Farm **H.F. Heflin** Acres **97**  
 Location (waters) \_\_\_\_\_  
 Well No. **6758** Elev. **1063**  
 District **West Union** County **Doddridge**  
 The surface of tract is owned in fee by \_\_\_\_\_  
 Address \_\_\_\_\_  
 Mineral rights are owned by \_\_\_\_\_  
 Address \_\_\_\_\_  
 Drilling commenced **January 26, 1926**  
 Drilling completed **March 19, 1926**  
 Date Shot \_\_\_\_\_ From \_\_\_\_\_ To \_\_\_\_\_  
 With \_\_\_\_\_  
 Open Flow \_\_\_\_\_ /10ths Water in \_\_\_\_\_ Inch  
 \_\_\_\_\_ /10ths Merc. in \_\_\_\_\_ Inch  
 Volume \_\_\_\_\_ Cu. Ft.  
 Rock Pressure \_\_\_\_\_ lbs. \_\_\_\_\_ hrs.  
 Oil \_\_\_\_\_ bbls., 1st 24 hrs.  
 Fresh water \_\_\_\_\_ feet  
 Salt water **1440** feet

Casing and Tubing	Used in Drilling	Left in Well	Packers
Size			
16			Kind of Packer
13			
10	<b>220</b>	<b>108</b>	Size of
8 1/4	<b>958</b>	<b>Pulled</b>	
6 5/8	<b>1815</b>	<b>1815</b>	Depth set
5 3/16			
3	<b>2033</b>	<b>2033</b>	Perf. top
2			Perf. bottom
Liners Used			Perf. top
			Perf. bottom

**Not cemented**  
 CASING CEMENTED \_\_\_\_\_ SIZE \_\_\_\_\_ No. Ft. \_\_\_\_\_ Date \_\_\_\_\_  
 COAL WAS ENCOUNTERED AT **481** FEET **36** INCHES  
 \_\_\_\_\_ FEET \_\_\_\_\_ INCHES FEET \_\_\_\_\_ INCHES  
 \_\_\_\_\_ FEET \_\_\_\_\_ INCHES FEET \_\_\_\_\_ INCHES

Formation	Color	Hard or Soft	Top	Bottom	Oil, Gas or Water	Depth Found	Remarks
Pittsburgh Coal			481	484			
Big Dunkard Gas sand			930 1142	959 1148			
First Salt			1164	1275			
Second Salt			1312	1580	water	1440	
Maxon			1710	1732			
Little Line			1748	1775			
Pencil cave			1775	1793			
Big Lime			1793	1905			
Big Injun Squaw			1905 2022	2004 2060	gas	1945 to 1995	
Gantz Fifty foot			2195 2282	2265 2325			
Gordon Stray			2590	2611			
Gordon			2619	2627			
Total depth				2652			
Filled back to				2033			

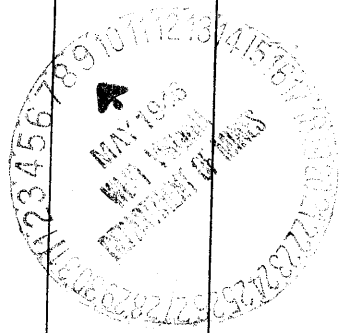

Formation	Color	Hard or Soft	Top	Bottom	Oil, Gas or Water	Depth Found	Remarks

Date May 7, 1946, 194

APPROVED Hope Natural Gas Company, Owner

By [Signature] General Superintendent.

