

Latitude 39° 15' 00"

1100, 07, 08

15'
+

Longitude

Topo Location

7.5' Loc. 1.575 15' Loc. 1.575
0.20W (calc.) 0.20W

Company _____ # C-995

Farm W.H. Douglas

15' Quad Vadis NW
(sec.)

7.5' Quad New Milton

District New Milton

WELL LOCATION PLAT

County 017 Permit 30148

Dod-148-A M

New Milton District, Doddridge County, W. Va.
 By Hope Cons. & Ref. Co., 445 W. Main St., Clarksburg, W. Va.
 On 218 acres, surface owned by A. L. Keister, New Milton, W. Va.;
 owner of mineral rights, unknown.

Elevation, 982' L.

10" casing, 313' + ~~111'~~ (pulled); 8 1/4", 1174'; 6-5/8", 2031'; 2" tubing, 2093'.

Coal was encountered at 107-110 and 655-665'.

Abandonment reported to Dept. of Mines June 8, 1936.

Well was shot at 2067-2074'.

Fresh water at 130 and 505'; salt water at 1191'.

Producing hole.

	Top.	Bottom.	Thickness.
Native coal	107	110	3
Fresh water at 130 and 505'			
Pittsburgh Coal	655	665	10
Little Dunkard Sand	1000	1025	25
Big Dunkard Sand (water, 1191')	1160	1217	57
Gas Sand	1410	1452	42
First Salt Sand	1457	1517	60
Second Salt Sand	1692	1769	77
Maxton Sand	1914	1935	21
Little Lime	1958	1973	15
Pencil Cave	1973	1995	22
Big Lime	1995	2051	56
Big Injun Sand (gas and oil, 2069-2073')	2051	2145	94
Original total depth		2184	
Filled up to		2093	

New Milton District, Doddridge County, W. Va.
 By Rope Construction & Refining Co., 445 W. Main St.,
 Clarksburg, W. Va.

On 215 acres, surface owned by A. L. Keister, New Milton, W. Va.;
 owned of mineral rights unknown.

Elevation, 982' L.

10" casing, 313' (pulled); 8 $\frac{1}{2}$ ", 1174'; 6-5/8", 2031'; 2" tubing, 2093'.

Coal was encountered at 107-110' and 655-665'.

Abandonment reported to Dept. of Mines June 8, 1936.

Well was shot at 2067-2074'.

Fresh water at 130' and 505'; salt water at 1191'.

	Top.	Bottom.	Thickness.
Native coal (fresh water at 130' and 505')	107	- 110	3
Pittsburgh Coal	655	- 665	10
Little Dunkard Sand	1000	- 1025	25
Big Dunkard Sand (water at 1191')	1160	- 1217	57
Gas Sand	1410	- 1452	42
First Salt Sand	1457	- 1517	60
Second Salt Sand	1692	- 1769	77
Maxton Sand	1914	- 1935	21
Little Line	1958	- 1973	15
Pencil Cave	1973	- 1995	22
Big Line	1995	- 2031	56
Big Injun Sand (gas and oil, 2069-73')	2051	- 2145	94
Original total depth			2184
Filled up to			2093

FORMATION RECORD

Name	Color	Character	Oil, Gas or Water	Top	Bottom	Thickness	Total Depth	Remarks
Active coal				107	110	3'		
Pittsburgh Coal		Frash water	130 105	655	665	10'		
Little Duckard Sand				1000	1020	20'		
Big Duckard Sand		Water-1191		1100	1217	57'	1174' - 8 1/2'	
Gas Sand				1410	1450	40'		
First Salt Sand				1457	1517	60'		
Second Salt Sand				1692	1719	27'		
Marion Sand				1914	1935	21'		
Little Lime				1956	1975	19'		
Pencil Cave				1973	1995	22'		
Big Lime				1995	2151	56'	2131' - 6 1/2'	
Big Injun Sand				2051	2145	94'		
				Gas and oil-3069 to 2073.				
				Original total depth 2144, filled up to		2093		

Well was not shot at _____ feet; well was shot at 2097 to 2074 _____ feet.

INDEX
Fresh water at 130 to 505 _____ feet; Salt water at 1191 _____ feet.

Well was dry producing both _____ feet.

June 8th, 1936. Date
Approved _____ Owner _____
By _____

NOTE: All bottom formations must be noted as indicated above and all bearings and all and gas sands must be recorded with their proper geological names in the district in well as any local names commonly used in the district for such strata.

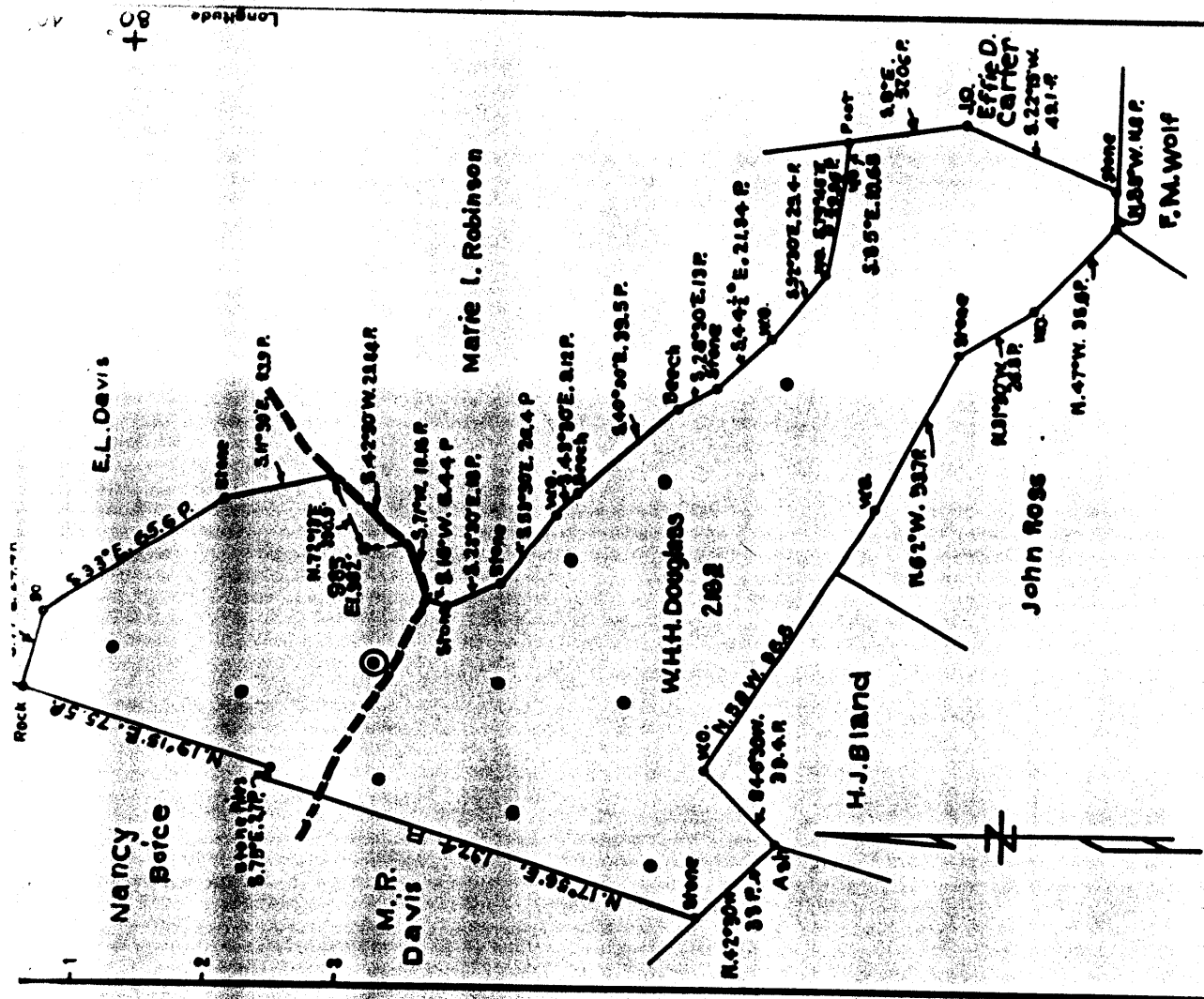

STATE OF WEST VIRGINIA
DEPARTMENT OF MINES
OIL AND GAS DIVISION
CHARLESTON

WELL LOCATION MAP
FILE NO. 282-148

Company Hope Construction & Refining Co.
Address Clarksburg W. Va.
Farm W.H.H. Douglas
Tract Acres 218 Lease No. _____
Well (Farm) No. 10 Serial No. 282
Direction (Spit Level) 282
Geographic Yadis

WEST VIRGINIA DEPARTMENT OF MINES
OIL AND GAS DIVISION
PRELIMINARY DATA SHEET NO. 1

File No. _____ Well No. 415
 Hope Construction Co., Inc., Company of 449 West Virginia
 Clarksville, W. Va., on the _____
 containing Oil from Location New Milton District, in Doddridge County, West Virginia
 The surface of the above tract is owned in fee by A. L. Keister
 of New Milton, W. Va., address, and the mineral rights are owned by
UNKNOWN of _____

The oil and gas privileges are held under lease by the above named company, and this well is drilled under permit
 No. _____ issued by the West Virginia Department of Mines, Oil and Gas Division
 Date 982

Elevation of surface at top of well _____ feet

The number of feet of the different sized casings used in the well.

315	feet	10" (Pulled)	dia. reg	1174	feet	8"	dia. reg	_____
2031	feet	6-5/8"	dia. reg	7073	feet	2"	dia. reg	_____
_____	feet	_____	dia. reg	_____	feet	_____	dia. reg	_____
_____	_____	_____	_____	_____	_____	_____	_____	_____
_____	_____	_____	_____	_____	_____	_____	_____	_____
_____	_____	_____	_____	_____	_____	_____	_____	_____

Coal was encountered at 167 feet, thickness 36 inches, and at 658
 feet; thickness 120 inches; and at _____ feet; thickness _____ inches.
 Lenses were used as follows: (Give details) _____

Date, June 8th, 1936.
 Approved: Hope Construction & Drilling Company

WEST VIRGINIA DEPARTMENT OF MINES
OIL AND GAS DIVISION
PLUGGING AND FILLING WELL

to be plugged or filled in section _____
 Coal seam _____
 Surface Owner: A. L. Keister, New Milton, W. Va.
 Well and Location New Milton, Doddridge County
 Well No. 415
 Date January 20, 1936

AFFIDAVIT

STATE OF WEST VIRGINIA,
 County of Doddridge
Thomas P. Flynn and Miner J. S. Sledge
 being first duly sworn according to law depose and say that they are experienced in the work of plugging
 and filling oil and gas wells and were employed by Hope Construction & Drilling Co., Inc.
 and participated in the work of plugging and filling the above well, that said work was commenced on the
10th day of November 1937, and that the well was plugged and filled in
 the following manner:

Manner in which well was plugged:
 Removed 8" tubing and filled with clay mud to 202 1/2' - 20' above Big Injun,
 placed 6" lead metal plug. Pulled 6-5/8" casing. Installed bridge at 1799,
 20' below salt sand. Filled with clay mud and casings to 1697, 20' above salt
 sand. Placed a cement plug. Left in a mud barrel at 1690, made of 20' of 8-5/8"
 casing. Installed bridge at 1647 and filled with clay mud to 1180 and placed
 a cement plug. Cut 8" casing at 1060, 980, 800, 480 and 330-3/16 ft.
 Pulled 200-0/12 ft. 8" casing. Installed bridge at 1025 and placed a cement
 plug. Pulled 100' of 8" casing. Installed bridge at 895 to 885. Filled with clay
 mud to 160'. Installed bridge at 87'. Filled with clay from 87 feet to surface.

Description of monument: Concrete shaft - 8 x 8 x 9' with inscription
H. C. & E. Co. 908

That above construction was in accordance with the provisions of section 11, article 4, chapter 20 of the code
 and that the work of plugging and filling said well was completed on the 8 day of January

And further deposes each set.
 Approved: Thomas P. Flynn
Miner J. S. Sledge