

Latitude 39°15'00"

085130"

Longitude

75'  
+

Topo Location

7.5' Loc.	<u>1.92S</u>	15' Loc.	<u>1.92S</u>
	<u>2.22W</u>	(calc.)	<u>4.45W</u>

Company C-1095

Farm W.H. Douglas

15' Quad Vadis NE  
(sec.)

7.5' Quad New Milton

District New Milton

WELL LOCATION PLAT

County 017 Permit 30144

Dodd, 144-A

New Milton District, Doddridge County, W. Va.

By Hope Construction & Refining Co., 445 W. Main St.,  
Clarksburg, W. Va.On 218 acres, surface owned by A. L. Keister, New Milton, W. Va.;  
owner of mineral rights, unknown.

Elevation, 898' L.

10" casing, 307'; 8 1/4", 1095'; 6-5/8", 1939'; 2" tubing, 2046'.

Coal was encountered at 30-32 and 580-585'.

Abandonment reported to Dept. of Mines April 21, 1936.

Well was shot at 2007-2014'. Oil well.

Fresh water at 35'; salt water at 1850'.

	Top.	Bottom.	Thickness.
Native coal (Water at 35')	30	32	2
Pittsburgh Coal	580	585	5
Big Dunkard Sand	1078		
Gas Sand	1205	1270	65
First Salt Sand	1324	1370	46
Second Salt Sand	1385	1517	132
Third Salt Sand	1600	1690	90
Maxton Sand (water at 1850')	1815	1868	53
Little Lime	1875	1912	37
Pencil Cave	1912	1923	11
Big Lime	1923	1983	60
Big Injun Sand (oil, 2007-2014')	1983	2076	93
Total depth		2079	

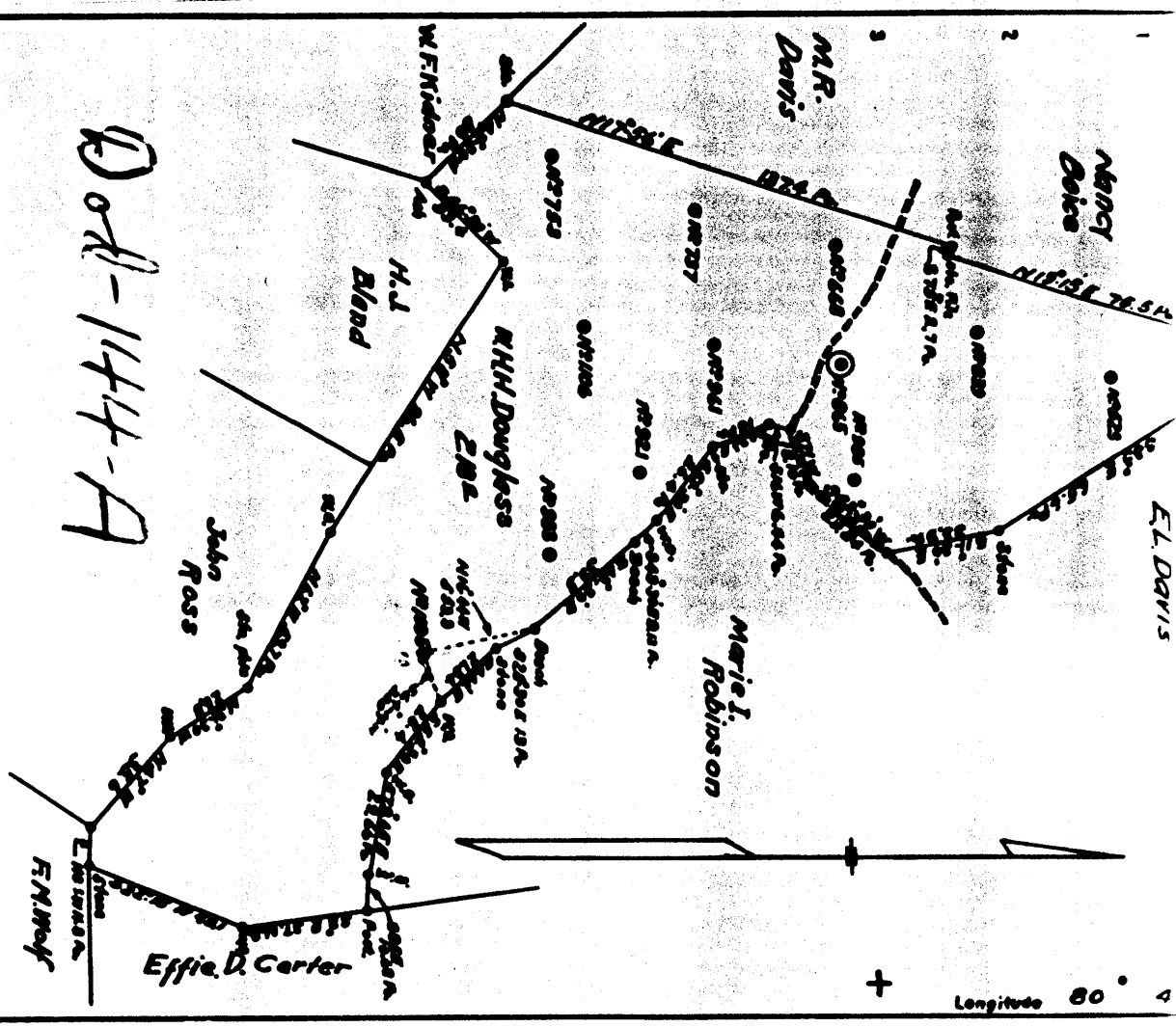

Company HOPE CONST. & REC. CO.  
 Address CLARKSBURG W.VA.  
 Farm W.H. Douglas  
 Tract Acres 21/8 Lease No. 227  
 Well (Farm) No. 12 Serial No. 1225  
 Quantity VADIS  
 County DODD  
 District NEW MILTON

STATE OF WEST VIRGINIA  
 DEPARTMENT OF MINES  
 OIL AND GAS DIVISION  
 CHARLESTON

WELL LOCATION MAP  
 FILE NO. DOD-144

† Denotes location of well on United States  
 Topographic Maps, scale 1 to 62,500, 1:1.

WELL NO. D-011-1414-A FORMATION RECORD

Name	Color	Diameter	In. Use or Well	Top	Bottom	Thickness	Total Depth	Remarks
Native Coal						2'		
Pittsburgh Coal		14 1/2" - 35"		500	562	5'		
2 1/2' Dunham sand				1076				
Gas Sand				1205	1270	65'		
First Salt Sand				1334	1370	46'		
Second Salt Sand				1385	1517	132'		
Third Salt Sand				1600	1680	80'		
Lexon Sand				1615	1662	55'		
Little Linn		14 1/2" - 18 1/2"		1675	1912	37'		
Pennell Carbon				1912	1923	11'		
Big Linn				1923	1863	60'		
Big Injun Sand				1943	2076	95'		
				011 - 2007 to 2014			2076	

Well was last shot at \_\_\_\_\_ feet; well was shot at 2007-2014 feet.

Salt fresh water at \_\_\_\_\_ feet; fresh water at \_\_\_\_\_ feet.

Well was producing salt brine \_\_\_\_\_ days.

April 21, 1936.

Approved Hope Construction & Refining Company  
 Owner \_\_\_\_\_ By \_\_\_\_\_

NOTE: All bottom formations must be noted as indicated above and all bottom sand and all sand over \_\_\_\_\_

