

Latitude 39° 20' 00"

80° 35' 00"

Longitude

7.5'  
+

Topo Location

7.5' Loc. 2.30S 15' Loc. 2.30S  
1.60W (calc.) 1.60W

Company 238

Farm Joshua Davis

15' Quad Centripnt SE  
(sec.)

7.5' Quad Salem

District GRANT

WELL LOCATION PLAT

County 017 Permit 30137

**Grant District, Doddridge County, W. Va.**

Hope Natural Gas Co., 445 W. Main St., Clarksburg, W. Va.  
 On 234.76 acres; surface owned by O. C. Davis, RFD#2, Salem, W. Va.  
 Elevation, 1124' L.  
 6-5/8" casing, 2154'.  
 Coal was encountered at 856-860'.  
 Abandonment reported to Dept. of Mines Oct. 4, 1935.  
 Well was not shot.  
 No water recorded.  
 Gas well. Now existed.

	Top.	Bottom.
Pittsburgh Coal	856	860
Dunkard Sand	1400	1460
Salt Sand	1765	1828
Big Lime	2140	2190
Big Injun Sand (gas, 2210')	2190	2298
Gordon Stray Sand	2931	2947
Gordon Sand (gas, 2933')	2970	2975
Total depth		3028

Grant District, Doddridge County, W. Va.

By Hope Natural Gas Co., 445 W. Main St., Clarksburg, W. Va.  
 On 234.76 acres, surface owned by O. C. Davis, R. F. D. No. 2,  
 Salem, W. Va.; owner of mineral rights, unknown.

Elevation, 1124' L.

6-5/8" casing, 2154'.

Coal was encountered at 856-860'.

Abandonment reported to Dept. of Mines Oct. 4, 1935.

Well was not shot.

Water not recorded.

Gas well; now exhausted.

	Top.	Bottom.	Thickness.
Pittsburgh Coal	856	- 860	4
Dunkard Sand	1400	- 1460	60
Salt Sand	1765	- 1828	63
Big Lime	2140	- 2190	50
Big Injun Sand (gas, 2210')	2190	- 2298	108
Gordon Stray Sand	2931	- 2947	16
Gordon Sand (gas, 2933')	2970	- 2975	5
Total depth			3028

Clarkburg, A. Va.,  
 WELL NO 236  
 Farm Joshua Davis  
 Address

NO. 2  
 FORMATION RECORD

Name	Color	Character	Oil, Gas or Water	Top	Bottom	Thickness	Total Depth	Remarks
Pittsburgh Coal				856	860	4'		
Dunkard Sand				1400	1460	60'		
Sals Sand				1765	1828	63'		
Big Lime				2140	2190	50'		
Big Injun Sand				2190	2298	108'		
Gordon Stray Sand			Gas-2210	2931	2947	16'		
Gordon Sand			Gas-2935	2970	2975	5'	3028	

234 acres

Well was not shot at \_\_\_\_\_ feet; well was shot at \_\_\_\_\_ feet  
 Salt Fresh water at \_\_\_\_\_ feet; fresh water at \_\_\_\_\_ feet  
 Well was producing \_\_\_\_\_ bbl. Not exhausted. \_\_\_\_\_ day  
 October 4, 1935.  
 Approved Hope Natural Gas Company  
 Owner

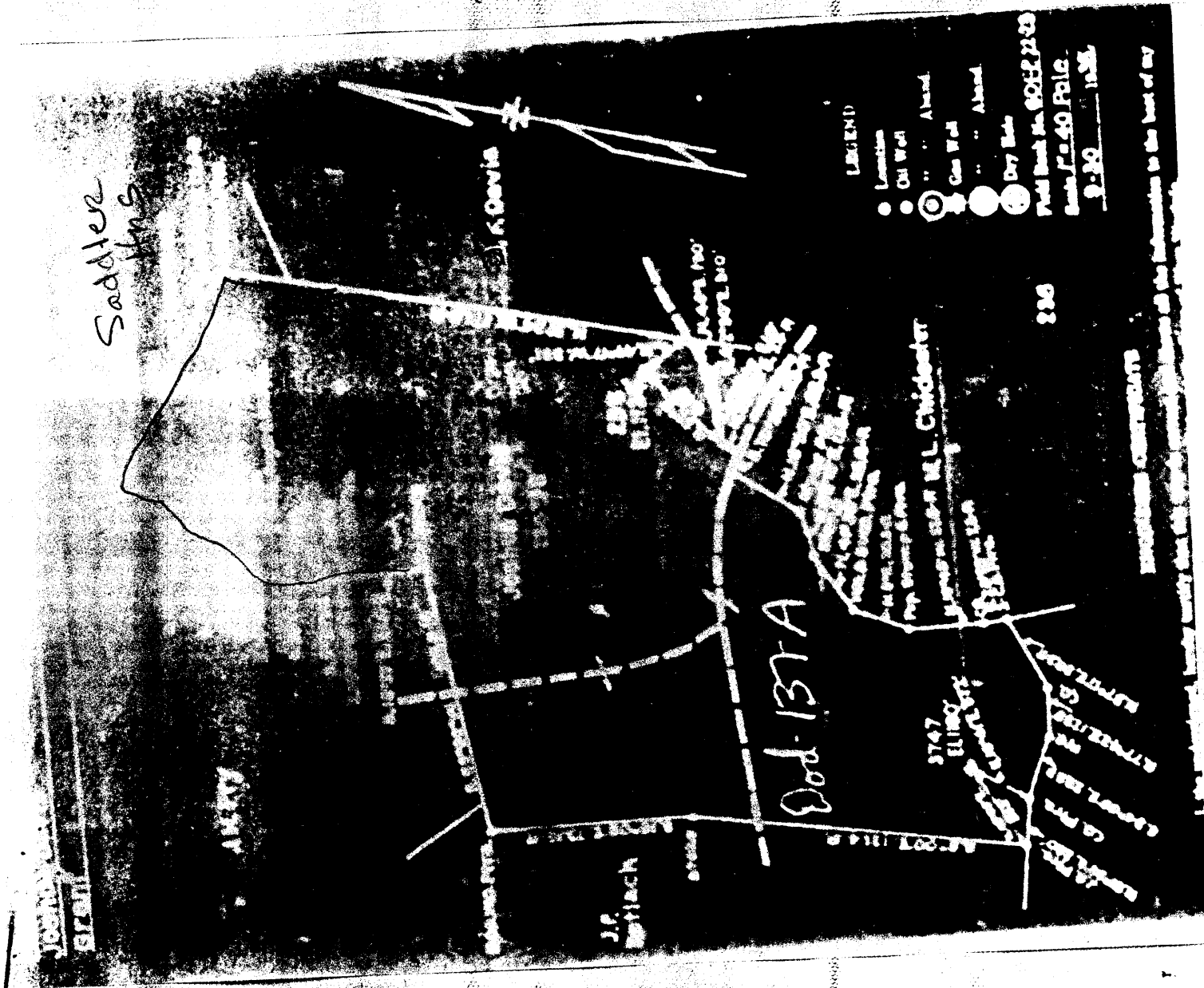

PLUGGING AND FILLING WELL

CLARKSBURG, W. VA.

No coal operations in this section.
Clarksville, W. Va.
Coal Owner: Un known.

Well No. 238
County: Boone
District: Boone

The well and gas problems are still under lease by the above named company, and this well is drilled under permit issued by the West Virginia Department of Mines, Oil and Gas Division.

Direction of wellhead top of well: 23.94'

The number of feet of shafthead and casing used in this well:

Table with 3 columns: Material, Length, and Diameter. Includes entries for 2 1/2 inch casing, 4 inch casing, and 6 inch casing.

Casing was cemented at 805 feet, 485 inches, and at 825 feet, 485 inches, and at 845 feet, 485 inches.

Lanes were used as follows: (See details)
October 25th, 1935.
Boone Natural Gas Company, Boone, W. Va.

WEST VIRGINIA DEPARTMENT OF MINES

CLARKSBURG, W. VA.

No coal operations in this section.
Clarksville, W. Va.
Coal Owner: Un known.

Well No. 238
County: Boone
District: Boone

AFFIDAVIT

STATE OF WEST VIRGINIA,
County of Boone

Thomas F. Stum and Thomas A. Statler being first duly sworn according to law depose and say that they are experienced in the work of plugging and filling oil and gas wells and were employed by Boone Natural Gas Company, well operator, and participated in the work of plugging and filling the above well, that said work was commenced on the 5th day of October, 1935, and that the well was plugged and filled in

Manner in which said well was plugged: Filled hole with clay mud from bottom to 2911, 20 feet above Gordon tray and placed a suitable cement plug and a wood plug. Installed permanent bridge at 2318, 30' above the big Injun sand, and temporarily filled with clay mud to 2170, 20' above the big Injun sand. Placed 6-5/8" wood rod, lead wool, and cement plugs. Removed 6-5/8" casing, set at 2154'. Installed permanent bridge at 1490, 30' below Dunkard Sand, and filled with clay mud to 1425'. Dunkard Sand, and placed cement plug. Installed permanent bridge at 890, 30' below Pittsborough Coal, and filled with cement to 836, 20' above Coal seam. From this point to the surface the hole was filled with clay mud to surface, and a concrete monument was erected over the hole.

Description of monument: 10 x 8 x 5 with inscription HNGCO. # 238.

and that the work of plugging and filling said well was completed on the 15 day of October, 1935.
And further deponents with me.

Thomas A. Statler
Thomas F. Stum