

Latitude 39°25'00"

80°37'30"

Longitude

75
+

Topo Location

7.5' Loc. 1.745 15' Loc. 1.745
2.00 W (calc.) 4.234

Company _____

Farm John A. Davis et al #2

15' Quad Centerpoint C
(sec.)

7.5' Quad Center Point

District McClellan

WELL LOCATION PLAT

County 017 Permit 30108

McClellan District, Doddridge County, W. Va.
 South Penn Oil Co., Chamber of Commerce Bldg., Pittsburgh, Pa.
 On 150 acres, surface and mineral rights owned by Icie L. Davis
 et al., Salem, W. Va.

Elevation, 825.24' L.

10" casing, 228' (pulled); 8 $\frac{1}{2}$ " 1071' 3" (pulled); 6-5/8", 1875'.

Coal was encountered at 526-530'

Abandonment reported to Dept. of Mines June 5, 1935.

Well was shot 6-27-05, with 40 qts.

	Top.	Bottom.
Pittsburgh Coal	526	
Big Injun Sand (gas and show of oil, 1887'; 2nd pay, 1980')	1862	
Total depth		2000

COMPLETION DATA SHEET
NO 2

FORMATION RECORD

Member of Commerce Club,
Pittsburgh, Pa.
Address

Well No. S.A. John A. Davis Farm.

Name	Color	Character	Oil, Gas or Water	Top	Bottom	Thickness	Total Depth	Remarks
Pittsburgh Coal Big Injun sand				528 1062				
		Gas & show of oil 1887						
		second pay		1900				
				2000			2000	
Total Depth								

Well was ~~drilled~~ 6-27-05, 40 ft. ft.; well was shot at
ft.

Producing ft.; fresh water at
ft.

Well was ~~drilled~~ ft.
 Approved By Ellen E. [Signature] Owner
 SOUTH PINE OIL COMPANY
 Lead Agent.
 Date June 5, 1935.

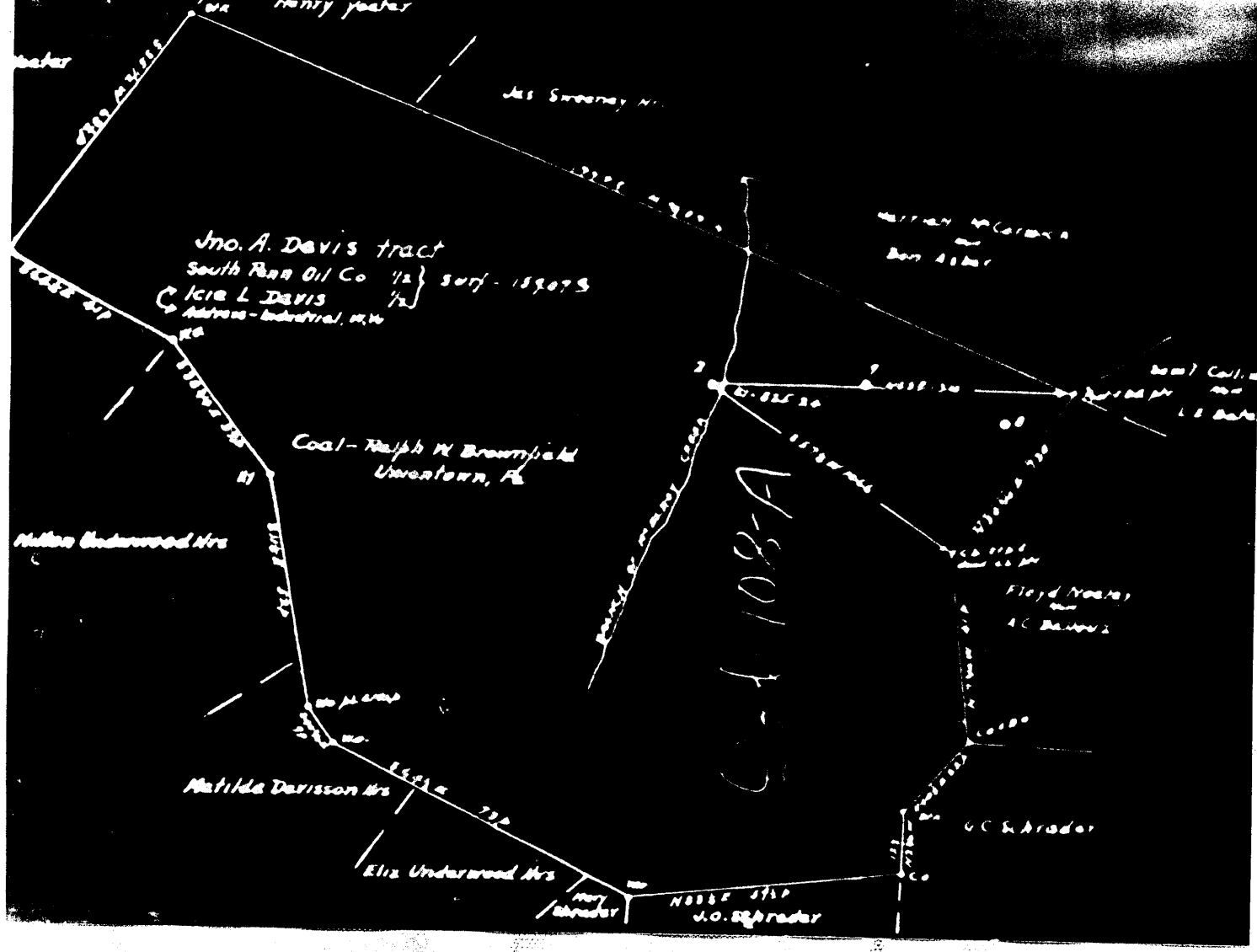

AFFIDAVIT IN TRIPLICATE TO TIME AND MANNER OF PLUGGING AND FILLING WELL

(Approved by Section 5, Article 1, Chapter 53 of the Code)

**WEST VIRGINIA DEPARTMENT OF MINES
OIL AND GAS DIVISION**

Ralph W. Brownfield
 WELL OPERATOR OR OWNER
 Montomton, Pa.
 SOUTH PENN OIL COMPANY
 Chamber of Commerce Bldg.
 Pittsburgh, Pa.
 October 7, 19 35.
 WELL AND LOCATION
 McClellan District
 Doddridge County
 Well No. 2
 JOHN A. DAVIS Farm

AFFIDAVIT

STATE OF WEST VIRGINIA,
 County of Wetzel
 I, A. S. Haught
 being first duly sworn according to law depose and say that they are experienced in the work of plugging and filling oil and gas wells and were employed by South Penn Oil Company well operator, and participated in the work of plugging and filling the above well, that said work was commenced on the 22nd day of July 19 35, and that the well was plugged and filled in the following manner:

Manner in which well was plugged:
 Total depth 2006'. Filled with stone and red clay to 1842'. Set 6-5/8" wood plug at 1842' to 1839'. Set cement plug at 1839' to 1829'. Filled with stone and red clay to 1800'. Set 6-5/8" wood plug at 1800' to 1597'. Set cement plug at 1597' to 1597'. Filled with stone and red clay to 1550'. 6-5/8" casing would not pull, and was cut and 403' pulled up to 596', leaving 1472' in hole below cut. Set 6-5/8" wood plug at 1550' to 1347'. Set cement plug at 1347' to 1337'. Filled hole at 700'. Filled with stone and red clay to 560'. (Pittsburgh Coal 526'). Set Morning Glory Packer at 560' with 2" vent pipe below packer, and 2" vent pipe from packer to top of ground. Cemented from 560' to 506'. Pulled remainder of 403' of 6-5/8" casing. Filled with stone and red clay solid from 506' to top of ground.

Description of measurement: Erected monument at top of ground with closed top 8" perforated nipple in accordance with rule 18, 1931 Regulations.
 NOTE: 228' of 10" casing and 1071' of 8 1/2" casing was pulled when well was drilled.
 (This above measurement may be in error, and in accordance with the provisions of section 16, article 4, chapter 53 of the Code)
 and that the work of plugging and filling said well was completed on the 15th day of October 19 35.

And further deposed and sworn to by
A. S. Haught
 Subscribed and sworn to before me on this _____ day of _____ 1935.

 Notary Public

WEST VIRGINIA DEPARTMENT OF MINES

OIL AND GAS DIVISION

PRELIMINARY DATA SHEET NO. 1

File No. Dod 108 A Well No. 2
 SOUTH PENN OIL Company of Chamber of Commerce Bldg.
Pittsburgh, Pa. on the John A. Davis Farm
 containing 150 acres. Location McClellan District in Doddridge County, West Virginia
 The surface of the above tract is owned in fee by John L. Davis et al
 of Salem, West Va. address, and the mineral rights are owned by
John L. Davis of Salem, West Va.

The oil and gas privileges are held under lease by the above named company, and this well is drilled under permit issued by the West Virginia Department of Mines, Oil and Gas Division.

Elevation of surface at top of well 825.24' Spirit Barometric

The number of feet of the different sized casings used in the well.

228 (Pulled)	feet	10"	size, cas.	feet	Wood conductor
1071.5 (Pulled)	feet	8-1/4"	size, cas.	feet	lined cas.
1875	feet	6-5/8"	size, cas.	feet	lined cas.

_____ packer of _____ size, set at _____ feet
 _____ packer of _____ size, set at _____ feet
 _____ in casing perforated at _____ feet to _____ feet
 _____ in casing perforated at _____ feet to _____ feet

Coal was encountered at 526 feet, thickness 48(7) inches, and at _____ feet; thickness _____ inches; and at _____ feet; thickness _____ inches.
 Layers were used as follows: (Give details) _____

June 5, 1935. Date.