



Antero Resources Corporation
Appalachian Basin
Locke Pad
Doddridge County

Quadrangle: Oxford
Watershed: South Fork Hughes River
District: Southwest
Date: 12-21-2021

12/15/2023

LATITUDE 39°12'30"

11,718'

LATITUDE 39°12'30" 1,489' TO BOTTOM HOLE

Antero Resources Corporation
Well No. Osborne #1H

SOUTHWEST DISTRICT DODDRIDGE COUNTY	
8-05	LARRY SANDER
8-06	JOHN WATKINS
9-07	BRIAN PRIM
9-08	ROBERT LEE BROWNFIELD JR
9-09	ANTERO RESOURCES CORPORATION
9-10	DELBERT OSBORNE
9-14	KERRY JUNKINS
9-15	ROBERT LEE BROWNFIELD JR
12-01	DAVID BALL JR

NOTES:

WELL 1H TOP HOLE INFORMATION:
N: 249,765ft E: 1,622,119ft
LAT: 39°10'41.00" LON: 80°49'58.80"
BOTTOM HOLE INFORMATION:
N: 250,074ft E: 1,620,540ft
LAT: 39°10'43.82" LON: 80°50'18.91"
WEST VIRGINIA COORDINATE SYSTEM OF 1927 NORTH ZONE ZONE WAS DERIVED FROM MEASUREMENTS TAKEN WITH TRIMBLE GEOXT SUBMETER MAPPING GRADE GPS UNIT. PLAT ORIENTATION, CORNER AND WELL REFERENCE TIE LINES ARE BASED ON GRID NORTH.

(NAD) 83 (UTM) ZONE 17 COORDS:
WELL 1H TOP HOLE INFORMATION:
N: 4,336,559m E: 514,439m
BOTTOM HOLE INFORMATION:
N: 4,336,645m E: 513,957m

(NAD) 27 (UTM) ZONE 17 COORDS:
WELL 1H TOP HOLE INFORMATION:
N: 14,226,812ft E: 1,687,742ft
POINT OF ENTRY INFORMATION:
N: 14,226,633ft E: 1,686,353ft
BOTTOM HOLE INFORMATION:
N: 14,227,094ft E: 1,686,159ft

NOTE
NO OCCUPIED DWELLINGS OR BUILDINGS TWO THOUSAND FIVE HUNDRED (2,500) SQUARE FEET OR LARGER USED TO HOUSE OR SHELTER DAIRY CATTLE OR POULTRY HUSBANDRY ARE LOCATED WITHIN SIX HUNDRED TWENTY-FIVE (625) FEET OF THE CENTER OF THE WELL PAD.

WV NORTH ZONE
GRID NORTH

10,743' TO BOTTOM HOLE

11,028'

LONGITUDE 80°50'00"

LONGITUDE 80°47'30"

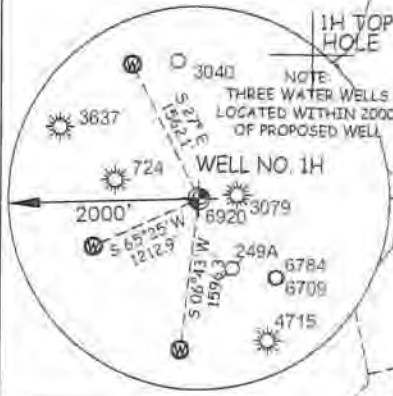

I, THE UNDERSIGNED, HEREBY CERTIFY THAT THIS PLAT IS CORRECT TO THE BEST OF MY KNOWLEDGE AND BELIEF AND SHOWS ALL THE INFORMATION REQUIRED BY LAW AND THE RULES ISSUED AND PERSCRIBED BY THE DEPARTMENT OF ENVIRONMENTAL PROTECTION.



STATE OF WEST VIRGINIA DIVISION
OF ENVIRONMENTAL PROTECTION,
OFFICE OF OIL AND GAS

WILLOW LAND SURVEYING PLLC
220 MASONIC AVE. PENNSBORO
WEST VIRGINIA 26415

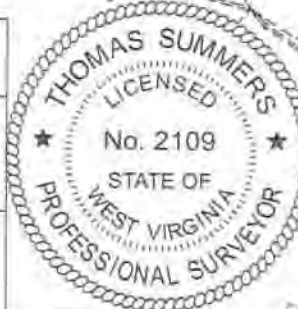

JOB # 23-019WA
DRAWING # OSBORNE1HS
SCALE 1" = 2000'
MINIMUM DEGREE OF ACCURACY SUBMETER
PROVEN SOURCE OF ELEV. SUBMETER MAPPING GRADE GPS

LEGEND
--- Surface Owner Boundary Lines +/-
--- Adjoining Surface Tracts +/-
⊕ Found monument, as noted

Thomas Summers
THOMAS SUMMERS P.S. 2109



STATE OF WEST VIRGINIA
DEPARTMENT OF ENERGY
DIVISION OF OIL AND GAS

DATE 10/25/23
OPERATOR'S WELL# OSBORNE UNIT #1H

WELL TYPE: OIL ___ GAS LIQUID INJECTION ___ WASTE DISPOSAL ___ 47 - 017 - 06972
(IF "GAS") PRODUCTION STORAGE ___ DEEP ___ SHALLOW STATE COUNTY PERMIT
LOCATION: ELEVATION 1,100.5' - AS BUILT WATERSHED SOUTH FORK HUGHES RIVER
QUADRANGLE OXFORD 7.5' DISTRICT SOUTHWEST COUNTY DODDRIDGE
SURFACE OWNER ANTERO RESOURCES CORPORATION ACREAGE 59.74 ACRES +/- 12/15/2023
OIL & GAS ROYALTY OWNER E.W. OSBORNE ET AL LEASE ACREAGE 180 AC+

PROPOSED WORK: DRILL CONVERT ___ DRILL DEEPER ___ REDRILL ___ FRACTURE OR STIMULATE
PLUG OFF OLD FORMATION ___ PERFORATE NEW FORMATION OTHER PHYSICAL CHANGE IN WELL
(SPECIFY) PLUG & ABANDON CLEAN OUT & REPLUG
TARGET FORMATION MARCELLUS ESTIMATED DEPTH 7,000' TVD 9,800' MD
WELL OPERATOR ANTERO RESOURCES CORP DESIGNATED AGENT KEVIN ELLIS
ADDRESS 1615 WYNKOOP ST ADDRESS 636 WHITE OAKS BLVD
FORM WW-6 DENVER, CO 80202 BRIDGEPORT, WV 26330

COUNTY NAME PERMIT