

1,508' to Bottom Hole

4,228' to Top Hole
TOP HOLE LATITUDE 39 - 12 - 30
BTM HOLE LATITUDE 39 - 10 - 00

LONGITUDE 80 - 40 - 00

7,600' to Top Hole

7,171' to Bottom Hole

Antero Resources
Well No. Castilow 1H
BHL MOD
Antero Resources Corporation

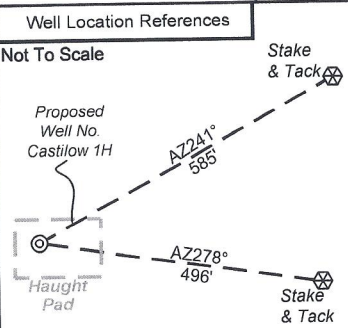
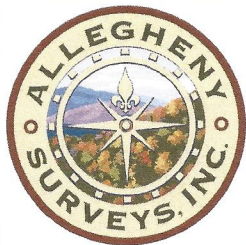

I, the undersigned, hereby certify that this plat is correct to the best of my knowledge and belief and shows all the information required by law and the rules issued and prescribed by the Department of Environmental Protection.

Bradley D. Miller, P.S. 2167

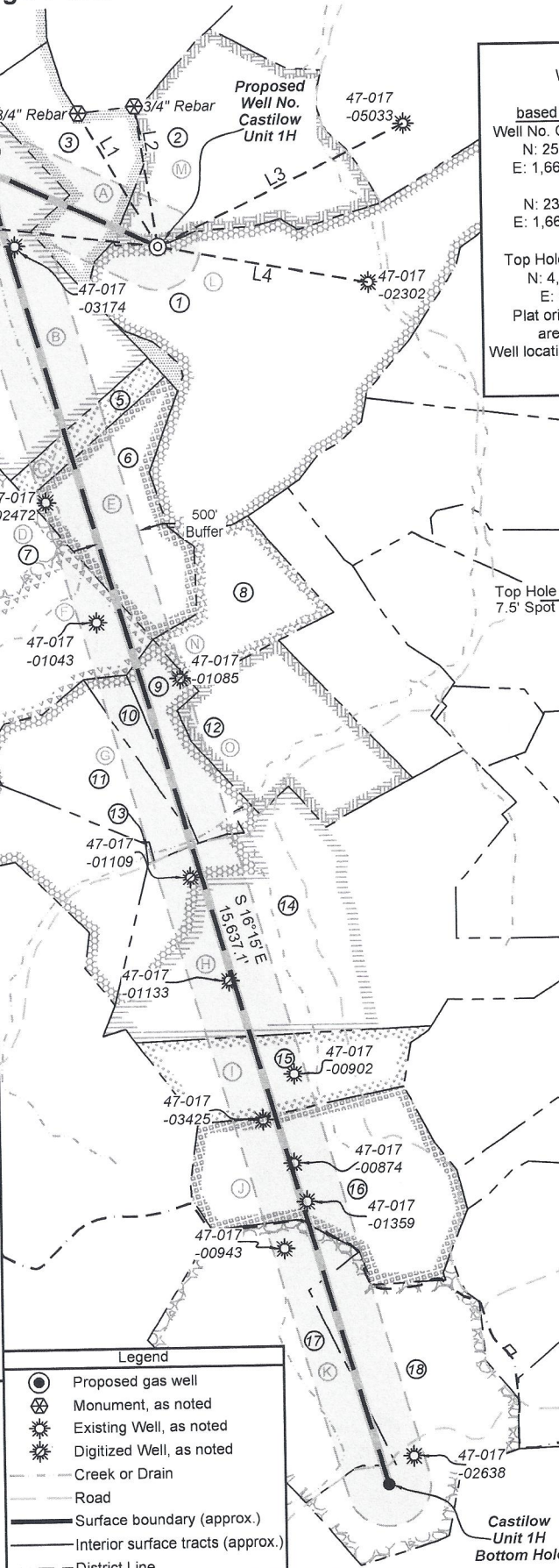
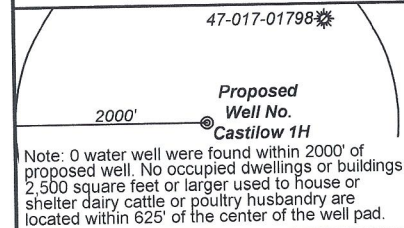
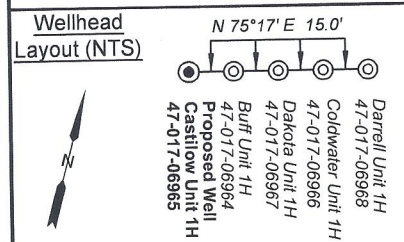

Notes
West Virginia Coordinate System of 1927, North Zone based upon Differential GPS Measurements.
Well No. Castilow Unit 1H Top Hole coordinates are
N: 252,592.54' Latitude: 39°11'14.89"
E: 1,665,085.49' Longitude: 80°40'53.69"
Bottom Hole coordinates are
N: 237,811.41' Latitude: 39°08'49.13"
E: 1,667,613.82' Longitude: 80°40'19.14"
UTM Zone 17, NAD 1983
Top Hole Coordinates Bottom Hole Coordinates
N: 4,337,638.500m N: 4,333,148.336m
E: 527,514.765m E: 528,360.121m
Plat orientation and corner and well references are based upon the grid north meridian.
Well location references are based upon the magnetic meridian.

Notes:
Well No. Castilow Unit 1H
UTM Zone 17, NAD 1927
Top Hole Coordinates
N: 14,230,353.39'
E: 1,730,640.28'
Point of Entry Coordinates
N: 14,230,553.81'
E: 1,728,790.03'
Bottom Hole Coordinates
N: 14,215,621.79'
E: 1,733,413.53'

	Bearing	Dist.
L1	S 30°00' E	1,852.8'
L2	S 08°42' E	1,698.0'
L3	S 64°02' W	3,271.1'
L4	N 79°56' W	2,535.4'
L5	N 82°52' W	1,861.7'

- Legend
- Proposed gas well
 - Monument, as noted
 - Existing Well, as noted
 - Digitized Well, as noted
 - Creek or Drain
 - Road
 - Surface boundary (approx.)
 - Interior surface tracts (approx.)
 - District Line

RECEIVED
Office of Grand Cas
DEC 13 2023

WV Department of Environmental Protection
New Milton Cove

STATE OF WEST VIRGINIA
DEPARTMENT OF ENVIRONMENTAL PROTECTION
OIL AND GAS DIVISION

FILE NO: 265-30-N-22
DRAWING NO: Castilow 1H Well Plat
SCALE: 1" = 2000'
MINIMUM DEGREE OF ACCURACY: Submeter
PROVEN SOURCE OF ELEVATION: WVDOT, Harrisville, WV

DATE: November 16 2023
OPERATOR'S WELL NO. Castilow 1H
API WELL NO
47 - 017 - 06965
STATE COUNTY PERMIT

WELL TYPE: OIL GAS LIQUID INJECTION WASTE DISPOSAL
(IF GAS) PRODUCTION: STORAGE DEEP SHALLOW

LOCATION: ELEVATION: Proposed 1,194' TH: New Milton WATERSHED: Headwaters Middle Island Creek QUADRANGLE: New Milton
DISTRICT: BH: Cove Susan Haught COUNTY: Doddridge
SURFACE OWNER: Gido, et al ACREAGE: 264
ROYALTY OWNER: O.C. Haught, et ux LEASE NO: ACREAGE: 264

PROPOSED WORK: DRILL CONVERT DRILL DEEPER FRACTURE OR STIMULATE PLUG OFF OLD FORMATION
 PERFORATE NEW FORMATION OTHER PHYSICAL CHANGE IN WELL (SPECIFY) BHL MOD 7,700' TVD
 PLUG AND ABANDON CLEAN OUT AND REPLUG TARGET FORMATION: Marcellus Shale ESTIMATED DEPTH: 26,600' MD

WELL OPERATOR: Antero Resources Corporation DESIGNATED AGENT: Kevin Ellis
ADDRESS: 1615 Wynkoop Street ADDRESS: 535 White Oaks Blvd.
Denver, CO 80202 Bridgeport, WV 26330



Leases	
A	Franklin Maxwell Heirs, LP
B	Denver Cox, et ux
C	Ralph Lee & Deloris Cox
D	Jack E. & Dorothea Webber
E	Kenneth R. Mason, et ux
F	Frank Hinter, et al
G	O.C. Haught, et al
H	O.C. Haught, et al
I	Embra D. White
J	AMP IV, LP
K	H.B. Gum, et ux
L	O.C. Haught, et ux
M	Haught Family Trust
N	Mary K. Post Revocable Trust - 2017, et al
O	Mary K. Post Revocable Trust - 2017, et al

ID	TM-Par	Owner	Bk/Pg	Acres
1	15-15	Susan Haught Gido, et al	WB62/407	264.00
2	15-6	Susan Haught Gido, et al	WB62/407	119.23
3	15-5	David E. Bowyer, et al	389/715	64.00
4	15-14	Ralph & Deloris Cox	223/187	207.50
5	15-16	Ralph & Deloris Cox	223/187	15.25
6	15-17	Denver W., Jr. & Mary Beth Cox	223/185	69.21
7	15-13	Harold J. Hastings	174/74	346.16
8	15-18	Susan Haught Gido, et al	WB62/407	37.39
9	19-4.2	Eileen Squitiro	183/341	29.84
10	19-4.1	Paul Eisenkramer	171/515	12.80
11	19-4.3	Luke Squitiro	WB54/253	53.61
12	19-5	Susan Haught Gido, et al	WB62/407	86.26
13	19-4.4	Luke Squitiro	512/497	0.29
14	19-7	Susan Haught Gido, et al	WB62/407	269.50
15	19-19	Rezall M. Crislip, et al	349/484	63.20
16	19-15	AMP IV LP	444/354	108.56
17	6-5	Troy S. Gum	364/465	130.00
18	7-1	Mary Ann Gum	WB30/102	130.00

RECEIVED
Office of Oil and Gas

DEC 13 2023

WV Department of
Environmental Protection

FILE NO: 265-30-N-22
DRAWING NO: Castilow 1H Well Plat
SCALE: 1" = 2000'
MINIMUM DEGREE OF ACCURACY:
Submeter
PROVEN SOURCE OF ELEVATION:
WVDOT, Harrisville, WV

STATE OF WEST VIRGINIA
DEPARTMENT OF ENVIRONMENTAL PROTECTION
OIL AND GAS DIVISION

DATE: November 16 2023
OPERATOR'S WELL NO. Castilow 1H
API WELL NO
47 - 017 - 06965
STATE COUNTY PERMIT

WELL TYPE: OIL GAS LIQUID INJECTION WASTE DISPOSAL
(IF GAS) PRODUCTION: STORAGE DEEP SHALLOW
LOCATION: ELEVATION: Proposed 1,194' WATERSHED: Headwaters Middle Island Creek QUADRANGLE: New Milton
DISTRICT: BH:Cove Susan Haught COUNTY: Doddridge
SURFACE OWNER: Gido, et al ACREAGE: 264
ROYALTY OWNER: O.C. Haught, et ux LEASE NO: _____ ACREAGE: 264
PROPOSED WORK: DRILL CONVERT DRILL DEEPER FRACTURE OR STIMULATE PLUG OFF OLD FORMATION
 PERFORATE NEW FORMATION OTHER PHYSICAL CHANGE IN WELL (SPECIFY) BHL MOD
 PLUG AND ABANDON CLEAN OUT AND REPLUG TARGET FORMATION: Marcellus Shale ESTIMATED DEPTH: 26,600' MD 7,700' TVD

WELL OPERATOR: Antero Resources Corporation DESIGNATED AGENT: Kevin Ellis
ADDRESS: 1615 Wynkoop Street ADDRESS: 535 White Oaks Blvd.
Denver, CO 80202 Bridgeport, WV 26330