

Antero Resources Corporation
Appalachian Basin
Haught Pad
Doddridge County

Quadrangle: New Milton
Watershed: Middle Island Creek
District: New Milton
Date: 11-7-2022

**Antero Resources
Well No. Buff 1H**

Antero Resources Corporation

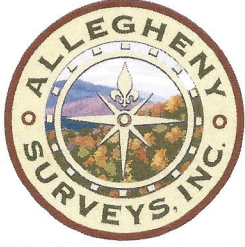

Leases	
A	O.C. Haught, et ux
B	Haught Family Trust
C	Franklin Maxwell Heirs
D	Dorothy A. Kohler

ID	TM-Par	Owner	Bk/Pg	Acres
1	15-15	Susan Haught Gido, et al	WB62/407	264.00
2	15-6	Susan Haught Gido, et al	WB62/407	119.23
3	15-5	David E. Bowyer, et al	389/715	64.00
4	15-14	Ralph & Deloris Cox	223/187	207.50

Notes
West Virginia Coordinate System of 1927, North Zone
based upon Differential GPS Measurements
Well No. Buff Unit 1H Top Hole coordinates are
N: 252,596.35' Latitude: 39°11'14.93"
E: 1,665,099.99' Longitude: 80°40'53.51"
Bottom Hole coordinates are
N: 251,862.25' Latitude: 39°11'07.60"
E: 1,664,551.32' Longitude: 80°41'00.36"
UTM Zone 17, NAD 1983
Top Hole Coordinates Bottom Hole Coordinates
N: 4,337,639.735m N: 4,337,413.305m
E: 527,519.166m E: 527,355.742m
Plat orientation and corner and well references are based upon the grid north meridian.
Well location references are based upon the magnetic meridian.

Well Location References

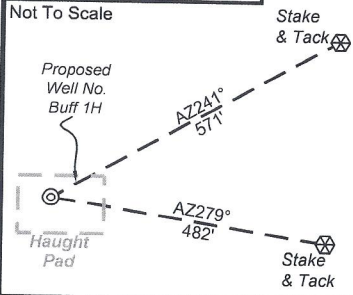

I, the undersigned, hereby certify that this plat is correct to the best of my knowledge and belief and shows all the information required by law and the rules issued and prescribed by the Department of Environmental Protection.

Bradley D. Miller
Bradley D. Miller, P.S. 2167

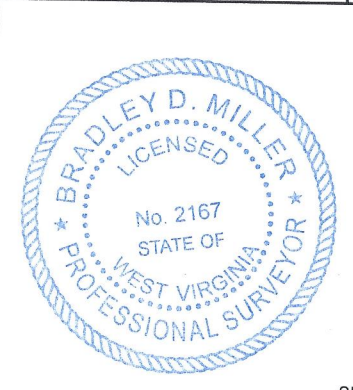

Note: 0 water well were found within 2000' of proposed well. No occupied dwellings or buildings 2,500 square feet or larger used to house or shelter dairy cattle or poultry husbandry are located within 625' of the center of the well pad.

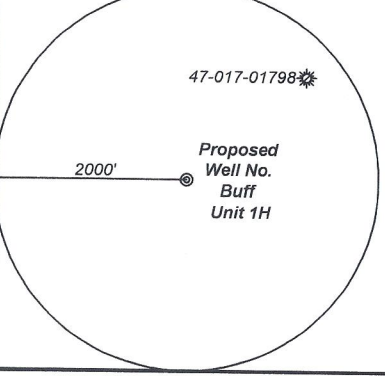

	Bearing	Dist.
L1	S 30°54' E	1,860.9'
L2	S 09°42' E	1,695.1'
L3	S 63°56' W	3,241.7'
L4	N 79°39' W	2,508.2'
L5	S 69°45' E	734.9'

Legend

- Proposed gas well
- Monument, as noted
- Existing Well, as noted
- Digitized Well, as noted
- Creek or Drain
- Road
- Surface boundary (approx.)
- Interior surface tracts (approx.)

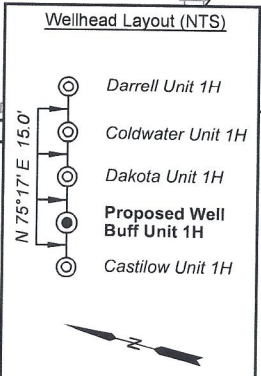

Notes:
Well No. Buff Unit 1H
UTM Zone 17, NAD 1927
Top Hole Coordinates
N: 14,230,357.44'
E: 1,730,654.71'
Point of Entry Coordinates
N: 14,230,091.74'
E: 1,729,969.78'
Bottom Hole Coordinates
N: 14,229,614.57'
E: 1,730,118.55'

FILE NO: 245-30-N-23
DRAWING NO: Buff 1H Well Plat
SCALE: 1" = 1000'
MINIMUM DEGREE OF ACCURACY: Submeter
PROVEN SOURCE OF ELEVATION: WVDOT, Harrisville, WV

STATE OF WEST VIRGINIA
DEPARTMENT OF ENVIRONMENTAL PROTECTION
OIL AND GAS DIVISION

DATE: August 18 2023
OPERATOR'S WELL NO. Buff 1H
API WELL NO
47 - 017 - 06964
STATE COUNTY PERMIT

WELL TYPE: OIL GAS LIQUID INJECTION WASTE DISPOSAL
(IF GAS) PRODUCTION: STORAGE DEEP SHALLOW
Proposed 1,194'
LOCATION: ELEVATION: Existing 1,190' WATERSHED: Headwaters Middle Island Creek QUADRANGLE: New Milton
DISTRICT: New Milton SURFACE OWNER: Susan Haught Gido, et al COUNTY: Doddridge
ROYALTY OWNER: O.C. Haught, et ux LEASE NO: ACREAGE: 264
PROPOSED WORK: DRILL CONVERT DRILL DEEPER FRACTURE OR STIMULATE PLUG OFF OLD FORMATION
 PERFORATE NEW FORMATION OTHER PHYSICAL CHANGE IN WELL (SPECIFY)
 PLUG AND ABANDON CLEAN OUT AND REPLUG TARGET FORMATION: Marcellus Shale ESTIMATED DEPTH: 7,700' TVD 10,200' MD

WELL OPERATOR: Antero Resources Corporation DESIGNATED AGENT: Kevin Ellis
ADDRESS: 1615 Wynkoop Street ADDRESS: 535 White Oaks Blvd.
Denver, CO 80202 Bridgeport, WV 26330

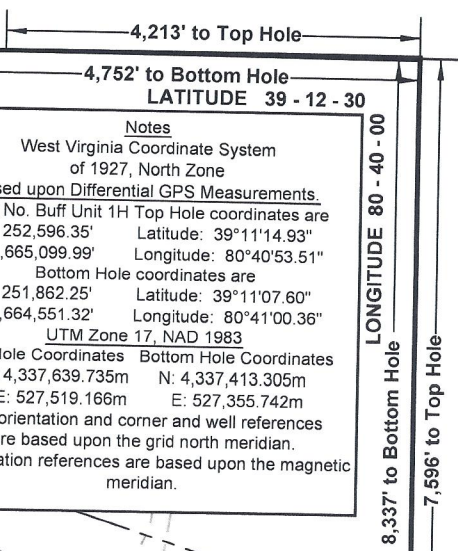

LONGITUDE 80 - 40 - 00
8,337' to Bottom Hole
7,596' to Top Hole