

LATITUDE 39°12'30" 118'

LATITUDE 39°10'00"

10,232' TO BOTTOM HOLE

6,471' TO BOTTOM HOLE

11,250'

LONGITUDE 80°47'30"

LONGITUDE 80°50'00"

Antero Resources Corporation Well No. Stope #2H

AS DRILLED DATA: WELL 2H TOP HOLE INFORMATION: N: 249,547ft E: 1,621,903ft LAT: 39°10'38.81" LON: 80°50'01.49" BOTTOM HOLE INFORMATION: N: 239,126ft E: 1,623,452ft LAT: 39°08'56.05" LON: 80°49'39.87" WEST VIRGINIA COORDINATE SYSTEM OF 1927 NORTH ZONE. ZONE WAS DERIVED FROM MEASUREMENTS TAKEN WITH TRIMBLE GEOXT SUBMETER MAPPING GRADE GPS UNIT. PLAT ORIENTATION, CORNER, AND WELL REFERENCE TIE LINES ARE BASED ON GRID NORTH.

(NAD) 83 (UTM) ZONE 17 COORDS: WELL 2H TOP HOLE INFORMATION: N: 4,336,491m E: 514,375m BOTTOM HOLE INFORMATION: N: 4,333,324m E: 514,900m

(NAD) 27 (UTM) ZONE 17 COORDS: WELL 2H TOP HOLE INFORMATION: N: 14,226,589ft E: 1,687,531ft POINT OF ENTRY INFORMATION: N: 14,226,238ft E: 1,685,794ft BOTTOM HOLE INFORMATION: N: 14,216,200ft E: 1,689,252ft

WV NORTH ZONE GRID NORTH

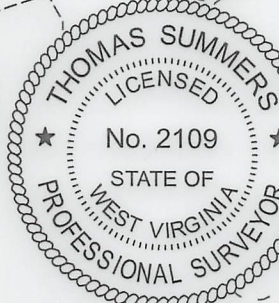
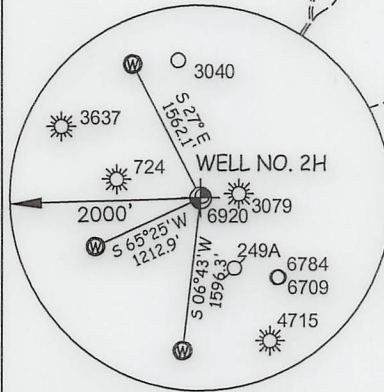

I THE UNDERSIGNED, HEREBY CERTIFY THAT THIS PLAT IS CORRECT TO THE BEST OF MY KNOWLEDGE AND BELIEF AND SHOWS ALL THE INFORMATION REQUIRED BY LAW AND THE RULES ISSUED AND PRESCRIBED BY THE DEPARTMENT OF ENVIRONMENTAL PROTECTION.



STATE OF WEST VIRGINIA, DIVISION OF ENVIRONMENTAL PROTECTION, OFFICE OF OIL AND GAS

WILLOW LAND SURVEYING PLLC 220 MASONIC AVE. PENNSBORO WEST VIRGINIA 26415

Table listing landowners and lease information for the Southwest District - Doddridge County. Includes names like Larry Gander, John Waitkus, Brian Prim, Robert Lee Brownfield Jr., Antero Resources Corporation, Delbert Osborne, Stephen Harris, Anthony Ramey, Gary Sanchez, Kerry Junkins, Robert Lee Brownfield Jr., Hunter Jenkins, David Ball Jr., David Ball Jr., James Haught, and Mansfield Leeson, Hunter Jenkins, Jacqueline Payne, Harold Hinzman, Ernest Seeds, Michael McCloy, Dana Long, James Haught, James Haught, Floyd Stout Jr., Judith Moran, Steven Adams, Dana Long, Robert Lee Brownfield Jr., Coy Adams, and Utahona Williams.

JOB # 21-005WA DRAWING # STOPE2HAD SCALE 1" = 2000' MINIMUM DEGREE OF ACCURACY SUBMETER PROVEN SOURCE OF ELEV. SUBMETER MAPPING GRADE GPS STATE OF WEST VIRGINIA DEPARTMENT OF ENERGY DIVISION OF OIL AND GAS

LEGEND: Surface Owner Boundary Lines +/-, Interior Surface Tracts +/-, Proposed Well Path, As Drilled Well Path. Signature of Thomas Summers P.S. 2109. DATE 10/24/23 OPERATOR'S WELL# STOPE #2H

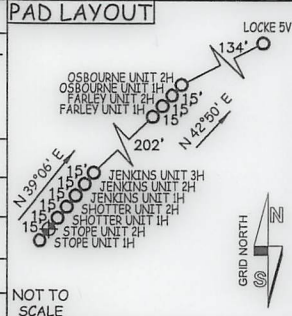

NOTE: 1. NO OCCUPIED DWELLINGS OR BUILDINGS TWO THOUSAND FIVE HUNDRED (2,500) SQUARE FEET OR LARGER USED TO HOUSE OR SHELTER DAIRY CATTLE OR POULTRY HUSBANDRY ARE LOCATED WITHIN SIX HUNDRED TWENTY-FIVE (625) FEET OF THE CENTER OF THE WELL PAD. 2. TOP HOLE DATA SHOWN HEREON WAS PROVIDED BY ANTERO RESOURCES CORPORATION. 3. AS DRILLED DATA WAS PROVIDED BY ANTERO RESOURCES CORPORATION. 4. WLS IS NOT CERTIFYING THE DATA AND INFORMATION PROVIDED LISTED IN NOTES 2 AND 3, ONLY THE RELATIONSHIP TO THE DATA AND INFORMATION PROVIDED TO THE LEASE BOUNDARIES. 5. WLS IS BY NO MEANS RESPONSIBLE FOR ANY ERRORS OR INACCURACIES WITH THE DATA AND INFORMATION THAT HAS BEEN PROVIDED.

WELL TYPE: OIL \_\_\_ GAS x LIQUID INJECTION \_\_\_ WASTE DISPOSAL \_\_\_ 47 - 017 - 06948 (IF "GAS") PRODUCTION x STORAGE \_\_\_ DEEP \_\_\_ SHALLOW x STATE COUNTY PERMIT LOCATION: ELEVATION 1,100.5' - AS BUILT WATERSHED SOUTH FORK HUGHES RIVER QUADRANGLE OXFORD 7.5' DISTRICT SOUTHWEST COUNTY DODDRIDGE SURFACE OWNER ANTERO RESOURCES CORPORATION ACREAGE 59.74 ACRES +/- OIL & GAS ROYALTY OWNER E. W. OSBORNE ET AL LEASE ACREAGE 180 ACRES±

PROPOSED WORK: DRILL \_\_\_ CONVERT \_\_\_ DRILL DEEPER \_\_\_ REDRILL \_\_\_ FRACTURE OR STIMULATE \_\_\_ PLUG OFF OLD FORMATION \_\_\_ PERFORATE NEW FORMATION \_\_\_ OTHER PHYSICAL CHANGE IN WELL (SPECIFY) AS DRILLED PLUG & ABANDON CLEAN OUT & REPLUG TARGET FORMATION MARCELLUS ESTIMATED DEPTH 6,509' TVD 17,808' MD WELL OPERATOR ANTERO RESOURCES CORP. DESIGNATED AGENT KEVIN ELLIS ADDRESS 1615 WYNKOOP ST. ADDRESS 535 WHITE OAKS BLVD