

State of West Virginia
Department of Environmental Protection - Office of Oil and Gas
Well Operator's Report of Well Work

API 47 - 017 - 06948 County Doddridge District Southwest
Quad Oxford 7.5' Pad Name Locke Field/Pool Name -----
Farm name Antero Resources Corporation Well Number Stope Unit 2H
Operator (as registered with the OOG) Antero Resources Corporation
Address 1615 Wynkoop Street City Denver State CO Zip 80202

As Drilled location NAD 83/UTM Attach an as-drilled plat, profile view, and deviation survey
Top hole Northing 4336491m Easting 514375m
Landing Point of Curve Northing 4328284m Easting 543066m
Bottom Hole Northing 4333324m Easting 514900m

Elevation (ft) 1100.5' GL Type of Well New Existing Type of Report Interim Final
Permit Type Deviated Horizontal Horizontal 6A Vertical Depth Type Deep Shallow
Type of Operation Convert Deepen Drill Plug Back Redrilling Rework Stimulate
Well Type Brine Disposal CBM Gas Oil Secondary Recovery Solution Mining Storage Other _____
Type of Completion Single Multiple Fluids Produced Brine Gas NGL Oil Other _____
Drilled with Cable Rotary

Drilling Media Surface hole Air Mud Fresh Water Intermediate hole Air Mud Fresh Water Brine
Production hole Air Mud Fresh Water Brine
Mud Type(s) and Additive(s)
Air - Foam & 4% KCL
Mud - Polymer

Date permit issued 1/30/2023 Date drilling commenced 3/2/2023 Date drilling ceased 4/28/2023
Date completion activities began 6/13/2023 Date completion activities ceased 7/31/2023
Verbal plugging (Y/N) N/A Date permission granted N/A Granted by N/A

Please note: Operator is required to submit a plugging application within 5 days of verbal permission to plug

Freshwater depth(s) ft 775, 781' Open mine(s) (Y/N) depths No
Salt water depth(s) ft 1733, 1750' Void(s) encountered (Y/N) depths No
Coal depth(s) ft N/A Cavern(s) encountered (Y/N) depths No
Is coal being mined in area (Y/N) No

RECEIVED
Office of Oil and Gas
OCT 27 2023
WVA Department of
Environmental Protection

Reviewed by:
K.G. Nulubez
12/08/2023

API 47-017 - 06948 Farm name Antero Resources Corporation Well number Stope Unit 2H

CASING STRINGS	Hole Size	Casing Size	Depth	New or Used	Grade wt/ft	Basket Depth(s)	Did cement circulate (Y/N) * Provide details below*
Conductor	28"	20"	130'	New	91.59#, J-55	N/A	Y
Surface	17-1/2"	13-3/8"	451'	New	54.5#, J-55	N/A	Y
Coal							
Intermediate 1	12-1/4"	9-5/8"	2961'	New	36#, J-55	N/A	Y
Intermediate 2							
Intermediate 3							
Production	8-3/4"/8-1/2"	5-1/2"	17808'	New	23#, P-110-ICY	N/A	Y
Tubing		2-3/8"	7057'		4.7#, P-110		
Packer type and depth set		N/A					

Comment Details _____

CEMENT DATA	Class/Type of Cement	Number of Sacks	Slurry wt (ppg)	Yield (ft ³ /sks)	Volume (ft ³)	Cement Top (MD)	WOC (hrs)
Conductor	Class A	204 sx	15.6	1.18	241	0'	8 Hrs.
Surface	Class A	418 sx	15.8	1.17	486	0'	8 Hrs.
Coal							
Intermediate 1	Class A	1095 sx	15.8	1.16	1270	0'	8 Hrs.
Intermediate 2							
Intermediate 3							
Production	Class H	1790 sx (Lead)	12.5 (Lead), 11.5 (Tail)	2.17 (Lead), 2.65 (Tail)	4744	~500' into Intermediate Casing	8 Hrs.
Tubing							

Drillers TD (ft) 21300' MD, 7000' TVD (BHL), (Deepest Point Drilled) Loggers TD (ft) 21300' MD
 Deepest formation penetrated Marcellus Plug back to (ft) N/A
 Plug back procedure N/A

Kick off depth (ft) 6000'

RECEIVED
Office of Oil and Gas
OCT 27 2023
Department of Environmental Protection

Check all wireline logs run caliper density deviated/directional induction
 neutron resistivity gamma ray temperature

Well cored Yes No Conventional Sidewall Were cuttings collected Yes No

DESCRIBE THE CENTRALIZER PLACEMENT USED FOR EACH CASING STRING _____
 Conductor - 0
 Surface - 1 above guide shoe, 1 above insert float, 1 every 4th joint to surface
 Intermediate - 1 above float joint, 1 above float collar, 1 every 4th joint to surface
 Production - 1 above float joint, 1 below float collar, 1 every 3rd joint to top of cement

WAS WELL COMPLETED AS SHOT HOLE Yes No DETAILS _____

WAS WELL COMPLETED OPEN HOLE? Yes No DETAILS _____

WERE TRACERS USED Yes No TYPE OF TRACER(S) USED N/A

12/08/2023

API 47-017-06948 Farm Name Antero Resources Corporation Well Number Stone Unit 2H

Exhibit 1

Stage No.	Perforation Date	Perforated from MD ft.	Perforated to MD ft.	Number of Perforations	Formations
1	6/13/2023	17672.5	17629.6	60	Marcellus
2	6/14/2023	17592.19744	17427.1846	60	Marcellus
3	6/14/2023	17391.78205	17226.7692	60	Marcellus
4	6/15/2023	17191.36667	17026.3538	60	Marcellus
5	6/15/2023	16990.95128	16825.9385	60	Marcellus
6	6/16/2023	16790.5359	16625.5231	60	Marcellus
7	6/16/2023	16590.12051	16425.1077	60	Marcellus
8	6/17/2023	16389.70513	16224.6923	60	Marcellus
9	6/17/2023	16189.28974	16024.2769	60	Marcellus
10	6/18/2023	15988.87436	15823.8615	60	Marcellus
11	6/18/2023	15788.45897	15623.4462	60	Marcellus
12	6/18/2023	15588.04359	15423.0308	60	Marcellus
13	6/19/2023	15387.62821	15222.6154	60	Marcellus
14	6/20/2023	15187.21282	15022.2	60	Marcellus
15	6/20/2023	14986.79744	14821.7846	60	Marcellus
16	6/21/2023	14786.38205	14621.3692	60	Marcellus
17	6/21/2023	14585.96667	14420.9538	60	Marcellus
18	6/22/2023	14385.55128	14220.5385	60	Marcellus
19	6/22/2023	14185.1359	14020.1231	60	Marcellus
20	6/22/2023	13984.72051	13819.7077	60	Marcellus
21	6/23/2023	13784.30513	13619.2923	60	Marcellus
22	6/23/2023	13583.88974	13418.8769	60	Marcellus
23	6/23/2023	13383.47436	13218.4615	60	Marcellus
24	6/23/2023	13183.05897	13018.0462	60	Marcellus
25	6/24/2023	12982.64359	12817.6308	60	Marcellus
26	6/24/2023	12782.22821	12617.2154	60	Marcellus
27	6/24/2023	12581.81282	12416.8	60	Marcellus
28	6/24/2023	12381.39744	12216.3846	60	Marcellus
29	6/24/2023	12180.98205	12015.9692	60	Marcellus
30	6/25/2023	11980.56667	11815.5538	60	Marcellus
31	6/25/2023	11780.15128	11615.1385	60	Marcellus
32	6/25/2023	11579.7359	11414.7231	60	Marcellus
33	6/25/2023	11379.32051	11214.3077	60	Marcellus
34	6/26/2023	11178.90513	11013.8923	60	Marcellus
35	6/26/2023	10978.48974	10813.4769	60	Marcellus
36	6/26/2023	10778.07436	10613.0615	60	Marcellus
37	6/26/2023	10577.65897	10412.6462	60	Marcellus
38	6/26/2023	10377.24359	10212.2308	60	Marcellus
39	6/27/2023	10176.82821	10011.8154	60	Marcellus
40	6/27/2023	9976.412821	9811.4	60	Marcellus
41	6/27/2023	9775.997436	9610.98462	60	Marcellus
42	6/27/2023	9575.582051	9410.56923	60	Marcellus
43	6/27/2023	9375.166667	9210.15385	60	Marcellus
44	6/28/2023	9174.751282	9009.73846	60	Marcellus
45	6/28/2023	8974.335897	8809.32308	60	Marcellus
46	6/28/2023	8773.920513	8608.90769	60	Marcellus
47	6/28/2023	8573.505128	8408.49231	60	Marcellus
48	6/29/2023	8373.089744	8208.07692	60	Marcellus
49	6/29/2023	8172.674359	8007.66154	60	Marcellus
50	6/29/2023	7972.258974	7807.24615	60	Marcellus
51	6/29/2023	7771.84359	7606.83077	60	Marcellus
52	6/29/2023	7571.428205	7406.41538	60	Marcellus
53	6/29/2023	7371.012821	7206	60	Marcellus

RECEIVED
Office of Oil and Gas
OCT 27 2023
WV Department of
Environmental Protection

12/08/2023

API 47-017-06948 Farm Name Antero Resources Corporation Well Number Stope Unit 2H

EXHIBIT 2

Stage No.	Stimulations Date	Avg Pump Rate	Avg Treatment Pressure (PSI)	Max Breakdown Pressure (PSI)	ISIP (PSI)	Amount of Proppant (lbs)	Amount of Water (bbls)	Amount of Nitrogen/ other (units)
1	6/13/2023	73.7	7806.2	6768.9	3393.0	161070	4751.0	N/A
2	6/14/2023	89.7	8390.9	5194.4	3550.0	416230	7307.4	N/A
3	6/14/2023	92.7	8471.5	5861.9	3126.3	412890	7272.7	N/A
4	6/15/2023	97.3	8440.4	5058.8	3154.0	411900	6870.4	N/A
5	6/15/2023	96.8	8452.2	5393.4	3093.0	415370	7086.4	N/A
6	6/16/2023	96.2	8540.9	5932.4	3596.0	411180	7094.7	N/A
7	6/16/2023	97.8	8468.7	3253.8	3398.0	409780	7081.7	N/A
8	6/17/2023	96.4	8458.1	3026.7	3755.0	396030	7064.0	N/A
9	6/17/2023	97.8	8549.0	4590.0	3460.0	407000	7082.5	N/A
10	6/18/2023	94.5	8406.3	5443.8	3321.4	400620	6907.7	N/A
11	6/18/2023	97.8	8341.0	4855.6	3414.0	408990	7031.3	N/A
12	6/18/2023	98.7	8508.9	3180.7	3645.0	411750	6995.7	N/A
13	6/19/2023	96.3	8507.3	5499.0	3279.0	414460	6989.2	N/A
14	6/20/2023	96.6	8582.1	5531.6	3565.0	415650	7059.2	N/A
15	6/20/2023	91.5	8432.5	5636.2	3485.0	401970	6997.6	N/A
16	6/21/2023	94.8	8520.5	5823.2	3282.0	414650	7016.4	N/A
17	6/21/2023	96.7	8609.8	5531.4	3133.0	414580	7076.9	N/A
18	6/22/2023	96.9	8371.4	5309.6	3409.0	401870	6868.0	N/A
19	6/22/2023	97.7	8605.7	5952.0	3295.0	409890	6953.7	N/A
20	6/22/2023	95.7	8637.1	5514.9	3201.0	397950	6824.0	N/A
21	6/23/2023	96.9	8360.5	5677.7	3326.0	400090	6803.0	N/A
22	6/23/2023	97.7	8397.9	6221.9	3037.0	399580	6816.1	N/A
23	6/23/2023	97.1	8162.2	3944.0	3520.0	398270	6845.5	N/A
24	6/23/2023	96.3	8376.9	5559.5	3148.0	414150	7085.8	N/A
25	6/24/2023	98.2	8210.6	5359.0	3371.0	397010	6953.0	N/A
26	6/24/2023	98.2	8257.2	5044.5	2980.0	406880	6992.9	N/A
27	6/24/2023	97.6	8023.1	6532.9	3021.0	414900	7022.5	N/A
28	6/24/2023	97.4	8154.6	6165.1	3142.0	404810	6939.4	N/A
29	6/24/2023	93.7	8003.9	5145.4	3068.0	411990	6841.0	N/A
30	6/25/2023	98.4	8067.0	5396.0	3241.0	415340	7014.6	N/A
31	6/25/2023	94.5	8039.8	6738.8	2842.0	404390	6927.7	N/A
32	6/25/2023	96.9	7918.5	6194.4	2980.0	400280	6844.5	N/A
33	6/25/2023	97.0	7845.9	5920.5	2958.0	416740	7184.7	N/A
34	6/26/2023	98.2	7392.8	4429.9	3148.0	416740	6965.7	N/A
35	6/26/2023	97.9	7816.6	5614.7	2876.0	413230	6905.4	N/A
36	6/26/2023	97.7	7520.9	3978.2	3015.0	400600	6875.5	N/A
37	6/26/2023	96.1	7440.5	3528.5	2852.5	414380	6882.0	N/A
38	6/26/2023	95.1	7326.7	4556.8	2926.0	410230	6866.4	N/A
39	6/27/2023	98.4	7573.0	5121.3	2921.0	404300	6884.6	N/A
40	6/27/2023	97.3	7483.0	6053.1	2964.0	400800	6700.6	N/A
41	6/27/2023	97.8	7416.3	4616.7	3049.0	416160	7116.8	N/A
42	6/27/2023	96.7	7543.6	6028.7	3066.0	413300	7015.3	N/A
43	6/27/2023	99.2	7511.8	6100.4	2922.0	401600	6992.2	N/A
44	6/28/2023	98.0	7172.0	3777.9	3090.0	399200	7082.5	N/A
45	6/28/2023	95.8	7275.7	5177.0	3072.0	399380	6910.2	N/A
46	6/28/2023	97.3	6930.4	4754.3	2900.0	398560	6893.9	N/A
47	6/28/2023	99.4	7130.2	5313.6	3042.0	399800	6847.4	N/A
48	6/29/2023	98.7	7266.6	5879.7	2809.0	414990	7040.5	N/A
49	6/29/2023	99.5	6986.3	6104.7	2729.6	396850	6777.5	N/A
50	6/29/2023	97.8	7005.7	5952.8	2920.0	405120	7034.8	N/A
51	6/29/2023	97.2	6741.8	6419.3	3136.0	413440	7166.0	N/A
52	6/29/2023	98.5	6776.3	5965.9	2901.0	410260	7182.9	N/A
53	6/29/2023	99.5	6300.3	3262.5	2913.0	415950	7206.9	N/A
	AVERAGE	96	7,916	5,281	3,159	21,363,150	367,949	TOTAL

RECEIVED
Office of Oil and Gas

OCT 27 2023

WV Department of
Environmental Protection

12/08/2023

EXHIBIT 3

LITHOLOGY/ FORMATION	TOP DEPTH (TVD)	BOTTOM DEPTH (TVD)	TOP DEPTH (MD)	BOTTOM DEPTH (MD)
	From Surface	From Surface	From Surface	From Surface
Sandstone	120	470	120	470
Sandy Siltstone	470	620	470	620
Siltstone, occ SS	620	770	620	770
Sandy Siltstone, occ LS	770	870	770	870
Siltstone, occ SS, tr LS	870	970	870	970
Silty Sandstone, tr shale	970	1,070	970	1,070
Sandstone	1,070	1,170	1,070	1,170
Silty Sandstone	1,170	1,270	1,170	1,270
Shaly Siltstone, tr coal	1,270	1,370	1,270	1,370
Sandy Siltstone, occ shale	1,370	1,620	1,370	1,620
Silty Sandstone, tr coal	1,620	1,870	1,620	1,870
Siltstone, occ LS	1,870	1,857	1,870	1,895
Big Lime	1,887	2,404	1,895	2,475
Fifty Foot Sandstone	2,404	2,535	2,445	2,616
Gordon	2,535	2,832	2,586	2,934
Fifth Sandstone	2,832	2,956	2,904	3,067
Bayard	2,956	3,635	3,037	3,807
Speechley	3,635	3,802	3,777	3,986
Balltown	3,802	4,427	3,956	4,643
Bradford	4,427	4,830	4,613	5,074
Benson	4,830	5,068	5,044	5,334
Alexander	5,068	6,301	5,304	6,691
Sycamore	6,090	6,271	6,433	6,661
Middlesex	6,271	6,385	6,661	6,869
Burkett	6,385	6,434	6,869	7,022
Tully	6,434	6,465	7,022	7,154
Marcellus	6,465	NA	7,154	NA

*Please note Antero determines formation tops based on mud logs that are only run on one well on a multi-well pad. The measured depth (MD) data on subsequent wells may be slightly different due to the well's unique departure.

RECEIVED
Office of Oil and Gas

OCT 27 2023

WV Department of
Environmental Protection

12/08/2023

Hydraulic Fracturing Fluid Product Component Information Disclosure

Job Start Date:	6/13/2023
Job End Date:	6/29/2023
State:	West Virginia
County:	Doddridge
API Number:	47-017-06948-00-00
Operator Name:	Antero Resources Corporation
Well Name and Number:	Stope 2H
Latitude:	39.17753200
Longitude:	-80.83357400
Datum:	WGS84
Federal Well:	NO
Indian Well:	NO
True Vertical Depth:	6,539
Total Base Water Volume (gal):	15,984,222
Total Base Non Water Volume:	0



Hydraulic Fracturing Fluid Composition:

Trade Name	Supplier	Purpose	Ingredients	Chemical Abstract Service Number (CAS #)	Maximum Ingredient Concentration in Additive (% by mass)**	Maximum Ingredient Concentration in HF Fluid (% by mass)**	Comments
Produced Water	Halliburton	Base Fluid					
			Water	7732-18-5	100.00000	86.24337	Density = 8.50
Ingredients	Listed Above	Listed Above					
			Water	7732-18-5	100.00000	0.17022	

RECEIVED
 Office of Oil and Gas
 OCT 27 2023
 WV Department of Environmental Protection

WG-36 GELLING AGENT	Halliburton	Gelling Agent					
				Listed Below			
HYDROCHLORIC ACID, 22 BAUME	Halliburton	Solvent					
				Listed Below			
FDP-S1464-22	Halliburton	Friction Reducer					
				Listed Below			
FDP-S1463-22	Halliburton	Friction Reducer					
				Listed Below			
OPTIFLO-II DELAYED RELEASE BREAKER	Halliburton	Breaker					
				Listed Below			
MC B-8614A	MultiChem	Biocide					
				Listed Below			
Sand-Common White-100 Mesh, SSA-2	Halliburton	Proppant					
				Listed Below			
HAI-501	Halliburton	Acid Corrosion Inhibitor					
				Listed Below			

RECEIVED
 Office of Oil and Gas
 OCT 27 2023
 Environmental Protection
 WV Department of

Items above are Trade Names with the exception of Base Water . Items below are the individual ingredients.

			Crystalline silica, quartz	14808-60-7	100.00000	13.56066	
			Hydrochloric acid	7647-01-0	30.00000	0.03932	
			Complex amine compound	Proprietary	60.00000	0.03085	
			Hydrotreated distillate	Proprietary	30.00000	0.01542	
			Guar gum	9000-30-0	100.00000	0.00485	
			Fatty nitrogen derived amides	Proprietary	5.00000	0.00257	
			Ammonium chloride	12125-02-9	5.00000	0.00257	
			Ethoxylated alcohol	Proprietary	5.00000	0.00257	
			Glutaraldehyde	111-30-8	30.00000	0.00250	
			Sorbitan, mono-9-octadecenoate, (Z)	1338-43-8	1.00000	0.00051	
			Sorbitan monooleate polyoxyethylene derivative	9005-65-6	1.00000	0.00051	
			Alkyl (C12-16) dimethylbenzyl ammonium chloride	68424-85-1	5.00000	0.00042	
			Methanol	67-56-1	100.00000	0.00025	
			Ammonium persulfate	7727-54-0	100.00000	0.00009	
			Ethanol	64-17-5	1.00000	0.00008	
			Modified thiourea polymer	Proprietary	30.00000	0.00007	
			Mixture of dimer and trimer fatty acids of indefinite composition derived from tall oil	61790-12-3	30.00000	0.00007	
			Oxylated phenolic resin	Proprietary	30.00000	0.00003	
			Propargyl alcohol	107-19-7	5.00000	0.00001	
			Ethoxylated alcohols	Proprietary	5.00000	0.00001	
			Hexadecene	629-73-2	5.00000	0.00001	
			C.I. pigment Orange 5	3468-63-1	1.00000	0.00000	
			Polyacrylate	Proprietary	30.00000		
			Hydrotreated light petroleum distillate	64742-47-8	30.00000		

RECEIVED
 Office of Oil and Gas
 OCT 27 2023
 WV Department of
 Environmental Protection

			Inorganic salt	Proprietary	10.00000		
--	--	--	----------------	-------------	----------	--	--

* Total Water Volume sources may include various types of water including fresh water, produced water, and recycled water

** Information is based on the maximum potential for concentration and thus the total may be over 100%

*** If you are calculating a percentage of total ingredients do not add the water volume below the green line to the water volume above the green line

Note: For Field Development Products (products that begin with FDP), MSDS level only information has been provided.

Ingredient information for chemicals subject to 29 CFR 1910.1200(i) and Appendix D are obtained from suppliers Material Safety Data Sheets (MSDS)

RECEIVED
Office of Oil and Gas
OCT 27 2023
WV Department of
Environmental Protection

LATITUDE 39°12'30" 118'

LATITUDE 39°10'00"

10,232' TO BOTTOM HOLE

6,471' TO BOTTOM HOLE

1,250'

LONGITUDE 80°47'30"

LONGITUDE 80°50'00"

Antero Resources Corporation Well No. Stope #2H

AS DRILLED DATA: WELL 2H TOP HOLE INFORMATION: N: 249,547ft E: 1,621,903ft LAT: 39°10'38.81" LON: 80°50'01.49" BOTTOM HOLE INFORMATION: N: 239,126ft E: 1,623,452ft LAT: 39°08'56.05" LON: 80°49'39.87" WEST VIRGINIA COORDINATE SYSTEM OF 1927 NORTH ZONE. ZONE WAS DERIVED FROM MEASUREMENTS TAKEN WITH TRIMBLE GEOXT SUBMETER MAPPING GRADE GPS UNIT. PLAT ORIENTATION, CORNER, AND WELL REFERENCE TIE LINES ARE BASED ON GRID NORTH.

(NAD) 83 (UTM) ZONE 17 COORDS: WELL 2H TOP HOLE INFORMATION: N: 4,336,491m E: 514,375m BOTTOM HOLE INFORMATION: N: 4,333,324m E: 514,900m

(NAD) 27 (UTM) ZONE 17 COORDS: WELL 2H TOP HOLE INFORMATION: N: 14,226,589ft E: 1,687,531ft POINT OF ENTRY INFORMATION: N: 14,226,238ft E: 1,685,794ft BOTTOM HOLE INFORMATION: N: 14,216,200ft E: 1,689,252ft

WV NORTH ZONE GRID NORTH

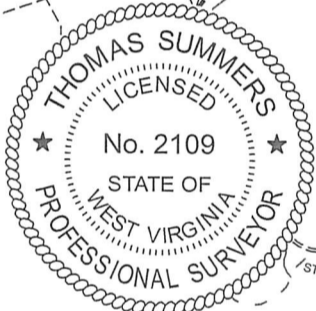
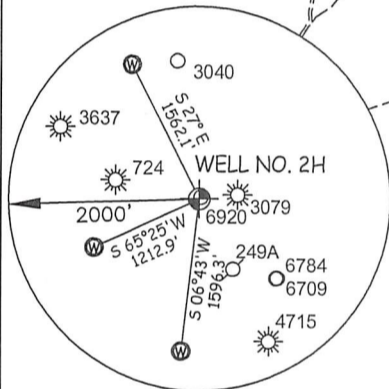

I THE UNDERSIGNED, HEREBY CERTIFY THAT THIS PLAT IS CORRECT TO THE BEST OF MY KNOWLEDGE AND BELIEF AND SHOWS ALL THE INFORMATION REQUIRED BY LAW AND THE RULES ISSUED AND PRESCRIBED BY THE DEPARTMENT OF ENVIRONMENTAL PROTECTION.



STATE OF WEST VIRGINIA, DIVISION OF ENVIRONMENTAL PROTECTION, OFFICE OF OIL AND GAS

WILLOW LAND SURVEYING PLLC 220 MASONIC AVE. PENNSBORO WEST VIRGINIA 26415

Table with 3 columns: Well ID, Owner Name, and Well ID. Lists owners such as LARRY GANDER, JOHN WAITKUS, BRIAN PRIM, ROBERT LEE BROWNFIELD JR., ANTERO RESOURCES CORPORATION, DELBERT OSBORNE, STEPHEN HARRIS, etc.

JOB # 21-005WA DRAWING # STOPE2HAD SCALE 1" = 2000' MINIMUM DEGREE OF ACCURACY SUBMETER PROVEN SOURCE OF ELEV. SUBMETER MAPPING GRADE GPS STATE OF WEST VIRGINIA DEPARTMENT OF ENERGY DIVISION OF OIL AND GAS

LEGEND: Surface Owner Boundary Lines +/-, Interior Surface Tracts +/-, Proposed Well Path, As Drilled Well Path. Includes signature of Thomas Summers and date 10/24/23. OPERATOR'S WELL# STOPE #2H

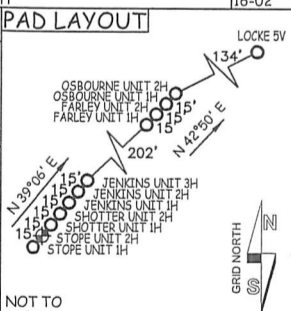

- NOTE: 1. NO OCCUPIED DWELLINGS OR BUILDINGS TWO THOUSAND FIVE HUNDRED (2,500) SQUARE FEET OR LARGER USED TO HOUSE OR SHELTER DAIRY CATTLE OR POULTRY HUSBANDRY ARE LOCATED WITHIN SIX HUNDRED TWENTY-FIVE (625) FEET OF THE CENTER OF THE WELL PAD. 2. TOP HOLE DATA SHOWN HEREON WAS PROVIDED BY ANTERO RESOURCES CORPORATION. 3. AS DRILLED DATA WAS PROVIDED BY ANTERO RESOURCES CORPORATION. 4. WLS IS NOT CERTIFYING THE DATA AND INFORMATION PROVIDED LISTED IN NOTES 2 AND 3, ONLY THE RELATIONSHIP TO THE DATA AND INFORMATION PROVIDED TO THE LEASE BOUNDARIES. 5. WLS IS BY NO MEANS RESPONSIBLE FOR ANY ERRORS OR INACCURACIES WITH THE DATA AND INFORMATION THAT HAS BEEN PROVIDED.

WELL TYPE: OIL ___ GAS X LIQUID INJECTION ___ WASTE DISPOSAL 47 - 017 - 06948 (IF "GAS") PRODUCTION X STORAGE ___ DEEP ___ SHALLOW X STATE COUNTY PERMIT LOCATION: ELEVATION 1,100.5' - AS BUILT WATERSHED SOUTH FORK HUGHES RIVER QUADRANGLE OXFORD 7.5' DISTRICT SOUTHWEST COUNTY DODDRIDGE SURFACE OWNER ANTERO RESOURCES CORPORATION ACREAGE 59.74 ACRES +/- LEASE ACREAGE 180 ACRES± 12/08/2023

PROPOSED WORK: DRILL ___ CONVERT ___ DRILL DEEPER ___ REDRILL ___ FRACTURE OR STIMULATE ___ PLUG OFF OLD FORMATION ___ PERFORATE NEW FORMATION ___ OTHER PHYSICAL CHANGE IN WELL (SPECIFY) AS DRILLED PLUG & ABANDON CLEAN OUT & REPLUG TARGET FORMATION MARCELLUS ESTIMATED DEPTH 6,509' TVD 17,808' MD WELL OPERATOR ANTERO RESOURCES CORP. DESIGNATED AGENT KEVIN ELLIS ADDRESS 1615 WYNKOOP ST. ADDRESS 535 WHITE OAKS BLVD BRIDGEPORT, WV 26330

COUNTY NAME

PERMIT

LATITUDE 39°12'30" 118'

LATITUDE 39°10'00"

10,232' TO BOTTOM HOLE

6,471' TO BOTTOM HOLE

11,250'

LONGITUDE 80°47'30"

LONGITUDE 80°50'00"

Antero Resources Corporation Well No. Stope #2H

AS DRILLED DATA: WELL 2H TOP HOLE INFORMATION: N: 249,547ft E: 1,621,903ft LAT: 39°10'38.81" LON: 80°50'01.49" BOTTOM HOLE INFORMATION: N: 239,126ft E: 1,623,452ft LAT: 39°08'56.05" LON: 80°49'39.87" WEST VIRGINIA COORDINATE SYSTEM OF 1927 NORTH ZONE. ZONE WAS DERIVED FROM MEASUREMENTS TAKEN WITH TRIMBLE GEOXT SUBMETER MAPPING GRADE GPS UNIT. PLAT ORIENTATION, CORNER, AND WELL REFERENCE TIE LINES ARE BASED ON GRID NORTH.

(NAD) 83 (UTM) ZONE 17 COORDS: WELL 2H TOP HOLE INFORMATION: N: 4,336,491m E: 514,375m BOTTOM HOLE INFORMATION: N: 4,333,324m E: 514,900m

(NAD) 27 (UTM) ZONE 17 COORDS: WELL 2H TOP HOLE INFORMATION: N: 14,226,589ft E: 1,687,531ft POINT OF ENTRY INFORMATION: N: 14,226,238ft E: 1,685,794ft BOTTOM HOLE INFORMATION: N: 14,216,200ft E: 1,689,252ft

WV NORTH ZONE GRID NORTH

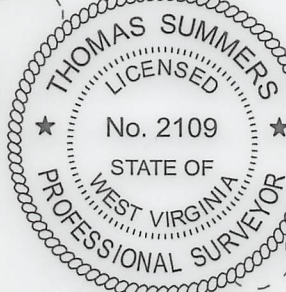
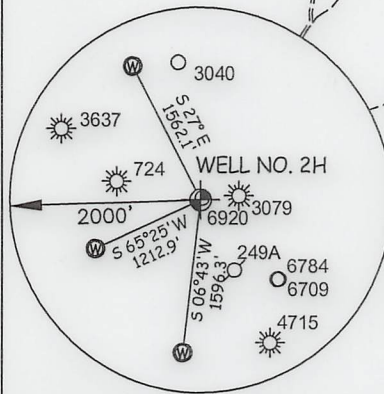

I THE UNDERSIGNED, HEREBY CERTIFY THAT THIS PLAT IS CORRECT TO THE BEST OF MY KNOWLEDGE AND BELIEF AND SHOWS ALL THE INFORMATION REQUIRED BY LAW AND THE RULES ISSUED AND PRESCRIBED BY THE DEPARTMENT OF ENVIRONMENTAL PROTECTION.



STATE OF WEST VIRGINIA, DIVISION OF ENVIRONMENTAL PROTECTION, OFFICE OF OIL AND GAS

WILLOW LAND SURVEYING PLLC 220 MASONIC AVE. PENNSBORO WEST VIRGINIA 26415

Table with 3 columns: SURVEYOR, SURVEYOR, SURVEYOR. Lists names of surveyors for various tracts, including LARRY GANDER, JOHN WAITKUS, BRYAN PRIM, ROBERT LEE BROWNFIELD JR., ANTERO RESOURCES CORPORATION, DELBERT OSBORNE, STEPHEN HARRIS, ANTHONY RAMEY, GARY SANCHEZ, KERRY JUNKINS, ROBERT LEE BROWNFIELD JR., HUNTER JENKINS, DAVID BALL JR., DAVID BALL JR., JAMES HAUGHT, MANSFIELD LEESEON, HUNTER JENKINS, JACQUELINE PAYNE, HAROLD HINZMAN, ERNEST SEEDS, MICHAEL MCCLOY, DANA LONG, JAMES HAUGHT, FLOYD STOUT JR., JUDITH MORAN, STEVEN ADAMS, DANA LONG, ROBERT LEE BROWNFIELD JR., COY ADAMS, and UTAHONA WILLIAMS.

JOB # 21-005WA DRAWING # STOPE2HAD SCALE 1" = 2000' MINIMUM DEGREE OF ACCURACY SUBMETER PROVEN SOURCE OF ELEV. SUBMETER MAPPING GRADE GPS STATE OF WEST VIRGINIA DEPARTMENT OF ENERGY DIVISION OF OIL AND GAS

LEGEND: Surface Owner Boundary Lines +/-, Interior Surface Tracts +/-, Proposed Well Path, As Drilled Well Path. THOMAS SUMMERS P.S. 2109 DATE 10/24/23 OPERATOR'S WELL# STOPE #2H

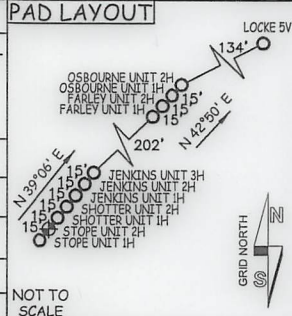

NOTE: 1. NO OCCUPIED DWELLINGS OR BUILDINGS TWO THOUSAND FIVE HUNDRED (2,500) SQUARE FEET OR LARGER USED TO HOUSE OR SHELTER DAIRY CATTLE OR POULTRY HUSBANDRY ARE LOCATED WITHIN SIX HUNDRED TWENTY-FIVE (625) FEET OF THE CENTER OF THE WELL PAD. 2. TOP HOLE DATA SHOWN HEREON WAS PROVIDED BY ANTERO RESOURCES CORPORATION. 3. AS DRILLED DATA WAS PROVIDED BY ANTERO RESOURCES CORPORATION. 4. WLS IS NOT CERTIFYING THE DATA AND INFORMATION PROVIDED LISTED IN NOTES 2 AND 3, ONLY THE RELATIONSHIP TO THE DATA AND INFORMATION PROVIDED TO THE LEASE BOUNDARIES. 5. WLS IS BY NO MEANS RESPONSIBLE FOR ANY ERRORS OR INACCURACIES WITH THE DATA AND INFORMATION THAT HAS BEEN PROVIDED.

WELL TYPE: OIL ___ GAS x LIQUID INJECTION ___ WASTE DISPOSAL ___ 47 - 017 - 06948 (IF "GAS") PRODUCTION x STORAGE ___ DEEP ___ SHALLOW x STATE COUNTY PERMIT LOCATION: ELEVATION 1,100.5' - AS BUILT WATERSHED SOUTH FORK HUGHES RIVER QUADRANGLE OXFORD 7.5' DISTRICT SOUTHWEST COUNTY DODDRIDGE SURFACE OWNER ANTERO RESOURCES CORPORATION ACREAGE 59.74 ACRES +/- OIL & GAS ROYALTY OWNER E. W. OSBORNE ET AL LEASE ACREAGE 180 ACRES±

PROPOSED WORK: DRILL ___ CONVERT ___ DRILL DEEPER ___ REDRILL ___ FRACTURE OR STIMULATE ___ PLUG OFF OLD FORMATION ___ PERFORATE NEW FORMATION ___ OTHER PHYSICAL CHANGE IN WELL (SPECIFY) AS DRILLED PLUG & ABANDON CLEAN OUT & REPLUG TARGET FORMATION MARCELLUS ESTIMATED DEPTH 6,509' TVD 17,808' MD WELL OPERATOR ANTERO RESOURCES CORP. DESIGNATED AGENT KEVIN ELLIS ADDRESS 1615 WYNKOOP ST. ADDRESS 535 WHITE OAKS BLVD