

LATITUDE 39°12'30" 22'

LATITUDE 39°12'30" 10,021' TO BOTTOM HOLE

Antero Resources Corporation Well No. Jenkins #3H

NOTES:

WELL 3H TOP HOLE INFORMATION: N: 249,604ft E: 1,621,951ft LAT: 39°10'39.39" LON: 80°50'00.90" BOTTOM HOLE INFORMATION: N: 250,744ft E: 1,624,040ft LAT: 39°10'50.95" LON: 80°49'29.33" WEST VIRGINIA COORDINATE SYSTEM OF 1927 NORTH ZONE. ZONE WAS DERIVED FROM MEASUREMENTS TAKEN WITH TRIMBLE GEOXT SUBMETER MAPPING GRADE GPS UNIT. PLAT ORIENTATION, CORNER, AND WELL REFERENCE TIE LINES ARE BASED ON GRID NORTH.

(NAD) 83 (UTM) ZONE 17 COORDS: WELL 3H TOP HOLE INFORMATION: N: 4,336,509m E: 514,389m BOTTOM HOLE INFORMATION: N: 4,336,866m E: 515,020m

(NAD) 27 (UTM) ZONE 17 COORDS: WELL 3H TOP HOLE INFORMATION: N: 14,226,648ft E: 1,687,578ft POINT OF ENTRY INFORMATION: N: 14,227,971ft E: 1,689,595ft BOTTOM HOLE INFORMATION: N: 14,227,822ft E: 1,689,646ft

NOTE NO OCCUPIED DWELLINGS OR BUILDINGS TWO THOUSAND FIVE HUNDRED (2,500) SQUARE FEET OR LARGER USED TO HOUSE OR SHELTER DAIRY CATTLE OR POULTRY HUSBANDRY ARE LOCATED WITHIN SIX HUNDRED TWENTY-FIVE (625) FEET OF THE CENTER OF THE WELL PAD.

WV NORTH ZONE GRID NORTH

10,021' TO BOTTOM HOLE

11,160'

LONGITUDE 80°50'00"

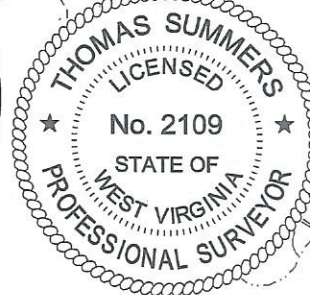
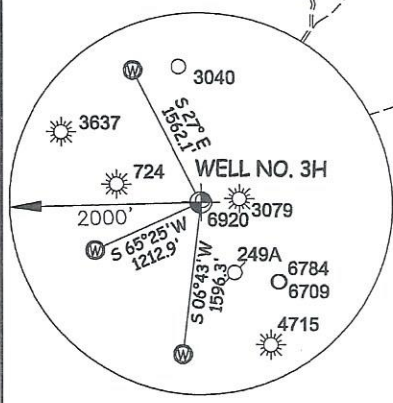

I THE UNDERSIGNED, HEREBY CERTIFY THAT THIS PLAT IS CORRECT TO THE BEST OF MY KNOWLEDGE AND BELIEF AND SHOWS ALL THE INFORMATION REQUIRED BY LAW AND THE RULES ISSUED AND PRESCRIBED BY THE DEPARTMENT OF ENVIRONMENTAL PROTECTION.

Table with 3 columns: SURTHWEST DISTRICT - DODDRIDGE COUNTY, 13-01, MANSFIELD LEESON. Lists names and well numbers for various landowners.



STATE OF WEST VIRGINIA, DIVISION OF ENVIRONMENTAL PROTECTION, OFFICE OF OIL AND GAS. WILLOW LAND SURVEYING PLLC 220 MASONIC AVE. PENNSBORO WEST VIRGINIA 26415

JOB # 21-005WA DRAWING # JENKINS3H SCALE 1" = 2000' MINIMUM DEGREE OF ACCURACY SUBMETER PROVEN SOURCE OF ELEV. SUBMETER MAPPING GRADE GPS STATE OF WEST VIRGINIA DEPARTMENT OF ENERGY DIVISION OF OIL AND GAS

LEGEND: Surface Owner Boundary Lines +/-, Adjoining Surface Tracts +/-, Found monument, as noted. Signature of Thomas Summers, P.S. 2109. DATE 12/19/22 OPERATOR'S WELL# JENKINS #3H

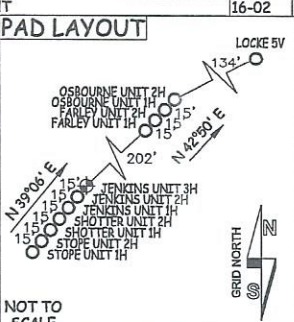

WELL TYPE: OIL ___ GAS X LIQUID INJECTION ___ WASTE DISPOSAL ___ (IF "GAS") PRODUCTION X STORAGE ___ DEEP ___ SHALLOW X LOCATION: ELEVATION PROPOSED - 1,100.5' ORIGINAL GROUND - 1,108' WATERSHED SOUTH FORK HUGHES RIVER QUADRANGLE OXFORD 7.5' DISTRICT SOUTHWEST COUNTY DODDRIDGE SURFACE OWNER ANTERO RESOURCES CORPORATION ACREAGE 59.74 ACRES +/- OIL & GAS ROYALTY OWNER E.W. OSBORNE ET AL; CHARLES J. DENNISON; LEASE ACREAGE 180 AC±; 30 AC±; J.W. NUTTER HEIRS 36 AC±

PROPOSED WORK: DRILL X CONVERT ___ DRILL DEEPER ___ REDRILL ___ FRACTURE OR STIMULATE X PLUG OFF OLD FORMATION ___ PERFORATE NEW FORMATION X OTHER PHYSICAL CHANGE IN WELL (SPECIFY) PLUG & ABANDON CLEAN OUT & REPLUG TARGET FORMATION MARCELLUS ESTIMATED DEPTH 7,000' TVD 11,300' MD WELL OPERATOR ANTERO RESOURCES CORP. DESIGNATED AGENT KEVIN ELLIS ADDRESS 1615 WYNKOOP ST. ADDRESS 535 WHITE OAKS BLVD BRIDGEPORT, WV 26330

02/23/2023

02/03/2023

