

State of West Virginia
Department of Environmental Protection - Office of Oil and Gas
Well Operator's Report of Well Work

API 47 - 017 - 06944 County Doddrige District Southwest
Quad Oxford 7.5' Pad Name Locke Field/Pool Name -----
Farm name Antero Resources Corporation Well Number Jenkins Unit 3H
Operator (as registered with the OOG) Antero Resources Corporation
Address 1615 Wynkoop Street City Denver State CO Zip 80202

As Drilled location NAD 83/UTM Attach an as-drilled plat, profile view, and deviation survey
Top hole Northing 4336509m Easting 514389m
Landing Point of Curve Northing 4328450m Easting 543819m
Bottom Hole Northing 4334146m Easting 515947m

Elevation (ft) 1100.5' GL Type of Well New Existing Type of Report Interim Final
Permit Type Deviated Horizontal Horizontal 6A Vertical Depth Type Deep Shallow
Type of Operation Convert Deepen Drill Plug Back Redrilling Rework Stimulate
Well Type Brine Disposal CBM Gas Oil Secondary Recovery Solution Mining Storage Other _____
Type of Completion Single Multiple Fluids Produced Brine Gas NGL Oil Other _____
Drilled with Cable Rotary

Drilling Media Surface hole Air Mud Fresh Water Intermediate hole Air Mud Fresh Water Brine
Production hole Air Mud Fresh Water Brine
Mud Type(s) and Additive(s)
Air - Foam & 4% KCL
Mud - Polymer

Date permit issued 1/30/2023 Date drilling commenced 3/2/2023 Date drilling ceased 5/31/2023
Date completion activities began 6/30/2023 Date completion activities ceased 7/31/2023
Verbal plugging (Y/N) N/A Date permission granted N/A Granted by N/A

Please note: Operator is required to submit a plugging application within 5 days of verbal permission to plug

Freshwater depth(s) ft 775, 781' Open mine(s) (Y/N) depths No
Salt water depth(s) ft 1733, 1750' Void(s) encountered (Y/N) depths No
Coal depth(s) ft N/A Cavern(s) encountered (Y/N) depths No
Is coal being mined in area (Y/N) No

Reviewed by:
KG-12/6/23
12/08/2023

API 47-017 - 06944 Farm name Antero Resources Corporation Well number Jenkins Unit 3H

CASING STRINGS	Hole Size	Casing Size	Depth	New or Used	Grade wt/ft	Basket Depth(s)	Did cement circulate (Y/N) * Provide details below*
Conductor	28"	20"	130'	New	91.59#, J-55	N/A	Y
Surface	17-1/2"	13-3/8"	455'	New	54.5#, J-55	N/A	Y
Coal							
Intermediate 1	12-1/4"	9-5/8"	3043'	New	36#, J-55	N/A	Y
Intermediate 2							
Intermediate 3							
Production	8-3/4"/8-1/2"	5-1/2"	16998'	New	23#, P-110-ICY	N/A	Y
Tubing		2-3/8"	7087'		4.7#, P-110		
Packer type and depth set		N/A					

Comment Details _____

CEMENT DATA	Class/Type of Cement	Number of Sacks	Slurry wt (ppg)	Yield (ft ³ /sks)	Volume (ft ³)	Cement Top (MD)	WOC (hrs)
Conductor	Class A	204 sx	15.6	1.18	241	0'	8 Hrs.
Surface	Class A	555 sx	15.8	1.16	644	0'	8 Hrs.
Coal							
Intermediate 1	Class A	1146 sx	15.8	1.16	1329	0'	8 Hrs.
Intermediate 2							
Intermediate 3							
Production	Class H	1655 sx (Lead)	13 (Lead), 12 (Tail)	1.97 (Lead), 2.26 (Tail)	3740	-500' into Intermediate Casing	8 Hrs.
Tubing							

Drillers TD (ft) 19600' MD, 7000' TVD (BHL), ' (Deepest Point Drilled) Loggers TD (ft) 19600' MD

Deepest formation penetrated Marcellus Plug back to (ft) N/A

Plug back procedure N/A

Kick off depth (ft) 6287'

Check all wireline logs run caliper density deviated/directional induction
 neutron resistivity gamma ray temperature sonic

Well cored Yes No Conventional Sidewall Were cuttings collected Yes No

DESCRIBE THE CENTRALIZER PLACEMENT USED FOR EACH CASING STRING _____

Conductor - 0
Surface - 1 above guide shoe, 1 above insert float, 1 every 4th joint to surface
Intermediate - 1 above float joint, 1 above float collar, 1 every 4th joint to surface
Production - 1 above float joint, 1 below float collar, 1 every 3rd joint to top of cement

WAS WELL COMPLETED AS SHOT HOLE Yes No DETAILS _____

WAS WELL COMPLETED OPEN HOLE? Yes No DETAILS _____

WERE TRACERS USED Yes No TYPE OF TRACER(S) USED N/A

API 47- 017 - 06944 Farm name Antero Resources Corporation Well number Jenkins Unit 3H

PRODUCING FORMATION(S)	DEPTHS		
Marcellus	6515' (TOP)	TVD	7459' (TOP) MD

Please insert additional pages as applicable.

GAS TEST Build up Drawdown Open Flow OIL TEST Flow Pump

SHUT-IN PRESSURE Surface 1938 psi Bottom Hole --- psi DURATION OF TEST --- hrs

OPEN FLOW Gas 10640 mcfpd Oil 209 bpd NGL --- bpd Water 1547 bpd GAS MEASURED BY Estimated Orifice Pilot

LITHOLOGY/ FORMATION	TOP DEPTH IN FT NAME TVD	BOTTOM DEPTH IN FT TVD	TOP DEPTH IN FT MD	BOTTOM DEPTH IN FT MD	DESCRIBE ROCK TYPE AND RECORD QUANTITY AND TYPE OF FLUID (FRESHWATER, BRINE, OIL, GAS, H ₂ S, ETC)
-------------------------	--------------------------------	------------------------------	--------------------------	-----------------------------	--

***PLEASE SEE ATTACHED EXHIBIT 3**

Please insert additional pages as applicable.

Drilling Contractor H & P Drilling
Address 912 N Eagle Valley Rd City Howard State PA Zip 16841

Logging Company GR Energy Services
Address 2315 PA-66 City Delmont State PA Zip 15626

Cementing Company Halliburton Energy Services
Address 3000 W. Sam Houston Pkwy City Houston State TX Zip 76114

Stimulating Company Halliburton
Address 3000 W. Sam Houston Pkwy City Houston State TX Zip 76114

Please insert additional pages as applicable.

Completed by Carly Marvel Telephone 303-357-7373
Signature _____ Title Permitting Agent Date 10/11/2023

Submittal of Hydraulic Fracturing Chemical Disclosure Information Attach copy of FRACFOCUS Registry

12/08/2023

API 47-017-06944 Farm Name Antero Resources Corporation Well Number Jenkins Unit 3H

Exhibit 1

Stage No.	Perforation Date	Perforated from MD ft.	Perforated to MD ft.	Number of Perforations	Formations
1	6/30/2023	16860.8	16816.7	60	Marcellus
2	7/1/2023	16778.99094	16612.4457	60	Marcellus
3	7/1/2023	16576.73659	16410.1913	60	Marcellus
4	7/1/2023	16374.48225	16207.937	60	Marcellus
5	7/2/2023	16172.2279	16005.6826	60	Marcellus
6	7/2/2023	15969.97355	15803.4283	60	Marcellus
7	7/2/2023	15767.7192	15601.1739	60	Marcellus
8	7/2/2023	15565.46486	15398.9196	60	Marcellus
9	7/3/2023	15363.21051	15196.6652	60	Marcellus
10	7/3/2023	15160.95616	14994.4109	60	Marcellus
11	7/3/2023	14958.70181	14792.1565	60	Marcellus
12	7/4/2023	14756.44746	14589.9022	60	Marcellus
13	7/4/2023	14554.19312	14387.6478	60	Marcellus
14	7/4/2023	14351.93877	14185.3935	60	Marcellus
15	7/4/2023	14149.68442	13983.1391	60	Marcellus
16	7/4/2023	13947.43007	13780.8848	60	Marcellus
17	7/5/2023	13745.17572	13578.6304	60	Marcellus
18	7/5/2023	13542.92138	13376.3761	60	Marcellus
19	7/5/2023	13340.66703	13174.1217	60	Marcellus
20	7/5/2023	13138.41268	12971.8674	60	Marcellus
21	7/6/2023	12936.15833	12769.613	60	Marcellus
22	7/6/2023	12733.90399	12567.3587	60	Marcellus
23	7/6/2023	12531.64964	12365.1043	60	Marcellus
24	7/6/2023	12329.39529	12162.85	60	Marcellus
25	7/7/2023	12127.14094	11960.5957	60	Marcellus
26	7/7/2023	11924.88659	11758.3413	60	Marcellus
27	7/7/2023	11722.63225	11556.087	60	Marcellus
28	7/7/2023	11520.3779	11353.8326	60	Marcellus
29	7/8/2023	11318.12355	11151.5783	60	Marcellus
30	7/8/2023	11115.8692	10949.3239	60	Marcellus
31	7/8/2023	10913.61486	10747.0696	60	Marcellus
32	7/8/2023	10711.36051	10544.8152	60	Marcellus
33	7/9/2023	10509.10616	10342.5609	60	Marcellus
34	7/9/2023	10306.85181	10140.3065	60	Marcellus
35	7/9/2023	10104.59746	9938.05217	60	Marcellus
36	7/9/2023	9902.343116	9735.79783	60	Marcellus
37	7/9/2023	9700.088768	9533.54348	60	Marcellus
38	7/10/2023	9497.83442	9331.28913	60	Marcellus
39	7/10/2023	9295.580072	9129.03478	60	Marcellus
40	7/10/2023	9093.325725	8926.78043	60	Marcellus
41	7/10/2023	8891.071377	8724.52609	60	Marcellus
42	7/11/2023	8688.817029	8522.27174	60	Marcellus
43	7/11/2023	8486.562681	8320.01739	60	Marcellus
44	7/11/2023	8284.308333	8117.76304	60	Marcellus
45	7/11/2023	8082.053986	7915.5087	60	Marcellus
46	7/12/2023	7879.799638	7713.25435	60	Marcellus
47	7/12/2023	7677.54529	7511	60	Marcellus

RECEIVED
Office of Oil and Gas
OCT 27 2023
WV Department of
Environmental Protection

12/08/2023

API 47-017-06944 Farm Name Antero Resources Corporation Well Number Jenkins Unit 3H

EXHIBIT 2

Stage No.	Stimulations Date	Avg Pump Rate	Avg Treatment Pressure (PSI)	Max Breakdown Pressure (PSI)	ISIP (PSI)	Amount of Proppant (lbs)	Amount of Water (bbls)	Amount of Nitrogen/ other (units)
1	6/30/2023	80.8	8628.3	6771.0	4065.0	177070	4905.1	N/A
2	7/1/2023	90.1	8996.4	7543.3	4227.0	411900	7428.9	N/A
3	7/1/2023	92.6	8598.3	5925.1	4090.0	403850	7311.8	N/A
4	7/1/2023	87.5	8475.8	6008.8	3861.0	416960	9208.4	N/A
5	7/2/2023	92.2	8453.2	4851.2	4149.0	402980	8300.0	N/A
6	7/2/2023	95.2	8650.4	5122.0	3732.0	403150	7031.3	N/A
7	7/2/2023	96.6	8690.9	5590.9	3814.0	404450	6993.1	N/A
8	7/2/2023	95.7	8543.3	5657.8	3379.0	398360	6952.5	N/A
9	7/3/2023	95.7	8599.9	5560.6	3493.0	403320	7102.9	N/A
10	7/3/2023	94.0	8515.5	5629.6	3749.0	413390	7133.6	N/A
11	7/3/2023	96.3	8502.5	5294.8	4560.0	402180	6954.8	N/A
12	7/4/2023	96.7	8542.7	5889.3	3614.0	402920	6980.3	N/A
13	7/4/2023	97.2	8756.0	5904.6	3011.5	417440	7091.2	N/A
14	7/4/2023	97.2	8563.1	5462.7	3250.6	400560	6913.0	N/A
15	7/4/2023	97.2	8454.7	5239.4	3626.0	403720	6964.5	N/A
16	7/4/2023	95.3	8486.0	6369.0	3125.0	416030	7126.0	N/A
17	7/5/2023	94.9	8061.2	6057.4	3260.0	410800	7069.6	N/A
18	7/5/2023	97.2	8156.3	5455.4	3310.0	404520	6971.3	N/A
19	7/5/2023	90.0	8208.0	5635.7	3400.0	399680	7675.8	N/A
20	7/5/2023	94.3	8226.3	6096.0	3135.0	401690	6981.5	N/A
21	7/6/2023	94.1	8182.8	6176.6	3107.0	416180	7970.6	N/A
22	7/6/2023	97.8	7975.2	5773.1	3542.0	397620	6806.0	N/A
23	7/6/2023	97.7	7925.2	5808.2	3362.0	397840	6913.5	N/A
24	7/6/2023	97.7	7804.9	6385.8	3020.0	415400	7065.2	N/A
25	7/7/2023	96.2	7470.2	5467.3	3190.0	399010	6912.5	N/A
26	7/7/2023	97.8	7789.9	6079.0	3550.0	404230	6959.4	N/A
27	7/7/2023	96.1	7970.8	3096.6	3075.0	405440	6981.4	N/A
28	7/7/2023	88.8	7355.5	6821.5	3306.0	398150	8574.5	N/A
29	7/8/2023	97.1	7694.7	5199.1	3294.0	415480	7184.8	N/A
30	7/8/2023	98.4	7914.5	5715.6	3316.0	404770	6911.0	N/A
31	7/8/2023	97.9	7760.3	5375.1	3232.0	405520	6917.8	N/A
32	7/8/2023	96.8	7627.8	5230.6	2997.0	409150	6981.8	N/A
33	7/9/2023	97.7	7590.9	7128.8	2997.0	412100	7046.0	N/A
34	7/9/2023	97.3	7183.1	5904.1	3000.0	398160	7810.6	N/A
35	7/9/2023	97.8	7646.2	5292.7	3021.0	402310	6983.3	N/A
36	7/9/2023	96.8	7401.1	5627.8	3095.0	398390	7364.1	N/A
37	7/9/2023	97.0	7441.1	5990.6	2920.0	416600	7134.1	N/A
38	7/10/2023	98.1	7350.8	6174.5	2925.0	408960	7002.6	N/A
39	7/10/2023	97.7	7399.0	4243.9	3275.0	397660	6801.3	N/A
40	7/10/2023	97.4	7267.0	3653.9	2778.5	397880	6700.8	N/A
41	7/10/2023	97.6	7271.0	6301.0	2767.0	404640	6806.5	N/A
42	7/11/2023	97.3	7088.9	5572.7	2906.0	398050	6845.9	N/A
43	7/11/2023	97.9	6987.8	4903.5	3169.0	410260	6882.5	N/A
44	7/11/2023	97.0	6833.8	5830.5	3123.0	397600	6805.0	N/A
45	7/11/2023	97.4	6816.1	5192.9	3000.0	408140	6945.0	N/A
46	7/12/2023	96.3	6885.5	6912.5	3172.0	398600	6837.0	N/A
47	7/12/2023	97.8	7018.3	5763.6	3022.0	416230	7100.0	N/A
	AVERAGE	96	7,910	5,695	3,341	18,829,340	334,339	TOTAL

RECEIVED
Office of Oil and Gas
OCT 27 2023
WV Department of
Environmental Protection

12/08/2023

EXHIBIT 3

LITHOLOGY/ FORMATION	TOP DEPTH (TVD)	BOTTOM DEPTH (TVD)	TOP DEPTH (MD)	BOTTOM DEPTH (MD)
	From Surface	From Surface	From Surface	From Surface
Sandstone	120	470	120	470
Sandy Siltstone	470	620	470	620
Siltstone, occ SS	620	770	620	770
Sandy Siltstone, occ LS	770	870	770	870
Siltstone, occ SS, tr LS	870	970	870	970
Silty Sandstone, tr shale	970	1,070	970	1,070
Sandstone	1,070	1,170	1,070	1,170
Silty Sandstone	1,170	1,270	1,170	1,270
Shaly Siltstone, tr coal	1,270	1,370	1,270	1,370
Sandy Siltstone, occ shale	1,370	1,620	1,370	1,620
Silty Sandstone, tr coal	1,620	1,870	1,620	1,870
Siltstone, occ LS	1,870	1,844	1,870	1,961
Big Lime	1,874	2,387	1,961	2,560
Fifty Foot Sandstone	2,387	2,520	2,530	2,705
Gordon	2,520	2,829	2,675	3,045
Fifth Sandstone	2,829	2,946	3,015	3,174
Bayard	2,946	3,636	3,144	3,959
Speechley	3,636	3,795	3,929	4,136
Balltown	3,795	4,416	4,106	4,815
Bradford	4,416	4,829	4,785	5,266
Benson	4,829	5,072	5,236	5,541
Alexander	5,072	6,321	5,511	6,945
Sycamore	6,091	6,291	6,670	6,915
Middlesex	6,291	6,420	6,915	7,140
Burkett	6,420	6,471	7,140	7,279
Tully	6,471	6,515	7,279	7,459
Marcellus	6,515	NA	7,459	NA

*Please note Antero determines formation tops based on mud logs that are only run on one well on a multi-well pad. The measured depth (MD) data on subsequent wells may be slightly different due to the well's unique departure.

RECEIVED
Office of Oil and Gas

OCT 27 2023

WV Department of
Environmental Protection

12/08/2023

Hydraulic Fracturing Fluid Product Component Information Disclosure

Job Start Date:	6/30/2023
Job End Date:	7/12/2023
State:	West Virginia
County:	Doddridge
API Number:	47-017-06944-00-00
Operator Name:	Antero Resources Corporation
Well Name and Number:	Jenkins 3H
Latitude:	39.17769400
Longitude:	-80.83341200
Datum:	WGS84
Federal Well:	NO
Indian Well:	NO
True Vertical Depth:	6,562
Total Base Water Volume (gal):	14,528,950
Total Base Non Water Volume:	0



Hydraulic Fracturing Fluid Composition:

Trade Name	Supplier	Purpose	Ingredients	Chemical Abstract Service Number (CAS #)	Maximum Ingredient Concentration in Additive (% by mass)**	Maximum Ingredient Concentration in HF Fluid (% by mass)**	Comments
Produced Water	Halliburton	Base Fluid	Water				
				7732-18-5	100.00000	86.59790	Density = 8.50
Ingredients	Listed Above	Listed Above	Water				
				7732-18-5	100.00000	0.17030	

FDP-S1464-22	Halliburton	Friction Reducer					
				Listed Below			
LCA-1	Halliburton	Solvent					
				Listed Below			
Sand-Common White-100 Mesh, SSA-2	Halliburton	Proppant					
				Listed Below			
HAI-501	Halliburton	Acid Corrosion Inhibitor					
				Listed Below			
HYDROCHLORIC ACID, 22 BAUME	Halliburton	Solvent					
				Listed Below			
OPTIFLO-II DELAYED RELEASE BREAKER	Halliburton	Breaker					
				Listed Below			
WG-36 GELLING AGENT	Halliburton	Gelling Agent					
				Listed Below			
MC B-8614A	MultiChem	Biocide					
				Listed Below			

RECEIVED
 Office of Oil and Gas
 OCT 27 2023
 WV Department of
 Environmental Protection

Items above are Trade Names with the exception of Base Water . Items below are the individual ingredients.

			Crystalline silica, quartz	14808-60-7	100.00000	13.20352	
			Hydrochloric acid	7647-01-0	30.00000	0.03861	
			Complex amine compound	Proprietary	60.00000	0.03329	
			Hydrotreated distillate	Proprietary	30.00000	0.01664	
			Guar gum	9000-30-0	100.00000	0.00575	
			Ammonium chloride	12125-02-9	5.00000	0.00277	
			Fatty nitrogen derived amides	Proprietary	5.00000	0.00277	
			Ethoxylated alcohol	Proprietary	5.00000	0.00277	
			Glutaraldehyde	111-30-8	30.00000	0.00250	
			Sorbitan monooleate polyoxyethylene derivative	9005-65-6	1.00000	0.00055	
			Sorbitan, mono-9-octadecenoate, (Z)	1338-43-8	1.00000	0.00055	
			Alkyl (C12-16) dimethylbenzyl ammonium chloride	68424-85-1	5.00000	0.00042	
			Methanol	67-56-1	100.00000	0.00024	
			Ammonium persulfate	7727-54-0	100.00000	0.00010	
			Ethanol	64-17-5	1.00000	0.00008	
			Modified thiourea polymer	Proprietary	30.00000	0.00007	
			Mixture of dimer and trimer fatty acids of indefinite composition derived from tall oil	61790-12-3	30.00000	0.00007	
			Oxylated phenolic resin	Proprietary	30.00000	0.00003	
			Propargyl alcohol	107-19-7	5.00000	0.00001	
			Hexadecene	629-73-2	5.00000	0.00001	
			Ethoxylated alcohols	Proprietary	5.00000	0.00001	
			C.I. pigment Orange 5	3468-63-1	1.00000	0.00000	
			Hydrotreated distillate	Proprietary	100.00000		

RECEIVED
 Office of Oil and Gas
 OCT 27 2023
 WV Department of Environmental Protection

* Total Water Volume sources may include various types of water including fresh water, produced water, and recycled water

** Information is based on the maximum potential for concentration and thus the total may be over 100%

*** If you are calculating a percentage of total ingredients do not add the water volume below the green line to the water volume above the green line

Note: For Field Development Products (products that begin with FDP), MSDS level only information has been provided.

Ingredient information for chemicals subject to 29 CFR 1910.1200(f) and Appendix D are obtained from suppliers Material Safety Data Sheets (MSDS)

RECEIVED

Office of Oil and Gas

OCT 27 2023

WV Department of
Environmental Protection

LATITUDE 39°12'30" 71'

LATITUDE 39°10'00" 6,789' TO BOTTOM HOLE

3,779' TO BOTTOM HOLE

LONGITUDE 80°47'30" LONGITUDE 80°50'00"

Antero Resources Corporation Well No. Jenkins #3H

AS DRILLED DATA: WELL 3H TOP HOLE INFORMATION: N: 249,604ft E: 1,621,951ft LAT: 39°10'39.38" LON: 80°50'00.90" BOTTOM HOLE INFORMATION: N: 241,767ft E: 1,626,933ft LAT: 39°09'22.65" LON: 80°48'56.18" WEST VIRGINIA COORDINATE SYSTEM OF 1927 NORTH ZONE. ZONE WAS DERIVED FROM MEASUREMENTS TAKEN WITH TRIMBLE GEOXT SUBMETER MAPPING GRADE GPS UNIT. PLAT ORIENTATION, CORNER, AND WELL REFERENCE TIE LINES ARE BASED ON GRID NORTH.

(NAD) 83 (UTM) ZONE 17 COORDS: WELL 3H TOP HOLE INFORMATION: N: 4,336,509m E: 514,389m BOTTOM HOLE INFORMATION: N: 4,334,146m E: 515,947m

(NAD) 27 (UTM) ZONE 17 COORDS: WELL 3H TOP HOLE INFORMATION: N: 14,226,648ft E: 1,687,578ft POINT OF ENTRY INFORMATION: N: 14,227,893ft E: 1,689,624ft BOTTOM HOLE INFORMATION: N: 14,218,898ft E: 1,692,688ft

WV NORTH ZONE GRID NORTH

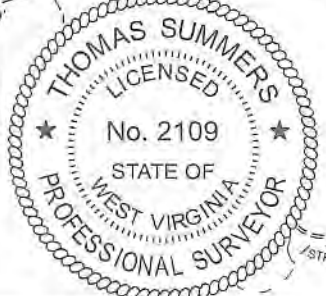
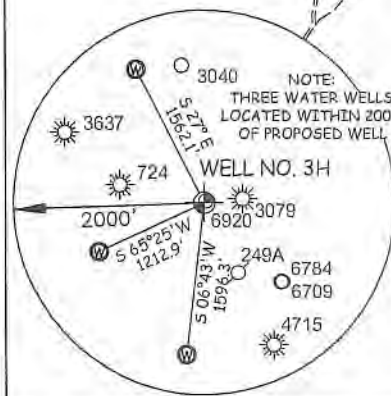

I THE UNDERSIGNED, HEREBY CERTIFY THAT THIS PLAT IS CORRECT TO THE BEST OF MY KNOWLEDGE AND BELIEF AND SHOWS ALL THE INFORMATION REQUIRED BY LAW AND THE RULES ISSUED AND PERSCRIBED BY THE DEPARTMENT OF ENVIRONMENTAL PROTECTION.



STATE OF WEST VIRGINIA, DIVISION OF ENVIRONMENTAL PROTECTION, OFFICE OF OIL AND GAS. WILLOW LAND SURVEYING PLLC 220 MASONIC AVE. PENNSBORO WEST VIRGINIA 26415

Table listing adjacent landowners and their well numbers in Doddridge County, West Virginia. Includes names like Larry Gander, John Waitkus, Robert Lee Brownfield Jr., etc.

JOB # 21-005WA DRAWING # JENKINS3HAD SCALE 1" = 2000' MINIMUM DEGREE OF ACCURACY SUBMETER PROVEN SOURCE OF ELEV. SUBMETER MAPPING GRADE GPS STATE OF WEST VIRGINIA DEPARTMENT OF ENERGY DIVISION OF OIL AND GAS

LEGEND: Surface Owner Boundary Lines +/- Interior Surface Tracts +/- Proposed Well Path As Drilled Well Path THOMAS SUMMERS P.S. 2109 DATE 10/24/23 OPERATOR'S WELL# JENKINS #3H

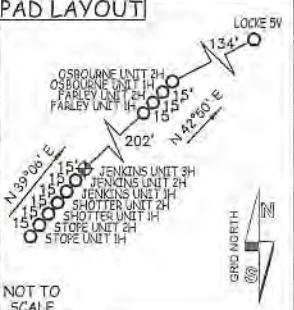

NOTE: 1. NO OCCUPIED DWELLINGS OR BUILDINGS TWO THOUSAND FIVE HUNDRED (2,500) SQUARE FEET OR LARGER USED TO HOUSE OR SHELTER DAIRY CATTLE OR POULTRY HUSBANDRY ARE LOCATED WITHIN SIX HUNDRED TWENTY-FIVE (625) FEET OF THE CENTER OF THE WELL PAD. 2. TOP HOLE DATA SHOWN HEREON WAS PROVIDED BY ANTERO RESOURCES CORPORATION. 3. AS DRILLED DATA WAS PROVIDED BY ANTERO RESOURCES CORPORATION. 4. WLS IS NOT CERTIFYING THE DATA AND INFORMATION PROVIDED LISTED IN NOTES 2 AND 3, ONLY THE RELATIONSHIP TO THE DATA AND INFORMATION PROVIDED TO THE LEASE BOUNDARIES. 5. WLS IS BY NO MEANS RESPONSIBLE FOR ANY ERRORS OR INACCURACIES WITH THE DATA AND INFORMATION THAT HAS BEEN PROVIDED.

WELL TYPE: OIL ___ GAS X LIQUID INJECTION ___ WASTE DISPOSAL ___ 47 - 017 - 06944 (IF "GAS") PRODUCTION X STORAGE ___ DEEP ___ SHALLOW X STATE COUNTY PERMIT LOCATION: ELEVATION 1,100.5' - AS BUILT WATERSHED SOUTH FORK HUGHES RIVER QUADRANGLE OXFORD 7.5 DISTRICT SOUTHWEST COUNTY DODDRIDGE SURFACE OWNER ANTERO RESOURCES CORPORATION ACREAGE 59.74 ACRES +/- 12/08/2023 OIL & GAS ROYALTY OWNER E. W. OSBORNE ET AL LEASE ACREAGE 180 ACRES±

PROPOSED WORK: DRILL ___ CONVERT ___ DRILL DEEPER ___ REDRILL ___ FRACTURE OR STIMULATE ___ PLUG OFF OLD FORMATION ___ PERFORATE NEW FORMATION ___ OTHER PHYSICAL CHANGE IN WELL (SPECIFY) AS DRILLED PLUG & ABANDON CLEAN OUT & REPLUG TARGET FORMATION MARCELLUS ESTIMATED DEPTH 6,490' TVD 16,998' MD WELL OPERATOR ANTERO RESOURCES CORP. DESIGNATED AGENT KEVIN ELLIS ADDRESS 1615 WYNKOOP ST. ADDRESS 535 WHITE OAKS BLVD FORM WW-6 DENVER, CO 80202 BRIDGEPORT, WV 26330

LATITUDE 39°12'30" 71'

LATITUDE 39°10'00" 6,789' TO BOTTOM HOLE

3,779' TO BOTTOM HOLE

1,191'

LONGITUDE 80°47'30"

COUNTY NAME

PERMIT

Antero Resources Corporation Well No. Jenkins #3H

AS DRILLED DATA: WELL 3H TOP HOLE INFORMATION: N: 249,604ft E: 1,621,951ft LAT: 39°10'39.38" LON: 80°50'00.90" BOTTOM HOLE INFORMATION: N: 241,767ft E: 1,626,933ft LAT: 39°09'22.65" LON: 80°48'56.18" WEST VIRGINIA COORDINATE SYSTEM OF 1927 NORTH ZONE. ZONE WAS DERIVED FROM MEASUREMENTS TAKEN WITH TRIMBLE GEOXT SUBMETER MAPPING GRADE GPS UNIT. PLAT ORIENTATION, CORNER, AND WELL REFERENCE TIE LINES ARE BASED ON GRID NORTH.

(NAD) 83 (UTM) ZONE 17 COORDS: WELL 3H TOP HOLE INFORMATION: N: 4,336,509m E: 514,389m BOTTOM HOLE INFORMATION: N: 4,334,146m E: 515,947m

(NAD) 27 (UTM) ZONE 17 COORDS: WELL 3H TOP HOLE INFORMATION: N: 14,226,648ft E: 1,687,578ft POINT OF ENTRY INFORMATION: N: 14,227,893ft E: 1,689,624ft BOTTOM HOLE INFORMATION: N: 14,218,898ft E: 1,692,688ft

WV NORTH ZONE GRID NORTH

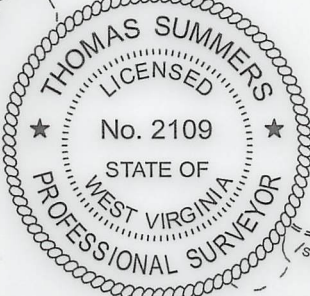
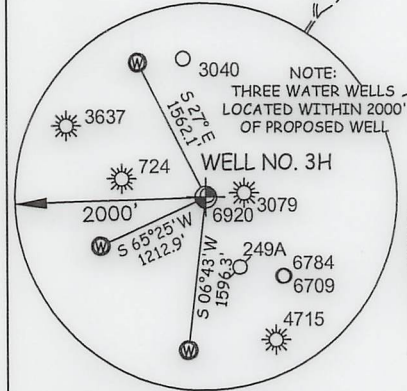

I THE UNDERSIGNED, HEREBY CERTIFY THAT THIS PLAT IS CORRECT TO THE BEST OF MY KNOWLEDGE AND BELIEF AND SHOWS ALL THE INFORMATION REQUIRED BY LAW AND THE RULES ISSUED AND PERSCRIBED BY THE DEPARTMENT OF ENVIRONMENTAL PROTECTION.

Table with 4 columns: Surveyor/Owner Name, Survey/Lease Number, and other identifiers. Includes names like Larry Gander, John Waitkus, Brian Prim, Robert Lee Brownfield Jr., Antero Resources Corporation, Delbert Osborne, Stephen Harris, Delbert Osborne, Anthony Ramey, Gary Sanchez, Kerry Junkins, Robert Lee Brownfield Jr., Hunter Jenkins, David Ball Jr., David Ball Jr., James Haught, Mansfield Leeson, Hunter Jenkins, Jacqueline Payne, Harold Hinzman, Ernest Seeds, Michael McCloy, Dana Long, Dana Long, James Haught, James Haught, Floyd Stout Jr., Judith Moran, Steven Adams, Dana Long, Robert Lee Brownfield Jr., Coy Adams, and Utahona Williams.



STATE OF WEST VIRGINIA, DIVISION OF ENVIRONMENTAL PROTECTION, OFFICE OF OIL AND GAS. WILLLOW LAND SURVEYING PLLC, 220 MASONIC AVE. PENNSBORO WEST VIRGINIA 26415

JOB # 21-005WA, DRAWING # JENKINS3HAD, SCALE 1" = 2000', MINIMUM DEGREE OF ACCURACY SUBMETER, PROVEN SOURCE OF ELEV. SUBMETER MAPPING GRADE GPS, STATE OF WEST VIRGINIA DEPARTMENT OF ENERGY DIVISION OF OIL AND GAS

LEGEND: Surface Owner Boundary Lines +/-, Interior Surface Tracts +/-, Proposed Well Path, As Drilled Well Path. THOMAS SUMMERS P.S. 2109, DATE 10/24/23, OPERATOR'S WELL# JENKINS #3H

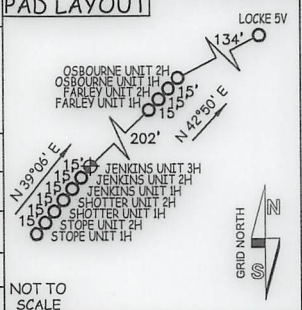

NOTE: 1. NO OCCUPIED DWELLINGS OR BUILDINGS TWO THOUSAND FIVE HUNDRED (2,500) SQUARE FEET OR LARGER USED TO HOUSE OR SHELTER DAIRY CATTLE OR POULTRY HUSBANDRY ARE LOCATED WITHIN SIX HUNDRED TWENTY-FIVE (625) FEET OF THE CENTER OF THE WELL PAD. 2. TOP HOLE DATA SHOWN HEREON WAS PROVIDED BY ANTERO RESOURCES CORPORATION. 3. AS DRILLED DATA WAS PROVIDED BY ANTERO RESOURCES CORPORATION. 4. WLS IS NOT CERTIFYING THE DATA AND INFORMATION PROVIDED LISTED IN NOTES 2 AND 3, ONLY THE RELATIONSHIP TO THE DATA AND INFORMATION PROVIDED TO THE LEASE BOUNDARIES. 5. WLS IS BY NO MEANS RESPONSIBLE FOR ANY ERRORS OR INACCURACIES WITH THE DATA AND INFORMATION THAT HAS BEEN PROVIDED.

WELL TYPE: OIL ___ GAS X LIQUID INJECTION ___ WASTE DISPOSAL 47 - 017 - 06944 (IF "GAS") PRODUCTION X STORAGE ___ DEEP SHALLOW X STATE COUNTY PERMIT LOCATION: ELEVATION 1,100.5' - AS BUILT WATERSHED SOUTH FORK HUGHES RIVER QUADRANGLE OXFORD 7.5' DISTRICT SOUTHWEST COUNTY DODDRIDGE SURFACE OWNER ANTERO RESOURCES CORPORATION ACREAGE 59.74 ACRES +/- LEASE ACREAGE 180 ACRES±

PROPOSED WORK: DRILL ___ CONVERT ___ DRILL DEEPER ___ REDRILL ___ FRACTURE OR STIMULATE ___ PLUG OFF OLD FORMATION ___ PERFORATE NEW FORMATION ___ OTHER PHYSICAL CHANGE IN WELL (SPECIFY) AS DRILLED PLUG & ABANDON CLEAN OUT & REPLUG TARGET FORMATION MARCELLUS ESTIMATED DEPTH 6,490' TVD 16,998' MD WELL OPERATOR ANTERO RESOURCES CORP. DESIGNATED AGENT KEVIN ELLIS ADDRESS 1615 WYNKOOP ST. ADDRESS 535 WHITE OAKS BLVD DENVER, CO 80202 BRIDGEPORT, WV 26330