

State of West Virginia
Department of Environmental Protection - Office of Oil and Gas
Well Operator's Report of Well Work

API 47 - 017 - 06943 County Doddridge District Southwest
Quad Oxford 7.5' Pad Name Locke Field/Pool Name -----
Farm name Antero Resources Corporation Well Number Jenkins Unit 2H
Operator (as registered with the OOG) Antero Resources Corporation
Address 1615 Wynkoop Street City Denver State CO Zip 80202

As Drilled location NAD 83/UTM Attach an as-drilled plat, profile view, and deviation survey
Top hole Northing 4336505m Easting 514386m
Landing Point of Curve Northing 4328525m Easting 543712m ✓
Bottom Hole Northing 4334045m Easting 515718m

Elevation (ft) 1100.5' GL Type of Well New Existing Type of Report Interim Final
Permit Type Deviated Horizontal Horizontal 6A Vertical Depth Type Deep Shallow
Type of Operation Convert Deepen Drill Plug Back Redrilling Rework Stimulate
Well Type Brine Disposal CBM Gas Oil Secondary Recovery Solution Mining Storage Other _____
Type of Completion Single Multiple Fluids Produced Brine Gas NGL Oil Other _____
Drilled with Cable Rotary

Drilling Media Surface hole Air Mud Fresh Water Intermediate hole Air Mud Fresh Water Brine
Production hole Air Mud Fresh Water Brine
Mud Type(s) and Additive(s)
Air - Foam & 4% KCL
Mud - Polymer

Date permit issued 1/30/2023 Date drilling commenced 3/2/2023 Date drilling ceased 5/22/2023
Date completion activities began 6/30/2023 Date completion activities ceased 7/31/2023
Verbal plugging (Y/N) N/A Date permission granted N/A Granted by N/A

Please note: Operator is required to submit a plugging application within 5 days of verbal permission to plug

Freshwater depth(s) ft 775, 781' Open mine(s) (Y/N) depths No
Salt water depth(s) ft 1733, 1750' Void(s) encountered (Y/N) depths No
Coal depth(s) ft N/A Cavern(s) encountered (Y/N) depths No
Is coal being mined in area (Y/N) No

Reviewed by:
KG - 12/6/23
12/08/2023

API 47-017 - 06943 Farm name Antero Resources Corporation Well number Jenkins Unit 2H

CASING STRINGS	Hole Size	Casing Size	Depth	New or Used	Grade wt/ft	Basket Depth(s)	Did cement circulate (Y/N) * Provide details below*
Conductor	28"	20"	130'	New	91.59#, J-55	N/A	Y
Surface	17-1/2"	13-3/8"	460'	New	54.5#, J-55	N/A	Y
Coal							
Intermediate 1	12-1/4"	9-5/8"	2968'	New	36#, J-55	N/A	Y
Intermediate 2							
Intermediate 3							
Production	8-3/4"/8-1/2"	5-1/2"	16754'	New	23#, P-110-ICY	N/A	Y
Tubing		2-3/8"	6861'		4.7#, P-110		
Packer type and depth set		N/A					

Comment Details _____

CEMENT DATA	Class/Type of Cement	Number of Sacks	Slurry wt (ppg)	Yield (ft ³ /sks)	Volume (ft ³)	Cement Top (MD)	WOC (hrs)
Conductor	Class A	204 sx	15.6	1.18	241	0'	8 Hrs.
Surface	Class A	418 sx	15.8	1.17	489	0'	8 Hrs.
Coal							
Intermediate 1	Class A	1102 sx	15.8	1.16	1278	0'	8 Hrs.
Intermediate 2							
Intermediate 3							
Production	Class H	1645 sx (Lead)	13 (Lead), 12 (Tail)	1.97 (Lead), 2.26 (Tail)	3718	-500' into Intermediate Casing	8 Hrs.
Tubing							

Drillers TD (ft) 19400' MD, 7000' TVD (BHL), (Deepest Point Drilled) Loggers TD (ft) 19400' MD
 Deepest formation penetrated Marcellus Plug back to (ft) N/A
 Plug back procedure N/A

RECEIVED
Office of Oil and Gas
OCT 27 2023

Kick off depth (ft) 5942'

WV Department of Environmental Protection

Check all wireline logs run caliper density deviated/directional induction
 neutron resistivity gamma ray temperature sonic

Well cored Yes No Conventional Sidewall Were cuttings collected Yes No

DESCRIBE THE CENTRALIZER PLACEMENT USED FOR EACH CASING STRING _____
 Conductor - 0
 Surface - 1 above guide shoe, 1 above insert float, 1 every 4th joint to surface
 Intermediate - 1 above float joint, 1 above float collar, 1 every 4th joint to surface
 Production - 1 above float joint, 1 below float collar, 1 every 3rd joint to top of cement

WAS WELL COMPLETED AS SHOT HOLE Yes No DETAILS _____

WAS WELL COMPLETED OPEN HOLE? Yes No DETAILS _____

WERE TRACERS USED Yes No TYPE OF TRACER(S) USED N/A

12/08/2023

API 47-017-06943 Farm Name Antero Resources Corporation Well Number Jenkins Unit 2H

Exhibit 1

Stage No.	Perforation Date	Perforated from MD ft.	Perforated to MD ft.	Number of Perforations	Formations
1	6/30/2023	16616.3	16572.3	60	Marcellus
2	7/1/2023	16534.80248	16369.3149	60	Marcellus
3	7/1/2023	16333.81738	16168.3298	60	Marcellus
4	7/1/2023	16132.83227	15967.3447	60	Marcellus
5	7/1/2023	15931.84716	15766.3596	60	Marcellus
6	7/2/2023	15730.86206	15565.3745	60	Marcellus
7	7/2/2023	15529.87695	15364.3894	60	Marcellus
8	7/2/2023	15328.89184	15163.4043	60	Marcellus
9	7/2/2023	15127.90674	14962.4191	60	Marcellus
10	7/3/2023	14926.92163	14761.434	60	Marcellus
11	7/3/2023	14725.93652	14560.4489	60	Marcellus
12	7/3/2023	14524.95142	14359.4638	60	Marcellus
13	7/4/2023	14323.96631	14158.4787	60	Marcellus
14	7/4/2023	14122.98121	13957.4936	60	Marcellus
15	7/4/2023	13921.9961	13756.5085	60	Marcellus
16	7/4/2023	13721.01099	13555.5234	60	Marcellus
17	7/5/2023	13520.02589	13354.5383	60	Marcellus
18	7/5/2023	13319.04078	13153.5532	60	Marcellus
19	7/5/2023	13118.05567	12952.5681	60	Marcellus
20	7/5/2023	12917.07057	12751.583	60	Marcellus
21	7/5/2023	12716.08546	12550.5979	60	Marcellus
22	7/6/2023	12515.10035	12349.6128	60	Marcellus
23	7/6/2023	12314.11525	12148.6277	60	Marcellus
24	7/6/2023	12113.13014	11947.6426	60	Marcellus
25	7/7/2023	11912.14504	11746.6574	60	Marcellus
26	7/7/2023	11711.15993	11545.6723	60	Marcellus
27	7/7/2023	11510.17482	11344.6872	60	Marcellus
28	7/7/2023	11309.18972	11143.7021	60	Marcellus
29	7/8/2023	11108.20461	10942.717	60	Marcellus
30	7/8/2023	10907.2195	10741.7319	60	Marcellus
31	7/8/2023	10706.2344	10540.7468	60	Marcellus
32	7/8/2023	10505.24929	10339.7617	60	Marcellus
33	7/8/2023	10304.26418	10138.7766	60	Marcellus
34	7/9/2023	10103.27908	9937.79149	60	Marcellus
35	7/9/2023	9902.293972	9736.80638	60	Marcellus
36	7/9/2023	9701.308865	9535.82128	60	Marcellus
37	7/9/2023	9500.323759	9334.83617	60	Marcellus
38	7/10/2023	9299.338652	9133.85106	60	Marcellus
39	7/10/2023	9098.353546	8932.86596	60	Marcellus
40	7/10/2023	8897.36844	8731.88085	60	Marcellus
41	7/10/2023	8696.383333	8530.89574	60	Marcellus
42	7/11/2023	8495.398227	8329.91064	60	Marcellus
43	7/11/2023	8294.413121	8128.92553	60	Marcellus
44	7/11/2023	8093.428014	7927.94043	60	Marcellus
45	7/11/2023	7892.442908	7726.95532	60	Marcellus
46	7/11/2023	7691.457801	7525.97021	60	Marcellus
47	7/12/2023	7490.472695	7324.98511	60	Marcellus
48	7/12/2023	7289.487589	7124	60	Marcellus

RECEIVED
Office of Oil and Gas

OCT 27 2023

WV Department of
Environmental Protection

12/08/2023

EXHIBIT 2

Stage No.	Stimulations Date	Avg Pump Rate	Avg Treatment Pressure (PSI)	Max Breakdown Pressure (PSI)	ISIP (PSI)	Amount of Proppant (lbs)	Amount of Water (bbls)	Amount of Nitrogen/ other (units)
1	6/30/2023	74.3	8466.4	6690.0	3397.0	170300	4914.5	N/A
2	7/1/2023	88.1	8714.7	6452.7	4047.0	398920	7235.3	N/A
3	7/1/2023	92.6	8530.8	5177.9	3940.8	414560	7446.9	N/A
4	7/1/2023	88.3	8702.2	6157.2	3357.0	398340	6923.6	N/A
5	7/1/2023	94.9	8653.2	6163.2	3805.0	403520	6992.1	N/A
6	7/2/2023	96.0	8558.9	4107.8	3317.0	398560	7112.6	N/A
7	7/2/2023	94.0	8668.5	5514.1	4058.0	414740	7108.9	N/A
8	7/2/2023	97.2	8619.3	5819.5	3834.0	400920	6968.6	N/A
9	7/2/2023	93.9	8573.7	5636.9	3449.0	406420	8669.4	N/A
10	7/3/2023	94.4	8640.5	5868.4	3919.0	414500	7143.9	N/A
11	7/3/2023	96.4	8597.3	5955.0	3727.0	396010	6901.4	N/A
12	7/3/2023	90.9	8494.9	5836.6	3732.0	407100	8045.6	N/A
13	7/4/2023	96.4	8608.2	6374.2	3793.0	399840	7084.3	N/A
14	7/4/2023	97.0	8580.8	5808.7	3520.0	394800	6877.1	N/A
15	7/4/2023	96.3	8564.5	5525.7	3862.0	410920	6995.5	N/A
16	7/4/2023	96.6	8465.8	6036.9	2954.0	409400	7122.9	N/A
17	7/5/2023	97.9	8344.2	6171.1	3031.0	401870	7071.8	N/A
18	7/5/2023	97.4	8348.0	5753.6	3334.0	402500	6995.5	N/A
19	7/5/2023	95.5	8550.1	5718.0	3744.0	397320	7006.2	N/A
20	7/5/2023	96.3	8381.6	5669.8	3501.0	398930	6919.1	N/A
21	7/5/2023	97.2	8094.2	6235.3	3297.0	398430	6844.0	N/A
22	7/6/2023	97.9	7856.6	6032.1	3803.0	399140	6801.9	N/A
23	7/6/2023	97.6	7865.4	3135.3	3342.0	398240	6861.4	N/A
24	7/6/2023	91.7	7661.1	6315.0	3132.0	404890	7534.9	N/A
25	7/7/2023	96.5	7808.1	3518.7	3067.0	404230	7008.2	N/A
26	7/7/2023	97.4	7894.1	5305.8	3240.0	401740	6794.8	N/A
27	7/7/2023	93.6	7607.5	5680.2	3228.0	416760	7346.2	N/A
28	7/7/2023	97.4	7501.1	6352.0	3157.0	407880	6950.5	N/A
29	7/8/2023	97.2	7789.3	5911.3	3208.0	412790	7063.0	N/A
30	7/8/2023	97.7	7802.4	4996.6	3400.0	398560	6894.0	N/A
31	7/8/2023	98.1	7921.3	3127.8	3015.0	410580	6910.3	N/A
32	7/8/2023	96.6	7614.4	6217.6	3237.0	417550	7020.5	N/A
33	7/8/2023	97.0	7798.9	6728.5	3061.0	407690	7208.0	N/A
34	7/9/2023	96.7	7711.8	6603.8	3003.0	412440	6946.4	N/A
35	7/9/2023	97.6	7556.6	5895.9	3281.0	397980	7017.1	N/A
36	7/9/2023	97.0	7414.6	5818.3	3230.0	401200	6777.8	N/A
37	7/9/2023	97.8	7274.2	5861.4	3112.0	400980	6901.4	N/A
38	7/10/2023	98.1	7376.6	5720.5	2865.0	400940	6985.7	N/A
39	7/10/2023	97.9	7076.8	4763.4	3499.0	396210	6739.4	N/A
40	7/10/2023	99.0	7135.1	5732.3	3245.0	395460	6653.1	N/A
41	7/10/2023	97.7	7083.9	5169.2	2769.0	397230	6799.4	N/A
42	7/11/2023	97.2	6889.3	6179.0	2797.0	405440	6918.1	N/A
43	7/11/2023	97.4	7206.1	6284.7	2986.0	413320	6982.1	N/A
44	7/11/2023	93.5	7175.2	5915.1	2969.0	396210	7956.8	N/A
45	7/11/2023	96.9	6808.7	6764.1	2990.0	397070	6853.0	N/A
46	7/11/2023	97.3	6721.2	5539.0	3098.0	411580	6929.0	N/A
47	7/12/2023	97.5	6801.7	6043.0	2914.0	406350	6858.8	N/A
48	7/12/2023	97.7	6859.2	5743.4	2648.0	397580	6725.0	N/A
	AVERAGE	96	7,904	5,709	3,332	19,147,940	336,816	TOTAL

RECEIVED
Office of Oil and Gas
OCT 27 2023
WV Department of
Environmental Protection

EXHIBIT 3

LITHOLOGY/ FORMATION	TOP DEPTH (TVD)	BOTTOM DEPTH (TVD)	TOP DEPTH (MD)	BOTTOM DEPTH (MD)
	From Surface	From Surface	From Surface	From Surface
Sandstone	120	470	120	470
Sandy Siltstone	470	620	470	620
Siltstone, occ SS	620	770	620	770
Sandy Siltstone, occ LS	770	870	770	870
Siltstone, occ SS, tr LS	870	970	870	970
Silty Sandstone, tr shale	970	1,070	970	1,070
Sandstone	1,070	1,170	1,070	1,170
Silty Sandstone	1,170	1,270	1,170	1,270
Shaly Siltstone, tr coal	1,270	1,370	1,270	1,370
Sandy Siltstone, occ shale	1,370	1,620	1,370	1,620
Silty Sandstone, tr coal	1,620	1,870	1,620	1,870
Siltstone, occ LS	1,870	1,841	1,870	1,872
Big Lime	1,871	2,402	1,872	2,466
Fifty Foot Sandstone	2,402	2,530	2,436	2,603
Gordon	2,530	2,827	2,573	2,923
Fifth Sandstone	2,827	2,953	2,893	3,058
Bayard	2,953	3,644	3,028	3,809
Speechley	3,644	3,801	3,779	3,978
Balltown	3,801	4,418	3,948	4,630
Bradford	4,418	4,830	4,600	5,069
Benson	4,830	5,070	5,039	5,326
Alexander	5,070	6,355	5,296	6,722
Sycamore	6,145	6,325	6,470	6,692
Middlesex	6,325	6,439	6,692	6,882
Burkett	6,439	6,486	6,882	6,993
Tully	6,486	6,513	6,993	7,080
Marcellus	6,513	NA	7,080	NA

*Please note Antero determines formation tops based on mud logs that are only run on one well on a multi-well pad. The measured depth (MD) data on subsequent wells may be slightly different due to the well's unique departure.

RECEIVED
Office of Oil and Gas
OCT 27 2023
WV Department of
Environmental Protection

12/08/2023

Hydraulic Fracturing Fluid Product Component Information Disclosure

Job Start Date:	6/30/2023
Job End Date:	7/12/2023
State:	West Virginia
County:	Doddridge
API Number:	47-017-06943-00-00
Operator Name:	Antero Resources Corporation
Well Name and Number:	Jenkins 2H
Latitude:	39.17765800
Longitude:	-80.83344700
Datum:	WGS84
Federal Well:	NO
Indian Well:	NO
True Vertical Depth:	6,573
Total Base Water Volume (gal):	14,601,757
Total Base Non Water Volume:	0



Hydraulic Fracturing Fluid Composition:

Trade Name	Supplier	Purpose	Ingredients	Chemical Abstract Service Number (CAS #)	Maximum Ingredient Concentration in Additive (% by mass)**	Maximum Ingredient Concentration in HF Fluid (% by mass)**	Comments
Produced Water	Halliburton	Base Fluid					
			Water	7732-18-5	100.00000	86.45971	Density = 8.50
Ingredients	Listed Above	Listed Above					
			Water	7732-18-5	100.00000	0.17217	

RECEIVED
Office of Oil and Gas
OCT 27 2023
WV Department of
Environmental Protection

12/08/2023

HAI-501	Halliburton	Acid Corrosion Inhibitor					
				Listed Below			
MC B-8614A	MultiChem	Biocide					
				Listed Below			
FDP-S1464-22	Halliburton	Friction Reducer					
				Listed Below			
Sand-Common White-100 Mesh, SSA-2	Halliburton	Proppant					
				Listed Below			
OPTIFLO-II DELAYED RELEASE BREAKER	Halliburton	Breaker					
				Listed Below			
HYDROCHLORIC ACID, 22 BAUME	Halliburton	Solvent					
				Listed Below			
LCA-1	Halliburton	Solvent					
				Listed Below			
WG-36 GELLING AGENT	Halliburton	Gelling Agent					
				Listed Below			

Items above are Trade Names with the exception of Base Water. Items below are the individual ingredients.

RECEIVED
Office of Oil and Gas
OCT 27 2023
WV Department of
Environmental Protection

12/08/2023

			Crystalline silica, quartz	14808-60-7	100.00000	13.33866	
			Hydrochloric acid	7647-01-0	30.00000	0.03915	
			Complex amine compound	Proprietary	60.00000	0.03332	
			Hydrotreated distillate	Proprietary	30.00000	0.01666	
			Guar gum	9000-30-0	100.00000	0.00598	
			Ammonium chloride	12125-02-9	5.00000	0.00278	
			Ethoxylated alcohol	Proprietary	5.00000	0.00278	
			Fatty nitrogen derived amides	Proprietary	5.00000	0.00278	
			Glutaraldehyde	111-30-8	30.00000	0.00250	
			Hydrotreated distillate	Proprietary	100.00000	0.00094	
			Sorbitan monooleate polyoxyethylene derivative	9005-65-6	1.00000	0.00056	
			Sorbitan, mono-9-octadecenoate, (Z)	1338-43-8	1.00000	0.00056	
			Alkyl (C12-16) dimethylbenzyl ammonium chloride	68424-85-1	5.00000	0.00042	
			Methanol	67-56-1	100.00000	0.00025	
			Ammonium persulfate	7727-54-0	100.00000	0.00010	
			Ethanol	64-17-5	1.00000	0.00008	
			Mixture of dimer and trimer fatty acids of indefinite composition derived from tall oil	61790-12-3	30.00000	0.00007	
			Modified thiourea polymer	Proprietary	30.00000	0.00007	
			Oxylated phenolic resin	Proprietary	30.00000	0.00003	
			Propargyl alcohol	107-19-7	5.00000	0.00001	
			Ethoxylated alcohols	Proprietary	5.00000	0.00001	
			Hexadecene	629-73-2	5.00000	0.00001	
			C.I. pigment Orange 5	3468-63-1	1.00000	0.00000	

RECEIVED
Office of Oil and Gas

OCT 27 2023

WV Department of
Environmental Protection

12/08/2023

- * Total Water Volume sources may include various types of water including fresh water, produced water, and recycled water
- ** Information is based on the maximum potential for concentration and thus the total may be over 100%
- *** If you are calculating a percentage of total ingredients do not add the water volume below the green line to the water volume above the green line

Note: For Field Development Products (products that begin with FDP), MSDS level only information has been provided.
Ingredient information for chemicals subject to 29 CFR 1910.1200(i) and Appendix D are obtained from suppliers Material Safety Data Sheets (MSDS)

RECEIVED
Office of Oil and Gas

OCT 27 2023

WV Department of
Environmental Protection

12/08/2023

LATITUDE 39°12'30" 80'

LATITUDE 39°10'00" 7,541' TO BOTTOM HOLE

4,112' TO BOTTOM HOLE
LONGITUDE 80°47'30"

1,203'

LONGITUDE 80°50'00"

Antero Resources Corporation
Well No. Jenkins #2H

AS DRILLED DATA:
WELL 2H TOP HOLE INFORMATION:
N: 249,593ft E: 1,621,942ft
LAT: 39°10'39.27" LON: 80°50'01.02"
BOTTOM HOLE INFORMATION:
N: 241,445ft E: 1,626,177ft
LAT: 39°09'19.36" LON: 80°49'05.73"
WEST VIRGINIA COORDINATE SYSTEM OF 1927 NORTH ZONE. ZONE WAS DERIVED FROM MEASUREMENTS TAKEN WITH TRIMBLE GEOXT SUBMETER MAPPING GRADE GPS UNIT. PLAT ORIENTATION, CORNER, AND WELL REFERENCE TIE LINES ARE BASED ON GRID NORTH.

(NAD) 83 (UTM) ZONE 17 COORDS:
WELL 2H TOP HOLE INFORMATION:
N: 4,336,505m E: 514,386m
BOTTOM HOLE INFORMATION:
N: 4,334,045m E: 515,718m

(NAD) 27 (UTM) ZONE 17 COORDS:
WELL 2H TOP HOLE INFORMATION:
N: 14,226,636ft E: 1,687,568ft
POINT OF ENTRY INFORMATION:
N: 14,227,680ft E: 1,688,797ft
BOTTOM HOLE INFORMATION:
N: 14,218,563ft E: 1,691,937ft

WV NORTH ZONE
GRID NORTH

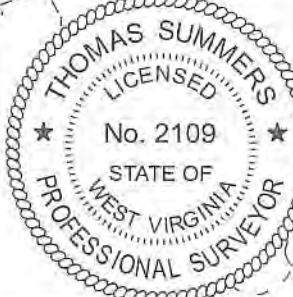
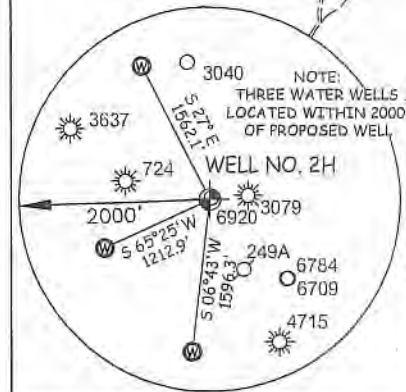

I, THE UNDERSIGNED, HEREBY CERTIFY THAT THIS PLAT IS CORRECT TO THE BEST OF MY KNOWLEDGE AND BELIEF AND SHOWS ALL THE INFORMATION REQUIRED BY LAW AND THE RULES ISSUED AND PERSCRIBED BY THE DEPARTMENT OF ENVIRONMENTAL PROTECTION.

SOUTHWEST DISTRICT - DODDRIDGE COUNTY		13-01	MANSFIELD LEESON
8-05	LARRY GANDER	13-03	HUNTER JENKINS
8-06	JOHN WAITKUS	13-04	JACQUELINE PAYNE
9-07	BRIAN PRIM	13-10	HAROLD HINZMAN
9-08	ROBERT LEE BROWNFIELD JR.	13-21	ERNEST SEEDS
9-09	ANTERO RESOURCES CORPORATION	13-22	MICHAEL MCCLOY
9-10	DELBERT OSBORNE	13-23	DANA LONG
9-11	STEPHEN HARRIS	13-25	DANA LONG
9-11.1	DELBERT OSBORNE	13-42	JAMES HAUGHT
9-13	ANTHONY RAMEY	13-46	JAMES HAUGHT
9-13.1	GARY SANCHEZ	13-47	FLOYD STOUT JR.
9-14	KERRY JUNKINS	13-48	JUDITH MORAN
9-15	ROBERT LEE BROWNFIELD JR.	13-52	STEVEN ADAMS
9-16	HUNTER JENKINS	13-55	DANA LONG
12-01	DAVID BALL JR.	13-71	ROBERT LEE BROWNFIELD JR.
12-05	DAVID BALL JR.	16-01	COY ADAMS
12-06	JAMES HAUGHT	16-02	UTAHONA WILLIAMS



STATE OF WEST VIRGINIA, DIVISION OF ENVIRONMENTAL PROTECTION, OFFICE OF OIL AND GAS

WILLOW LAND SURVEYING PLLC
220 MASONIC AVE. PENNSBORO
WEST VIRGINIA 26415

JOB # 21-005WA
DRAWING # JENKINS2HAD
SCALE 1" = 2000'
MINIMUM DEGREE OF ACCURACY SUBMETER
PROVEN SOURCE OF ELEV. SUBMETER MAPPING GRADE GPS
STATE OF WEST VIRGINIA DEPARTMENT OF ENERGY DIVISION OF OIL AND GAS

LEGEND
--- Surface Owner Boundary Lines +/-
--- Interior Surface Tracts +/-
○ Proposed Well Path
○ As Drilled Well Path
Thomas Summers
THOMAS SUMMERS P.S. 2109
DATE 10/24/23
OPERATOR'S WELL # JENKINS #2H

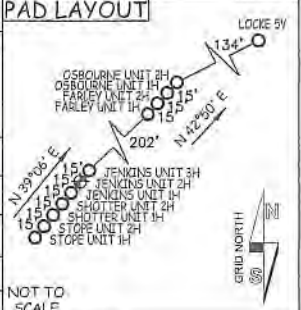

NOTE:
1. NO OCCUPIED DWELLINGS OR BUILDINGS TWO THOUSAND FIVE HUNDRED (2500) SQUARE FEET OR LARGER USED TO HOUSE OR SHELTER DAIRY CATTLE OR POULTRY HUSBANDRY ARE LOCATED WITHIN SIX HUNDRED TWENTY-FIVE (625) FEET OF THE CENTER OF THE WELL PAD.
2. TOP HOLE DATA SHOWN HEREON WAS PROVIDED BY ANTERO RESOURCES CORPORATION.
3. AS DRILLED DATA WAS PROVIDED BY ANTERO RESOURCES CORPORATION.
4. WLS IS NOT CERTIFYING THE DATA AND INFORMATION PROVIDED LISTED IN NOTES 2 AND 3. ONLY THE RELATIONSHIP TO THE DATA AND INFORMATION PROVIDED TO THE LEASE BOUNDARIES.
5. WLS IS BY NO MEANS RESPONSIBLE FOR ANY ERRORS OR INACCURACIES WITH THE DATA AND INFORMATION THAT HAS BEEN PROVIDED.

WELL TYPE: OIL ___ GAS X LIQUID INJECTION ___ WASTE DISPOSAL ___
(IF "GAS") PRODUCTION X STORAGE ___ DEEP ___ SHALLOW X STATE COUNTY PERMIT
LOCATION: ELEVATION 1,100.5' - AS BUILT WATERSHED SOUTH FORK HUGHES RIVER
QUADRANGLE OXFORD 7.5' DISTRICT SOUTHWEST COUNTY DODDRIDGE
SURFACE OWNER ANTERO RESOURCES CORPORATION ACREAGE 59.74 ACRES +/-
OIL & GAS ROYALTY OWNER E. W. OSBORNE ET AL LEASE ACREAGE 180 ACRES +/-

PROPOSED WORK: DRILL ___ CONVERT ___ DRILL DEEPER ___ REDRILL ___ FRACTURE OR STIMULATE ___
PLUG OFF OLD FORMATION ___ PERFORATE NEW FORMATION ___ OTHER PHYSICAL CHANGE IN WELL ___
(SPECIFY) AS DRILLED PLUG & ABANDON CLEAN OUT & REPLUG
TARGET FORMATION MARCELLUS ESTIMATED DEPTH 6,497' TVD 16,754' MD
WELL OPERATOR ANTERO RESOURCES CORP. DESIGNATED AGENT KEVIN ELLIS
ADDRESS 1615 WYNKOOP ST. ADDRESS 535 WHITE OAKS BLVD
FORM WW-6 DENVER, CO 80202 BRIDGEPORT, WV 26330

COUNTY NAME

PERMIT

12/08/2023

LATITUDE 39°12'30" 80'

LATITUDE 39°10'00" 7,541' TO BOTTOM HOLE

4,112' TO BOTTOM HOLE

11,203'

LONGITUDE 80°47'30"

COUNTY NAME

PERMIT

Antero Resources Corporation Well No. Jenkins #2H

AS DRILLED DATA: WELL 2H TOP HOLE INFORMATION: N: 249,593ft E: 1,621,942ft LAT: 39°10'39.27" LON: 80°50'01.02" BOTTOM HOLE INFORMATION: N: 241,445ft E: 1,626,177ft LAT: 39°09'19.36" LON: 80°49'05.73" WEST VIRGINIA COORDINATE SYSTEM OF 1927 NORTH ZONE. ZONE WAS DERIVED FROM MEASUREMENTS TAKEN WITH TRIMBLE GEOXT SUBMETER MAPPING GRADE GPS UNIT. PLAT ORIENTATION, CORNER, AND WELL REFERENCE TIE LINES ARE BASED ON GRID NORTH.

(NAD) 83 (UTM) ZONE 17 COORDS: WELL 2H TOP HOLE INFORMATION: N: 4,336,505m E: 514,386m BOTTOM HOLE INFORMATION: N: 4,334,045m E: 515,718m

(NAD) 27 (UTM) ZONE 17 COORDS: WELL 2H TOP HOLE INFORMATION: N: 14,226,636ft E: 1,687,568ft POINT OF ENTRY INFORMATION: N: 14,227,680ft E: 1,688,797ft BOTTOM HOLE INFORMATION: N: 14,218,563ft E: 1,691,937ft

WV NORTH ZONE GRID NORTH

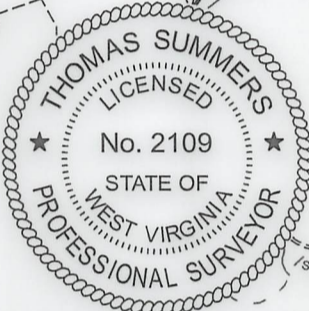
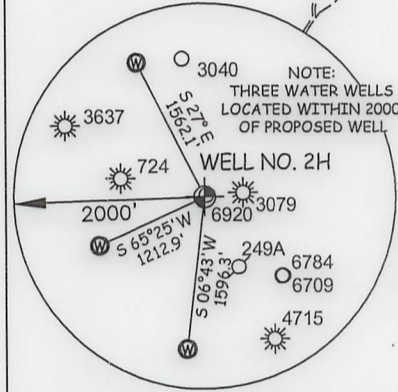

I, THE UNDERSIGNED, HEREBY CERTIFY THAT THIS PLAT IS CORRECT TO THE BEST OF MY KNOWLEDGE AND BELIEF AND SHOWS ALL THE INFORMATION REQUIRED BY LAW AND THE RULES ISSUED AND PRESCRIBED BY THE DEPARTMENT OF ENVIRONMENTAL PROTECTION.

Table with columns for well numbers (8-05 to 16-02) and owner names (LARRY GANDER, JOHN WAITKUS, BRIAN PRIM, ROBERT LEE BROWNFIELD JR., ANTERO RESOURCES CORPORATION, DELBERT OSBORNE, STEPHEN HARRIS, DELBERT OSBORNE, ANTHONY RAMEY, GARY SANCHEZ, KERRY JUNKINS, ROBERT LEE BROWNFIELD JR., HUNTER JENKINS, DAVID BALL JR., DAVID BALL JR., JAMES HAUGHT, MANSFIELD LEESON, HUNTER JENKINS, JACQUELINE PAYNE, HAROLD HINZMAN, ERNEST SEEDS, MICHAEL MCCLOY, DANA LONG, DANA LONG, JAMES HAUGHT, JAMES HAUGHT, FLOYD STOUT JR., JUDITH MORAN, STEVEN ADAMS, DANA LONG, ROBERT LEE BROWNFIELD JR., COY ADAMS, UTAHONA WILLIAMS).



STATE OF WEST VIRGINIA, DIVISION OF ENVIRONMENTAL PROTECTION, OFFICE OF OIL AND GAS. WILLOW LAND SURVEYING PLLC, 220 MASONIC AVE. PENNSBORO WEST VIRGINIA 26415

JOB # 21-005WA, DRAWING # JENKINS2HAD, SCALE 1" = 2000', MINIMUM DEGREE OF ACCURACY SUBMETER, PROVEN SOURCE OF ELEV. SUBMETER MAPPING GRADE GPS, STATE OF WEST VIRGINIA DEPARTMENT OF ENERGY DIVISION OF OIL AND GAS

LEGEND: Surface Owner Boundary Lines +/-, Interior Surface Tracts +/-, Proposed Well Path, As Drilled Well Path. THOMAS SUMMERS P.S. 2109, DATE 10/24/23, OPERATOR'S WELL# JENKINS #2H

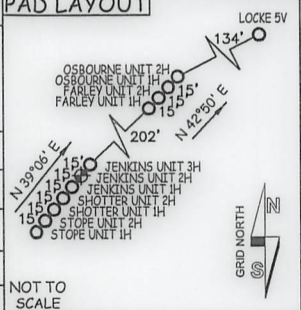

NOTE: 1. NO OCCUPIED DWELLINGS OR BUILDINGS TWO THOUSAND FIVE HUNDRED (2,500) SQUARE FEET OR LARGER USED TO HOUSE OR SHELTER DAIRY CATTLE OR POULTRY HUSBANDRY ARE LOCATED WITHIN SIX HUNDRED TWENTY-FIVE (625) FEET OF THE CENTER OF THE WELL PAD. 2. TOP HOLE DATA SHOWN HEREON WAS PROVIDED BY ANTERO RESOURCES CORPORATION. 3. AS DRILLED DATA WAS PROVIDED BY ANTERO RESOURCES CORPORATION. 4. WLS IS NOT CERTIFYING THE DATA AND INFORMATION PROVIDED LISTED IN NOTES 2 AND 3, ONLY THE RELATIONSHIP TO THE DATA AND INFORMATION PROVIDED TO THE LEASE BOUNDARIES. 5. WLS IS BY NO MEANS RESPONSIBLE FOR ANY ERRORS OR INACCURACIES WITH THE DATA AND INFORMATION THAT HAS BEEN PROVIDED.

WELL TYPE: OIL ___ GAS X LIQUID INJECTION ___ WASTE DISPOSAL 47 - 017 - 06943 (IF "GAS") PRODUCTION X STORAGE ___ DEEP ___ SHALLOW X STATE COUNTY PERMIT LOCATION: ELEVATION 1,100.5' - AS BUILT WATERSHED SOUTH FORK HUGHES RIVER QUADRANGLE OXFORD 7.5' DISTRICT SOUTHWEST COUNTY DODDRIDGE SURFACE OWNER ANTERO RESOURCES CORPORATION ACREAGE 59.74 ACRES +/- LEASE ACREAGE 180 ACRES +/-

PROPOSED WORK: DRILL ___ CONVERT ___ DRILL DEEPER ___ REDRILL ___ FRACTURE OR STIMULATE ___ PLUG OFF OLD FORMATION ___ PERFORATE NEW FORMATION ___ OTHER PHYSICAL CHANGE IN WELL (SPECIFY) AS DRILLED PLUG & ABANDON CLEAN OUT & REPLUG TARGET FORMATION MARCELLUS ESTIMATED DEPTH 6,497' TVD 16,754' MD WELL OPERATOR ANTERO RESOURCES CORP. DESIGNATED AGENT KEVIN ELLIS ADDRESS 1615 WYNKOOP ST. ADDRESS 535 WHITE OAKS BLVD DENVER, CO 80202 BRIDGEPORT, WV 26330

12/08/2023