

LATITUDE 39°17'30"

2,255'

LATITUDE 39°17'30"

2,979' TO BOTTOM HOLE

Antero Resources Corporation Well No. Redwood 2H

NOTES:

WELL 2H TOP HOLE INFORMATION: N: 276,964ft E: 1,631,974ft LAT: 39°15'11.24" LON: 80°47'58.67" BOTTOM HOLE INFORMATION: N: 284,084ft E: 1,631,352ft LAT: 39°16'21.51" LON: 80°48'07.88" WEST VIRGINIA COORDINATE SYSTEM OF 1927 NORTH ZONE. ZONE WAS DERIVED FROM MEASUREMENTS TAKEN WITH TRIMBLE GEOXT SUBMETER MAPPING GRADE GPS UNIT. PLAT ORIENTATION, CORNER, AND WELL REFERENCE TIE LINES ARE BASED ON GRID NORTH.

(NAD) 83 (UTM) ZONE 17 COORDS: WELL 2H TOP HOLE INFORMATION: N: 4,344,895m E: 517,303m BOTTOM HOLE INFORMATION: N: 4,347,061m E: 517,078m

(NAD) 27 (UTM) ZONE 17 COORDS: WELL 2H TOP HOLE INFORMATION: N: 14,254,161ft E: 1,697,139ft POINT OF ENTRY INFORMATION: N: 14,254,085ft E: 1,697,206ft BOTTOM HOLE INFORMATION: N: 14,261,267ft E: 1,696,388ft

Table listing landowners and lease information for West Union District, including names like Alfred Perine, Lisa Meyer, and various lease numbers.

WV NORTH ZONE GRID NORTH

6,930' TO BOTTOM HOLE

LONGITUDE 80°47'30"

14,039'

LONGITUDE 80°47'30"

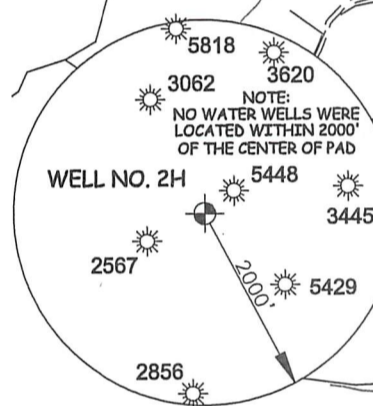

NOTE: NO WATER WELLS WERE LOCATED WITHIN 2000' OF THE CENTER OF PAD

I THE UNDERSIGNED, HEREBY CERTIFY THAT THIS PLAT IS CORRECT TO THE BEST OF MY KNOWLEDGE AND BELIEF AND SHOWS ALL THE INFORMATION REQUIRED BY LAW AND THE RULES ISSUED AND PERSCRIBED BY THE DEPARTMENT OF ENVIRONMENTAL PROTECTION.

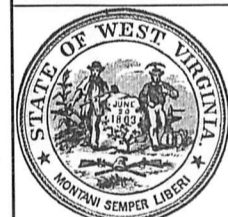

STATE OF WEST VIRGINIA, DIVISION OF ENVIRONMENTAL PROTECTION, OFFICE OF OIL AND GAS. WILLOW LAND SURVEYING PLLC 220 MASONIC AVE. PENNSBORO WEST VIRGINIA 26415

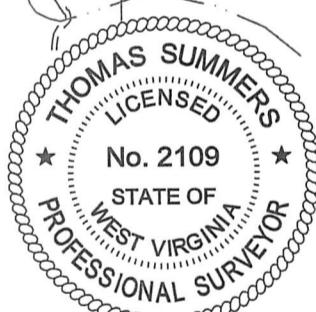

JOB # 19-039WA DRAWING # REDWOOD2HAD SCALE 1" = 2000' MINIMUM DEGREE OF ACCURACY SUBMETER PROVEN SOURCE OF ELEV. SUBMETER MAPPING GRADE GPS

LEGEND: Surface Owner Boundary Lines +/-, Interior Surface Tracts +/-, Proposed Well Path, As Drilled Well Path. THOMAS SUMMERS P.S. 2109

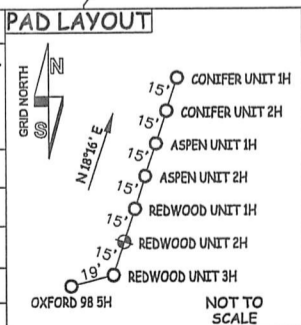

NOTE: 1. NO OCCUPIED DWELLINGS OR BUILDINGS TWO THOUSAND FIVE HUNDRED (2,500) SQUARE FEET OR LARGER USED TO HOUSE OR SHELTER DAIRY CATTLE OR POULTRY HUSBANDRY ARE LOCATED WITHIN SIX HUNDRED TWENTY-FIVE (625) FEET OF THE CENTER OF THE WELL PAD. 2. TOP HOLE DATA SHOWN HEREON WAS PROVIDED BY ANTERO RESOURCES CORPORATION. 3. AS DRILLED DATA WAS PROVIDED BY ANTERO RESOURCES CORPORATION. 4. WLS IS NOT CERTIFYING THE DATA AND INFORMATION PROVIDED LISTED IN NOTES 2 AND 3, ONLY THE RELATIONSHIP TO THE DATA AND INFORMATION PROVIDED TO THE LEASE BOUNDARIES. 5. WLS IS BY NO MEANS RESPONSIBLE FOR ANY ERRORS OR INACCURACIES WITH THE DATA AND INFORMATION THAT HAS BEEN PROVIDED.

STATE OF WEST VIRGINIA DEPARTMENT OF ENERGY DIVISION OF OIL AND GAS

DATE 04/14/23 OPERATOR'S WELL# REDWOOD 2H

WELL TYPE: OIL ___ GAS X LIQUID INJECTION ___ WASTE DISPOSAL ___ 47 - 017 - 06931 (IF "GAS") PRODUCTION X STORAGE ___ DEEP ___ SHALLOW X STATE COUNTY PERMIT LOCATION: ELEVATION 1,120' - AS BUILT WATERSHED HEADWATERS MIDDLE ISLAND CREEK QUADRANGLE WEST UNION 7.5' DISTRICT WEST UNION COUNTY DODDRIDGE SURFACE OWNER MICHAEL R. BRITTON & ANGELA D. PRATT ACREAGE 136.56 ACRES +/- 12/08/2023 OIL & GAS ROYALTY OWNER MICHAEL S. FRANCIS ET AL; RICHARD W. MINNIS ET AL; LEASE ACREAGE 173 AC +/-; 69 AC +/-; JAMES P. GAINES ET UX; SHIRLEY W. FLEMING; FRANKLIN L. BUTLER; J.S. NETZER ET UX; 200 AC +/-; 29 AC +/-; 109 AC +/-; 85 AC +/-; WILMER ROLLINS ET UX; EMORY ROLLINS ET UX; A. K. ROLLINS ET UX; 75 AC +/-; 44 AC +/-; 40 AC +/- PROPOSED WORK: DRILL ___ CONVERT ___ DRILL DEEPER X REDRILL ___ FRACTURE OR STIMULATE X PLUG OFF OLD FORMATION ___ PERFORATE NEW FORMATION X OTHER PHYSICAL CHANGE IN WELL (SPECIFY) AS DRILLED PLUG & ABANDON CLEAN OUT & REPLUG TARGET FORMATION MARCELLUS ESTIMATED DEPTH 6,705' TVD 14,002' MD WELL OPERATOR ANTERO RESOURCES CORP. DESIGNATED AGENT KEVIN ELLIS ADDRESS 1615 WYNKOOP ST. DENVER, CO 80202 ADDRESS 554 WHITE OAKS BLVD BRIDGEPORT, WV 26330