

State of West Virginia
Department of Environmental Protection - Office of Oil and Gas
Well Operator's Report of Well Work

API 47 - 017 - 06931 County Doddrige District West Union
Quad West Union 7.5' Pad Name OXFD 98 Field/Pool Name -----
Farm name Michael R. Britton & Angela D. Pratt Well Number Redwood Unit 2H
Operator (as registered with the OOG) Antero Resources Corporation
Address 1615 Wynkoop Street City Denver State CO Zip 80202

As Drilled location NAD 83/UTM Attach an as-drilled plat, profile view, and deviation survey
Top hole Northing 4344895m Easting 517303m
Landing Point of Curve Northing 4345171.62m Easting 517273.04m
Bottom Hole Northing 4347054m Easting 517074m

Elevation (ft) 1120' GL Type of Well New Existing Type of Report Interim Final
Permit Type Deviated Horizontal Horizontal 6A Vertical Depth Type Deep Shallow
Type of Operation Convert Deepen Drill Plug Back Redrilling Rework Stimulate
Well Type Brine Disposal CBM Gas Oil Secondary Recovery Solution Mining Storage Other _____
Type of Completion Single Multiple Fluids Produced Brine Gas NGL Oil Other _____
Drilled with Cable Rotary

Drilling Media Surface hole Air Mud Fresh Water Intermediate hole Air Mud Fresh Water Brine
Production hole Air Mud Fresh Water Brine
Mud Type(s) and Additive(s)
Air - Foam & 4% KCL
Mud - Polymer

Date permit issued 6/16/2022 Date drilling commenced 7/6/2022 Date drilling ceased 9/30/2022
Date completion activities began 12/12/2022 Date completion activities ceased 1/9/2023
Verbal plugging (Y/N) N/A Date permission granted N/A Granted by N/A

Please note: Operator is required to submit a plugging application within 5 days of verbal permission to plug

Freshwater depth(s) ft 123, 1001' Open mine(s) (Y/N) depths No
Salt water depth(s) ft 1653' Void(s) encountered (Y/N) depths No
Coal depth(s) ft 120' Cavern(s) encountered (Y/N) depths No
Is coal being mined in area (Y/N) No

APPROVED

RECEIVED
Office of Oil and Gas
APR 24 2023
WV Department of
Environmental Protection

Reviewed by:
IMC
12/08/2023
7/18/23

APPROVED

12/08/2023

API 47-017 - 06931 Farm name Michael R. Britton & Angela D. Pratt Well number Redwood Unit 2H

CASING STRINGS	Hole Size	Casing Size	Depth	New or Used	Grade wt/ft	Basket Depth(s)	Did cement circulate (Y/ N) * Provide details below*
Conductor	28"	20"	125.5'	New	78.67#, X-60	N/A	Y
Surface	17-1/2"	13-3/8"	359'	New	54.5#, J-55	N/A	Y
Coal							
Intermediate 1	12-1/4"	9-5/8"	2600'	New	36#, J-55	N/A	Y
Intermediate 2							
Intermediate 3							
Production	8-3/4"/8-1/2"	5-1/2"	14091'	New	20#, P-110	N/A	Y
Tubing		2-3/8"	6613'		4.7#, P-110		
Packer type and depth set		N/A					

Comment Details _____

CEMENT DATA	Class/Type of Cement	Number of Sacks	Slurry wt (ppg)	Yield (ft ³ /sks)	Volume (ft ³)	Cement Top (MD)	WOC (hrs)
Conductor	Class A	218 sx	15.6	1.18	257	0'	8 Hrs.
Surface	Class A	380 sx	15.6	1.20	456	0'	8 Hrs.
Coal							
Intermediate 1	Class A	890 sx	15.6	1.20	1068	0'	8 Hrs.
Intermediate 2							
Intermediate 3							
Production	Class H	1972 sx (Tail)	13.5 (Lead), 15.2(Tail)	1.26 (Tail)	2485	-500' into Intermediate Casing	8 Hrs.
Tubing							

Drillers TD (ft) 16400' MD, 6600' TVD (BHL), 6717' (Deepest Point Drilled) Loggers TD (ft) 16400' MD
 Deepest formation penetrated Marcellus Plug back to (ft) N/A
 Plug back procedure N/A

Kick off depth (ft) _____

Check all wireline logs run caliper density deviated/directional induction
 neutron resistivity gamma ray temperature sonic

Well cored Yes No Conventional Sidewall Were cuttings collected Yes No

DESCRIBE THE CENTRALIZER PLACEMENT USED FOR EACH CASING STRING _____
 Conductor - 0 RECEIVED
 Surface - 1 above guide shoe, 1 above insert float, 1 every 4th joint to surface Office of Oil and Gas
 Intermediate - 1 above float joint, 1 above float collar, 1 every 4th joint to surface
 Production - 1 above float joint, 1 below float collar, 1 every 3rd joint to top of cement APR 24 2023

WAS WELL COMPLETED AS SHOT HOLE Yes No DETAILS _____
WV Department of
Environmental Protection

WAS WELL COMPLETED OPEN HOLE? Yes No DETAILS _____

WERE TRACERS USED Yes No TYPE OF TRACER(S) USED N/A

12/08/2023

API 47- 017 - 06931 Farm name Michael R. Britton & Angela D. Pratt Well number Redwood Unit 2H

<u>PRODUCING FORMATION(S)</u>	<u>DEPTHS</u>		
<u>Marcellus</u>	<u>6567' (TOP)</u>	<u>TVD</u>	<u>6829' (TOP)</u> <u>MD</u>
_____	_____	_____	_____
_____	_____	_____	_____
_____	_____	_____	_____

Please insert additional pages as applicable.

GAS TEST Build up Drawdown Open Flow OIL TEST Flow Pump

SHUT-IN PRESSURE Surface 2359 psi Bottom Hole --- psi DURATION OF TEST --- hrs

OPEN FLOW Gas 11273 mcfpd Oil 129 bpd NGL --- bpd Water 227 bpd GAS MEASURED BY Estimated Orifice Pilot

<u>LITHOLOGY/ FORMATION</u>	<u>TOP</u>		<u>BOTTOM</u>		<u>DESCRIBE ROCK TYPE AND RECORD QUANTITY AND TYPE OF FLUID (FRESHWATER, BRINE, OIL, GAS, H₂S, ETC)</u>
	<u>DEPTH IN FT</u>	<u>DEPTH IN FT</u>	<u>DEPTH IN FT</u>	<u>DEPTH IN FT</u>	
	<u>NAME</u>	<u>TVD</u>	<u>MD</u>	<u>MD</u>	

***PLEASE SEE ATTACHED EXHIBIT 3**

Please insert additional pages as applicable.

Drilling Contractor H & P Drilling
Address 912 N Eagle Valley Rd City Howard State PA Zip 16841

Logging Company Nine Energy Services
Address 6500 West Fwy City Fort Worth State TX Zip 76116

Cementing Company Schlumberger US Land
Address 1080 US-33 City Weston State WV Zip 26452

Stimulating Company Halliburton
Address 3000 W. Sam Houston Pkwy City Houston State TX Zip 76114

Please insert additional pages as applicable.

Completed by Carly Marvel Telephone 303-357-7373
Signature Carly Marvel Title Permitting Agent Date 3/22/2023

RECEIVED
Office of Oil and Gas
APR 24 2023
WV Department of
Environmental Protection

Submission of Hydraulic Fracturing Chemical Disclosure Information Attach copy of FRACFOCUS Registry

12/08/2023

API 47-017-06931 Farm Name Michael R. Britton & Angela D. Pratt Well Number Redwood Unit 2H

Exhibit 1

Stage No.	Perforation Date	Perforated from MD ft.	Perforated to MD ft.	Number of Perforations	Formations
1	12/12/2022	13977	13936	60	Marcellus
2	12/12/2022	13896.40476	13730.4286	60	Marcellus
3	12/12/2022	13694.83333	13528.8571	60	Marcellus
4	12/12/2022	13493.2619	13327.2857	60	Marcellus
5	12/12/2022	13291.69048	13125.7143	60	Marcellus
6	12/12/2022	13090.11905	12924.1429	60	Marcellus
7	12/13/2022	12888.54762	12722.5714	60	Marcellus
8	12/13/2022	12686.97619	12521	60	Marcellus
9	12/13/2022	12485.40476	12319.4286	60	Marcellus
10	12/13/2022	12283.83333	12117.8571	60	Marcellus
11	12/13/2022	12082.2619	11916.2857	60	Marcellus
12	12/14/2022	11880.69048	11714.7143	60	Marcellus
13	12/14/2022	11679.11905	11513.1429	60	Marcellus
14	12/14/2022	11477.54762	11311.5714	60	Marcellus
15	12/14/2022	11275.97619	11110	60	Marcellus
16	12/14/2022	11074.40476	10908.4286	60	Marcellus
17	12/14/2022	10872.83333	10706.8571	60	Marcellus
18	12/15/2022	10671.2619	10505.2857	60	Marcellus
19	12/15/2022	10469.69048	10303.7143	60	Marcellus
20	12/15/2022	10268.11905	10102.1429	60	Marcellus
21	12/16/2022	10066.54762	9900.57143	60	Marcellus
22	12/16/2022	9864.97619	9699	60	Marcellus
23	12/16/2022	9663.404762	9497.42857	60	Marcellus
24	12/17/2022	9461.833333	9295.85714	60	Marcellus
25	12/17/2022	9260.261905	9094.28571	60	Marcellus
26	12/17/2022	9058.690476	8892.71429	60	Marcellus
27	12/18/2022	8857.119048	8691.14286	60	Marcellus
28	12/18/2022	8655.547619	8489.57143	60	Marcellus
29	12/18/2022	8453.97619	8288	60	Marcellus
30	12/19/2022	8252.404762	8086.42857	60	Marcellus
31	12/19/2022	8050.833333	7884.85714	60	Marcellus
32	12/20/2022	7849.261905	7683.28571	60	Marcellus
33	12/20/2022	7647.690476	7481.71429	60	Marcellus
34	12/20/2022	7446.119048	7280.14286	60	Marcellus
35	12/20/2022	7244.547619	7078.57143	60	Marcellus
36	12/21/2022	7042.97619	6877	60	Marcellus

RECEIVED
Office of Oil and Gas
APR 24 2023

WV Department of
Environmental Protection 12/08/2023

API 47-017-06931 Farm Name Michael R. Britton & Angela D. Pratt Well Number Redwood Unit 2H

EXHIBIT 2

Stage No.	Stimulations Date	Avg Pump Rate	Avg Treatment Pressure (PSI)	Max Breakdown Pressure (PSI)	ISIP (PSI)	Amount of Proppant (lbs)	Amount of Water (bbls)	Amount of Nitrogen/ other (units)
1	12/12/2022	84.5	8215	7623	3527	177720	204242	N/A
2	12/12/2022	89.0	8175.016	4842.85	3906.638	394390	291121	N/A
3	12/12/2022	92.2	8239.383	4840.8	4019.362	406800	311539	N/A
4	12/12/2022	90.4	8136.967	4847	3527.549	395200	305410	N/A
5	12/12/2022	95.5	8307	4565	4006	398188	320465	N/A
6	12/12/2022	97.5	8430	3033	3815	394210	298477	N/A
7	12/13/2022	96.8	8388	5555	4932	395920	304606	N/A
8	12/13/2022	96.2	8418	5479	3703	396610	304780	N/A
9	12/13/2022	97.0	8157.902	6083.1	3546.603	392220	303099	N/A
10	12/13/2022	88.8	7591	5754	3637	393920	347270	N/A
11	12/13/2022	97.4	8309	2887	3990	410750	298941	N/A
12	12/14/2022	97.9	8240	3138	3666	411680	312351	N/A
13	12/14/2022	97.8	8142	3029	3998	410060	353247	N/A
14	12/14/2022	97.7	7906.699	5470.49	3386.446	409290	383415	N/A
15	12/14/2022	97.7	7999	4915	3544	396630	280364	N/A
16	12/14/2022	97.7	7894	5381	3984	391930	290550	N/A
17	12/14/2022	97.8	7949	3096	4003	397680	282137	N/A
18	12/15/2022	97.7	7829	3011	3005	389930	294191	N/A
19	12/15/2022	97.6	7937	5833	3352	409070	308256	N/A
20	12/15/2022	97.2	7974	2915	3677	394550	284065	N/A
21	12/16/2022	97.7	7925	2983	4006	391700	281407	N/A
22	12/16/2022	97.6	7757.806	5467.77	3314.849	394860	280435	N/A
23	12/16/2022	98.0	7865	2779	3340	392650	280078	N/A
24	12/17/2022	97.8	7754	5592	4005	394140	273057	N/A
25	12/17/2022	97.0	7729	5971	3453	399150	278596	N/A
26	12/17/2022	97.4	7562	5716	3530	396670	276237	N/A
27	12/18/2022	98.0	7837	3117	3550	397540	270887	N/A
28	12/18/2022	97.2	7610	5860	3409	391640	273777	N/A
29	12/18/2022	97.6	7400.627	5755.48	3284.087	392168	274687	N/A
30	12/19/2022	96.8	7432	6240	3327	391960	272812	N/A
31	12/19/2022	97.2	7358	5757	3317	394590	275636	N/A
32	12/20/2022	97.9	7244	5647	3359	398125	271966	N/A
33	12/20/2022	97.4	7030.665	5506.57	3402.577	392820	277971	N/A
34	12/20/2022	97.7	7355	6235	3442	399110	275700	N/A
35	12/20/2022	96.2	7307	6253	3353	396170	274710	N/A
36	12/21/2022	96.8	7108	6101	3362	388640	270270	N/A
	AVERAGE	96	7,848	4,924	3,630	14,078,681	10,486,752	TOTAL

RECEIVED
Office of Oil and Gas

APR 24 2023

WV Department of
Environmental Protection
12/08/2023

EXHIBIT 3

LITHOLOGY/ FORMATION	TOP DEPTH (TVD)	BOTTOM DEPTH (TVD)	TOP DEPTH (MD)	BOTTOM DEPTH (MD)
	From Surface	From Surface	From Surface	From Surface
Sandstone, tr coal	154	304	154	304
Shaley Siltstone	304	424	304	424
Sandy Siltstone	424	664	424	664
Shaley Siltstone, tr coal	544	754	544	754
Shaley Siltstone	664	754	664	754
Shaley Siltstone, tr coal	754	814	754	814
Shaley Siltstone, tr SS	814	934	814	934
Sandy Shale w/ coal	934	1,054	934	1,054
Sandy Shale w/ tr coal	1,054	1,234	1,054	1,234
Shaley Sandstone w/ coal	1,234	1,324	1,234	1,324
Silty Sandstone, tr shale	1,324	1,594	1,324	1,594
Silty Sandstone w/ shale	1,594	1,684	1,594	1,684
Shaly Sandstone w/ tr siltstone	1,684	1,744	1,684	1,744
Silty Sandstone w/ tr coal	1,744	1,804	1,744	1,804
Silty Sandstone, tr shale	1,804	1,915	1,804	1,924
Big Lime	1,941	2,543	1,924	2,556
Fifty Foot Sandstone	2,543	2,599	2,530	2,613
Gordon	2,599	2,827	2,587	2,842
Fifth Sandstone	2,827	3,030	2,816	3,046
Bayard	3,030	3,706	3,020	3,728
Speechley	3,706	3,936	3,702	3,960
Balltown	3,936	4,444	3,934	4,470
Bradford	4,444	4,882	4,444	4,910
Benson	4,882	5,163	4,884	5,192
Alexander	5,163	6,387	5,166	6,455
Sycamore	6,227	6,361	6,271	6,429
Middlesex	6,361	6,491	6,429	6,633
Burkett	6,491	6,524	6,633	6,703
Tully	6,524	6,567	6,703	6,829
Marcellus	6,567	NA	6,829	NA

*Please note Antero determines formation tops based on mud logs that are only run on one well on a multi-well pad. The measured depth (MD) data on subsequent wells may be slightly different due to the well's unique departure.

RECEIVED
Office of Oil and Gas
APR 24 2023
WV Department of
Environmental Protection

12/08/2023

LATITUDE 39°17'30"

2,255'

LATITUDE 39°17'30"

2,979' TO BOTTOM HOLE

Antero Resources Corporation Well No. Redwood 2H

NOTES:

WELL 2H TOP HOLE INFORMATION: N: 276,964ft E: 1,631,974ft LAT: 39°15'11.24" LON: 80°47'58.67" BOTTOM HOLE INFORMATION: N: 284,084ft E: 1,631,352ft LAT: 39°16'21.51" LON: 80°48'07.88" WEST VIRGINIA COORDINATE SYSTEM OF 1927 NORTH ZONE. ZONE WAS DERIVED FROM MEASUREMENTS TAKEN WITH TRIMBLE GEOXT SUBMETER MAPPING GRADE GPS UNIT. PLAT ORIENTATION, CORNER, AND WELL REFERENCE TIE LINES ARE BASED ON GRID NORTH.

(NAD) 83 (UTM) ZONE 17 COORDS: WELL 2H TOP HOLE INFORMATION: N: 4,344,895m E: 517,303m BOTTOM HOLE INFORMATION: N: 4,347,061m E: 517,078m

(NAD) 27 (UTM) ZONE 17 COORDS: WELL 2H TOP HOLE INFORMATION: N: 14,254,161ft E: 1,697,139ft POINT OF ENTRY INFORMATION: N: 14,254,085ft E: 1,697,206ft BOTTOM HOLE INFORMATION: N: 14,261,267ft E: 1,696,388ft

Table listing landowners and lease information for West Union District, including names like Alfred Perine, Lisa Meyer, and various lease numbers.

WV NORTH ZONE GRID NORTH

6,930' TO BOTTOM HOLE

LONGITUDE 80°47'30"

14,039'

LONGITUDE 80°47'30"

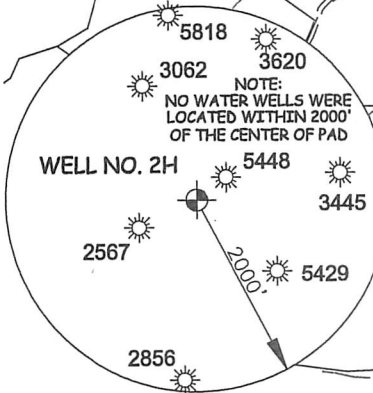

NOTE: NO WATER WELLS WERE LOCATED WITHIN 2000' OF THE CENTER OF PAD

I THE UNDERSIGNED, HEREBY CERTIFY THAT THIS PLAT IS CORRECT TO THE BEST OF MY KNOWLEDGE AND BELIEF AND SHOWS ALL THE INFORMATION REQUIRED BY LAW AND THE RULES ISSUED AND PERSCRIBED BY THE DEPARTMENT OF ENVIRONMENTAL PROTECTION.



STATE OF WEST VIRGINIA, DIVISION OF ENVIRONMENTAL PROTECTION, OFFICE OF OIL AND GAS

WILLOW LAND SURVEYING PLLC 220 MASONIC AVE. PENNSBORO WEST VIRGINIA 26415

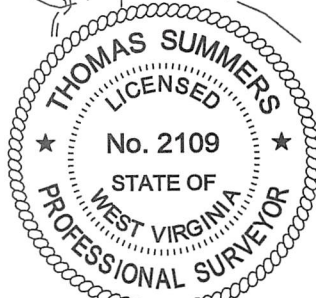

JOB # 19-039WA DRAWING # REDWOOD2HAD SCALE 1" = 2000' MINIMUM DEGREE OF ACCURACY SUBMETER PROVEN SOURCE OF ELEV. SUBMETER MAPPING GRADE GPS

LEGEND: Surface Owner Boundary Lines +/-, Interior Surface Tracts +/-, Proposed Well Path, As Drilled Well Path. Signature of Thomas Summers P.S. 2109.

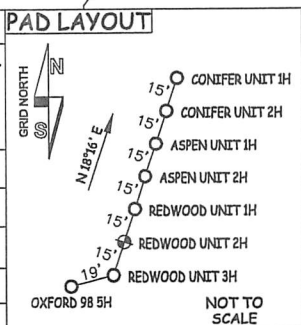

NOTE: 1. NO OCCUPIED DWELLINGS OR BUILDINGS TWO THOUSAND FIVE HUNDRED (2,500) SQUARE FEET OR LARGER USED TO HOUSE OR SHELTER DAIRY CATTLE OR POULTRY HUSBANDRY ARE LOCATED WITHIN SIX HUNDRED TWENTY-FIVE (625) FEET OF THE CENTER OF THE WELL PAD. 2. TOP HOLE DATA SHOWN HEREON WAS PROVIDED BY ANTERO RESOURCES CORPORATION. 3. AS DRILLED DATA WAS PROVIDED BY ANTERO RESOURCES CORPORATION. 4. WLS IS NOT CERTIFYING THE DATA AND INFORMATION PROVIDED LISTED IN NOTES 2 AND 3, ONLY THE RELATIONSHIP TO THE DATA AND INFORMATION PROVIDED TO THE LEASE BOUNDARIES. 5. WLS IS BY NO MEANS RESPONSIBLE FOR ANY ERRORS OR INACCURACIES WITH THE DATA AND INFORMATION THAT HAS BEEN PROVIDED.

STATE OF WEST VIRGINIA DEPARTMENT OF ENERGY DIVISION OF OIL AND GAS

DATE 04/14/23 OPERATOR'S WELL# REDWOOD 2H

WELL TYPE: OIL ___ GAS X LIQUID INJECTION ___ WASTE DISPOSAL ___ 47 - 017 - 06931 (IF "GAS") PRODUCTION X STORAGE ___ DEEP ___ SHALLOW X STATE COUNTY PERMIT LOCATION: ELEVATION 1,120' - AS BUILT WATERSHED HEADWATERS MIDDLE ISLAND CREEK QUADRANGLE WEST UNION 7.5' DISTRICT WEST UNION COUNTY DODDRIDGE SURFACE OWNER MICHAEL R. BRITTON & ANGELA D. PRATT ACREAGE 136.56 ACRES +/- 12/08/2023 OIL & GAS ROYALTY OWNER MICHAEL S. FRANCIS ET AL; RICHARD W. MINNIS ET AL; LEASE ACREAGE 173 AC +/-; 69 AC +/-; JAMES P. GAINES ET UX; SHIRLEY W. FLEMING; FRANKLIN L. BUTLER; J.S. NETZER ET UX; 200 AC +/-; 29 AC +/-; 109 AC +/-; 85 AC +/-; WILMER ROLLINS ET UX; EMORY ROLLINS ET UX; A. K. ROLLINS ET UX; 75 AC +/-; 44 AC +/-; 40 AC +/- PROPOSED WORK: DRILL ___ CONVERT ___ DRILL DEEPER X REDRILL ___ FRACTURE OR STIMULATE X PLUG OFF OLD FORMATION ___ PERFORATE NEW FORMATION X OTHER PHYSICAL CHANGE IN WELL (SPECIFY) AS DRILLED PLUG & ABANDON CLEAN OUT & REPLUG TARGET FORMATION MARCELLUS ESTIMATED DEPTH 6,705' TVD 14,002' MD WELL OPERATOR ANTERO RESOURCES CORP. DESIGNATED AGENT KEVIN ELLIS ADDRESS 1615 WYNKOOP ST. DENVER, CO 80202 ADDRESS 554 WHITE OAKS BLVD BRIDGEPORT, WV 26330

Hydraulic Fracturing Fluid Product Component Information Disclosure

Job Start Date:	12/11/2022
Job End Date:	12/21/2022
State:	West Virginia
County:	Doddridge
API Number:	47-017-06931-00-00
Operator Name:	Antero Resources Corporation
Well Name and Number:	Redwood 2H
Latitude:	39.25312000
Longitude:	-80.79963000
Datum:	WGS84
Federal Well:	NO
Indian Well:	NO
True Vertical Depth:	6,713
Total Base Water Volume (gal):	10,780,308
Total Base Non Water Volume:	0

RECEIVED
 Office of Oil and Gas
 APR 24 2023
 WV Department of Environmental Protection



Hydraulic Fracturing Fluid Composition:

Trade Name	Supplier	Purpose	Ingredients	Chemical Abstract Service Number (CAS #)	Maximum Ingredient Concentration in Additive (% by mass)**	Maximum Ingredient Concentration in HF Fluid (% by mass)**	Comments
Fresh Water	Halliburton	Base Fluid					
			Water	7732-18-5	100.00000	86.27333	Density = 8.34
Ingredients	Listed Above	Listed Above					
			Water	7732-18-5	100.00000	0.15579	

Sand-Common White-100 Mesh, SSA-2	Halliburton	Proppant					
				Listed Below			
Chemstream StimSTREAM FR 9750	Chemstream Oilfield Services	Friction Reducer					
				Listed Below			
OPTIFLO-II DELAYED RELEASE BREAKER	Halliburton	Breaker					
				Listed Below			
Chemstream StimSTREAM FR 9800	Chemstream, Inc.	Friction Reducer					
				Listed Below			
WG-36 GELLING AGENT	Halliburton	Gelling Agent					
				Listed Below			
MC B-8614A	MultiChem	Biocide					
				Listed Below			
HAI-501	Halliburton	Acid Corrosion Inhibitor					
				Listed Below			
HYDROCHLORIC ACID, 22 BAUME	Halliburton	Solvent					
				Listed Below			

RECEIVED
 Office of Oil and Gas
 APR 24 2023
 WV Department of
 Environmental Protection

LEGEND(TM) LD-7750W	MultiChem	Scale Control					
				Listed Below			
Items above are Trade Names with the exception of Base Water . Items below are the individual ingredients.							
			Crystalline silica, quartz	14808-60-7	100.00000	13.50958	
			Hydrochloric acid	7647-01-0	30.00000	0.04131	
			Distillates (petroleum), hydrotreated light	64742-47-8	25.00000	0.01351	
			Methanol	67-56-1	100.00000	0.00727	
			Guar gum	9000-30-0	100.00000	0.00689	
			Alcohols, C11-14-iso, C- 13-rich, ethoxylated	78330-21-9	5.00000	0.00270	
			Glutaraldehyde	111-30-8	30.00000	0.00251	
			Phosphoric Acid Salt	Proprietary	5.00000	0.00058	
			Sodium chloride	7647-14-5	5.00000	0.00058	
			Alkyl (C12-16) dimethylbenzyl ammonium chloride	68424-85-1	5.00000	0.00042	
			Ammonium persulfate	7727-54-0	100.00000	0.00015	
			Ethanol	64-17-5	1.00000	0.00008	
			Modified thiourea polymer	Proprietary	30.00000	0.00008	
			Mixture of dimer and trimer fatty acids of indefinite composition derived from tall oil	61790-12-3	30.00000	0.00008	
			Oxylated phenolic resin	Proprietary	30.00000	0.00004	
			Propargyl alcohol	107-19-7	5.00000	0.00001	
			Hexadecene	629-73-2	5.00000	0.00001	
			Ethoxylated alcohols	Proprietary	5.00000	0.00001	
			Formaldehyde	50-00-0	0.10000	0.00001	
			C.I. pigment Orange 5	3468-63-1	1.00000	0.00000	
			Butene, homopolymer	9003-29-6	25.00000		
			Alkanes, C16-20-iso-	Proprietary	25.00000		

Environmental
 Health & Safety
 Division

APR 24 2022

RECEIVED
 Office of Oil and Gas

			Ethoxylated alcohols (C12-16)	68213-23-0	3.00000		
--	--	--	----------------------------------	------------	---------	--	--

* Total Water Volume sources may include various types of water including fresh water, produced water, and recycled water

** Information is based on the maximum potential for concentration and thus the total may be over 100%

*** If you are calculating a percentage of total ingredients do not add the water volume below the green line to the water volume above the green line

Note: For Field Development Products (products that begin with FDP), MSDS level only information has been provided.

Ingredient information for chemicals subject to 29 CFR 1910.1200(i) and Appendix D are obtained from suppliers Material Safety Data Sheets (MSDS)

RECEIVED
Office of Oil and Gas
APR 24 2023
WV Department of
Environmental Protection