

State of West Virginia
Department of Environmental Protection - Office of Oil and Gas
Well Operator's Report of Well Work

API 47 - 017 - 06930 County Doddridge District West Union
Quad West Union 7.5' Pad Name OXFD 98 Field/Pool Name -----
Farm name Michael R. Britton & Angela D. Pratt Well Number Redwood Unit 1H
Operator (as registered with the OOG) Antero Resources Corporation
Address 1615 Wynkoop Street City Denver State CO Zip 80202

As Drilled location NAD 83/UTM Attach an as-drilled plat, profile view, and deviation survey
Top hole Northing 4344899m Easting 517305m
Landing Point of Curve Northing 4344796.57m Easting 517078.31m
Bottom Hole Northing 4346871m Easting 516835m

Elevation (ft) 1120' GL Type of Well New Existing Type of Report Interim Final
Permit Type Deviated Horizontal Horizontal 6A Vertical Depth Type Deep Shallow
Type of Operation Convert Deepen Drill Plug Back Redrilling Rework Stimulate
Well Type Brine Disposal CBM Gas Oil Secondary Recovery Solution Mining Storage Other _____
Type of Completion Single Multiple Fluids Produced Brine Gas NGL Oil Other _____
Drilled with Cable Rotary

Drilling Media Surface hole Air Mud Fresh Water Intermediate hole Air Mud Fresh Water Brine
Production hole Air Mud Fresh Water Brine
Mud Type(s) and Additive(s)
Air - Foam & 4% KCL
Mud - Polymer

Date permit issued 6/16/2022 Date drilling commenced 7/6/2022 Date drilling ceased 9/25/2022
Date completion activities began 12/9/2022 Date completion activities ceased 1/7/2023
Verbal plugging (Y/N) N/A Date permission granted N/A Granted by N/A

Please note: Operator is required to submit a plugging application within 5 days of verbal permission to plug

Freshwater depth(s) ft 123, 1001' Open mine(s) (Y/N) depths No
Salt water depth(s) ft 1653' Void(s) encountered (Y/N) depths No
Coal depth(s) ft 120' Cavern(s) encountered (Y/N) depths No
Is coal being mined in area (Y/N) No

APPROVED

Office of Oil and Gas
APR 24 2023
WV Department of
Environmental Protection

Reviewed by:
IMC
12/08/2023
7/18/23

API 47-017 - 06930 Farm name Michael R. Britton & Angela D. Pratt Well number Redwood Unit 1H

CASING STRINGS	Hole Size	Casing Size	Depth	New or Used	Grade wt/ft	Basket Depth(s)	Did cement circulate (Y/N) * Provide details below*
Conductor	28"	20"	125.5'	New	78.67#, X-60	N/A	Y
Surface	17-1/2"	13-3/8"	351'	New	54.5#, J-55	N/A	Y
Coal							
Intermediate 1	12-1/4"	9-5/8"	2627'	New	36#, J-55	N/A	Y
Intermediate 2							
Intermediate 3							
Production	8-3/4"/8-1/2"	5-1/2"	14002'	New	20#, P-110	N/A	Y
Tubing		2-3/8"	6639'		4.7#, P-110		
Packer type and depth set		N/A					

Comment Details _____

CEMENT DATA	Class/Type of Cement	Number of Sacks	Slurry wt (ppg)	Yield (ft ³ /sks)	Volume (ft ³)	Cement Top (MD)	WOC (hrs)
Conductor	Class A	218 sx	15.6	1.18	257	0'	8 Hrs.
Surface	Class A	380 sx	15.6	1.20	456	0'	8 Hrs.
Coal							
Intermediate 1	Class A	903 sx	15.6	1.20	1084	0'	8 Hrs.
Intermediate 2							
Intermediate 3							
Production	Class H	2369 sx (Tail)	13.5 (Lead), 15.2(Tail)	1.26 (Tail)	2985	-500' into Intermediate casing	8 Hrs.
Tubing							

Drillers TD (ft) 16900' MD, 6600' TVD (BHL), 6705' (Deepest Point Drilled) Loggers TD (ft) 16900' MD
 Deepest formation penetrated Marcellus Plug back to (ft) N/A
 Plug back procedure N/A

Kick off depth (ft) _____

Check all wireline logs run caliper density deviated/directional induction
 neutron resistivity gamma ray temperature sonic

Well cored Yes No Conventional Sidewall Were cuttings collected Yes No

DESCRIBE THE CENTRALIZER PLACEMENT USED FOR EACH CASING STRING _____

Conductor - 0
 Surface - 1 above guide shoe, 1 above insert float, 1 every 4th joint to surface
 Intermediate - 1 above float joint, 1 above float collar, 1 every 4th joint to surface
 Production - 1 above float joint, 1 below float collar, 1 every 3rd joint to top of cement

WAS WELL COMPLETED AS SHOT HOLE Yes No DETAILS _____

WAS WELL COMPLETED OPEN HOLE? Yes No DETAILS _____

WERE TRACERS USED Yes No TYPE OF TRACER(S) USED N/A

RECEIVED
Office of Oil and Gas
APR 24 2023
WV Department of Environmental Protection

API 47-017-06930 Farm Name Michael R. Britton & Angela D. Pratt Well Number Redwood Unit 1H

Exhibit 1

Stage No.	Perforation Date	Perforated from MD ft.	Perforated to MD ft.	Number of Perforations	Formations
1	12/9/2022	13886	13843	60	Marcellus
2	12/9/2022	13804.62745	13639.7647	60	Marcellus
3	12/9/2022	13604.39216	13439.5294	60	Marcellus
4	12/9/2022	13404.15686	13239.2941	60	Marcellus
5	12/9/2022	13203.92157	13039.0588	60	Marcellus
6	12/10/2022	13003.68627	12838.8235	60	Marcellus
7	12/10/2022	12803.45098	12638.5882	60	Marcellus
8	12/10/2022	12603.21569	12438.3529	60	Marcellus
9	12/10/2022	12402.98039	12238.1176	60	Marcellus
10	12/10/2022	12202.7451	12037.8824	60	Marcellus
11	12/10/2022	12002.5098	11837.6471	60	Marcellus
12	12/10/2022	11802.27451	11637.4118	60	Marcellus
13	12/11/2022	11602.03922	11437.1765	60	Marcellus
14	12/11/2022	11401.80392	11236.9412	60	Marcellus
15	12/11/2022	11201.56863	11036.7059	60	Marcellus
16	12/15/2022	11001.33333	10836.4706	60	Marcellus
17	12/15/2022	10801.09804	10636.2353	60	Marcellus
18	12/15/2022	10600.86275	10436	60	Marcellus
19	12/16/2022	10400.62745	10235.7647	60	Marcellus
20	12/16/2022	10200.39216	10035.5294	60	Marcellus
21	12/16/2022	10000.15686	9835.29412	60	Marcellus
22	12/17/2022	9799.921569	9635.05882	60	Marcellus
23	12/17/2022	9599.686275	9434.82353	60	Marcellus
24	12/17/2022	9399.45098	9234.58824	60	Marcellus
25	12/17/2022	9199.215686	9034.35294	60	Marcellus
26	12/18/2022	8998.980392	8834.11765	60	Marcellus
27	12/18/2022	8798.745098	8633.88235	60	Marcellus
28	12/18/2022	8598.509804	8433.64706	60	Marcellus
29	12/19/2022	8398.27451	8233.41176	60	Marcellus
30	12/19/2022	8198.039216	8033.17647	60	Marcellus
31	12/20/2022	7997.803922	7832.94118	60	Marcellus
32	12/20/2022	7797.568627	7632.70588	60	Marcellus
33	12/20/2022	7597.333333	7432.47059	60	Marcellus
34	12/21/2022	7397.098039	7232.23529	60	Marcellus
35	12/21/2022	7196.862745	7032	60	Marcellus

RECEIVED
Office of Oil and Gas

APR 24 2023

WV Department of
Environmental Protection

12/08/2023

API 47-017-06930 Farm Name Michael R. Britton & Angela D. Pratt Well Number Redwood Unit 1H

EXHIBIT 2

Stage No.	Stimulations Date	Avg Pump Rate	Avg Treatment Pressure (PSI)	Max Breakdown Pressure (PSI)	ISIP (PSI)	Amount of Proppant (lbs)	Amount of Water (bbls)	Amount of Nitrogen/ other (units)
1	12/9/2022	81.8	7978	6120	4966	179820	203355	N/A
2	12/9/2022	94.9	8390	5330	3975	399394	291730	N/A
3	12/9/2022	96.0	8322.932	4714.23	4105.117	396260	292585	N/A
4	12/9/2022	95.3	8158	3620	3546	391960	285106	N/A
5	12/9/2022	93.5	8137	2890	3984	405700	280265	N/A
6	12/10/2022	96.4	8287	3744	3660	401290	281605	N/A
7	12/10/2022	96.2	8309	5258	3994	405760	295310	N/A
8	12/10/2022	96.1	8104.124	5808.04	3466.987	397220	287520	N/A
9	12/10/2022	96.8	8389	5735	3563	401710	280086	N/A
10	12/10/2022	96.6	8268.018	5878.06	3582.579	403860	280456	N/A
11	12/10/2022	97.1	8127	5752	4015	404640	290865	N/A
12	12/10/2022	98.4	8010	4235	3996	397680	310693	N/A
13	12/11/2022	98.2	8106	4761	4002	394590	284664	N/A
14	12/11/2022	96.9	8024	5505	4033	391300	372958	N/A
15	12/11/2022	96.3	8163.382	5603.41	3353.769	397460	284745	N/A
16	12/15/2022	98.6	7757	3914	3013	389940	364591	N/A
17	12/15/2022	97.3	7903.513	7902.16	3190.12	391990	331991	N/A
18	12/15/2022	97.6	7596.329	5457.19	3405.351	386030	318813	N/A
19	12/16/2022	98.1	8090	5464	3991	397520	303322	N/A
20	12/16/2022	97.1	7800.251	5737.75	3333.82	394970	380493	N/A
21	12/16/2022	97.0	7680	5712	3506	391340	301092	N/A
22	12/17/2022	97.6	7853	2727	3999	389920	275155	N/A
23	12/17/2022	97.2	7760.386	5692.74	3267.276	398790	278959	N/A
24	12/17/2022	97.9	7476.98	5472.41	3387.127	397840	277515	N/A
25	12/17/2022	97.7	7739	5899	3535	391850	271799	N/A
26	12/18/2022	97.6	7578	2778	4003	391820	270507	N/A
27	12/18/2022	97.5	7622	5422	3457	396950	277648	N/A
28	12/18/2022	98.3	7406	5576	3515	397790	284313	N/A
29	12/19/2022	96.7	7375	5944	3464	394740	272823	N/A
30	12/19/2022	98.7	7242	3482	3332	392120	271275	N/A
31	12/20/2022	97.8	7223	2973	4005	396840	277795	N/A
32	12/20/2022	97.2	7192.398	5807.04	3201.06	401530	278099	N/A
33	12/20/2022	97.6	7411	6234	3503	396110	279289	N/A
34	12/21/2022	94.8	7205.464	6111.46	3291.01	388180	274650	N/A
35	12/21/2022	96.3	7115	6127	3354	394960	289107	N/A
	AVERAGE	97	7,823	5,125	3,657	13,649,874	10,201,179	TOTAL

12/08/2023

EXHIBIT 3

LITHOLOGY/ FORMATION	TOP DEPTH (TVD)	BOTTOM DEPTH (TVD)	TOP DEPTH (MD)	BOTTOM DEPTH (MD)
	From Surface	From Surface	From Surface	From Surface
Sandstone, tr coal	154	304	154	304
Shaley Siltstone	304	424	304	424
Sandy Siltstone	424	664	424	664
Shaley Siltstone, tr coal	544	754	544	754
Shaley Siltstone	664	754	664	754
Shaley Siltstone, tr coal	754	814	754	814
Shaley Siltstone, tr SS	814	934	814	934
Sandy Shale w/ coal	934	1,054	934	1,054
Sandy Shale w/ tr coal	1,054	1,234	1,054	1,234
Shaley Sandstone w/ coal	1,234	1,324	1,234	1,324
Silty Sandstone, tr shale	1,324	1,594	1,324	1,594
Silty Sandstone w/ shale	1,594	1,684	1,594	1,684
Shaly Sandstone w/ tr siltstone	1,684	1,744	1,684	1,744
Silty Sandstone w/ tr coal	1,744	1,804	1,744	1,804
Silty Sandstone, tr shale	1,804	1,918	1,804	1,946
Big Lime	1,944	2,540	1,946	2,584
Fifty Foot Sandstone	2,540	2,599	2,558	2,644
Gordon	2,599	2,835	2,618	2,888
Fifth Sandstone	2,835	3,045	2,862	3,105
Bayard	3,045	3,700	3,079	3,779
Speechley	3,700	3,948	3,753	4,033
Balltown	3,948	4,447	4,007	4,545
Bradford	4,447	4,900	4,519	5,011
Benson	4,900	5,179	4,985	5,294
Alexander	5,179	6,391	5,268	6,573
Sycamore	6,230	6,365	6,385	6,547
Middlesex	6,365	6,497	6,547	6,760
Burkett	6,497	6,530	6,760	6,833
Tully	6,530	6,574	6,833	6,984
Marcellus	6,574	NA	6,984	NA

*Please note Antero determines formation tops based on mud logs that are only run on one well on a multi-well pad. The measured depth (MD) data on subsequent wells may be slightly different due to the well's unique departure.

RECEIVED
Office of Oil and Gas

APR 24 2023

WV Department of
Environmental Protection

RECEIVED
Office of Oil and Gas

APR 24 2023

WV Department of
Environmental Protection

12/08/2023

LATITUDE 39°17'30"

2,250'

LATITUDE 39°17'30" 3,769' TO BOTTOM HOLE

Antero Resources Corporation Well No. Redwood 1H

NOTES: WELL 1H TOP HOLE INFORMATION: N: 276,979ft E: 1,631,978ft LAT: 39°15'11.38" LON: 80°47'58.61" BOTTOM HOLE INFORMATION: N: 283,425ft E: 1,630,553ft LAT: 39°16'14.89" LON: 80°48'17.92" WEST VIRGINIA COORDINATE SYSTEM OF 1927 NORTH ZONE. ZONE WAS DERIVED FROM MEASUREMENTS TAKEN WITH TRIMBLE GEOXT SUBMETER MAPPING GRADE GPS UNIT. PLAT ORIENTATION, CORNER, AND WELL REFERENCE TIE LINES ARE BASED ON GRID NORTH.

(NAD) 83 (UTM) ZONE 17 COORDS: WELL 1H TOP HOLE INFORMATION: N: 4,344,899m E: 517,305m BOTTOM HOLE INFORMATION: N: 4,346,856m E: 516,838m

(NAD) 27 (UTM) ZONE 17 COORDS: WELL 1H TOP HOLE INFORMATION: N: 14,254,176ft E: 1,697,143ft POINT OF ENTRY INFORMATION: N: 14,253,665ft E: 1,696,473ft BOTTOM HOLE INFORMATION: N: 14,260,595ft E: 1,695,611ft

Table listing well numbers and names in the West Union District, including Alfred Perine, Gail DeBerry, Lisa Meyer, Dennis Hayes, Marvin Rollins, Glenn Whitehair, Mark Smith, Michael Mignone, Richard Leggett, Richard Leggett, Richard Leggett, Mary Nealer, Danny Harris, Roger Britton, Danny Harris, Coastal Forest Resources Co, Doddridge County Board of Education, Coastal Forest Resources Co, Coastal Forest Resources Co, Coastal Forest Resources Co, Drexelene Perrine, Michael Wilkinson, Michael Wilkinson, John Trent, Loren Smith, Kenneth Hughes, Glade Perine, Donald Perine, EQM Gathering OPCO LLC, Michael Britton, Russell Nelson, Arnold Creek UB Church, Michael Wilkinson, Loren Smith, EQM Gathering OPCO LLC, Loren Smith, Loren Smith, Loren Smith, Jessie Vansacy, Loren Smith, Diane Bennett, CNS Transmission Corp, Loren Smith, Mary Sechrist.

WV NORTH ZONE GRID NORTH

7,599' TO BOTTOM HOLE

14,025'

LONGITUDE 80°47'30"

LONGITUDE 80°47'30"

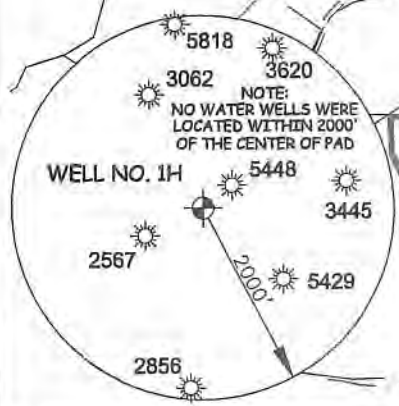

NOTE: NO WATER WELLS WERE LOCATED WITHIN 2000' OF THE CENTER OF PAD

I, THE UNDERSIGNED, HEREBY CERTIFY THAT THIS PLAT IS CORRECT TO THE BEST OF MY KNOWLEDGE AND BELIEF AND SHOWS ALL THE INFORMATION REQUIRED BY LAW AND THE RULES ISSUED AND PERSCRIBED BY THE DEPARTMENT OF ENVIRONMENTAL PROTECTION.



STATE OF WEST VIRGINIA, DIVISION OF ENVIRONMENTAL PROTECTION, OFFICE OF OIL AND GAS. WILLOW LAND SURVEYING PLLC 220 MASONIC AVE. PENNSBORO WEST VIRGINIA 26415

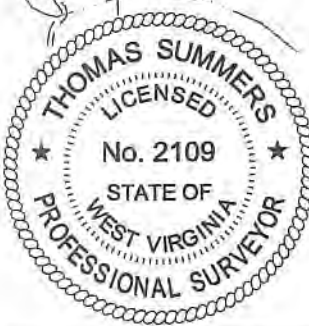

JOB # 19-039WA DRAWING # REDWOOD1HAD SCALE 1" = 2000' MINIMUM DEGREE OF ACCURACY SUBMETER PROVEN SOURCE OF ELEV. SUBMETER MAPPING GRADE GPS

LEGEND: Surface Owner Boundary Lines +/-, Interior Surface Tracts +/-, Proposed Well Path, As Drilled Well Path. THOMAS SUMMERS P.S. 2109

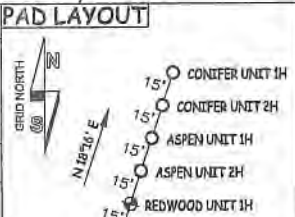

- NOTE: 1. NO OCCUPIED DWELLINGS OR BUILDINGS TWO THOUSAND FIVE HUNDRED (2,500) SQUARE FEET OR LARGER USED TO HOUSE OR SHELTER DAIRY CATTLE OR POULTRY HUSBANDRY ARE LOCATED WITHIN SIX HUNDRED TWENTY-FIVE (625) FEET OF THE CENTER OF THE WELL PAD. 2. TOP HOLE DATA SHOWN HEREON WAS PROVIDED BY ANTERO RESOURCES CORPORATION. 3. AS DRILLED DATA WAS PROVIDED BY ANTERO RESOURCES CORPORATION. 4. WLS IS NOT CERTIFYING THE DATA AND INFORMATION PROVIDED LISTED IN NOTES 2 AND 3, ONLY THE RELATIONSHIP TO THE DATA AND INFORMATION PROVIDED TO THE LEASE BOUNDARIES. 5. WLS IS BY NO MEANS RESPONSIBLE FOR ANY ERRORS OR INACCURACIES WITH THE DATA AND INFORMATION THAT HAS BEEN PROVIDED.

STATE OF WEST VIRGINIA DEPARTMENT OF ENERGY DIVISION OF OIL AND GAS

DATE 04/14/23 OPERATOR'S WELL# REDWOOD 1H

WELL TYPE: OIL ___ GAS X LIQUID INJECTION ___ WASTE DISPOSAL ___ 47 - 017 - 06930 (IF "GAS") PRODUCTION X STORAGE ___ DEEP ___ SHALLOW X STATE COUNTY PERMIT LOCATION: ELEVATION 1,120' - AS BUILT WATERSHED HEADWATERS MIDDLE ISLAND CREEK QUADRANGLE WEST UNION 7.5 DISTRICT WEST UNION COUNTY DODDRIDGE SURFACE OWNER MICHAEL R. BRITTON & ANGELA D. PRATT ACREAGE 136.56 ACRES +/- 12/08/2023 OIL & GAS ROYALTY OWNER MICHAEL S. FRANCIS ET AL.; RICHARD W. MINNIS ET AL.; WANDA HURST; LEASE ACREAGE 173 AC±; 69 AC±; 50 AC±; JAMES P. GAINES ET UX; RITCHIE BRITTON ET UX; FRANKLIN L. BUTLER; J.S. NETZER ET UX; WILMER ROLLINS ET UX; 200 AC±; 126 AC±; 109 AC±; 85 AC±; 75 AC±; EMORY ROLLINS ET UX 44 AC± PROPOSED WORK: DRILL ___ CONVERT ___ DRILL DEEPER X REDRILL ___ FRACTURE OR STIMULATE X PLUG OFF OLD FORMATION ___ PERFORATE NEW FORMATION X OTHER PHYSICAL CHANGE IN WELL (SPECIFY) AS DRILLED PLUG & ABANDON CLEAN OUT & REPLUG TARGET FORMATION MARCELLUS ESTIMATED DEPTH 6,705' TVD 14,002' MD WELL OPERATOR ANTERO RESOURCES CORP. DESIGNATED AGENT KEVIN ELLIS ADDRESS 1615 WYNKOOP ST. ADDRESS 554 WHITE OAKS BLVD FORM WW-6 DENVER, CO 80202 BRIDGEPORT, WV 26330

COUNTY NAME

PERMIT

Hydraulic Fracturing Fluid Product Component Information Disclosure

Job Start Date:	12/9/2022
Job End Date:	12/21/2022
State:	West Virginia
County:	Doddridge
API Number:	47-017-06930-00-00
Operator Name:	Antero Resources Corporation
Well Name and Number:	Redwood 1H
Latitude:	39.25316000
Longitude:	-80.79961000
Datum:	WGS84
Federal Well:	NO
Indian Well:	NO
True Vertical Depth:	6,703
Total Base Water Volume (gal):	10,494,982
Total Base Non Water Volume:	0

RECEIVED
 Office of Oil and Gas
 APR 24 2023
 WV Department of
 Environmental Protection



Hydraulic Fracturing Fluid Composition:

Trade Name	Supplier	Purpose	Ingredients	Chemical Abstract Service Number (CAS #)	Maximum Ingredient Concentration in Additive (% by mass)**	Maximum Ingredient Concentration in HF Fluid (% by mass)**	Comments
Fresh Water	Halliburton	Base Fluid					
			Water	7732-18-5	100.00000	86.32114	Density = 8.34
Ingredients	Listed Above	Listed Above					
			Water	7732-18-5	100.00000	0.15584	

WG-36 GELLING AGENT	Halliburton	Gelling Agent					
				Listed Below			
OPTIFLO-II DELAYED RELEASE BREAKER	Halliburton	Breaker					
				Listed Below			
HYDROCHLORIC ACID, 22 BAUME	Halliburton	Solvent					
				Listed Below			
HAI-501	Halliburton	Acid Corrosion Inhibitor					
				Listed Below			
Sand-Common White-100 Mesh, SSA-2	Halliburton	Proppant					
				Listed Below			
LEGEND(TM) LD-7750W	MultiChem	Scale Control					
				Listed Below			
Chemstream StimSTREAM FR 9750	Chemstream Oilfield Services	Friction Reducer					
				Listed Below			
MC B-8614A	MultiChem	Biocide					
				Listed Below			

RECEIVED
 Office of Oil and Gas
 APR 24 2023
 WV Department of
 Environmental Protection

Chemstream StimSTREAM FR 9800	Chemstream, Inc.	Friction Reducer					
				Listed Below			
Items above are Trade Names with the exception of Base Water ; Items below are the individual ingredients.							
			Crystalline silica, quartz	14808-60-7	100.00000	13.46166	
			Hydrochloric acid	7647-01-0	30.00000	0.04129	
			Distillates (petroleum), hydrotreated light	64742-47-8	25.00000	0.01356	
			Methanol	67-56-1	100.00000	0.00719	
			Guar gum	9000-30-0	100.00000	0.00672	
			Alcohols, C11-14-iso, C- 13-rich, ethoxylated	78330-21-9	5.00000	0.00271	
			Glutaraldehyde	111-30-8	30.00000	0.00257	
			Phosphoric Acid Salt	Proprietary	5.00000	0.00058	
			Sodium chloride	7647-14-5	5.00000	0.00058	
			Alkyl (C12-16) dimethylbenzyl ammonium chloride	68424-85-1	5.00000	0.00043	
			Ammonium persulfate	7727-54-0	100.00000	0.00017	
			Ethanol	64-17-5	1.00000	0.00009	
			Modified thiourea polymer	Proprietary	30.00000	0.00008	
			Mixture of dimer and trimer fatty acids of indefinite composition derived from tall oil	61790-12-3	30.00000	0.00008	
			Oxylated phenolic resin	Proprietary	30.00000	0.00005	
			Hexadecene	629-73-2	5.00000	0.00001	
			Ethoxylated alcohols	Proprietary	5.00000	0.00001	
			Propargyl alcohol	107-19-7	5.00000	0.00001	
			Formaldehyde	50-00-0	0.10000	0.00001	
			C.I. pigment Orange 5	3468-63-1	1.00000	0.00000	
			Alkanes, C16-20-iso-	Proprietary	25.00000		

RECEIVED
 Office of Oil and Gas
 APR 24 2023
 WV Department of
 Environmental Protection

			Ethoxylated alcohols (C12-16)	68213-23-0	3.00000		
			Butene, homopolymer	9003-29-6	25.00000		

* Total Water Volume sources may include various types of water including fresh water, produced water, and recycled water

** Information is based on the maximum potential for concentration and thus the total may be over 100%

*** If you are calculating a percentage of total ingredients do not add the water volume below the green line to the water volume above the green line

Note: For Field Development Products (products that begin with FDP), MSDS level only information has been provided.

Ingredient information for chemicals subject to 29 CFR 1910.1200(i) and Appendix D are obtained from suppliers Material Safety Data Sheets (MSDS)

RECEIVED
Office of Oil and Gas

APR 24 2023

WV Department of
Environmental Protection