

LATITUDE 39°17'30"

2,245'

LATITUDE 39°17'30"

612' TO BOTTOM HOLE

Antero Resources Corporation Well No. Aspen 2H

NOTES: WELL 2H TOP HOLE INFORMATION: N: 276,993ft E: 1,631,983ft LAT: 39°15'11.52" LON: 80°47'58.54" BOTTOM HOLE INFORMATION: N: 286,646ft E: 1,633,756ft LAT: 39°16'47.18" LON: 80°47'37.79" WEST VIRGINIA COORDINATE SYSTEM OF 1927 NORTH ZONE. ZONE WAS DERIVED FROM MEASUREMENTS TAKEN WITH TRIMBLE GEOXT SUBMETER MAPPING GRADE GPS UNIT. PLAT ORIENTATION, CORNER, AND WELL REFERENCE TIE LINES ARE BASED ON GRID NORTH.

(NAD) 83 (UTM) ZONE 17 COORDS: WELL 2H TOP HOLE INFORMATION: N: 4,344,903m E: 517,306m BOTTOM HOLE INFORMATION: N: 4,347,853m E: 517,797m

(NAD) 27 (UTM) ZONE 17 COORDS: WELL 2H TOP HOLE INFORMATION: N: 14,254,190ft E: 1,697,148ft POINT OF ENTRY INFORMATION: N: 14,255,481ft E: 1,699,924ft BOTTOM HOLE INFORMATION: N: 14,263,867ft E: 1,698,758ft

NOTE: NO OCCUPIED DWELLINGS OR BUILDINGS TWO THOUSAND FIVE HUNDRED (2,500) SQUARE FEET OR LARGER USED TO HOUSE OR SHELTER DAIRY CATTLE OR POULTRY HUSBANDRY ARE LOCATED WITHIN SIX HUNDRED TWENTY-FIVE (625) FEET OF THE CENTER OF THE WELL PAD.

Table listing West Union District parcels (14-02 to 20-14) and their owners, including Alfred Perline, Gail DeBerry, Lisa Meyer, Dennis Hoyes, Marvin Rollins, Glenn Whitehair, Mark Smith, Michael Algranelli, Richard Leggett, Mary Nesler, Danny Harris, Roger Barton, Danny Harris, Constal Forest Resources Co, Doddridge County Board of Education, EQM Gathering OPCO LLC, Russell Nelson, Arnold Creek UB Church, Michael Wilkinson, Loren Smith, EQM Gathering OPCO LLC, Loren Smith, Loren Smith, Jessie Vanscy, Loren Smith, Diane Bennett, CN&G Transmission Corp, Loren Smith, and Mary Sechrist.

GRID NORTH

4,333' TO BOTTOM HOLE

LONGITUDE 80°47'30"

LONGITUDE 80°47'30"

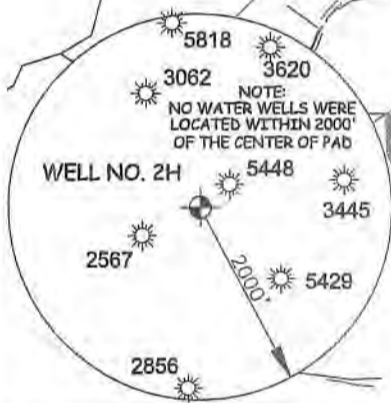

I THE UNDERSIGNED, HEREBY CERTIFY THAT THIS PLAT IS CORRECT TO THE BEST OF MY KNOWLEDGE AND BELIEF AND SHOWS ALL THE INFORMATION REQUIRED BY LAW AND THE RULES ISSUED AND PERSCRIBED BY THE DEPARTMENT OF ENVIRONMENTAL PROTECTION.



STATE OF WEST VIRGINIA, DIVISION OF ENVIRONMENTAL PROTECTION, OFFICE OF OIL AND GAS
WILLOW LAND SURVEYING PLLC
220 MASONIC AVE. PENNSBORO WEST VIRGINIA 26415

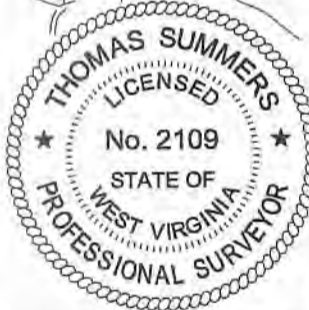

JOB # 19-039WA
DRAWING # ASPEN2H
SCALE 1" = 2000'
MINIMUM DEGREE OF ACCURACY SUBMETER
PROVEN SOURCE OF ELEV. SUBMETER MAPPING GRADE GPS

LEGEND
Surface Owner Boundary Lines +/-
Adjoining Surface Tracts +/-
Found monument, as noted
THOMAS SUMMERS P.S. 2109

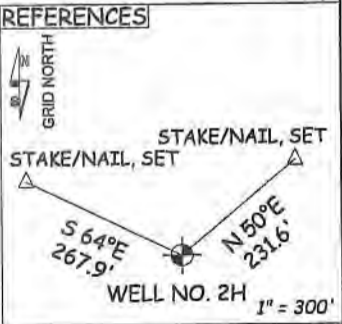
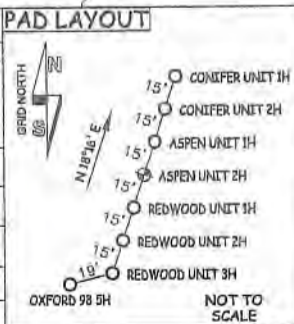

STATE OF WEST VIRGINIA DEPARTMENT OF ENERGY DIVISION OF OIL AND GAS
DATE 08/04/22
OPERATOR'S WELL# ASPEN 2H

WELL TYPE: OIL ___ GAS X LIQUID INJECTION ___ WASTE DISPOSAL ___ 47 - 017 - 06927 MOD
(IF "GAS") PRODUCTION X STORAGE ___ DEEP ___ SHALLOW X STATE COUNTY PERMIT
LOCATION: ELEVATION 1,120' - AS BUILT WATERSHED HEADWATERS MIDDLE ISLAND CREEK
QUADRANGLE WEST UNION 7.5' DISTRICT WEST UNION COUNTY DODDRIDGE
SURFACE OWNER MICHAEL R. BRITTON & ANGELA D. PRATT ACREAGE 136.56 ACRES +/-
OIL & GAS ROYALTY OWNER MICHAEL S. FRANCIS ET AL; RICHARD W. MINNIS ET AL; HARRISON-RITCHIE LEASE ACREAGE 173 AC±; 69 AC±; 17 AC±;
OIL & GAS CO.; JAMES P. GAINES ET AL; JAMES P. GAINES; JAMES P. GAINES ET UX; FRANKLIN L. BUTLER; 14 AC±; 42 AC±; 200 AC±; 109 AC±;
LEWIS MAXWELL ET UX; WM. WOLFE; BENJAMIN F. HEFLIN ET UX; DONALD BARKER ET AL; LAURIE GIVENS 1562 AC±; 50 AC±; 60 AC±; 54.5 AC±; 71.25 AC±
PROPOSED WORK: DRILL ___ CONVERT ___ DRILL DEEPER X REDRILL ___ FRACTURE OR STIMULATE X
PLUG OFF OLD FORMATION ___ PERFORATE NEW FORMATION X OTHER PHYSICAL CHANGE IN WELL
(SPECIFY) MOD-BHL PLUG & ABANDON CLEAN OUT & REPLUG
TARGET FORMATION MARCELLUS ESTIMATED DEPTH 6,600' TVD 20,100' MD
WELL OPERATOR ANTERO RESOURCES CORP. DESIGNATED AGENT DIANNA STAMPER - CT CORPORATION SYSTEM
ADDRESS 1615 WYNKOOP ST. ADDRESS 5400 D BIG TYLER ROAD
FORM WW-6 DENVER, CO 80202 CHARLESTON, WV 25313

09/02/2022

COUNTY NAME

PERMIT