

LATITUDE 39°20'00"

10,779'

896' TO BOTTOM HOLE
LATITUDE 39°20'00"

893' TO BOTTOM HOLE

LONGITUDE 80°45'00"

LONGITUDE 80°42'30"

COUNTY NAME PERMIT

Antero Resources Corporation Well No. Whitehill Unit 1H

- NOTE**
1. NO OCCUPIED DWELLINGS OR BUILDINGS TWO THOUSAND FIVE HUNDRED (2,500) SQUARE FEET OR LARGER USED TO HOUSE OR SHELTER DAIRY CATTLE OR POULTRY HUSBANDRY ARE LOCATED WITHIN SIX HUNDRED TWENTY-FIVE (625) FEET OF THE CENTER OF THE WELL PAD.
 2. TOP HOLE DATA SHOWN HEREON WAS PROVIDED BY ANTERO RESOURCES CORPORATION.
 3. AS DRILLED DATA WAS PROVIDED BY ANTERO RESOURCES CORPORATION.
 4. WLS IS NOT CERTIFYING THE DATA AND INFORMATION PROVIDED LISTED IN NOTES 2 AND 3, ONLY THE RELATIONSHIP TO THE DATA AND INFORMATION PROVIDED TO THE LEASE BOUNDARIES.
 5. WLS IS BY NO MEANS RESPONSIBLE FOR ANY ERRORS OR INACCURACIES WITH THE DATA AND INFORMATION THAT HAS BEEN PROVIDED.

API WELL # 47 - 017 - 06902
STATE COUNTY PERMIT

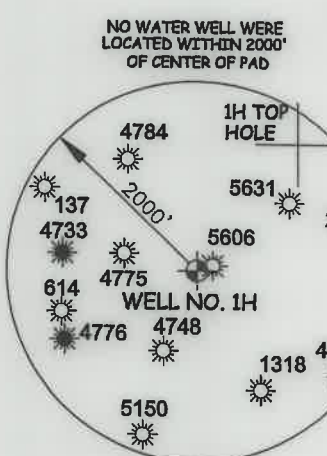
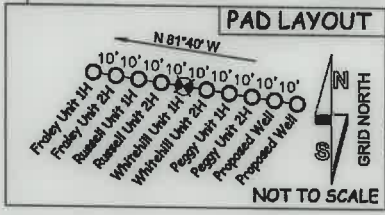

NOTES:

WELL 1H TOP HOLE INFORMATION:
N: 294,994ft E: 1,647,292ft
LAT: 39°18'11.58" LON: 80°44'47.12"

BOTTOM HOLE INFORMATION:
N: 305,096ft E: 1,645,525ft
LAT: 39°19'51.17" LON: 80°45'11.40"

WEST VIRGINIA COORDINATE SYSTEM OF 1927 NORTH ZONE. ZONE WAS DERIVED FROM MEASUREMENTS TAKEN WITH TRIMBLE GEOXT SUBMETER MAPPING GRADE GPS UNIT. PLAT ORIENTATION, CORNER, AND WELL REFERENCE TIE LINES ARE BASED ON GRID NORTH.

(NAD) 83 (UTM) ZONE 17 COORDS:
WELL 1H TOP HOLE INFORMATION:
N: 4,350,466m E: 521,879m
BOTTOM HOLE INFORMATION:
N: 4,353,534m E: 521,289m

WELL 1H POINT OF ENTRY INFORMATION:
N: 295,346ft E: 1,648,435ft
LAT: 39°18'15.21" LON: 80°44'32.66"
N: 4,350,579m E: 522,225m

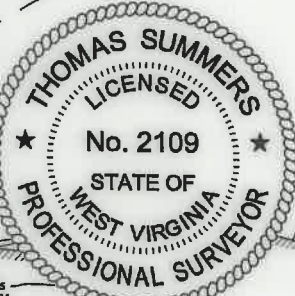

I THE UNDERSIGNED, HEREBY CERTIFY THAT THIS PLAT IS CORRECT TO THE BEST OF MY KNOWLEDGE AND BELIEF AND SHOWS ALL THE INFORMATION REQUIRED BY LAW AND THE RULES ISSUED AND PERSCRIBED BY THE DEPARTMENT OF ENVIRONMENTAL PROTECTION.



STATE OF WEST VIRGINIA, DIVISION OF ENVIRONMENTAL PROTECTION, OFFICE OF OIL AND GAS
WILLOW LAND SURVEYING PLLC
220 MASONIC AVE. PENNSBORO WEST VIRGINIA 26415

JOB # 19-036WA
DRAWING # WHITEHILL1HAD
SCALE 1" = 1000'
MINIMUM DEGREE OF ACCURACY SUBMETER
PROVEN SOURCE OF ELEV. SUBMETER MAPPING GRADE GPS

LEGEND

- Surface Owner Boundary Lines +/-
- Interior Surface Tracts +/-
- Proposed Well Path
- As Drilled Well Path

THOMAS SUMMERS P.S. 2109
DATE 08/03/21
OPERATOR'S WELL# WHITEHILL UNIT #1H

STATE OF WEST VIRGINIA DEPARTMENT OF ENERGY DIVISION OF OIL AND GAS
WELL TYPE: OIL ___ GAS LIQUID INJECTION ___ WASTE DISPOSAL ___
(IF "GAS") PRODUCTION STORAGE ___ DEEP ___ SHALLOW
LOCATION: ELEVATION 1,275' - AS BUILT WATERSHED HEADWATERS MIDDLE ISLAND CREEK
QUADRANGLE SH - SMITHBURG 7.5 BH - WEST UNION 7.5 DISTRICT WEST UNION COUNTY DODDRIDGE
SURFACE OWNER SAMUEL AND PEGGY SMITH ACREAGE 28.956 ACRES +/-
OIL & GAS ROYALTY OWNER ELAINE DEBOLT; R.L. BARNES ET UX; DIANA JEAN PARRISH;

CHARLES N. WELCH ET AL.; D.L. DOTSON ET UX; CAROL A. THOMAS; DEBORAH S. ARMSTRONG ET VIR; ROBERT E. SWART; 84.8 ACRES±; 85.92 ACRES±; 58 ACRES±; 27.5 ACRES±; 27.5 ACRES±; 21 ACRES±
NANCY BOOMER ET VIR; LENA E. CHRISTMAN; CLARENCE W. MUTSCHELKNAUS ET AL.; ELIZABETH WETZEL; ROMINE; ELIZABETH WETZEL; ROMINE 84 ACRES±; 39 ACRES±; 96 ACRES±; 80 ACRES±; 266.17 ACRES±

PROPOSED WORK: DRILL ___ CONVERT ___ DRILL DEEPER ___ REDRILL ___ FRACTURE OR STIMULATE ___
PLUG OFF OLD FORMATION ___ PERFORATE NEW FORMATION ___ OTHER PHYSICAL CHANGE IN WELL ___
(SPECIFY) AS DRILLED PLUG & ABANDON ___ CLEAN OUT & REPLUG ___
TARGET FORMATION MARCELLUS ESTIMATED DEPTH 7,085' TVD 17,580' MD

WELL OPERATOR ANTERO RESOURCES CORP. ADDRESS 1615 WYNKOOP STREET DENVER, CO 80202
DESIGNATED AGENT DIANNA STAMPER CT CORPORATION SYSTEM 5400 D BIG TYLER ROAD CHARLESTON, WV 25313

10/01/2021

