

State of West Virginia  
Department of Environmental Protection - Office of Oil and Gas  
Well Operator's Report of Well Work

API 47-017-06902 County Doddridge Tyler District West Union  
Quad Smithburg 7.5' Pad Name Peggy June Field/Pool Name ----  
Farm name Samuel and Peggy Smith Well Number Whitehill Unit 1H  
Operator (as registered with the OOG) Antero Resources Corporation  
Address 1615 Wynkoop Street City Denver State CO Zip 80202

As Drilled location NAD 83/UTM Attach an as-drilled plat, profile view, and deviation survey  
Top hole Northing 4350466m Easting 521879m  
Landing Point of Curve Northing 4350654.90m Easting 522181.47m  
Bottom Hole Northing 4353534m Easting 521289m

Elevation (ft) 1275' GL Type of Well  New  Existing Type of Report  Interim  Final  
Permit Type  Deviated  Horizontal  Horizontal 6A  Vertical Depth Type  Deep  Shallow  
Type of Operation  Convert  Deepen  Drill  Plug Back  Redrilling  Rework  Stimulate  
Well Type  Brine Disposal  CBM  Gas  Oil  Secondary Recovery  Solution Mining  Storage  Other \_\_\_\_\_  
Type of Completion  Single  Multiple Fluids Produced  Brine  Gas  NGL  Oil  Other \_\_\_\_\_  
Drilled with  Cable  Rotary

Drilling Media Surface hole  Air  Mud  Fresh Water Intermediate hole  Air  Mud  Fresh Water  Brine  
Production hole  Air  Mud  Fresh Water  Brine

Mud Type(s) and Additive(s)

Air - Foam & 4% KCL

Mud - Polymer

Date permit issued 1/28/2020 Date drilling commenced 2/15/2020 Date drilling ceased 1/31/2021  
Date completion activities began 4/5/2021 Date completion activities ceased 4/30/2021  
Verbal plugging (Y/N) N/A Date permission granted N/A Granted by N/A

RECEIVED  
Office of Oil and Gas

Please note: Operator is required to submit a plugging application within 5 days of verbal permission to plug

AUG 30 2021

Freshwater depth(s) ft 320' Open mine(s) (Y/N) depths No  
Salt water depth(s) ft 1603' Void(s) encountered (Y/N) depths No  
Coal depth(s) ft 1601' Cavern(s) encountered (Y/N) depths No  
Is coal being mined in area (Y/N) No

Reviewed

Reviewed by:

SDW  
9/8/21  
10/01/2021

API 47-017 - 06902 Farm name Samuel and Peggy Smith Well number Whitehill Unit 1H

CASING STRINGS	Hole Size	Casing Size	Depth	New or Used	Grade wt/ft	Basket Depth(s)	Did cement circulate (Y/ N) * Provide details below*
Conductor	24"	20"	80'	New	94#, H-40	N/A	Y
Surface	17-1/2"	13-3/8"	433'	New	54.5#, J-55	N/A	Y
Coal							
Intermediate 1	12-1/4"	9-5/8"	2575'	New	36#, K-55	N/A	Y
Intermediate 2							
Intermediate 3							
Production	8-3/4"/8-1/2"	5-1/2"	17485'	New	20#, P-110	N/A	Y
Tubing		2-3/8"	7329'		4.7#, P-110		
Packer type and depth set		N/A					

Comment Details \_\_\_\_\_

CEMENT DATA	Class/Type of Cement	Number of Sacks	Slurry wt (ppg)	Yield (ft <sup>3</sup> /sks)	Volume (ft <sup>3</sup> )	Cement Top (MD)	WOC (hrs)
Conductor	Class A	285 sx	15.6	1.20	60	0'	8 Hrs.
Surface	Class A	368 sx	15.6	1.20	79	0'	8 Hrs.
Coal							
Intermediate 1	Class A	878 sx	15.6	1.19	186	0'	8 Hrs.
Intermediate 2							
Intermediate 3							
Production	Class H	792 sx (Lead) 2490 sx (Tail)	13.5 (Lead), 15.2(Tail)	1.4 (Lead), 1.16 (Tail)	584	~500' into Intermediate Casing	8 Hrs.
Tubing							

Drillers TD (ft) 17580' MD, 7085' TVD (BHL), 7085' (Deepest Point Drilled) Loggers TD (ft) 17580' MD  
 Deepest formation penetrated Marcellus Plug back to (ft) N/A  
 Plug back procedure N/A

Kick off depth (ft) 6353'

Check all wireline logs run  caliper  density  deviated/directional  induction  
 neutron  resistivity  gamma ray  temperature  sonic

Well cored  Yes  No Conventional Sidewall Were cuttings collected  Yes  No

DESCRIBE THE CENTRALIZER PLACEMENT USED FOR EACH CASING STRING \_\_\_\_\_

Conductor - 0  
 Surface - 1 above guide shoe, 1 above insert float, 1 every 4th joint to surface  
 Intermediate - 1 above float joint, 1 above float collar, 1 every 4th joint to surface  
 Production - 1 above float joint, 1 below float collar, 1 every 3rd joint to top of cement

RECEIVED  
Office of Oil and Gas

AUG 30 2021

WAS WELL COMPLETED AS SHOT HOLE  Yes  No DETAILS \_\_\_\_\_

WV Department of Environmental Protection

WAS WELL COMPLETED OPEN HOLE?  Yes  No DETAILS \_\_\_\_\_

WERE TRACERS USED  Yes  No TYPE OF TRACER(S) USED N/A

10/01/2021



API 47- 017 - 06902 Farm name Samuel and Peggy Smith Well number Whitehill Unit 1H

PRODUCING FORMATION(S)	DEPTHS	
Marcellus	6934' (TOP) TVD	7366' (TOP) MD

Please insert additional pages as applicable.

GAS TEST  Build up  Drawdown  Open Flow OIL TEST  Flow  Pump

SHUT-IN PRESSURE Surface 2800 psi Bottom Hole --- psi DURATION OF TEST --- hrs

OPEN FLOW Gas 8051 mcfpd Oil 76 bpd NGL --- bpd Water 27 bpd  
GAS MEASURED BY  Estimated  Orifice  Pilot

LITHOLOGY/ FORMATION	TOP		BOTTOM		DESCRIBE ROCK TYPE AND RECORD QUANTITY AND TYPE OF FLUID (FRESHWATER, BRINE, OIL, GAS, H <sub>2</sub> S, ETC)
	DEPTH IN FT NAME TVD	DEPTH IN FT TVD	DEPTH IN FT MD	DEPTH IN FT MD	

**\*PLEASE SEE ATTACHED EXHIBIT 3**

RECEIVED  
Office of Oil and Gas  
AUG 30 2021  
WV Department of  
Environmental Protection

Please insert additional pages as applicable.

Drilling Contractor H & P Drilling  
Address 912 N Eagle Valley Rd City Howard State PA Zip 16841

Logging Company Nine Energy Services  
Address 6500 West Fwy City Fort Worth State TX Zip 76116

Cementing Company Halliburton Energy Services  
Address 300 W. Sam Houston Pkwy City Houston State TX Zip 76114

Stimulating Company Halliburton Energy Services  
Address 3000 W. Sam Houston Pkwy City Houston State TX Zip 76114

Please insert additional pages as applicable.

Completed by Brandi Hankins Telephone 303-357-7223  
Signature [Signature] Title Completions Technician Date 8/27/2021

Submittal of Hydraulic Fracturing Chemical Disclosure Information Attach copy of FRACFOCUS Registry

10/01/2021

API 47-017-06902 Farm Name Samuel and Peggy Smith Well Number Whitehill Unit 1H

Stage No.	Perforation Date	Perforated from MD ft.	Perforated to MD ft.	Number of Perforations	Formations
1	4/5/2021	17418	17374	36	Marcellus
2	4/5/2021	17333.45357	17122.175	36	Marcellus
3	4/5/2021	17084.62857	16873.35	36	Marcellus
4	4/5/2021	16835.80357	16624.525	36	Marcellus
5	4/6/2021	16586.97857	16375.7	36	Marcellus
6	4/6/2021	16338.15357	16126.875	36	Marcellus
7	4/6/2021	16089.32857	15878.05	36	Marcellus
8	4/6/2021	15840.50357	15629.225	36	Marcellus
9	4/7/2021	15591.67857	15380.4	36	Marcellus
10	4/7/2021	15342.85357	15131.575	36	Marcellus
11	4/7/2021	15094.02857	14882.75	36	Marcellus
12	4/7/2021	14845.20357	14633.925	36	Marcellus
13	4/7/2021	14596.37857	14385.1	36	Marcellus
14	4/8/2021	14347.55357	14136.275	36	Marcellus
15	4/8/2021	14098.72857	13887.45	36	Marcellus
16	4/8/2021	13849.90357	13638.625	36	Marcellus
17	4/8/2021	13601.07857	13389.8	36	Marcellus
18	4/8/2021	13352.25357	13140.975	36	Marcellus
19	4/9/2021	13103.42857	12892.15	36	Marcellus
20	4/9/2021	12854.60357	12643.325	36	Marcellus
21	4/9/2021	12605.77857	12394.5	36	Marcellus
22	4/9/2021	12356.95357	12145.675	36	Marcellus
23	4/9/2021	12108.12857	11896.85	36	Marcellus
24	4/10/2021	11859.30357	11648.025	36	Marcellus
25	4/10/2021	11610.47857	11399.2	36	Marcellus
26	4/10/2021	11361.65357	11150.375	36	Marcellus
27	4/10/2021	11112.82857	10901.55	36	Marcellus
28	4/10/2021	10864.00357	10652.725	36	Marcellus
29	4/11/2021	10615.17857	10403.9	36	Marcellus
30	4/11/2021	10366.35357	10155.075	36	Marcellus
31	4/11/2021	10117.52857	9906.25	36	Marcellus
32	4/11/2021	9868.703571	9657.425	36	Marcellus
33	4/11/2021	9619.878571	9408.6	36	Marcellus
34	4/12/2021	9371.053571	9159.775	36	Marcellus
35	4/12/2021	9122.228571	8910.95	36	Marcellus
36	4/12/2021	8873.403571	8662.125	36	Marcellus
37	4/12/2021	8624.578571	8413.3	36	Marcellus
38	4/12/2021	8375.753571	8164.475	36	Marcellus
39	4/13/2021	8126.928571	7915.65	36	Marcellus
40	4/13/2021	7878.103571	7666.825	36	Marcellus
41	4/13/2021	7629.278571	7418	36	Marcellus

RECEIVED  
Office of Oil and Gas  
AUG 31 2021  
WV Department of  
Environmental Protection

10/01/2021



**EXHIBIT 2**

Stage No.	Stimulations Date	Avg Pump Rate	Avg Treatment Pressure (PSI)	Max Breakdown Pressure (PSI)	ISIP (PSI)	Amount of Proppant (lbs)	Amount of Water (bbls)	Amount of Nitrogen/ other (units)
1	4/5/2021	65.46	8596	8577	4083	176458	213627	N/A
2	4/5/2021	81.64	8637	5495	3853	499680	377527	N/A
3	4/5/2021	85.42	8661	5781	4273	499570	376374	N/A
4	4/5/2021	80.92	8455	5913	7050	499168	374296	N/A
5	4/6/2021	81.18	8384	5582	4173	499630	369416	N/A
6	4/6/2021	87.27	8750	5507	4306	503547	372985	N/A
7	4/6/2021	89.84	8798	5841	3976	508480	359084	N/A
8	4/6/2021	80.93	8611	4620	3752	496400	366611	N/A
9	4/7/2021	82.92	8657	7681	3679	500789	358236	N/A
10	4/7/2021	89.76	8776	7245	4331	507523	355679	N/A
11	4/7/2021	91.23	8757	6016	4400	496640	351491	N/A
12	4/7/2021	90.41	8733	5975	4408	501880	352615	N/A
13	4/7/2021	91.22	8685	6769	3796	500208	361707	N/A
14	4/8/2021	90.01	8672	7346	3724	500323	353840	N/A
15	4/8/2021	93.38	8707	7949	4185	499903	346758	N/A
16	4/8/2021	97.62	8647	5726	4264	500140	348720	N/A
17	4/8/2021	95.46	8607	5287	4379	499720	353846	N/A
18	4/8/2021	95.01	8780	8402	3919	499318	356043	N/A
19	4/9/2021	98.27	8790	8548	3933	499747	359470	N/A
20	4/9/2021	97.07	8731	8157	4223	506402	356234	N/A
21	4/9/2021	98.09	8668	4937	4398	500400	356639	N/A
22	4/9/2021	97	8588	5806	4329	496540	354918	N/A
23	4/9/2021	97.7	8698	7122	3576	499414	349764	N/A
24	4/10/2021	97.33	8688	6834	3948	502758	353662	N/A
25	4/10/2021	94.91	8675	6225	4571	499988	348493	N/A
26	4/10/2021	98.17	8576	5598	4390	499620	353906	N/A
27	4/10/2021	95.58	8631	5741	4096	499560	350846	N/A
28	4/10/2021	93.67	8241	6509	3983	499592	351604	N/A
29	4/11/2021	97.9	8556	7192	4195	499761	334936	N/A
30	4/11/2021	98.89	8538	4909	4140	499382	345003	N/A
31	4/11/2021	98.81	8225	5981	4072	505180	349655	N/A
32	4/11/2021	98.61	8285	5448	4153	496700	350187	N/A
33	4/11/2021	98.11	7965	7067	4120	499637	346952	N/A
34	4/12/2021	97.4	7831	5017	4313	503408	385532	N/A
35	4/12/2021	98.65	7721	5540	4211	499487	363387	N/A
36	4/12/2021	99.33	7738	5670	4366	502689	364246	N/A
37	4/12/2021	98.83	7859	5844	4621	499569	364111	N/A
38	4/12/2021	96.42	7718	6718	4211	499762	362465	N/A
39	4/13/2021	99.2	7715	6539	4489	500165	361943	N/A
40	4/13/2021	99.17	7590	5763	4189	499477	360357	N/A
41	4/13/2021	99.97	7368	5648	3992	502600	360190	N/A
	AVG=	93	8,422	6,305	4,221	20,201,215	14,531,355	TOTAL

**EXHIBIT 3**

LITHOLOGY/ FORMATION	TOP DEPTH (TVD)	BOTTOM DEPTH (TVD)	TOP DEPTH (MD)	BOTTOM DEPTH (MD)
	From Surface	From Surface	From Surface	From Surface
Shaley Siltstone	120	210	120	210
Shale	210	390	210	390
Silty Shale	390	480	390	480
Shale	480	810	480	810
Silty Shale	810	840	810	840
Shaley Sandstone	840	960	840	960
Shaley Sandstone	960	1,050	960	1,050
Shale	1,050	1,110	1,050	1,110
Sandy Shale	1,110	1,230	1,110	1,230
Shaley Sandstone	1,230	1,290	1,230	1,290
Sandstone, Tr Shale, Tr Silt	1,290	1,710	1,290	1,710
Shaley Sandstone, Occ Coal	1,710	1,890	1,710	1,890
Sandy Shale, Tr Coal, Tr Limestone	1,890	2,143	1,890	2,148
Big Lime	2,173	2,767	2,178	2,773
Fifty Foot Sandstone	2,767	2,858	2,773	2,864
Gordon	2,858	3,140	2,864	3,151
Fifth Sandstone	3,140	3,338	3,151	3,357
Bayard	3,338	3,972	3,357	4,029
Speechley	3,972	4,278	4,029	4,351
Balltown	4,278	4,666	4,351	4,762
Bradford	4,666	5,145	4,762	5,269
Benson	5,145	5,451	5,269	5,592
Alexander	5,451	6,728	5,592	6,959
Sycamore	6,480	6,698	6,685	6,929
Middlesex	6,698	6,841	6,929	7,141
Burkett	6,841	6,871	7,141	7,201
Tully	6,871	6,934	7,201	7,366
Marcellus	6,934	NA	7,366	NA

\*Please note Antero determines formation tops based on mud logs that are only run on one well on a multi-well pad. The measured depth (MD) data on subsequent wells may be slightly different due to the well's unique departure.

RECEIVED  
Office of Oil and Gas

AUG 30 2021

WV Department of  
Environmental Protection

10/01/2021

# Hydraulic Fracturing Fluid Product Component Information Disclosure

Job Start Date:	4/5/2021
Job End Date:	4/13/2021
State:	West Virginia
County:	Doddridge
API Number:	47-017-06902-00-00
Operator Name:	Antero Resources Corporation
Well Name and Number:	WHITEHILL UNIT 1H
Latitude:	39.30321700
Longitude:	-80.74643000
Datum:	NAD83
Federal Well:	NO
Indian Well:	NO
True Vertical Depth:	7,081
Total Base Water Volume (gal):	15,078,777
Total Base Non Water Volume:	0



## Hydraulic Fracturing Fluid Composition:

Trade Name	Supplier	Purpose	Ingredients	Chemical Abstract Service Number (CAS #)	Maximum Ingredient Concentration in Additive (% by mass)**	Maximum Ingredient Concentration in HF Fluid (% by mass)**	Comments
Produced Water Mixture	Halliburton	Base Fluid					
			Water	7732-18-5	100.00000	86.26679	Density = 8.50
Ingredients	Listed Above	Listed Above					
			Water	7732-18-5	100.00000	0.05737	

RECEIVED  
 Office of Oil and Gas  
 WV Department of Environmental Protection  
 AUG 20 2021



FLUID Enviro-Syn HCR-7000-WL	Fluid Energy Group	Acid Replacement					
				Listed Below			
Excelerate LX-15	Halliburton	Friction Reducer					
				Listed Below			
HAI-501	Halliburton	Acid Corrosion Inhibitor					
				Listed Below			
MC B-8614A	MultiChem	Biocide					
				Listed Below			
Sand-Common White-100 Mesh, SSA-2	Halliburton	Proppant					
				Listed Below			
OPTIFLO-II DELAYED RELEASE BREAKER	Halliburton	Breaker					
				Listed Below			
HYDROCHLORIC ACID, 22 BAUME	Halliburton	Solvent					
				Listed Below			
WG-36 GELLING AGENT	Halliburton	Gelling Agent					
				Listed Below			

RECEIVED  
 Office of Oil and Gas  
 WV Department of Environmental Protection  
 AUG 30 2021

Items above are Trade Names with the exception of Base Water . Items below are the individual ingredients.

		Crystalline silica, quartz	14808-60-7	100.00000	13.59679
		Complex Amine Compound	Proprietary	60.00000	0.03059
		Hydrotreated light petroleum distillate	64742-47-8	30.00000	0.01530
		Proprietary	Proprietary	20.00000	0.01080
		Hydrochloric acid	7647-01-0	30.00000	0.00555
		Proprietary	Proprietary	10.00000	0.00540
		Guar gum	9000-30-0	100.00000	0.00452
		Sobitan, mono-9-octadecenoate, (Z)	1338-43-8	5.00000	0.00255
		Surfactant	Proprietary	5.00000	0.00255
		Glutaraldehyde	111-30-8	30.00000	0.00248
		Ethoxylated alcohols	Proprietary	5.00000	0.00051
		Alkoxylated polyhydric alcohol	Proprietary	1.00000	0.00051
		Organic chloride compound	Proprietary	1.00000	0.00051
		Alkyl (C12-16) dimethylbenzyl ammonium chloride	68424-85-1	5.00000	0.00041
		Ammonium persulfate	7727-54-0	100.00000	0.00010
		Ethanol	64-17-5	1.00000	0.00008
		Methanol	67-56-1	100.00000	0.00003
		Oxylated phenolic resin	Proprietary	30.00000	0.00003
		Mixture of dimer and trimer fatty acids of indefinite composition derived from tall oil	61790-12-3	30.00000	0.00001
		Modified thiourea polymer	Proprietary	30.00000	0.00001
		Acrylamide	79-06-1	0.01000	0.00001
		Sodium glycolate	2836-32-0	0.01000	0.00001
		Organic salt #2	Proprietary	0.01000	0.00001
		Nitrated acetate salt	Proprietary	0.01000	0.00001

WV Department of  
 Environmental Protection

AIG 30 2011

RECEIVED  
 Office of Oil and Gas

			Formaldehyde	50-00-0	0.01000	0.00001	
			Sodium hydroxide	1310-73-2	0.01000	0.00001	
			Organic salt #1	Proprietary	0.01000	0.00001	
			Hexadecene	629-73-2	5.00000	0.00000	
			Propargyl alcohol	107-19-7	5.00000	0.00000	
			C.I. pigment Orange 5	3468-63-1	1.00000	0.00000	

\* Total Water Volume sources may include various types of water including fresh water, produced water, and recycled water

\*\* Information is based on the maximum potential for concentration and thus the total may be over 100%

\*\*\* If you are calculating a percentage of total ingredients do not add the water volume below the green line to the water volume above the green line

Note: For Field Development Products (products that begin with FDP), MSDS level only information has been provided.

Ingredient information for chemicals subject to 29 CFR 1910.1200(i) and Appendix D are obtained from suppliers Material Safety Data Sheets (MSDS)

RECEIVED  
Office of Oil and Gas  
WV Department of  
Environmental Protection  
AUG 30 2021

LATITUDE 39°20'00"

10,779'

896' TO BOTTOM HOLE  
LATITUDE 39°20'00"

893' TO BOTTOM HOLE

LONGITUDE 80°45'00"

LONGITUDE 80°42'30"

COUNTY NAME

PERMIT

### Antero Resources Corporation Well No. Whitehill Unit 1H

- NOTE**
1. NO OCCUPIED DWELLINGS OR BUILDINGS TWO THOUSAND FIVE HUNDRED (2,500) SQUARE FEET OR LARGER USED TO HOUSE OR SHELTER DAIRY CATTLE OR POULTRY HUSBANDRY ARE LOCATED WITHIN SIX HUNDRED TWENTY-FIVE (625) FEET OF THE CENTER OF THE WELL PAD.
  2. TOP HOLE DATA SHOWN HEREON WAS PROVIDED BY ANTERO RESOURCES CORPORATION.
  3. AS DRILLED DATA WAS PROVIDED BY ANTERO RESOURCES CORPORATION.
  4. WLS IS NOT CERTIFYING THE DATA AND INFORMATION PROVIDED LISTED IN NOTES 2 AND 3, ONLY THE RELATIONSHIP TO THE DATA AND INFORMATION PROVIDED TO THE LEASE BOUNDARIES.
  5. WLS IS BY NO MEANS RESPONSIBLE FOR ANY ERRORS OR INACCURACIES WITH THE DATA AND INFORMATION THAT HAS BEEN PROVIDED.

API WELL # 47 - 017 - 06902  
STATE COUNTY PERMIT

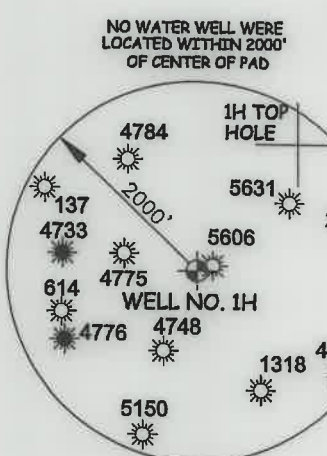
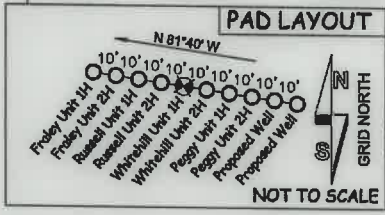

**NOTES:**

WELL 1H TOP HOLE INFORMATION:  
N: 294,994ft E: 1,647,292ft  
LAT: 39°18'11.58" LON: 80°44'47.12"

BOTTOM HOLE INFORMATION:  
N: 305,096ft E: 1,645,525ft  
LAT: 39°19'51.17" LON: 80°45'11.40"

WEST VIRGINIA COORDINATE SYSTEM OF 1927 NORTH ZONE. ZONE WAS DERIVED FROM MEASUREMENTS TAKEN WITH TRIMBLE GEOXT SUBMETER MAPPING GRADE GPS UNIT. PLAT ORIENTATION, CORNER, AND WELL REFERENCE TIE LINES ARE BASED ON GRID NORTH.

(NAD) 83 (UTM) ZONE 17 COORDS:  
WELL 1H TOP HOLE INFORMATION:  
N: 4,350,466m E: 521,879m  
BOTTOM HOLE INFORMATION:  
N: 4,353,534m E: 521,289m

WELL 1H POINT OF ENTRY INFORMATION:  
N: 295,346ft E: 1,648,435ft  
LAT: 39°18'15.21" LON: 80°44'32.66"  
N: 4,350,579m E: 522,225m

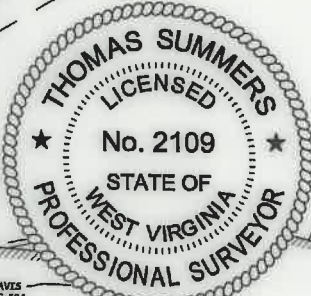

I THE UNDERSIGNED, HEREBY CERTIFY THAT THIS PLAT IS CORRECT TO THE BEST OF MY KNOWLEDGE AND BELIEF AND SHOWS ALL THE INFORMATION REQUIRED BY LAW AND THE RULES ISSUED AND PERSCRIBED BY THE DEPARTMENT OF ENVIRONMENTAL PROTECTION.



STATE OF WEST VIRGINIA, DIVISION OF ENVIRONMENTAL PROTECTION, OFFICE OF OIL AND GAS  
WILLOW LAND SURVEYING PLLC  
220 MASONIC AVE. PENNSBORO WEST VIRGINIA 26415

JOB # 19-036WA  
DRAWING # WHITEHILL1HAD  
SCALE 1" = 1000'  
MINIMUM DEGREE OF ACCURACY SUBMETER  
PROVEN SOURCE OF ELEV. SUBMETER MAPPING GRADE GPS

**LEGEND**

- Surface Owner Boundary Lines +/-
- Interior Surface Tracts +/-
- Proposed Well Path
- As Drilled Well Path

THOMAS SUMMERS P.S. 2109  
DATE 08/03/21  
OPERATOR'S WELL# WHITEHILL UNIT #1H

STATE OF WEST VIRGINIA DEPARTMENT OF ENERGY DIVISION OF OIL AND GAS  
WELL TYPE: OIL \_\_\_ GAS  LIQUID INJECTION \_\_\_ WASTE DISPOSAL \_\_\_  
(IF "GAS") PRODUCTION  STORAGE \_\_\_ DEEP \_\_\_ SHALLOW   
LOCATION: ELEVATION 1,275' - AS BUILT WATERSHED HEADWATERS MIDDLE ISLAND CREEK  
QUADRANGLE SH - SMITHBURG 7.5 BH - WEST UNION 7.5 DISTRICT WEST UNION COUNTY DODDRIDGE  
SURFACE OWNER SAMUEL AND PEGGY SMITH ACREAGE 28.956 ACRES +/-  
OIL & GAS ROYALTY OWNER ELAINE DEBOLT; R.L. BARNES ET UX; DIANA JEAN PARRISH;

CHARLES N. WELCH ET AL.; D.L. DOTSON ET UX; CAROL A. THOMAS; DEBORAH S. ARMSTRONG ET VIR; ROBERT E. SWART; 84.8 ACRES±; 85.92 ACRES±; 58 ACRES±; 27.5 ACRES±; 21 ACRES±; 84 ACRES±; 39 ACRES±; 96 ACRES±; 80 ACRES±; 266.17 ACRES±  
NANCY BOOMER ET VIR; LENA E. CHRISTMAN; CLARENCE W. MUTSCHELKNAUS ET AL.; ELIZABETH WETZEL; ROMINE; ELIZABETH WETZEL; ROMINE  
PROPOSED WORK: DRILL \_\_\_ CONVERT \_\_\_ DRILL DEEPER \_\_\_ REDRILL \_\_\_ FRACTURE OR STIMULATE \_\_\_  
PLUG OFF OLD FORMATION \_\_\_ PERFORATE NEW FORMATION \_\_\_ OTHER PHYSICAL CHANGE IN WELL \_\_\_  
(SPECIFY) AS DRILLED PLUG & ABANDON \_\_\_ CLEAN OUT & REPLUG \_\_\_  
TARGET FORMATION MARCELLUS ESTIMATED DEPTH 7,085' TVD 17,580' MD  
WELL OPERATOR ANTERO RESOURCES CORP. DESIGNATED AGENT DIANNA STAMPER  
ADDRESS 1615 WYNKOOP STREET ADDRESS CT CORPORATION SYSTEM  
FORM WW-6 DENVER, CO 80202 CHARLESTON, WV 25313

10/01/2021