

LATITUDE 39°20'00"

10,789'

6,660' TO BOTTOM HOLE

LATITUDE 39°17'30"

Antero Resources Corporation Well No. Russell Unit 2H

NOTES: WELL 2H TOP HOLE INFORMATION: N: 294,996ft E: 1,647,283ft LAT: 39°18'11.59" LON: 80°44'47.25" BOTTOM HOLE INFORMATION: N: 284,354ft E: 1,651,269ft LAT: 39°16'26.96" LON: 80°43'54.69" WEST VIRGINIA COORDINATE SYSTEM OF 1927 NORTH ZONE. ZONE WAS DERIVED FROM MEASUREMENTS TAKEN WITH TRIMBLE GEOXT SUBMETER MAPPING GRADE GPS UNIT. PLAT ORIENTATION, CORNER, AND WELL REFERENCE TIE LINES ARE BASED ON GRID NORTH.

(NAD) 83 (UTM) ZONE 17 COORDS: WELL 2H TOP HOLE INFORMATION: N: 4,350,466m E: 521,876m BOTTOM HOLE INFORMATION: N: 4,347,244m E: 523,144m

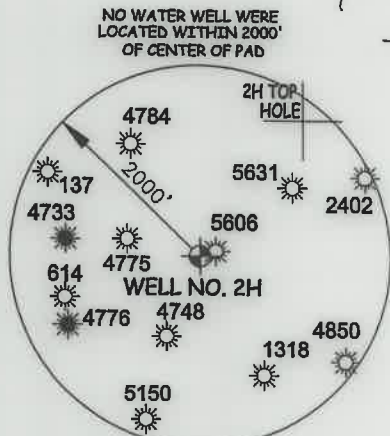
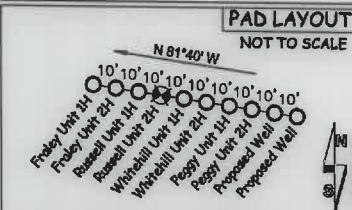

NO WATER WELL WERE LOCATED WITHIN 2000' OF CENTER OF PAD

Table listing landowners and lease numbers for the West Union District - Doddridge County. Includes names like David Sponagle, Michael O'Brien, John Smith, etc.

6,379' TO BOTTOM HOLE

10,968'

LONGITUDE 80°42'30"

LONGITUDE 80°42'30"

I THE UNDERSIGNED, HEREBY CERTIFY THAT THIS PLAT IS CORRECT TO THE BEST OF MY KNOWLEDGE AND BELIEF AND SHOWS ALL THE INFORMATION REQUIRED BY LAW AND THE RULES ISSUED AND PERSCRIBED BY THE DEPARTMENT OF ENVIRONMENTAL PROTECTION.



STATE OF WEST VIRGINIA, DIVISION OF ENVIRONMENTAL PROTECTION, OFFICE OF OIL AND GAS

WILLOW LAND SURVEYING PLLC 220 MASONIC AVE. PENNSBORO WEST VIRGINIA 26415

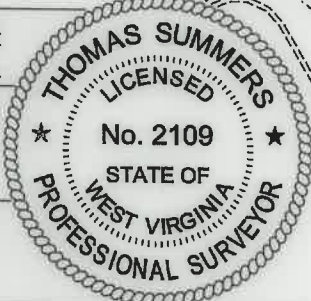

JOB # 19-030WA DRAWING # RUSSELL2HAD SCALE 1" = 2000' MINIMUM DEGREE OF ACCURACY SUBMETER PROVEN SOURCE OF ELEV. SUBMETER MAPPING GRADE GPS

LEGEND: Surface Owner Boundary Lines +/- Interior Surface Tracts +/- Proposed Well Path As Drilled Well Path. Includes signature of Thomas Summers and name THOMAS SUMMERS P.S. 2109.

NOTE: 1. NO OCCUPIED DWELLINGS OR BUILDINGS TWO THOUSAND FIVE HUNDRED (2,500) SQUARE FEET OR LARGER USED TO HOUSE OR SHELTER DAIRY CATTLE OR POULTRY HUSBANDRY ARE LOCATED WITHIN SIX HUNDRED TWENTY-FIVE (625) FEET OF THE CENTER OF THE WELL PAD. 2. TOP HOLE DATA SHOWN HEREON WAS PROVIDED BY ANTERO RESOURCES CORPORATION. 3. AS DRILLED DATA WAS PROVIDED BY ANTERO RESOURCES CORPORATION. 4. WLS IS NOT CERTIFYING THE DATA AND INFORMATION PROVIDED LISTED IN NOTES 2 AND 3, ONLY THE RELATIONSHIP TO THE DATA AND INFORMATION PROVIDED TO THE LEASE BOUNDARIES. 5. WLS IS BY NO MEANS RESPONSIBLE FOR ANY ERRORS OR INACCURACIES WITH THE DATA AND INFORMATION THAT HAS BEEN PROVIDED.

WELL 2H POINT OF ENTRY INFORMATION: N: 295,010ft E: 1,647,876ft LAT: 39°18'11.82" LON: 80°44'39.70" N: 4,350,474m E: 522,056m

STATE OF WEST VIRGINIA DEPARTMENT OF ENERGY DIVISION OF OIL AND GAS

WELL TYPE: OIL GAS X LIQUID INJECTION WASTE DISPOSAL 47 017 06901 (IF "GAS") PRODUCTION X STORAGE DEEP SHALLOW X STATE COUNTY PERMIT LOCATION: ELEVATION 1,275' - AS BUILT WATERSHED HEADWATERS MIDDLE ISLAND CREEK QUADRANGLE SMITHBURG 7.5' DISTRICT WEST UNION COUNTY DODDRIDGE

SURFACE OWNER SAMUEL AND PEGGY SMITH OIL & GAS ROYALTY OWNER ELAINE DEBOLT; R.L. BARNES ET UX; EQT PRODUCTION COMPANY; HARLAND E. SISLER; WVSRA; WVDNR; PATHFINDER RESOURCES, LLC; MARY N. KISSINGER; W.L. DAVIS ET UX; CNX GAS COMPANY LLC; PAULA LAFFERTY ACREAGE 28.956 ACRES +/- 10/01/2021 LEASE ACREAGE 84.8 AC +/- 222 AC +/- 75 AC +/- 7 AC +/- 301.19 AC +/- 54.48 AC +/- 138.58 AC +/- 81.58 AC +/- 265 AC +/- 1.32 AC +/- 44.9 AC +/-

PROPOSED WORK: DRILL CONVERT DRILL DEEPER REDRILL FRACTURE OR STIMULATE PLUG OFF OLD FORMATION PERFORATE NEW FORMATION OTHER PHYSICAL CHANGE IN WELL (SPECIFY) AS DRILLED TARGET FORMATION MARCELLUS PLUG & ABANDON CLEAN OUT & REPLUG

WELL OPERATOR ANTERO RESOURCES CORP. ESTIMATED DEPTH 6,880' TVD 18,460' MD DESIGNATED AGENT DIANNA STAMPER - CT CORPORATION SYSTEM ADDRESS 1615 WYNKOOP ST. DENVER, CO 80202 ADDRESS 5400 D BIG TYLER ROAD CHARLESTON, WV 25313

FORM WW-6

COUNTY NAME PERMIT