

LATITUDE 39°20'00"

10,789'

9,277' TO BOTTOM HOLE

LATITUDE 39°20'00"

Antero Resources Corporation Well No. Russell Unit 2H

NOTES: WELL 2H TOP HOLE INFORMATION: N: 294,995ft E: 1,647,283ft LAT: 39°18'11.59" LON: 80°44'47.25" BOTTOM HOLE INFORMATION: N: 292,230ft E: 1,648,757ft LAT: 39°17'44.45" LON: 80°44'28.01" WEST VIRGINIA COORDINATE SYSTEM OF 1927 NORTH ZONE. ZONE WAS DERIVED FROM MEASUREMENTS TAKEN WITH TRIMBLE GEOXT SUBMETER MAPPING GRADE GPS UNIT. PLAT ORIENTATION, CORNER, AND WELL REFERENCE TIE LINES ARE BASED ON GRID NORTH.

(NAD) 83 (UTM) ZONE 17 COORDS: WELL 2H TOP HOLE INFORMATION: N: 4,350,466m E: 521,876m BOTTOM HOLE INFORMATION: N: 4,349,631m E: 522,339m

PAD LAYOUT NOT TO SCALE

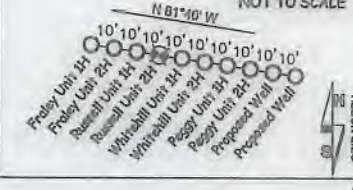

Table listing property owners and lease numbers for the area. Includes names like David Sproule, Michael O'Brien, John Smith, etc., and lease numbers like 08-49, 08-50, 12-08, etc.

WV NORTH ZONE GRID NORTH

13,714' TO BOTTOM HOLE

10,968'

LONGITUDE 80°42'30"

LONGITUDE 80°42'30"

I THE UNDERSIGNED, HEREBY CERTIFY THAT THIS PLAT IS CORRECT TO THE BEST OF MY KNOWLEDGE AND BELIEF AND SHOWS ALL THE INFORMATION REQUIRED BY LAW AND THE RULES ISSUED AND PERSCRIBED BY THE DEPARTMENT OF ENVIRONMENTAL PROTECTION.



STATE OF WEST VIRGINIA, DIVISION OF ENVIRONMENTAL PROTECTION, OFFICE OF OIL AND GAS. WILLOW LAND SURVEYING PLLC 220 MASONIC AVE. PENNSBORO WEST VIRGINIA 26415



JOB # 19-030WA DRAWING # RUSSELL2Hshorty SCALE 1" = 2000' MINIMUM DEGREE OF ACCURACY SUBMETER PROVEN SOURCE OF ELEV. SUBMETER MAPPING GRADE GPS STATE OF WEST VIRGINIA DEPARTMENT OF ENERGY DIVISION OF OIL AND GAS

LEGEND: Surface Owner Boundary Lines +/- Interior Surface Tracts +/- Existing Fence Found monument, as noted THOMAS SUMMERS P.S. 2109 DATE 11/25/19 OPERATOR'S WELL# RUSSELL UNIT #2H

(NAD) 27 (UTM) ZONE 17 COORDS: WELL 2H TOP HOLE INFORMATION: N: 14,272,439ft E: 1,712,140ft POINT OF ENTRY INFORMATION: N: 14,272,523ft E: 1,712,713ft BOTTOM HOLE INFORMATION: N: 14,269,699ft E: 1,713,660ft REFERENCES: 1" = 300' STAKE/ NAIL, SET N 138°34' W 210.3' STAKE/ NAIL, SET N 58°13' E 192.1' WELL NO. 2H

NOTE: NO OCCUPIED DWELLINGS OR BUILDINGS TWO THOUSAND FIVE HUNDRED (2,500) SQUARE FEET OR LARGER USED TO HOUSE OR SHELTER DAIRY CATTLE OR POULTRY HUSBANDRY ARE LOCATED WITHIN SIX HUNDRED TWENTY-FIVE (625) FEET OF THE CENTER OF THE WELL PAD.

WELL TYPE: OIL GAS X LIQUID INJECTION WASTE DISPOSAL 47 017 -06901 (IF "GAS") PRODUCTION X STORAGE DEEP SHALLOW X STATE COUNTY PERMIT LOCATION: ELEVATION 1,275' - AS BUILT WATERSHED HEADWATERS MIDDLE ISLAND CREEK QUADRANGLE SMITHBURG 7.5' DISTRICT WEST UNION COUNTY DODDRIDGE SURFACE OWNER SAMUEL AND PEGGY SMITH ACREAGE 28.956 ACRES +/- OIL & GAS ROYALTY OWNER ELAINE DEBOLT; R.L. BARNES ET UX LEASE ACREAGE 84.8 AC.±; 222 AC.±

PROPOSED WORK: DRILL X CONVERT DRILL DEEPER REDRILL FRACTURE OR STIMULATE X PLUG OFF OLD FORMATION PERFORATE NEW FORMATION X OTHER PHYSICAL CHANGE IN WELL (SPECIFY) PLUG & ABANDON CLEAN OUT & REPLUG TARGET FORMATION MARCELLUS ESTIMATED DEPTH 7,500' TVD 11,500' MD WELL OPERATOR ANTERO RESOURCES CORP. DESIGNATED AGENT DIANNA STAMPER - CT CORPORATION SYSTEM ADDRESS 1615 WYNKOOP ST. ADDRESS 5400 D BIG TYLER ROAD DENVER, CO 80202 CHARLESTON, WV 25313