

State of West Virginia
Department of Environmental Protection - Office of Oil and Gas
Well Operator's Report of Well Work

API 47-017-06900 County Tyler District West Union
Quad Smithburg 7.5' Pad Name Peggy June Field/Pool Name ----
Farm name Samuel and Peggy Smith Well Number Russell Unit 1H
Operator (as registered with the OOG) Antero Resources Corporation
Address 1615 Wynkoop Street City Denver State CO Zip 80202

As Drilled location NAD 83/UTM Attach an as-drilled plat, profile view, and deviation survey
Top hole Northing 4350466m Easting 521873m
Landing Point of Curve Northing 4350313.71m Easting 521771.16m
Bottom Hole Northing 4347406m Easting 522779m

Elevation (ft) 1275' GL Type of Well New Existing Type of Report Interim Final
Permit Type Deviated Horizontal Horizontal 6A Vertical Depth Type Deep Shallow
Type of Operation Convert Deepen Drill Plug Back Redrilling Rework Stimulate
Well Type Brine Disposal CBM Gas Oil Secondary Recovery Solution Mining Storage Other _____
Type of Completion Single Multiple Fluids Produced Brine Gas NGL Oil Other _____
Drilled with Cable Rotary

Drilling Media Surface hole Air Mud Fresh Water Intermediate hole Air Mud Fresh Water Brine
Production hole Air Mud Fresh Water Brine

Mud Type(s) and Additive(s)

Air - Foam & 4% KCL

Mud - Polymer

Date permit issued 1/28/2020 Date drilling commenced 2/22/2020 Date drilling ceased 2/10/2021
Date completion activities began 3/24/2021 Date completion activities ceased 5/7/2021
Verbal plugging (Y/N) N/A Date permission granted N/A Granted by N/A

RECEIVED
Office of Oil and Gas
AUG 30 2021

Please note: Operator is required to submit a plugging application within 5 days of verbal permission to plug

WV Department of
Environmental Protection

Freshwater depth(s) ft 320' Open mine(s) (Y/N) depths No
Salt water depth(s) ft 1603' Void(s) encountered (Y/N) depths No
Coal depth(s) ft 1601' Cavern(s) encountered (Y/N) depths No
Is coal being mined in area (Y/N) No

Reviewed by:

10/01/2021

API 47- 017 - 06900 Farm name Samuel and Peggy Smith Well number Russell Unit 1H

CASING STRINGS	Hole Size	Casing Size	Depth	New or Used	Grade wt/ft	Basket Depth(s)	Did cement circulate (Y/N) * Provide details below*
Conductor	24"	20"	80'	New	94#, H-40	N/A	Y
Surface	17-1/2"	13-3/8"	450'	New	54.5#, J-55	N/A	Y
Coal							
Intermediate 1	12-1/4"	9-5/8"	2581'	New	36#, K-55	N/A	Y
Intermediate 2							
Intermediate 3							
Production	8-3/4"/8-1/2"	5-1/2"	17566'	New	20#, P-110	N/A	Y
Tubing		2-3/8"	7180'		4.7#, P-110		
Packer type and depth set		N/A					

Comment Details _____

CEMENT DATA	Class/Type of Cement	Number of Sacks	Slurry wt (ppg)	Yield (ft ³ /sks)	Volume (ft ³)	Cement Top (MD)	WOC (hrs)
Conductor	Class A	204 sx	15.6	1.20	43	0'	8 Hrs.
Surface	Class A	368 sx	15.6	1.20	79	0'	8 Hrs.
Coal							
Intermediate 1	Class A	878 sx	15.6	1.19	186	0'	8 Hrs.
Intermediate 2							
Intermediate 3							
Production	Class H	792 sx (Lead) 2515 sx (Tail)	13.5 (Lead), 15.2(Tail)	1.4 (Lead), 1.32 (Tail)	590	-500' Into Intermediate Casing	8 Hrs.
Tubing							

Drillers TD (ft) 17616' MD, 6896' TVD (BHL), 7002' (Deepest Point Drilled) Loggers TD (ft) 17616' MD
 Deepest formation penetrated Marcellus Plug back to (ft) N/A
 Plug back procedure N/A

Kick off depth (ft) 6192'

Check all wireline logs run caliper density deviated/directional induction
 neutron resistivity gamma ray temperature sonic

Well cored Yes No Conventional Sidewall Were cuttings collected Yes No

DESCRIBE THE CENTRALIZER PLACEMENT USED FOR EACH CASING STRING _____

Conductor - 0
 Surface - 1 above guide shoe, 1 above insert float, 1 every 4th joint to surface
 Intermediate - 1 above float joint, 1 above float collar, 1 every 4th joint to surface
 Production - 1 above float joint, 1 below float collar, 1 every 3rd joint to top of cement

RECEIVED
Office of Oil and Gas

AUG 30 2021

WV Department of Environmental Protection

WAS WELL COMPLETED AS SHOT HOLE Yes No DETAILS _____

WAS WELL COMPLETED OPEN HOLE? Yes No DETAILS _____

WERE TRACERS USED Yes No TYPE OF TRACER(S) USED N/A

API 47- 017 - 06900 Farm name Samuel and Peggy Smith Well number Russell Unit 1H

PRODUCING FORMATION(S)	DEPTHS		
	6916' (TOP)	TVD	7200' (TOP) MD
Marcellus			

Please insert additional pages as applicable.

GAS TEST Build up Drawdown Open Flow OIL TEST Flow Pump

SHUT-IN PRESSURE Surface 2800 psi Bottom Hole --- psi DURATION OF TEST --- hrs

OPEN FLOW Gas 7504 mcfpd Oil 29 bpd NGL --- bpd Water 27 bpd GAS MEASURED BY Estimated Orifice Pilot

LITHOLOGY/ FORMATION	TOP		BOTTOM		DESCRIBE ROCK TYPE AND RECORD QUANTITY AND TYPE OF FLUID (FRESHWATER, BRINE, OIL, GAS, H ₂ S, ETC)
	DEPTH IN FT NAME TVD	DEPTH IN FT TVD	DEPTH IN FT MD	DEPTH IN FT MD	

***PLEASE SEE ATTACHED EXHIBIT 3**

Please insert additional pages as applicable.

Drilling Contractor H & P Drilling
Address 912 N Eagle Valley Rd City Howard State PA Zip 16841 RECEIVED Office of Oil and Gas

Logging Company Nine Energy Services
Address 6500 West Fwy City Fort Worth State TX Zip 76116 AUG 30 2021

Cementing Company Halliburton Energy Services
Address 300 W. Sam Houston Pkwy City Houston State TX Zip 76114 WV Department of Environmental Protection

Stimulating Company Halliburton Energy Services
Address 3000 W. Sam Houston Pkwy City Houston State TX Zip 76114

Please insert additional pages as applicable.

Completed by Brandi Hankins Telephone 303-357-7223
Signature [Signature] Title Completions Technician Date 8/27/21

Submission of Hydraulic Fracturing Chemical Disclosure Information Attach copy of FRACFOCUS Registry

10/01/2021

API 47-017-06900 Farm Name Samuel and Peggy Smith Well Number Russell Unit 1H

Stage No.	Perforation Date	Perforated from MD ft.	Perforated to MD ft.	Number of Perforations	Formations
1		17497	17452	36	Marcellus
2		17411.47038	17200.2927	36	Marcellus
3	3/25/2021	17162.76307	16951.5854	36	Marcellus
4	3/26/2021	16914.05575	16702.878	36	Marcellus
5	3/26/2021	16665.34843	16454.1707	36	Marcellus
6	3/26/2021	16416.64111	16205.4634	36	Marcellus
7	3/27/2021	16167.9338	15956.7561	36	Marcellus
8	3/27/2021	15919.22648	15708.0488	36	Marcellus
9	3/27/2021	15670.51916	15459.3415	36	Marcellus
10	3/27/2021	15421.81185	15210.6341	36	Marcellus
11	3/27/2021	15173.10453	14961.9268	36	Marcellus
12	3/28/2021	14924.39721	14713.2195	36	Marcellus
13	3/28/2021	14675.6899	14464.5122	36	Marcellus
14	3/28/2021	14426.98258	14215.8049	36	Marcellus
15	3/29/2021	14178.27526	13967.0976	36	Marcellus
16	3/29/2021	13929.56794	13718.3902	36	Marcellus
17	3/29/2021	13680.86063	13469.6829	36	Marcellus
18	3/29/2021	13432.15331	13220.9756	36	Marcellus
19	3/29/2021	13183.44599	12972.2683	36	Marcellus
20	3/30/2021	12934.73868	12723.561	36	Marcellus
21	3/30/2021	12686.03136	12474.8537	36	Marcellus
22	3/30/2021	12437.32404	12226.1463	36	Marcellus
23	3/30/2021	12188.61672	11977.439	36	Marcellus
24	3/31/2021	11939.90941	11728.7317	36	Marcellus
25	3/31/2021	11691.20209	11480.0244	36	Marcellus
26	3/31/2021	11442.49477	11231.3171	36	Marcellus
27	3/31/2021	11193.78746	10982.6098	36	Marcellus
28	4/1/2021	10945.08014	10733.9024	36	Marcellus
29	4/1/2021	10696.37282	10485.1951	36	Marcellus
30	4/1/2021	10447.66551	10236.4878	36	Marcellus
31	4/1/2021	10198.95819	9987.78049	36	Marcellus
32	4/1/2021	9950.250871	9739.07317	36	Marcellus
33	4/2/2021	9701.543554	9490.36585	36	Marcellus
34	4/2/2021	9452.836237	9241.65854	36	Marcellus
35	4/2/2021	9204.12892	8992.95122	36	Marcellus
36	4/2/2021	8955.421603	8744.2439	36	Marcellus
37	4/3/2021	8706.714286	8495.53659	36	Marcellus
38	4/3/2021	8458.006969	8246.82927	36	Marcellus
39	4/3/2021	8209.299652	7998.12195	36	Marcellus
40	4/3/2021	7960.592334	7749.41463	36	Marcellus
41	4/4/2021	7711.885017	7500.70732	36	Marcellus
42	4/4/2021	7463.1777	7252	36	Marcellus

RECEIVED
 Office of Oil and Gas
 AUG 9 2021
 WV Department of Environmental Protection

10/01/2021

EXHIBIT 2

Stage No.	Stimulations Date	Avg Pump Rate	Avg Treatment Pressure (PSI)	Max Breakdown Pressure (PSI)	ISIP (PSI)	Amount of Proppant (lbs)	Amount of Water (bbls)	Amount of Nitrogen/ other (units)
1								N/A
2								N/A
3	3/25/2021	78.3	8445	6151	4303	373140	270771	N/A
4	3/26/2021	84.35	8630	5449	5154	424840	309465	N/A
5	3/26/2021	88.36	8563	5467	4826	499313	383441	N/A
6	3/26/2021	85.07	8788	5532	4332	499745	374810	N/A
7	3/27/2021	87.51	8785	5228	4213	499420	373213	N/A
8	3/27/2021	86.35	8842	5262	3994	499597	375446	N/A
9	3/27/2021	87.64	8772	5655	3718	499366	364165	N/A
10	3/27/2021	89.53	8821	4538	4182	499729	358545	N/A
11	3/27/2021	87.26	8779	4315	4749	499540	362279	N/A
12	3/28/2021	86.78	8785	5595	4678	499310	364280	N/A
13	3/28/2021	90.96	8809	5208	4338	499513	358795	N/A
14	3/28/2021	88.9	8857	5802	4383	499302	356811	N/A
15	3/29/2021	88.86	8803	5721	4226	500340	359076	N/A
16	3/29/2021	89.11	8755	5048	4604	499840	356928	N/A
17	3/29/2021	95.91	8779	5399	4588	499465	360579	N/A
18	3/29/2021	93.23	8764	5326	4648	499659	358422	N/A
19	3/29/2021	92.75	8803	5142	4332	499680	360482	N/A
20	3/30/2021	90.51	8759	5765	3961	499940	357263	N/A
21	3/30/2021	94.36	8699	5003	4780	501230	365441	N/A
22	3/30/2021	93.83	8773	5615	4300	499415	363557	N/A
23	3/30/2021	89.98	8628	5846	3921	498717	339282	N/A
24	3/31/2021	88.3	8694	4277	4276	502458	356597	N/A
25	3/31/2021	93.35	8656	5620	4470	499648	354246	N/A
26	3/31/2021	96.57	8697	5828	4285	499605	372703	N/A
27	3/31/2021	94.45	8459	5228	4658	499352	364910	N/A
28	4/1/2021	96.94	8669	5571	4450	499277	366897	N/A
29	4/1/2021	94.34	8668	5795	4249	499582	371527	N/A
30	4/1/2021	90.31	8098	5729	5090	499705	371139	N/A
31	4/1/2021	96.62	8572	5375	4885	499344	375887	N/A
32	4/1/2021	99.18	8615	5920	4564	499680	363691	N/A
33	4/2/2021	98.43	8570	5922	4382	503748	368151	N/A
34	4/2/2021	97.71	8205	5720	5026	499705	377130	N/A
35	4/2/2021	98.83	8282	4661	4560	499620	373162	N/A
36	4/2/2021	98	8174	5636	4385	498368	366451	N/A
37	4/3/2021	98.35	8034	5111	4049	499540	359221	N/A
38	4/3/2021	97.68	7907	5943	4498	500165	376318	N/A
39	4/3/2021	97.31	7949	5563	4285	499896	373378	N/A
40	4/3/2021	98.73	8015	5938	4466	500145	366738	N/A
41	4/4/2021	98.7	7964	5579	4493	499488	365812	N/A
42	4/4/2021	99.67	7839	5872	3950	501110	363333	N/A
	AVG=	93	8,543	5,459	4,431	19,791,537	14,460,343	TOTAL

10/01/2021

EXHIBIT 3

LITHOLOGY/ FORMATION	TOP DEPTH (TVD)	BOTTOM DEPTH (TVD)	TOP DEPTH (MD)	BOTTOM DEPTH (MD)
	From Surface	From Surface	From Surface	From Surface
Shaley Siltstone	120	210	120	210
Shale	210	390	210	390
Silty Shale	390	480	390	480
Shale	480	810	480	810
Silty Shale	810	840	810	840
Shaley Sandstone	840	960	840	960
Shaley Sandstone	960	1,050	960	1,050
Shale	1,050	1,110	1,050	1,110
Sandy Shale	1,110	1,230	1,110	1,230
Shaley Sandstone	1,230	1,290	1,230	1,290
Sandstone, Tr Shale, Tr Silt	1,290	1,710	1,290	1,710
Shaley Sandstone, Occ Coal	1,710	1,890	1,710	1,890
Sandy Shale, Tr Coal, Tr Limestone	1,890	2,144	1,890	2,148
Big Lime	2,174	2,774	2,178	2,779
Fifty Foot Sandstone	2,774	2,859	2,779	2,865
Gordon	2,859	3,145	2,865	3,152
Fifth Sandstone	3,145	3,345	3,152	3,355
Bayard	3,345	3,992	3,355	4,011
Speechley	3,992	4,282	4,011	4,305
Balltown	4,282	4,661	4,305	4,690
Bradford	4,661	5,157	4,690	5,191
Benson	5,157	5,464	5,191	5,503
Alexander	5,464	6,720	5,503	6,811
Sycamore	6,479	6,690	6,539	6,781
Middlesex	6,690	6,831	6,781	6,991
Burkett	6,831	6,858	6,991	7,048
Tully	6,858	6,916	7,048	7,200
Marcellus	6,916	NA	7,200	NA

*Please note Antero determines formation tops based on mud logs that are only run on one well on a multi-well pad. The measured depth (MD) data on subsequent wells may be slightly different due to the well's unique departure.

RECEIVED
Office of Oil and Gas

AUG 30 2021

WV Department of
Environmental Protection

10/01/2021

Hydraulic Fracturing Fluid Product Component Information Disclosure

Job Start Date:	3/25/2021
Job End Date:	4/4/2021
State:	West Virginia
County:	Doddridge
API Number:	47-017-06900-00-00
Operator Name:	Antero Resources Corporation
Well Name and Number:	RUSSELL UNIT 1H
Latitude:	39.30322000
Longitude:	-80.74649000
Datum:	NAD83
Federal Well:	NO
Indian Well:	NO
True Vertical Depth:	7,002
Total Base Water Volume (gal):	14,954,840
Total Base Non Water Volume:	0



Hydraulic Fracturing Fluid Composition:

Trade Name	Supplier	Purpose	Ingredients	Chemical Abstract Service Number (CAS #)	Maximum Ingredient Concentration in Additive (% by mass)**	Maximum Ingredient Concentration in HF Fluid (% by mass)**	Comments
Produced Water Mixture	Halliburton	Base Fluid					
			Water	7732-18-5	100.00000	86.41855	Density = 8.50
Ingredients	Listed Above	Listed Above					
			Water	7732-18-5	100.00000	0.05210	

RECEIVED
 Office of Oil and Gas
 WV Department of Environmental Protection
 AUG 30 2021

HYDROCHLORIC ACID, 22 BAUME	Halliburton	Solvent					
				Listed Below			
OPTIFLO-II DELAYED RELEASE BREAKER	Halliburton	Breaker					
				Listed Below			
MC B-8614A	MultiChem	Biocide					
				Listed Below			
WG-36 GELLING AGENT	Halliburton	Gelling Agent					
				Listed Below			
FLUID Enviro-Syn HCR-7000-WL	Fluid Energy Group	Acid Replacement					
				Listed Below			
Sand-Common White-100 Mesh, SSA-2	Halliburton	Proppant					
				Listed Below			
Excelerate LX-15	Halliburton	Friction Reducer					
				Listed Below			
HAI-501	Halliburton	Acid Corrosion Inhibitor					
				Listed Below			

RECEIVED
 Office of Oil and Gas
 WV Department of Environmental Protection
 AUG 30 2021

Items above are Trade Names with the exception of Base Water . Items below are the individual ingredients.

			Crystalline silica, quartz	14808-60-7	100.00000	13.45507
			Complex Amine Compound	Proprietary	60.00000	0.02496
			Hydrotreated light petroleum distillate	64742-47-8	30.00000	0.01248
			Proprietary	Proprietary	20.00000	0.01060
			Hydrochloric acid	7647-01-0	30.00000	0.00559
			Proprietary	Proprietary	10.00000	0.00530
			Guar gum	9000-30-0	100.00000	0.00453
			Glutaraldehyde	111-30-8	30.00000	0.00255
			Sobitan, mono-9-octadecenoate, (Z)	1338-43-8	5.00000	0.00208
			Surfactant	Proprietary	5.00000	0.00208
			Alkyl (C12-16) dimethylbenzyl ammonium chloride	68424-85-1	5.00000	0.00042
			Ethoxylated alcohols	Proprietary	5.00000	0.00042
			Organic chloride compound	Proprietary	1.00000	0.00042
			Alkoxyated polyhydric alcohol	Proprietary	1.00000	0.00042
			Ammonium persulfate	7727-54-0	100.00000	0.00010
			Ethanol	64-17-5	1.00000	0.00008
			Methanol	67-56-1	100.00000	0.00003
			Oxylated phenolic resin	Proprietary	30.00000	0.00003
			Modified thiourea polymer	Proprietary	30.00000	0.00001
			Mixture of dimer and trimer fatty acids of indefinite composition derived from tall oil	61790-12-3	30.00000	0.00001
			Organic salt #2	Proprietary	0.01000	0.00000
			Sodium hydroxide	1310-73-2	0.01000	0.00000
			Organic salt #1	Proprietary	0.01000	0.00000
			Acrylamide	79-06-1	0.01000	0.00000

RECEIVED
 Office of Oil and Gas
 AUG 30 2021
 WV Department of Environmental Protection

			Sodium glycolate	2836-32-0	0.01000	0.00000	
			Formaldehyde	50-00-0	0.01000	0.00000	
			Nitrated acetate salt	Proprietary	0.01000	0.00000	
			Propargyl alcohol	107-19-7	5.00000	0.00000	
			Hexadecene	629-73-2	5.00000	0.00000	
			C.I. pigment Orange 5	3468-63-1	1.00000	0.00000	

* Total Water Volume sources may include various types of water including fresh water, produced water, and recycled water

** Information is based on the maximum potential for concentration and thus the total may be over 100%

*** If you are calculating a percentage of total ingredients do not add the water volume below the green line to the water volume above the green line

Note: For Field Development Products (products that begin with FDP), MSDS level only information has been provided.

Ingredient information for chemicals subject to 29 CFR 1910.1200(i) and Appendix D are obtained from suppliers Material Safety Data Sheets (MSDS)

RECEIVED
 Office of Oil and Gas
 WV Department of
 Environmental Protection
 AUG 30 2021

LATITUDE 39°20'00"

10,799'

LATITUDE 39°17'30" 7,858' TO BOTTOM HOLE

Antero Resources Corporation Well No. Russell Unit 1H

NOTES: WELL 1H TOP HOLE INFORMATION: N: 294,997ft E: 1,647,273ft LAT: 39°18'11.60" LON: 80°44'47.38" BOTTOM HOLE INFORMATION: N: 284,906ft E: 1,650,078ft LAT: 39°16'32.25" LON: 80°44'09.92" WEST VIRGINIA COORDINATE SYSTEM OF 1927 NORTH ZONE. ZONE WAS DERIVED FROM MEASUREMENTS TAKEN WITH TRIMBLE GEOXT SUBMETER MAPPING GRADE GPS UNIT. PLAT ORIENTATION, CORNER, AND WELL REFERENCE TIE LINES ARE BASED ON GRID NORTH.

(NAD) 83 (UTM) ZONE 17 COORDS: WELL 1H TOP HOLE INFORMATION: N: 4,350,466m E: 521,873m BOTTOM HOLE INFORMATION: N: 4,347,406m E: 522,779m

PAD LAYOUT NOT TO SCALE



NO WATER WELL WERE LOCATED WITHIN 2000' OF CENTER OF PAD

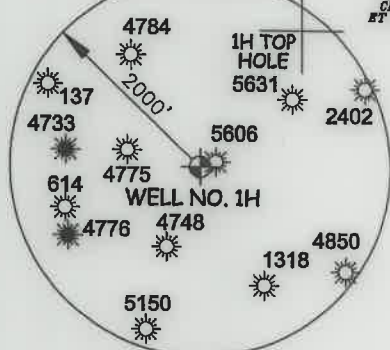

Table listing well numbers and owners in the West Union District - Doddridge County, including names like David Sponagle, Michael O'Brien, John Smith, etc.

5,843' TO BOTTOM HOLE LONGITUDE 80°42'30"

10,967' LONGITUDE 80°42'30"

I THE UNDERSIGNED, HEREBY CERTIFY THAT THIS PLAT IS CORRECT TO THE BEST OF MY KNOWLEDGE AND BELIEF AND SHOWS ALL THE INFORMATION REQUIRED BY LAW AND THE RULES ISSUED AND PERSCRIBED BY THE DEPARTMENT OF ENVIRONMENTAL PROTECTION.



STATE OF WEST VIRGINIA, DIVISION OF ENVIRONMENTAL PROTECTION, OFFICE OF OIL AND GAS

WILLOW LAND SURVEYING PLLC 220 MASONIC AVE. PENNSBORO WEST VIRGINIA 26415

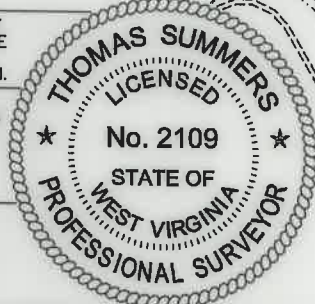

JOB # 19-030WA

DRAWING # RUSSELL1HAD

SCALE 1" = 2000'

MINIMUM DEGREE OF ACCURACY SUBMETER

PROVEN SOURCE OF ELEV. SUBMETER MAPPING GRADE GPS

STATE OF WEST VIRGINIA DEPARTMENT OF ENERGY DIVISION OF OIL AND GAS

LEGEND: Surface Owner Boundary Lines +/-, Interior Surface Tracts +/-, Proposed Well Path, As Drilled Well Path

THOMAS SUMMERS P.S. 2109

DATE 08/03/21 OPERATOR'S WELL# RUSSELL UNIT #1H

NOTE: 1. NO OCCUPIED DWELLINGS OR BUILDINGS TWO THOUSAND FIVE HUNDRED (2,500) SQUARE FEET OR LARGER USED TO HOUSE OR SHELTER DAIRY CATTLE OR POULTRY HUSBANDRY ARE LOCATED WITHIN SIX HUNDRED TWENTY-FIVE (625) FEET OF THE CENTER OF THE WELL PAD. 2. TOP HOLE DATA SHOWN HEREON WAS PROVIDED BY ANTERO RESOURCES CORPORATION. 3. AS DRILLED DATA WAS PROVIDED BY ANTERO RESOURCES CORPORATION. 4. WLS IS NOT CERTIFYING THE DATA AND INFORMATION PROVIDED LISTED IN NOTES 2 AND 3, ONLY THE RELATIONSHIP TO THE DATA AND INFORMATION PROVIDED TO THE LEASE BOUNDARIES. 5. WLS IS BY NO MEANS RESPONSIBLE FOR ANY ERRORS OR INACCURACIES WITH THE DATA AND INFORMATION THAT HAS BEEN PROVIDED.

WELL 1H POINT OF ENTRY INFORMATION: N: 294,786ft E: 1,646,907ft LAT: 39°18'09.46" LON: 80°44'51.99" N: 4,350,400m E: 521,762m

WELL TYPE: OIL ___ GAS X LIQUID INJECTION ___ WASTE DISPOSAL ___ 47 - 017 - 06900 (IF "GAS") PRODUCTION X STORAGE ___ DEEP ___ SHALLOW X

LOCATION: ELEVATION 1,275' - AS BUILT WATERSHED HEADWATERS MIDDLE ISLAND CREEK QUADRANGLE SMITHBURG 7.5 DISTRICT WEST UNION COUNTY DODDRIDGE

SURFACE OWNER SAMUEL AND PEGGY SMITH ACREAGE 28.956 ACRES +/-

OIL & GAS ROYALTY OWNER ELAINE DEBOLT; CAROLYN ROBISON ET AL; R.L. BARNES ET UX; AMERICAN ENERGY-MARCELLUS MINERALS, LLC LEASE ACREAGE 84.8 AC +/- 26 AC +/- 222 AC +/-

C.M. TATE ET UX; THOMAS L. BARNES ET UX; WVDNR; WVSRA; EQT PRODUCTION COMPANY; 102 AC +/- 9 AC +/- 54.48 AC +/- 301.19 AC +/- 75 AC +/-

ALTON J. CHILDERS ET AL; PATHFINDER RESOURCES, LLC; MARY N. KISSINGER; W.L. DAVIS ET UX 99 AC +/- 136.58 AC +/- 61.58 AC +/- 265 AC +/-

PROPOSED WORK: DRILL ___ CONVERT ___ DRILL DEEPER ___ REDRILL ___ FRACTURE OR STIMULATE ___

(SPECIFY) AS DRILLED PLUG & ABANDON CLEAN OUT & REPLUG

TARGET FORMATION MARCELLUS ESTIMATED DEPTH 6,896' TVD 17,616' MD

WELL OPERATOR ANTERO RESOURCES CORP. DESIGNATED AGENT DIANNA STAMPER - CT CORPORATION SYSTEM

ADDRESS 1615 WYNNKOOP ST. ADDRESS 5400 D BIG TYLER ROAD

FORM WW-6 DENVER, CO 80202 CHARLESTON, WV 25313

COUNTY NAME PERMIT