

LATITUDE 39°20'00"

10,749'

LATITUDE 39°17'30" 4,319' TO BOTTOM HOLE

Antero Resources Corporation Well No. Peggy Unit 2H

NOTES: WELL 2H TOP HOLE INFORMATION: N: 294,990ft E: 1,647,322ft LAT: 39°18'11.54" LON: 80°44'46.74" BOTTOM HOLE INFORMATION: N: 283,711ft E: 1,653,602ft LAT: 39°16'20.92" LON: 80°43'24.91" WEST VIRGINIA COORDINATE SYSTEM OF 1927 NORTH ZONE. ZONE WAS DERIVED FROM MEASUREMENTS TAKEN WITH TRIMBLE GEOXT SUBMETER MAPPING GRADE GPS UNIT. PLAT ORIENTATION, CORNER, AND WELL REFERENCE TIE LINES ARE BASED ON GRID NORTH.

(NAD) 83 (UTM) ZONE 17 COORDS: WELL 2H TOP HOLE INFORMATION: N: 4,350,464m E: 521,888m BOTTOM HOLE INFORMATION: N: 4,347,060m E: 523,858m

WELL 2H POINT OF ENTRY INFORMATION: N: 295,558ft E: 1,649,847ft LAT: 39°18'17.50" LON: 80°44'14.73" N: 4,350,651m E: 522,654m

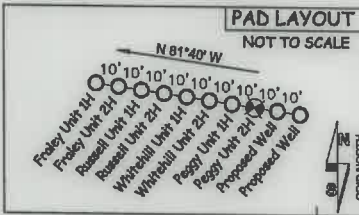

NO WATER WELL WERE LOCATED WITHIN 2000' OF CENTER OF PAD

2H TOP HOLE

Table listing leaseholders and acreage for West Union District - Doddridge County. Includes names like David Spengler, Michael O'Brien, John Smith, etc.

6,990' TO BOTTOM HOLE

LONGITUDE 80°42'30"

LONGITUDE 80°42'30"

I THE UNDERSIGNED, HEREBY CERTIFY THAT THIS PLAT IS CORRECT TO THE BEST OF MY KNOWLEDGE AND BELIEF AND SHOWS ALL THE INFORMATION REQUIRED BY LAW AND THE RULES ISSUED AND PERSCRIBED BY THE DEPARTMENT OF ENVIRONMENTAL PROTECTION.



STATE OF WEST VIRGINIA, DIVISION OF ENVIRONMENTAL PROTECTION, OFFICE OF OIL AND GAS

WILLOW LAND SURVEYING PLLC 220 MASONIC AVE. PENNSBORO WEST VIRGINIA 26415

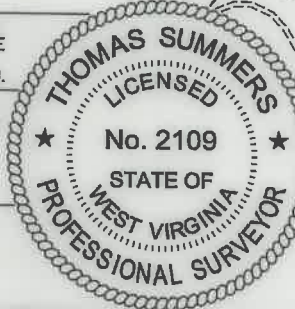

- A = BRYAN E. HAGEDORN ET UX
B = WILLIAM M. SMITH
C = MARK A. OWENS
D = ALBIN HART ET UX
E = ALBIN HART ET UX
F = VIRGINIA LEE NICHOLSON
G = CASSANDRA DAWN EWING

JOB # 19-029WA
DRAWING # PEGGY2HAD
SCALE 1" = 2000'
MINIMUM DEGREE OF ACCURACY SUBMETER
PROVEN SOURCE OF ELEV. SUBMETER MAPPING GRADE GPS

LEGEND: Surface Owner Boundary Lines +/-, Interior Surface Tracts +/-, Proposed Well Path, As Drilled Well Path. Includes signature of Thomas Summers.

NOTE: 1. NO OCCUPIED DWELLINGS OR BUILDINGS TWO THOUSAND FIVE HUNDRED (2,500) SQUARE FEET OR LARGER USED TO HOUSE OR SHELTER DAIRY CATTLE OR POULTRY HUSBANDRY ARE LOCATED WITHIN SIX HUNDRED TWENTY-FIVE (625) FEET OF THE CENTER OF THE WELL PAD.

Table listing leaseholders and acreage for New Milton District - Doddridge County. Includes names like Elwood Rill, Patrick Price, etc.

STATE OF WEST VIRGINIA DEPARTMENT OF ENERGY DIVISION OF OIL AND GAS
WELL TYPE: OIL GAS X LIQUID INJECTION WASTE DISPOSAL 47 017 06899
(IF "GAS") PRODUCTION X STORAGE DEEP SHALLOW X STATE COUNTY PERMIT
LOCATION: ELEVATION 1,275' - AS BUILT WATERSHED HEADWATERS MIDDLE ISLAND CREEK
QUADRANGLE SMITHBURG 7.5 DISTRICT WEST UNION COUNTY DODDRIIDGE

SURFACE OWNER SAMUEL AND PEGGY SMITH
OIL & GAS ROYALTY OWNER ELAINE DEBOLT; R. L. BARNES ET UX; V. B. CHAPMAN ET UX; R. L. BARNES ET UX;
JOAN M. STUTLER ET AL; E. C. JONES ET AL; SPENCER ENTERPRISES LLC; WYDOH; WVSRA; WVDNR; CASSANDRA DAWN EWING;
NEIL JONES HARSHBARGER; SUSAN H. JONES; GEN HOLDINGS LLC; A.E. FITZWILLIAMS ET AL; KENNETH KOEBE; ROBERT L. MOORE ET AL
ACREAGE 28.956 ACRES +/- 10701/2021
LEASE ACREAGE 84.8 AC +/- 222 AC +/- 156 AC +/- 15.86 AC +/-
100 AC +/- 390 AC +/- 9.91 AC +/- 38.5 AC +/- 301.19 AC +/- 777 AC +/- 2.28 AC +/-
69 AC +/- 36 AC +/- 27.63 AC +/- 138.5 AC +/- 27.94 AC +/- 95.12 AC +/-
PROPOSED WORK: DRILL CONVERT DRILL DEEPER REDRILL FRACTURE OR STIMULATE
PLUG OFF OLD FORMATION PERFORATE NEW FORMATION OTHER PHYSICAL CHANGE IN WELL
(SPECIFY) AS DRILLED
TARGET FORMATION MARCELLUS PLUG & ABANDON CLEAN OUT & REPLUG
WELL OPERATOR ANTERO RESOURCES CORP. ESTIMATED DEPTH 6,900' TVD 20,152' MD
ADDRESS 1615 WYNKOOP ST. DESIGNATED AGENT DIANNA STAMPER - CT CORPORATION SYSTEM
FORM WW-6 DENVER, CO 80202 ADDRESS 5400 D BIG TYLER ROAD CHARLESTON, WV 25313