

LATITUDE 39°20'00"

10,808'

1,270' TO BOTTOM HOLE
LATITUDE 39°20'00"

2,539' TO BOTTOM HOLE

10,966'

LONGITUDE 80°45'00"

LONGITUDE 80°42'30"

Antero Resources Corporation
Well No. Fraley Unit 2H

- NOTE**
1. NO OCCUPIED DWELLINGS OR BUILDINGS TWO THOUSAND FIVE HUNDRED (2,500) SQUARE FEET OR LARGER USED TO HOUSE OR SHELTER DAIRY CATTLE OR POULTRY HUSBANDRY ARE LOCATED WITHIN SIX HUNDRED TWENTY-FIVE (625) FEET OF THE CENTER OF THE WELL PAD.
 2. TOP HOLE DATA SHOWN HEREBY WAS PROVIDED BY ANTERO RESOURCES CORPORATION.
 3. AS DRILLED DATA WAS PROVIDED BY ANTERO RESOURCES CORPORATION.
 4. WLS IS NOT CERTIFYING THE DATA AND INFORMATION PROVIDED LISTED IN NOTES 2 AND 3, ONLY THE RELATIONSHIP TO THE DATA AND INFORMATION PROVIDED TO THE LEASE BOUNDARIES.
 5. WLS IS BY NO MEANS RESPONSIBLE FOR ANY ERRORS OR INACCURACIES WITH THE DATA AND INFORMATION THAT HAS BEEN PROVIDED.

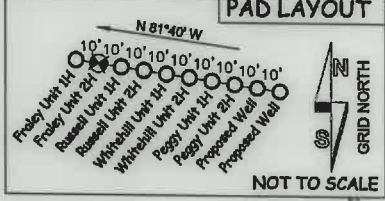

NO WATER WELL WERE LOCATED WITHIN 2000' OF CENTER OF PAD

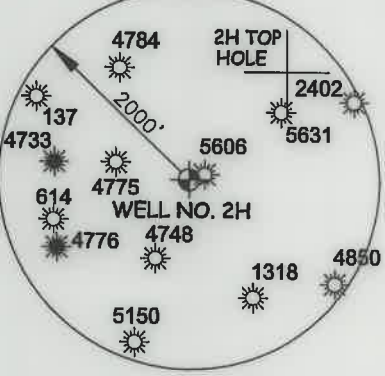

NOTES:

WELL 2H TOP HOLE INFORMATION:
N: 294,998ft E: 1,647,263ft
LAT: 39°18'11.61" LON: 80°44'47.50"

BOTTOM HOLE INFORMATION:
N: 303,456ft E: 1,645,126ft
LAT: 39°19'34.91" LON: 80°45'16.16"

WEST VIRGINIA COORDINATE SYSTEM OF 1927 NORTH ZONE. ZONE WAS DERIVED FROM MEASUREMENTS TAKEN WITH TRIMBLE GEOXT SUBMETER MAPPING GRADE GPS UNIT. PLAT ORIENTATION, CORNER, AND WELL REFERENCE TIE LINES ARE BASED ON GRID NORTH.

(NAD) 83 (UTM) ZONE 17 COORDS:
WELL 2H TOP HOLE INFORMATION:
N: 4,350,467m E: 521,870m
BOTTOM HOLE INFORMATION:
N: 4,353,032m E: 521,176m

WELL 2H POINT OF ENTRY INFORMATION:
N: 295,162ft E: 1,647,603ft
LAT: 39°18'13.27" LON: 80°44'43.20"
N: 4,350,518m E: 521,972m

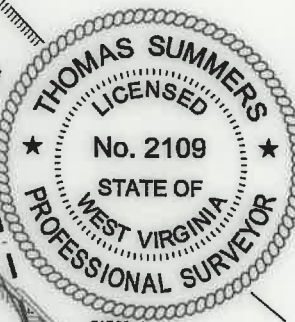

I THE UNDERSIGNED, HEREBY CERTIFY THAT THIS PLAT IS CORRECT TO THE BEST OF MY KNOWLEDGE AND BELIEF AND SHOWS ALL THE INFORMATION REQUIRED BY LAW AND THE RULES ISSUED AND PERSCRIBED BY THE DEPARTMENT OF ENVIRONMENTAL PROTECTION.



STATE OF WEST VIRGINIA, DIVISION OF ENVIRONMENTAL PROTECTION, OFFICE OF OIL AND GAS

WILLOW LAND SURVEYING PLLC
220 MASONIC AVE. PENNSBORO
WEST VIRGINIA 26415

JOB # 17-024WA
DRAWING # FRALEY2HAD
SCALE 1" = 1000'
MINIMUM DEGREE OF ACCURACY SUBMETER
PROVEN SOURCE OF ELEV. SUBMETER MAPPING GRADE GPS

LEGEND

- Surface Owner Boundary Lines +/-
- Interior Surface Tracts +/-
- Proposed Well Path
- As Drilled Well Path

THOMAS SUMMERS P.S. 2109

STATE OF WEST VIRGINIA DEPARTMENT OF ENERGY DIVISION OF OIL AND GAS

DATE 08/03/21
OPERATOR'S WELL# FRALEY UNIT #2H

WELL TYPE: OIL <input type="checkbox"/> GAS <input checked="" type="checkbox"/> LIQUID INJECTION <input type="checkbox"/> WASTE DISPOSAL <input type="checkbox"/>	API WELL #	47	017	06897
(IF "GAS") PRODUCTION <input checked="" type="checkbox"/> STORAGE <input type="checkbox"/> DEEP <input type="checkbox"/> SHALLOW <input checked="" type="checkbox"/>	STATE	WEST	COUNTY	DODDRIDGE
LOCATION: ELEVATION 1,275' - AS BUILT	WATERSHED	HEADWATERS MIDDLE ISLAND CREEK	DISTRICT	WEST UNION
SURFACE OWNER SAMUEL AND PEGGY SMITH	ACREAGE	28.956 ACRES +/-	DATE	10/01/2021
OIL & GAS ROYALTY OWNER ELAINE DEBOLT; R. L. BARNES ET UX;	LEASE ACREAGE	84.8 ACRES +/-	222 ACRES +/-	
D.L. DOTSON ET UX; DEBORAH S. ARMSTRONG ET VIR;		58 ACRES +/-	27.5 ACRES +/-	
NANCY BOOMER ET VIR; CLARENCE W. MUTSCHELKNAUS ET AL		84 ACRES +/-	96 ACRES +/-	
PROPOSED WORK: DRILL <input type="checkbox"/> CONVERT <input type="checkbox"/> DRILL DEEPER <input type="checkbox"/> REDRILL <input type="checkbox"/> FRACTURE OR STIMULATE <input type="checkbox"/>	PLUG OFF OLD FORMATION <input type="checkbox"/>	PERFORATE NEW FORMATION <input type="checkbox"/>	OTHER PHYSICAL CHANGE IN WELL (SPECIFY) AS DRILLED	
TARGET FORMATION MARCELLUS	PLUG & ABANDON <input type="checkbox"/>	CLEAN OUT & REPLUG <input type="checkbox"/>		
WELL OPERATOR ANTERO RESOURCES CORP.	DESIGNATED AGENT	DIANNA STAMPER	CT CORPORATION SYSTEM	
ADDRESS 1615 WYNKOOP STREET	ADDRESS	5400 D BIG TYLER ROAD	CHARLESTON, WV 25313	
FORM WW-6	DENVER, CO 80202			

COUNTY NAME PERMIT