

LATITUDE 39°20'00"

10,818'

216' TO BOTTOM HOLE  
LATITUDE 39°20'00"

LONGITUDE 80°45'00"

10,965'

8,694' TO BOTTOM HOLE

LONGITUDE 80°42'30"

**Antero Resources Corporation**  
**Well No. Fraley Unit 1H**

**NOTES:**  
**WELL 1H TOP HOLE INFORMATION:**  
 N: 295,000ft E: 1,647,253ft  
 LAT: 39°18'11.63" LON: 80°44'47.63"  
**BOTTOM HOLE INFORMATION:**  
 N: 297,287ft E: 1,646,096ft  
 LAT: 39°18'34.07" LON: 80°45'02.75"  
**WEST VIRGINIA COORDINATE SYSTEM OF 1927 NORTH ZONE. ZONE WAS DERIVED FROM MEASUREMENTS TAKEN WITH TRIMBLE GEOXT SUBMETER MAPPING GRADE GPS UNIT. PLAT ORIENTATION, CORNER, AND WELL REFERENCE TIE LINES ARE BASED ON GRID NORTH.**

**(NAD) 83 (UTM) ZONE 17 COORDS:**  
**WELL 1H TOP HOLE INFORMATION:**  
 N: 4,350,467m E: 521,867m  
**BOTTOM HOLE INFORMATION:**  
 N: 4,351,158m E: 521,902m

**(NAD) 27 (UTM) ZONE 17 COORDS:**  
**WELL 1H TOP HOLE INFORMATION:**  
 N: 14,272,443ft E: 1,712,110ft  
**POINT OF ENTRY INFORMATION:**  
 N: 14,272,356ft E: 1,711,659ft  
**BOTTOM HOLE INFORMATION:**  
 N: 14,274,709ft E: 1,710,915ft

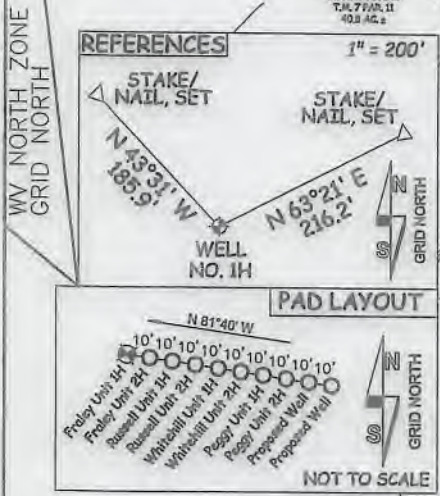
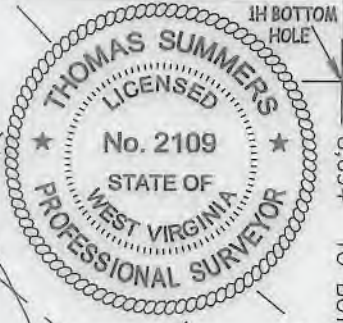

I THE UNDERSIGNED, HEREBY CERTIFY THAT THIS PLAT IS CORRECT TO THE BEST OF MY KNOWLEDGE AND BELIEF AND SHOWS ALL THE INFORMATION REQUIRED BY LAW AND THE RULES ISSUED AND PERSCRIBED BY THE DEPARTMENT OF ENVIRONMENTAL PROTECTION.



STATE OF WEST VIRGINIA, DIVISION OF ENVIRONMENTAL PROTECTION, OFFICE OF OIL AND GAS  
 WILLOW LAND SURVEYING PLLC  
 220 MASONIC AVE. PENNSBORO WEST VIRGINIA 26415

JOB # 17-024WA  
 DRAWING # FRALEY1Hahory  
 SCALE 1" = 1000'  
 MINIMUM DEGREE OF ACCURACY SUBMETER  
 PROVEN SOURCE OF ELEV. SUBMETER MAPPING GRADE GPS  
 STATE OF WEST VIRGINIA DEPARTMENT OF ENERGY DIVISION OF OIL AND GAS

**LEGEND**  
 - - - Surface Owner Boundary Lines +/-  
 - - - Interior Surface Tracts +/-  
 X Existing Fence  
 ⊕ Found monument, as noted

THOMAS SUMMERS P.S. 2109  
 DATE 11/25/19  
 OPERATOR'S WELL# FRALEY UNIT #1H

WELL TYPE: OIL \_\_\_ GAS X LIQUID INJECTION \_\_\_ WASTE DISPOSAL \_\_\_  
 (IF "GAS") PRODUCTION X STORAGE \_\_\_ DEEP \_\_\_ SHALLOW X  
 LOCATION: ELEVATION 1,275' - AS BUILT WATERSHED HEADWATERS MIDDLE ISLAND CREEK  
 QUADRANGLE SH - SMITHBURG 7.5' BH - WEST UNION 7.5' DISTRICT WEST UNION COUNTY DODDRIDGE  
 SURFACE OWNER SAMUEL AND PEGGY SMITH ACREAGE 28.956 ACRES +/-  
 OIL & GAS ROYALTY OWNER ELAINE DEBOLT; CAROLYN ROBISON ET AL; DAVID E. SPONAUGLE ET UX; JIM SPENCER LEASE ACREAGE 84.8 ACRES±; 26 ACRES±; 14.75 ACRES±; 20.16 ACRES±

API WELL # 47-017-06896  
 STATE COUNTY PERMIT

PROPOSED WORK: DRILL X CONVERT \_\_\_ DRILL DEEPER \_\_\_ REDRILL \_\_\_ FRACTURE OR STIMULATE X  
 PLUG OFF OLD FORMATION \_\_\_ PERFORATE NEW FORMATION X OTHER PHYSICAL CHANGE IN WELL (SPECIFY) \_\_\_  
 TARGET FORMATION MARCELLUS ESTIMATED DEPTH 7,400' TVD 10,825' MD  
 WELL OPERATOR ANTERO RESOURCES CORP. DESIGNATED AGENT DIANNA STAMPER  
 ADDRESS 1615 WYNKOOP STREET ADDRESS CT CORPORATION SYSTEM  
 FORM WW-6 DENVER, CO 80202 ADDRESS 5400 D BIG TYLER ROAD CHARLESTON, WV 25313

