

LATITUDE 39°20'00"

7,127'

10,546' TO BOTTOM HOLE

LATITUDE 39°22'30"

Antero Resources Corporation Well No. Laser Unit 4H

AS DRILLED DATA: WELL 4H TOP HOLE INFORMATION: N: 296,532ft E: 1,650,964ft LAT: 39°18'27.28" LON: 80°44'00.69" BOTTOM HOLE INFORMATION: N: 306,544ft E: 1,647,680ft LAT: 39°20'05.78" LON: 80°44'44.23" WEST VIRGINIA COORDINATE SYSTEM OF 1927 NORTH ZONE. ZONE WAS DERIVED FROM MEASUREMENTS TAKEN WITH TRIMBLE GEOXT TAKEMETER MAPPING GRADE GPS UNIT. PLAT ORIENTATION, CORNER, AND WELL REFERENCE TIE LINES ARE BASED ON GRID NORTH.

(NAD) 83 (UTM) ZONE 17 COORDS: WELL 4H TOP HOLE INFORMATION: N: 4,350,953m E: 522,990m BOTTOM HOLE INFORMATION: N: 4,353,986m E: 521,938m

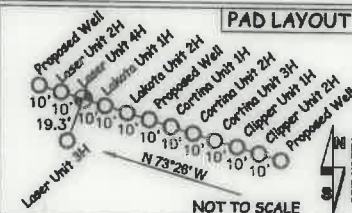

Table listing landowners and lease information. Includes names like Samuel Hammett, Larry Williams, Kinney Cemetery, Diana Knight, etc.

LONGITUDE 80°42'30"

9,382'

14,591' TO BOTTOM HOLE

LONGITUDE 80°42'30"

I THE UNDERSIGNED, HEREBY CERTIFY THAT THIS PLAT IS CORRECT TO THE BEST OF MY KNOWLEDGE AND BELIEF AND SHOWS ALL THE INFORMATION REQUIRED BY LAW AND THE RULES ISSUED AND PERSCRIBED BY THE DEPARTMENT OF ENVIRONMENTAL PROTECTION.



STATE OF WEST VIRGINIA, DIVISION OF ENVIRONMENTAL PROTECTION, OFFICE OF OIL AND GAS. WILLOW LAND SURVEYING PLLC 220 MASONIC AVE. PENNSBORO WEST VIRGINIA 26415

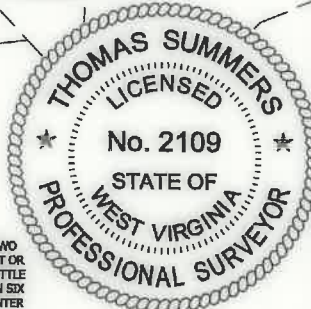

JOB # 17-025WA DRAWING # LASER4HAD SCALE 1" = 2000' MINIMUM DEGREE OF ACCURACY SUBMETER PROVEN SOURCE OF ELEV. SUBMETER MAPPING GRADE GPS STATE OF WEST VIRGINIA DEPARTMENT OF ENERGY DIVISION OF OIL AND GAS

LEGEND: Surface Owner Boundary Lines +/- Interior Surface Tracts +/- Proposed Well Path As Drilled Well Path. THOMAS SUMMERS P.S. 2109 DATE 06/18/20 OPERATOR'S WELL# LASER UNIT 4H

NOTE: 1. NO OCCUPIED DWELLINGS OR BUILDINGS TWO THOUSAND FIVE HUNDRED (2,500) SQUARE FEET OR LARGER USED TO HOUSE OR SHELTER DAIRY CATTLE OR POULTRY HUSBANDRY ARE LOCATED WITHIN SIX HUNDRED TWENTY-FIVE (625) FEET OF THE CENTER OF THE WELL PAD. 2. TOP HOLE DATA SHOWN HEREON WAS PROVIDED BY ANTERO RESOURCES CORPORATION. 3. AS DRILLED DATA WAS PROVIDED BY ANTERO RESOURCES CORPORATION. 4. WLS IS NOT CERTIFYING THE DATA AND INFORMATION PROVIDED LISTED IN NOTES 2 AND 3, ONLY THE RELATIONSHIP TO THE DATA AND INFORMATION PROVIDED TO THE LEASE BOUNDARIES. 5. WLS IS BY NO MEANS RESPONSIBLE FOR ANY ERRORS OR INACCURACIES WITH THE DATA AND INFORMATION THAT HAS BEEN PROVIDED.

WELL TYPE: OIL GAS X LIQUID INJECTION WASTE DISPOSAL 47 017 06895 (IF "GAS") PRODUCTION X STORAGE DEEP SHALLOW X STATE COUNTY PERMIT LOCATION: ELEVATION 1,283' -AS-BUILT WATERSHED HEADWATERS MIDDLE ISLAND CREEK QUADRANGLE SMITHBURG 7.5 DISTRICT WEST UNION COUNTY DODDRIDGE SURFACE OWNER GEORGE S. WYCKOFF ACREAGE 104.27 ACRES +/- LEASE ACREAGE 156 ACRES; 180 ACRES; 19.18 ACRES; OIL & GAS ROYALTY OWNER V.B. CHAPMAN ET UX; JOHNSON B. SMITH ET UX; S. A. SMITH ET AL; APPALACHIAN ROYALTIES, INC.; P.S. COWMAN ET UX; DIXIE J. CRAIG; PAMELA R. SCOTT; EDGAR DAVISSON ET UX; 12.13 ACRES; 105.93 ACRES; 68.75 ACRES; 32 ACRES; 220 ACRES; MICHAEL T. O'BRIEN ET UX; ED BROOME INC.; LORELEI PHILLIPS ET AL; MARIE K. COX ET AL 27 ACRES; 17.45 ACRES; 72 ACRES; 97 ACRES PROPOSED WORK: DRILL CONVERT DRILL DEEPER REDRILL FRACTURE OR STIMULATE PLUG OFF OLD FORMATION PERFORATE NEW FORMATION OTHER PHYSICAL CHANGE IN WELL (SPECIFY) AS DRILLED PLUG & ABANDON CLEAN OUT & REPLUG TARGET FORMATION MARCELLUS ESTIMATED DEPTH 7,103' TVD 17,693' MD WELL OPERATOR ANTERO RESOURCES CORP. DESIGNATED AGENT DIANNA STAMPER - CT CORPORATION SYSTEM ADDRESS 1615 WYNKOOP ST. ADDRESS 5400 D BIG TYLER ROAD DENVER, CO 80202 CHARLESTON, WV 25313

LATITUDE 39°20'00" 7,127'

10,546' TO BOTTOM HOLE

LATITUDE 39°22'30"

Antero Resources Corporation Well No. Laser Unit 4H

AS DRILLED DATA: WELL 4H TOP HOLE INFORMATION: N: 296,532ft E: 1,650,964ft LAT: 39°18'27.28" LON: 80°44'00.69" BOTTOM HOLE INFORMATION: N: 306,544ft E: 1,647,680ft LAT: 39°20'05.78" LON: 80°44'44.23" WEST VIRGINIA COORDINATE SYSTEM OF 1927 NORTH ZONE. ZONE WAS DERIVED FROM MEASUREMENTS TAKEN WITH TRIMBLE GEOXT SUBMETER MAPPING GRADE GPS UNIT. PLAT ORIENTATION, CORNER, AND WELL REFERENCE TIE LINES ARE BASED ON GRID NORTH.

(NAD) 83 (UTM) ZONE 17 COORDS: WELL 4H TOP HOLE INFORMATION: N: 4,350,953m E: 522,990m BOTTOM HOLE INFORMATION: N: 4,353,986m E: 521,938m

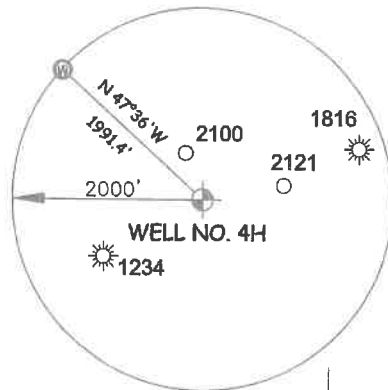
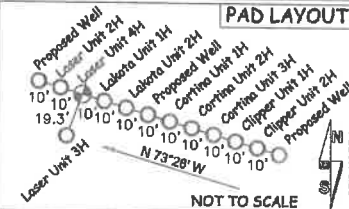

Table listing landowners and lease information. Includes names like Samuel Hammett, Larry Williams, Kinney Cemetery, Diana Knight, etc.

GRID NORTH VM NORTH NORTH

LONGITUDE 80°42'30"

9,382'

14,591' TO BOTTOM HOLE

LONGITUDE 80°42'30"

I THE UNDERSIGNED, HEREBY CERTIFY THAT THIS PLAT IS CORRECT TO THE BEST OF MY KNOWLEDGE AND BELIEF AND SHOWS ALL THE INFORMATION REQUIRED BY LAW AND THE RULES ISSUED AND PERSCRIBED BY THE DEPARTMENT OF ENVIRONMENTAL PROTECTION.



STATE OF WEST VIRGINIA, DIVISION OF ENVIRONMENTAL PROTECTION, OFFICE OF OIL AND GAS

WILLOW LAND SURVEYING PLLC 220 MASONIC AVE. PENNSBORO WEST VIRGINIA 26415

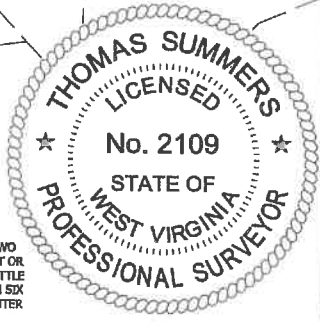

JOB # 17-025WA DRAWING # LASER4HAD SCALE 1" = 2000' MINIMUM DEGREE OF ACCURACY SUBMETER PROVEN SOURCE OF ELEV. SUBMETER MAPPING GRADE GPS STATE OF WEST VIRGINIA DEPARTMENT OF ENERGY DIVISION OF OIL AND GAS

LEGEND: Surface Owner Boundary Lines +/- Interior Surface Tracts +/- Proposed Well Path As Drilled Well Path THOMAS SUMMERS P.S. 2109 DATE 06/18/20 OPERATOR'S WELL# LASER UNIT #4H

NOTE: 1. NO OCCUPIED DWELLINGS OR BUILDINGS TWO THOUSAND FIVE HUNDRED (2,500) SQUARE FEET OR LARGER USED TO HOUSE OR SHELTER DAIRY CATTLE OR POULTRY HUSBANDRY ARE LOCATED WITHIN SIX HUNDRED TWENTY-FIVE (625) FEET OF THE CENTER OF THE WELL PAD. 2. TOP HOLE DATA SHOWN HEREON WAS PROVIDED BY ANTERO RESOURCES CORPORATION. 3. AS DRILLED DATA WAS PROVIDED BY ANTERO RESOURCES CORPORATION. 4. WLS IS NOT CERTIFYING THE DATA AND INFORMATION PROVIDED LISTED IN NOTES 2 AND 3, ONLY THE RELATIONSHIP TO THE DATA AND INFORMATION PROVIDED TO THE LEASE BOUNDARIES. 5. WLS IS BY NO MEANS RESPONSIBLE FOR ANY ERRORS OR INACCURACIES WITH THE DATA AND INFORMATION THAT HAS BEEN PROVIDED.

WELL TYPE: OIL GAS X LIQUID INJECTION WASTE DISPOSAL 47 017 06895 (IF "GAS") PRODUCTION X STORAGE DEEP SHALLOW X STATE COUNTY PERMIT LOCATION: ELEVATION 1,283' AS-BUILT WATERSHED HEADWATERS MIDDLE ISLAND CREEK QUADRANGLE SMITHBURG 7.5' DISTRICT WEST UNION COUNTY DODDRIDGE SURFACE OWNER GEORGE S. WYCKOFF ACREAGE 104.27 ACRES +/- LEASE ACREAGE 156 ACRES+ 180 ACRES+ 19.18 ACRES+ OIL & GAS ROYALTY OWNER V.B. CHAPMAN ET UX; JOHNSON B. SMITH ET UX; S. A. SMITH ET AL; APPALACHIAN ROYALTIES, INC.; P.S. COWMAN ET UX; DIXIE J. CRAIG; PAMELA R. SCOTT; EDGAR DAVISSON ET UX; 12.13 ACRES+ 105.93 ACRES+ 68.75 ACRES+ 32 ACRES+ 230 ACRES+ MICHAEL T. O'BRIEN ET UX; ED BROOME INC.; LORELEI PHILLIPS ET AL; MARIE K. COX ET AL 27 ACRES+ 17.45 ACRES+ 72 ACRES+ 97 ACRES+ PROPOSED WORK: DRILL CONVERT DRILL DEEPER REDRILL FRACTURE OR STIMULATE PLUG OFF OLD FORMATION PERFORATE NEW FORMATION OTHER PHYSICAL CHANGE IN WELL (SPECIFY) AS DRILLED PLUG & ABANDON CLEAN OUT & REPLUG TARGET FORMATION MARCELLUS ESTIMATED DEPTH 7,103' TVD 17,693' MD WELL OPERATOR ANTERO RESOURCES CORP. DESIGNATED AGENT DIANNA STAMPER - CT CORPORATION SYSTEM ADDRESS 1615 WYNKOOP ST. ADDRESS 5400 D BIG TYLER ROAD DENVER, CO 80202 CHARLESTON, WV 25313