

LATITUDE 39°20'00"

7,108'

LATITUDE 39°17'30"

2,023' TO BOTTOM HOLE

Antero Resources Corporation Well No. Lakota Unit 2H

AS DRILLED DATA: WELL 2H TOP HOLE INFORMATION: N: 296,526ft E: 1,650,986ft LAT: 39°18'27.22" LON: 80°44'00.41" BOTTOM HOLE INFORMATION: N: 283,166ft E: 1,655,890ft LAT: 39°16'15.84" LON: 80°42'55.72" WEST VIRGINIA COORDINATE SYSTEM OF 1927 NORTH ZONE. ZONE WAS DERIVED FROM MEASUREMENTS TAKEN WITH TRIMBLE GEOXT SUBMETER MAPPING GRADE GPS UNIT. PLAT ORIENTATION, CORNER, AND WELL REFERENCE TIE LINES ARE BASED ON GRID NORTH.

(NAD) 83 (UTM) ZONE 17 COORDS: WELL 2H TOP HOLE INFORMATION: N: 4,350,951m E: 522,996m BOTTOM HOLE INFORMATION: N: 4,346,906m E: 524,558m

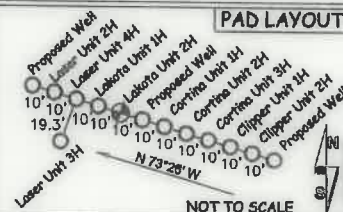

1 WATER WELL WAS LOCATED WITHIN 2000' OF CENTER OF PAD

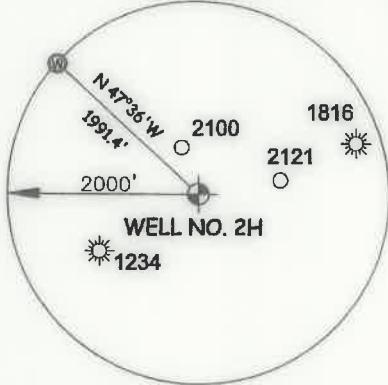

Table listing landowners and leaseholders in West Union District - Doddridge County, including names like Paul Smith, George Wyckoff, and various LLCs.

Table listing landowners and leaseholders in West Union District - Doddridge County, including names like Jimmie Nicholson, Michael Kappinger, and Archold Cemetery.

Table listing landowners and leaseholders in West Union District - Doddridge County, including names like Lucien Sammons, David Mitchell, and Robert Bland.

WV NORTH ZONE GRID NORTH

7,503' TO BOTTOM HOLE

9,387'

LONGITUDE 80°42'30"

LONGITUDE 80°42'30"

I THE UNDERSIGNED, HEREBY CERTIFY THAT THIS PLAT IS CORRECT TO THE BEST OF MY KNOWLEDGE AND BELIEF AND SHOWS ALL THE INFORMATION REQUIRED BY LAW AND THE RULES ISSUED AND PERSCRIBED BY THE DEPARTMENT OF ENVIRONMENTAL PROTECTION.



STATE OF WEST VIRGINIA, DIVISION OF ENVIRONMENTAL PROTECTION, OFFICE OF OIL AND GAS

WILLOW LAND SURVEYING PLLC 220 MASONIC AVE. PENNSBORO WEST VIRGINIA 26415

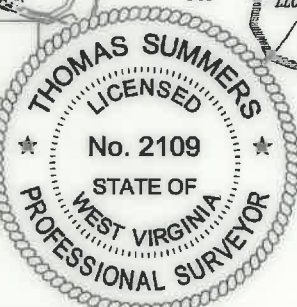

JOB # 18-034WA DRAWING # LAKOTA2HAD SCALE 1" = 2000' MINIMUM DEGREE OF ACCURACY SUBMETER PROVEN SOURCE OF ELEV. SUBMETER MAPPING GRADE GPS

LEGEND: Surface Owner Boundary Lines +/- Interior Surface Tracts +/- Proposed Well Path As Drilled Well Path

THOMAS SUMMERS P.S. 2109

STATE OF WEST VIRGINIA DEPARTMENT OF ENERGY DIVISION OF OIL AND GAS

DATE 06/18/20 OPERATOR'S WELL# LAKOTA UNIT #2H

NOTE: 1. NO OCCUPIED DWELLINGS OR BUILDINGS TWO THOUSAND FIVE HUNDRED (2,500) SQUARE FEET OR LARGER USED TO HOUSE OR SHELTER DAIRY CATTLE OR POULTRY HUSBANDRY ARE LOCATED WITHIN SIX HUNDRED TWENTY-FIVE (625) FEET OF THE CENTER OF THE WELL PAD. 2. TOP HOLE DATA SHOWN HEREON WAS PROVIDED BY ANTERO RESOURCES CORPORATION. 3. AS DRILLED DATA WAS PROVIDED BY ANTERO RESOURCES CORPORATION. 4. WLS IS NOT CERTIFYING THE DATA AND INFORMATION PROVIDED LISTED IN NOTES 2 AND 3, ONLY THE RELATIONSHIP TO THE DATA AND INFORMATION PROVIDED TO THE LEASE BOUNDARIES. 5. WLS IS BY NO MEANS RESPONSIBLE FOR ANY ERRORS OR INACCURACIES WITH THE DATA AND INFORMATION THAT HAS BEEN PROVIDED.

WELL TYPE: OIL GAS X LIQUID INJECTION WASTE DISPOSAL 47 017 06893 (IF "GAS") PRODUCTION X STORAGE DEEP SHALLOW X STATE COUNTY PERMIT LOCATION: ELEVATION 1,283' - AS BUILT WATERSHED HEADWATERS MIDDLE ISLAND CREEK QUADRANGLE SMITHBURG 7.5' DISTRICT WEST UNION COUNTY DODDRIDGE SURFACE OWNER GEORGE S. WYCKOFF ACREAGE 70.58 ACRES +/-

OIL & GAS ROYALTY OWNERS: V.B. CHAPMAN ET UX; JOHNSON B. SMITH ET UX; FANNIE A. COULEHAN; HELEN INGRID HALL; LEASE ACREAGE 158 AC +/- 180 AC +/- 234.94 AC +/- 33 AC +/- E.C. JONES ET AL; DOROTHY E. O'HANLON; LEWIS MAXWELL OIL & GAS LLC; WYDNR; THOMAS JOSEPH MCCONNELL; 300 AC +/- 69.88 AC +/- 54.94 AC +/- 8.9 AC +/- 24.45 AC +/- WYSRA; A.E. FITZWILLIAMS ET AL; HUGH SPENCER ET UX; SPENCER ENTERPRISES, LLC 301.19 AC +/- 138.5 AC +/- 132 AC +/- 43 AC +/-

PROPOSED WORK: DRILL CONVERT DRILL DEEPER REDRILL FRACTURE OR STIMULATE PLUG OFF OLD FORMATION PERFORATE NEW FORMATION OTHER PHYSICAL CHANGE IN WELL (SPECIFY) AS DRILLED PLUG & ABANDON CLEAN OUT & REPLUG

TARGET FORMATION MARCELLUS ESTIMATED DEPTH 6,936' TVD 21,426' MD WELL OPERATOR ANTERO RESOURCES CORP. DESIGNATED AGENT DIANNA STAMPER - CT CORPORATION SYSTEM ADDRESS 1615 WYNKOOP ST. ADDRESS 5400 D BIG TYLER ROAD

FORM WW-6 DENVER, CO 80202 CHARLESTON, WV 25313

COUNTY NAME PERMIT

