

LATITUDE 39°20'00"

4,824'

7,579' TO BOTTOM HOLE  
LATITUDE 39°22'30"

LONGITUDE 80°42'30"

6,891'

TO BOTTOM HOLE

LONGITUDE 80°42'30"

LONGITUDE 80°42'30"

Antero Resources Corporation  
Well No. Telstar Unit 2H

WELL NO. 2H  
BOTTOM HOLE

AS DRILLED DATA:  
WELL 2H TOP HOLE INFORMATION:  
N: 298,991ft E: 1,653,302ft  
LAT: 39°18'51.90" LON: 80°43'31.38"  
BOTTOM HOLE INFORMATION:  
N: 308,229ft E: 1,650,670ft  
LAT: 39°20'22.84" LON: 80°44'06.47"  
WEST VIRGINIA COORDINATE SYSTEM OF 1927 NORTH ZONE. ZONE WAS DERIVED FROM MEASUREMENTS TAKEN WITH TRIMBLE GEOXT SUBMETER MAPPING GRADE GPS UNIT. PLAT ORIENTATION, CORNER, AND WELL REFERENCE TIE LINES ARE BASED ON GRID NORTH.

(NAD) 83 (UTM) ZONE 17 COORDS:  
WELL 2H TOP HOLE INFORMATION:  
N: 4,351,714m E: 523,689m  
BOTTOM HOLE INFORMATION:  
N: 4,354,515m E: 522,840m

- NOTE
1. NO OCCUPIED DWELLINGS OR BUILDINGS TWO THOUSAND FIVE HUNDRED (2,500) SQUARE FEET OR LARGER USED TO HOUSE OR SHELTER DAIRY CATTLE OR POULTRY HUSBANDRY ARE LOCATED WITHIN SIX HUNDRED TWENTY-FIVE (625) FEET OF THE CENTER OF THE WELL PAD.
  2. TOP HOLE DATA SHOWN HEREON WAS PROVIDED BY ANTERO RESOURCES CORPORATION.
  3. AS DRILLED DATA WAS PROVIDED BY ANTERO RESOURCES CORPORATION.
  4. WLS IS NOT CERTIFYING THE DATA AND INFORMATION PROVIDED LISTED IN NOTES 2 AND 3, ONLY THE RELATIONSHIP TO THE DATA AND INFORMATION PROVIDED TO THE LEASE BOUNDARIES.
  5. WLS IS BY NO MEANS RESPONSIBLE FOR ANY ERRORS OR INACCURACIES WITH THE DATA AND INFORMATION THAT HAS BEEN PROVIDED.



WV NORTH ZONE  
GRID NORTH

ROBERT A. DEIGHT ET AL.  
D.B. 249 PG. 249  
T.M. 08 PAR. 22  
40.9 AC. ±

JINMAR E. SANCHEZ ET AL.  
D.B. 262 PG. 490  
T.M. 05 PAR. 08  
70.56 AC. ±

C. HOWARD KNIGHT ET AL.  
LEASE

SAMUEL HAMMETT ET AL.  
D.B. 263 PG. 99  
T.M. 08 PAR. 02.1  
379.58 AC. ±

GEORGE BENTON WHITE LEASE

TONY L. MULLINX ET AL.  
D.B. 258 PG. 179  
T.M. 05 PAR. 08.1  
9.44 AC. ±

CLEN L. MURPHY ET AL.  
D.B. 204 PG. 474  
T.M. 05 PAR. 09  
18.2 AC. ±

RANOMA L. MURPHY ET AL.  
W.B. 30 PG. 317  
T.M. 05 PAR. 14  
35.61 AC. ±

EDGAR DAVISSON ET AL.  
D.B. 272 PG. 425  
T.M. 05 PAR. 13  
27.33 AC. ±

JERRY A. CHOO ET AL.  
D.B. 256 PG. 254  
T.M. 05 PAR. 13  
27.33 AC. ±

MICHAEL J. KOZAREWICH ET AL.  
D.B. 272 PG. 425  
T.M. 05 PAR. 13  
27.33 AC. ±

SHARON ANN HODGSON  
W.B. 34 PG. 504  
T.M. 08 PAR. 14  
100.41 AC. ±

PAHOLA A. HESSEBOTHAM  
W.B. 41 PG. 67  
T.M. 08 PAR. 05  
142.44 AC. ±

JOHN MCKINNEY ET AL.  
LEASE

GREATHOUSE FAMILY TRUST  
D.B. 270 PG. 187  
T.M. 08 PAR. 10  
41.73 AC. ±

EDWARD J. CUTRIGHT  
U.S. 10 PG. 217  
T.M. 05 PAR. 14  
20 AC. ±

JAMES B. FOX ET AL.  
D.B. 177 PG. 33  
T.M. 05 PAR. 19  
36.1 AC. ±

JAMES B. FOX  
D.B. 236 PG. 666  
T.M. 08 PAR. 13  
50 AC. ±

JAMES B. FOX  
D.B. 236 PG. 666  
T.M. 12 PAR. 01  
28 AC. ±

JAMES B. FOX  
D.B. 236 PG. 666  
T.M. 12 PAR. 02  
29.73 AC. ±

DORIS L. CLEVELAND LEASE

JAMES B. FOX  
D.B. 236 PG. 666  
T.M. 12 PAR. 01  
28 AC. ±

P.B. McCLAIN ET AL. LEASE

GARY L. STEPHENS  
W.B. 34 PG. 505  
T.M. 08 PAR. 23.1  
100.41 AC. ±

T.G. BAKER ET AL. LEASE

MARY E. DEETS  
D.B. 235 PG. 103  
T.M. 08 PAR. 38  
33.29 AC. ±

JOHNSON B. SMITH ET AL. LEASE

PAULA A. SMITH  
D.B. 235 PG. 417  
T.M. 08 PAR. 36  
175.78 AC. ±

FANNIE A. COULERN LEASE

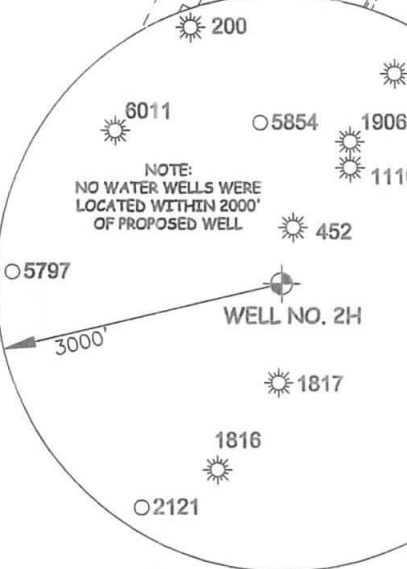

NOTE:  
NO WATER WELLS WERE  
LOCATED WITHIN 2000'  
OF PROPOSED WELL

LEGEND

- Surface Owner Boundary Lines +/-
- Interior Surface Tracts +/-
- Proposed Well Path
- As Drilled Well Path

THOMAS SUMMERS P.S. 2109

DATE 10/10/19

OPERATOR'S WELL# TELSTAR UNIT #2H

API WELL # 47 - 017 - 06881

STATE COUNTY PERMIT

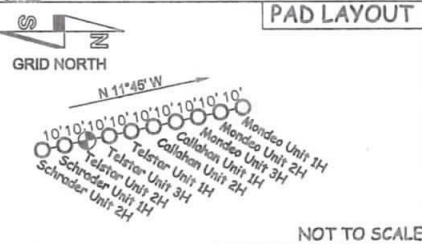

JOB # 17-026WA  
DRAWING # TELSTAR2HAD  
SCALE 1" = 1000'

MINIMUM DEGREE OF ACCURACY SUBMETER  
PROVEN SOURCE OF ELEV. SUBMETER MAPPING GRADE GPS

STATE OF WEST VIRGINIA  
DEPARTMENT OF ENERGY  
DIVISION OF OIL AND GAS



STATE OF WEST VIRGINIA, DIVISION  
OF ENVIRONMENTAL PROTECTION,  
OFFICE OF OIL AND GAS

WILLOW LAND SURVEYING PLLC  
220 MASONIC AVE. PENNSBORO  
WEST VIRGINIA 26415

WELL TYPE: OIL \_\_\_ GAS X LIQUID INJECTION \_\_\_ WASTE DISPOSAL \_\_\_  
(IF "GAS") PRODUCTION X STORAGE \_\_\_ DEEP \_\_\_ SHALLOW X  
LOCATION: ELEVATION 1,376' -AS BUILT WATERSHED HEADWATERS MIDDLE ISLAND CREEK  
QUADRANGLE SMITHBURG 7.5' DISTRICT WEST UNION COUNTY DODDRIDGE

SURFACE OWNER MARY E. DEETS AND/OR PAULA A. SMITH ACREAGE 53.29 ACRES +/- AND/OR 175.78 ACRES +/-

OIL & GAS ROYALTY OWNER T.G. BAKER ET AL.; JOHNSON B. SMITH ET AL.; P.B. McCLAIN ET AL.; LEASE ACREAGE 54 ACRES±; 180 ACRES±; 200 ACRES±;  
JOHNSON WILLIAMS; EDGAR DAVISSON ET AL.; JOHN MCKINNEY ET AL.; GEORGE BENTON WHITE; C. HOWARD KNIGHT ET AL. 105.5 ACRES±; 230 ACRES±; 73 ACRES±; 75 ACRES±; 54 ACRES±

PROPOSED WORK: DRILL \_\_\_ CONVERT \_\_\_ DRILL DEEPER \_\_\_ REDRILL \_\_\_ FRACTURE OR STIMULATE \_\_\_  
PLUG OFF OLD FORMATION \_\_\_ PERFORATE NEW FORMATION \_\_\_ OTHER PHYSICAL CHANGE IN WELL  
(SPECIFY) AS DRILLED PLUG & ABANDON \_\_\_ CLEAN OUT & REPLUG \_\_\_  
TARGET FORMATION MARCELLUS ESTIMATED DEPTH 7,177' TVD 16,872' MD

WELL OPERATOR ANTERO RESOURCES CORP. DESIGNATED AGENT DIANNA STAMPER  
ADDRESS 1615 WYNKOOP STREET ADDRESS 5400 D BIG TYLER ROAD  
DENVER, CO 80202 CHARLESTON, WV 25313