

7,389' to Top Hole

3,166' to Bottom Hole

**TOP HOLE LATITUDE 39 - 22 - 30**  
**BTM HOLE LATITUDE 39 - 20 - 00**

**Notes:**  
**West Virginia Coordinate System of 1927, North Zone based upon Differential GPS Measurements.**  
 Well No. Convair Unit 2H Top Hole coordinates are  
 N: 306,941.47' Latitude: 39°20'08.54"  
 E: 1,639,254.90' Longitude: 80°46'31.52"  
 Bottom Hole coordinates are  
 N: 299,470.67' Latitude: 39°18'55.26"  
 E: 1,643,266.57' Longitude: 80°45'39.13"  
**UTM Zone 17, NAD 1983**  
 Top Hole Coordinates Bottom Hole Coordinates  
 N: 4,354,064.487m N: 4,351,808.911m  
 E: 519,369.242m E: 520,629.365m  
 Plat orientation and corner well references are based upon the grid north meridian.  
 Well location references are based upon the magnetic meridian.

**LONGITUDE 80 - 45 - 00**

**6,506' to Bottom Hole**

**14,210' to Top Hole**

05/03/2019

Denotes Location of Well on United States Topographic Maps

Bottom Hole 7.5' Spot

Lease Table  
 A. David Lipscomb Lease

Top Hole Coordinates, As-drilled data, and information was provided by Antero Resources Corporation. Allegheny Surveys Inc. (ASI) is not certifying the data and information provided. ASI is not responsible for any errors or inaccuracies with the data and information that has been provided.

No.	TM-Par	Owner	Bk/Pg	Acres
1	4-34.4	Matthew W. Alexander & Linda Marie Muhly	320/629	4.50
2	4-32	Matthew W. Alexander & Linda Marie Muhly	241/412	43.94
3	4-30	Kathryn J. Sisler, et al	211/302	30.5
4	7-19	Janet & James R. Fraley	185/112	2.6
5	4-32.1	Andy H. & Carrie K. Kurtz	349/322	20.0
6	7-29	Steve T. & Sharon A. Gaspar	220/5	182.67

	Bearing	Dist.
L1	N 66°03' W	654.7'
L2	N 44°28' W	767.0'
L3	N 25°41' W	1,009.5'
L4	N 35°57' E	1,385.1'

**I, the undersigned, hereby certify that this plat is correct to the best of my knowledge and belief and shows all the information required by law and the rules issued and prescribed by the Department of Environmental Protection.**

*Bradley D. Miller*  
**Bradley D. Miller, 2167**

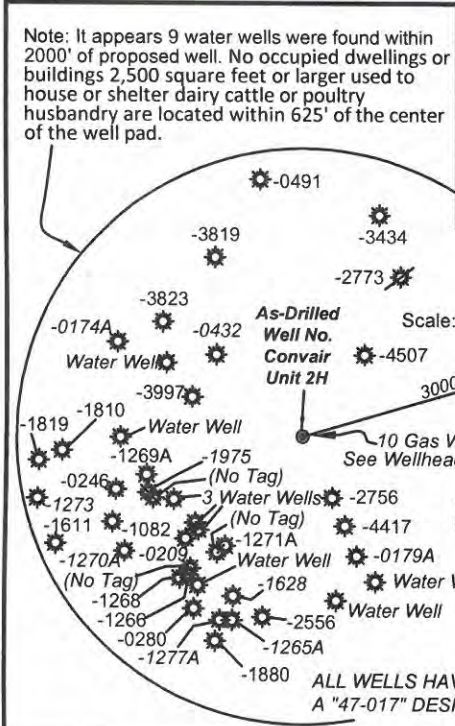

**Legend**

- Proposed gas well
- Found corner, as noted
- Well (as noted)
- Creek or Drain
- Existing Road
- Surface boundary (approx.)
- Surface tracts (approx.)

**Wellhead Layout**  
 Detail Not to Scale

- Edgar Unit 3H (47-017-6856)
- Edgar Unit 2H (47-017-6855)
- Edgar Unit 1H (47-017-6854)
- Scorpio Unit 2H (47-017-6861)
- Scorpio Unit 1H (47-017-6860)
- Convair Unit 3H (47-017-6853)
- As-Drilled Convair Unit 2H (47-017-6859)**
- Convair Unit 1H (47-017-6858)
- Northrop Unit 2H (47-017-6857)
- Northrop Unit 1H (47-017-6791)

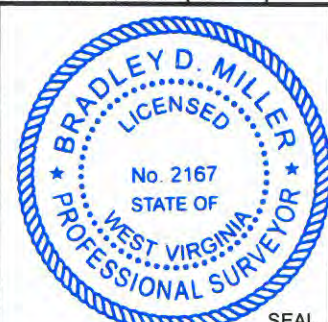

FILE NO: 47-30-WU-14  
 DRAWING NO: Convair 2H Well Plat  
 SCALE: 1" = 1000'  
 MINIMUM DEGREE OF ACCURACY: Submeter  
 PROVEN SOURCE OF ELEVATION: WVDOT, Harrisville, WV

**STATE OF WEST VIRGINIA**  
 DEPARTMENT OF ENVIRONMENTAL PROTECTION  
**OIL AND GAS DIVISION**

DATE: October 8 20 18  
 Operator's Well No. Convair Unit 2H  
 API WELL NO  
47 - 017 - 06859  
 STATE COUNTY PERMIT

WELL TYPE:  OIL  GAS  LIQUID INJECTION  WASTE DISPOSAL  
 (IF GAS) PRODUCTION:  STORAGE  DEEP  SHALLOW

LOCATION: ELEVATION: As-Drilled Grade - 1181' WATERSHED: Headwaters Middle Island Creek QUADRANGLE: West Union  
 DISTRICT: West Union COUNTY: Doddridge  
 SURFACE OWNER: Matthew W. Alexander & Linda Marie Muhly Joseph Freeman, et ux; William A. Farr; Charles C. Smith, et al ACREAGE: 43.94 60; 120; 40  
 ROYALTY OWNER: Clyde F. Smith, et al; Carole Hanlon; Larry Williams; William Ashburn Heirs LEASE NO: \_\_\_\_\_ ACREAGE: 428.51; 71.5  
 PROPOSED WORK:  DRILL  CONVERT  DRILL DEEPER  FRACTURE OR STIMULATE  PLUG OFF OLD FORMATION  
 PERFORATE NEW FORMATION  OTHER PHYSICAL CHANGE IN WELL (SPECIFY) As-Drilled  
 PLUG AND ABANDON  CLEAN OUT AND REPLUG TARGET FORMATION: Marcellus Shale ESTIMATED DEPTH: 6,930' TVD 15,661' MD

WELL OPERATOR: Antero Resources Corporation DESIGNATED AGENT: Dianna Stamper - CT Corporation System  
 ADDRESS: 1615 Wynkoop Street ADDRESS: 5400 D Big Tyler Road  
Denver, CO 80202 Charleston, WV 25313