

Bearing	Dist.
L1 S 63°22' W	541.2'
L2 N 88°57' E	726.9'
L3 N 03°23' W	728.7'
L4 S 65°06' E	1953.2'
L5 N 70°17' W	1230.4'

ALL WELLS HAVE A "47-017" DESIGNATION



Note: 6 water wells and 4 springs were found within 2000' of proposed well. No occupied dwellings or buildings 2,500 square feet or larger used to house or shelter dairy cattle or poultry husbandry are located within 625' of the center of the well pad.

Notes:
Well No. Jimmy Unit 1H
UTM Zone 17, NAD 1927
Top Hole Coordinates
N: 14,282,949.92'
E: 1,701,514.16'
Point of Entry Coordinates
N: 14,282,699.31'
E: 1,701,034.71'
Bottom Hole Coordinates
N: 14,274,004.46'
E: 1,704,573.58'

Notes:
West Virginia Coordinate System of 1927, North Zone based upon Differential GPS Measurements.
Well No. Jimmy Unit 1H Top Hole coordinates are
N: 305,686.20' Latitude: 39°19'55.79"
E: 1,636,830.32' Longitude: 80°47'02.15"
Bottom Hole coordinates are
N: 296,687.80' Latitude: 39°18'27.27"
E: 1,639,741.13' Longitude: 80°46'23.48"
UTM Zone 17, NAD 1983
Top Hole Coordinates Bottom Hole Coordinates
N: 4,353,669.723m N: 4,350,943.160m
E: 518,636.972m E: 519,569.482m
Plat orientation and corner and well references are based upon the grid north meridian.
Well location references are based upon the magnetic meridian.

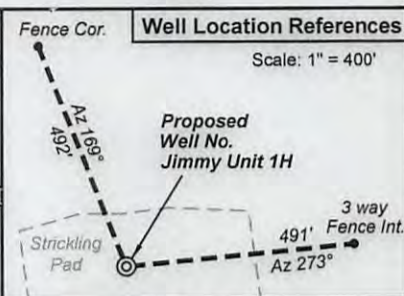

Legend

- ⊙ Proposed gas well
- ⊙ Found corner, as noted
- Creek or Drain
- Existing Road
- Surface boundary (approx.)
- Interior surface tracts (approx.)
- ⊙ Existing well, as noted

Tag	Par	Tax Map 4 Owner	Bk / Pg	Ac.
1	35	Matthew Alexander	276 / 12	5.89
2	29	Phillip S. Underwood Patricia Cooper Katherine S. Sisler	WB 51/709	0.46
3	24	Karen Ann Smith	248 / 254	35.34
4	23	Christian Church	49/71 & 72	0.85
5	30	Kathryn J. Sisler, et al	211/302	30.50
6	14.1	John M. & Andrea Fitzgerald	282/418	27.21

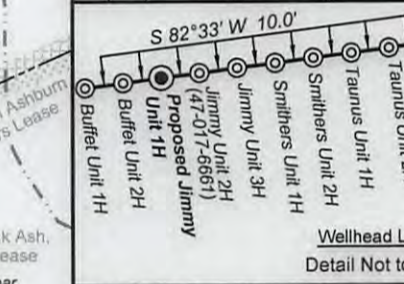

I, the undersigned, hereby certify that this plat is correct to the best of my knowledge and belief and shows all the information required by law and the rules issued and prescribed by the Department of Environmental Protection.

Kenneth J. Plum
Kenneth J. Plum, P.S. 2216



FILE NO: 50-30-WU-14
DRAWING NO: Jimmy 1H Well Plat 11-16
SCALE: 1" = 1200'
MINIMUM DEGREE OF ACCURACY: Submeter
PROVEN SOURCE OF ELEVATION: WVDOT, Harrisville, WV

STATE OF WEST VIRGINIA
DEPARTMENT OF ENVIRONMENTAL PROTECTION
OIL AND GAS DIVISION

DATE: March 22 2017
OPERATOR'S WELL NO. Jimmy Unit 1H
API WELL NO
47 - 017 - 06838-1-1-A
STATE COUNTY PERMIT

WELL TYPE: OIL GAS LIQUID INJECTION WASTE DISPOSAL
(IF GAS) PRODUCTION: STORAGE DEEP SHALLOW
LOCATION: ELEVATION: Existing Grade 1076' Proposed Grade 1065' WATERSHED: Headwaters Middle Island Creek QUADRANGLE: West Union
DISTRICT: West Union COUNTY: Doddridge
SURFACE OWNER: John Paul Strickling, et al Joseph Freeman, et ux ACREAGE: 357.75
ROYALTY OWNER: Charles C. Smith, et al; G. Frank Ash, et al; Ida F. Ford LEASE NO: ACREAGE: 600; 140; 450; 114
PROPOSED WORK: DRILL CONVERT DRILL DEEPER FRACTURE OR STIMULATE PLUG OFF OLD FORMATION
 PERFORATE NEW FORMATION OTHER PHYSICAL CHANGE IN WELL (SPECIFY) 7,100' TVD
 PLUG AND ABANDON CLEAN OUT AND REPLUG TARGET FORMATION: Marcellus Shale ESTIMATED DEPTH: 17,000 MD

WELL OPERATOR: Antero Resources Corporation DESIGNATED AGENT: Dianna Stamper - CT Corporation System
ADDRESS: 1615 Wynkoop Street ADDRESS: 5400 D Big Tyler Road
Denver, CO 80202 Charleston, WV 25313

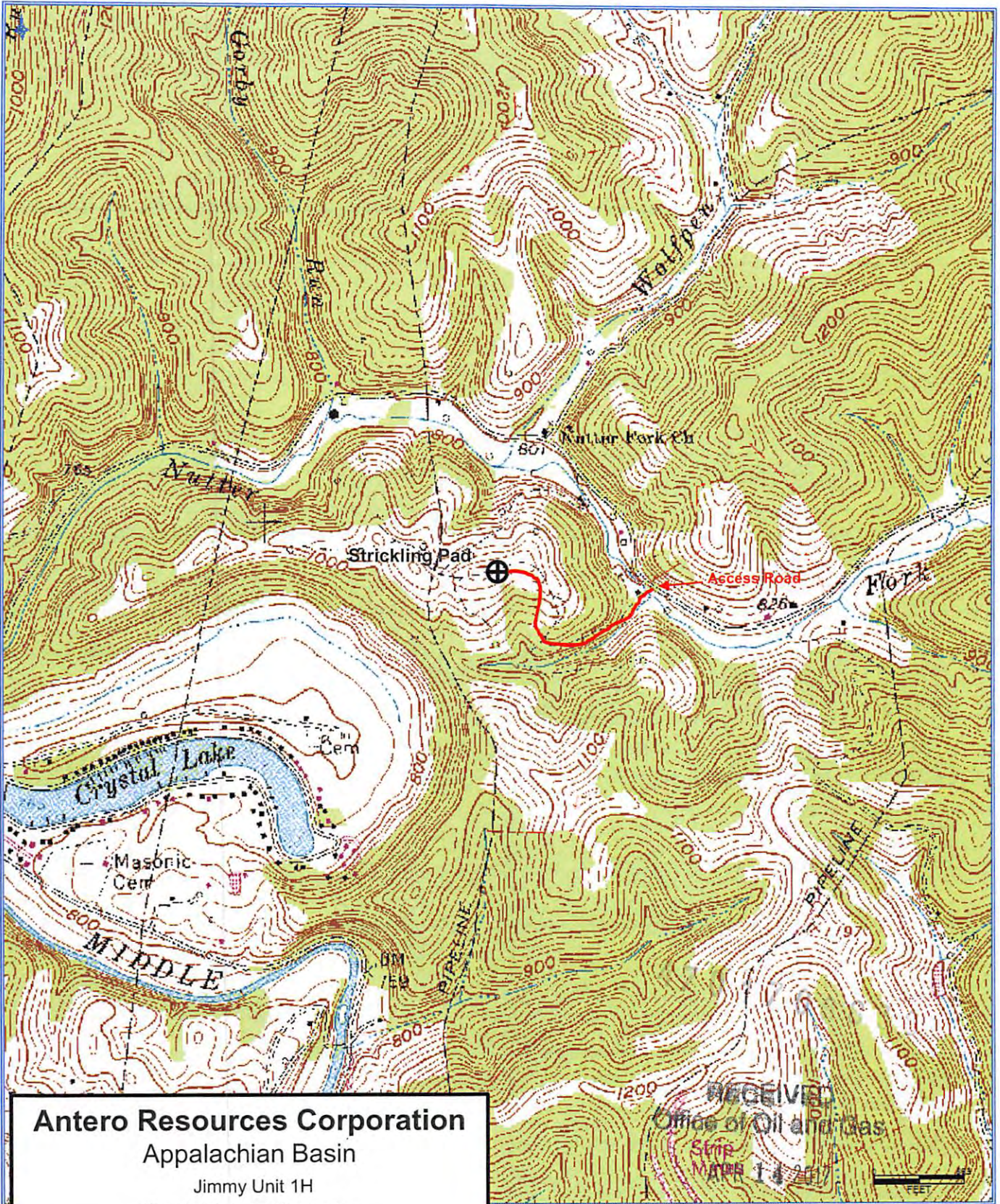

Antero Resources Corporation
 Appalachian Basin
 Jimmy Unit 1H
 Doddridge County
 Quadrangle: West Union
 Watershed: Headwaters Middle Island Creek
 District: West Union
 Date: 9-09-2014

RECEIVED
 Office of Oil and Gas
 Strip
 MAP 14 2017
 FEET