

WR-35
Rev. 8/23/13

State of West Virginia
Department of Environmental Protection - Office of Oil and Gas
Well Operator's Report of Well Work

API 47 - 017 - 06833 County Doddridge District Central
 Quad Pullman 7.5' (TH) Oxford 7.5' (BH) Pad Name Stanley Pad Field/Pool Name -----
 Farm name Stanley Webb et al Well Number Cool Unit 1H
 Operator (as registered with the OOG) Antero Resources Corporation
 Address 1615 Wynkoop Street City Denver State CO Zip 80202

As Drilled location NAD 83/UTM Attach an as-drilled plat, profile view, and deviation survey
 Top hole Northing 4343073m Easting 510403m
 Landing Point of Curve Northing 4342848m Easting 510154m
 Bottom Hole Northing 4340315m Easting 511264m

Elevation (ft) 1095' GL Type of Well New Existing Type of Report Interim Final
 Permit Type Deviated Horizontal Horizontal 6A Vertical Depth Type Deep Shallow
 Type of Operation Convert Deepen Drill Plug Back Redrilling Rework Stimulate
 Well Type Brine Disposal CBM Gas Oil Secondary Recovery Solution Mining Storage Other _____
 Type of Completion Single Multiple Fluids Produced Brine Gas NGL Oil Other _____
 Drilled with Cable Rotary

Drilling Media Surface hole Air Mud Fresh Water Intermediate hole Air Mud Fresh Water Brine
 Production hole Air Mud Fresh Water Brine

Mud Type(s) and Additive(s)

Air - Foam & 4% KCL

Mud - Polymer

Date permit issued 7/13/2017 Date drilling commenced 8/1/2018 Date drilling ceased 9/19/2018
 Date completion activities began 10/11/2018 Date completion activities ceased 11/17/2018
 Verbal plugging (Y/N) N/A Date permission granted N/A Granted by N/A

Please note: Operator is required to submit a plugging application within 5 days of verbal permission to plug

Freshwater depth(s) ft 51' Open mine(s) (Y/N) depths No
 Salt water depth(s) ft None Identified Void(s) encountered (Y/N) depths No
 Coal depth(s) ft None Identified Cavern(s) encountered (Y/N) depths No
 Is coal being mined in area (Y/N) No

Reviewed by:

WR-35
Rev. 8/23/13

API 47-017 - 06833 Farm name Stanley Webb et al Well number Cool Unit 1H

CASING STRINGS	Hole Size	Casing Size	Depth	New or Used	Grade wt/ft	Basket Depth(s)	Did cement circulate (Y/N) * Provide details below*
Conductor	24"	20"	80'	New	78.67#, ASTM A500-13	N/A	Y
Surface	17-1/2"	13-3/8"	562'	New	54.5#, J-55	N/A	Y
Coal							
Intermediate 1	12-1/4"	9-5/8"	2599'	New	36#, HCP-110	N/A	Y
Intermediate 2							
Intermediate 3							
Production	8-3/4"/8-1/2"	5-1/2"	16173'	New	23#, CYHP-P110 BPN	N/A	Y
Tubing		2-3/8"	6796'		23#, P-110		
Packer type and depth set		N/A					

Comment Details _____

CEMENT DATA	Class/Type of Cement	Number of Sacks	Slurry wt (ppg)	Yield (ft ³ /sks)	Volume (ft ³)	Cement Top (MD)	WOC (hrs)
Conductor	Class A	204 sx	15.6	1.20	245	0'	8 Hrs.
Surface	Class A	627 sx	15.6	1.21	759	0'	8 Hrs.
Coal							
Intermediate 1	Class A	876 sx	15.6	1.19	1042	0'	8 Hrs.
Intermediate 2							
Intermediate 3							
Production	Class H	770 sx (Lead) 2164sx (Tail)	14.5 (Lead), 15.7 (Tail)	1.40 (Lead), 1.60 (Tail)	4540	~500' into Intermediate Casing	8 Hrs.
Tubing							

Drillers TD (ft) 16227' MD, 6591' TVD (BHL), 6604' (Deepest Point Drilled) Loggers TD (ft) 16227' MD

Deepest formation penetrated Marcellus Plug back to (ft) N/A

Plug back procedure N/A

Kick off depth (ft) 6220'

Check all wireline logs run caliper density deviated/directional induction
 neutron resistivity gamma ray temperature sonic

Well cored Yes No Conventional Sidewall Were cuttings collected Yes No

DESCRIBE THE CENTRALIZER PLACEMENT USED FOR EACH CASING STRING _____

Conductor - 0

Surface - 1 above guide shoe, 1 above insert float, 1 every 4th joint to surface

Intermediate - 1 above float joint, 1 above float collar, 1 every 4th joint to surface

Production - 1 above float joint, 1 below float collar, 1 every 3rd joint to top of cement

WAS WELL COMPLETED AS SHOT HOLE Yes No DETAILS _____

WAS WELL COMPLETED OPEN HOLE? Yes No DETAILS _____

WERE TRACERS USED Yes No TYPE OF TRACER(S) USED N/A

API 47-017-06833 Farm Name Stanley Webb et al Well Number Cool Unit 1H					
EXHIBIT 1					
Stage No.	Perforation Date	Perforated from MD ft.	Perforated to MD ft.	Number of Perforations	Formations
1	10/11/2018	15966.8	16069.2	24	Marcellus
2	10/11/2018	15765.71	15935.285	48	Marcellus
3	10/11/2018	15564.62	15734.195	48	Marcellus
4	10/14/2018	15363.53	15533.105	48	Marcellus
5	10/14/2018	15162.44	15332.015	48	Marcellus
6	10/15/2018	14961.35	15130.925	48	Marcellus
7	10/16/2018	14760.26	14929.835	48	Marcellus
8	10/16/2018	14559.17	14728.745	48	Marcellus
9	10/17/2018	14358.08	14527.655	48	Marcellus
10	10/17/2018	14156.99	14326.565	48	Marcellus
11	10/18/2018	13955.9	14125.475	48	Marcellus
12	10/18/2018	13754.81	13924.385	48	Marcellus
13	10/19/2018	13553.72	13723.295	48	Marcellus
14	10/19/2018	13352.63	13522.205	48	Marcellus
15	10/20/2018	13151.54	13321.115	48	Marcellus
16	10/20/2018	12950.45	13120.025	48	Marcellus
17	10/21/2018	12749.36	12918.935	48	Marcellus
18	10/21/2018	12548.27	12717.845	48	Marcellus
19	10/22/2018	12347.18	12516.755	48	Marcellus
20	10/22/2018	12146.09	12315.665	48	Marcellus
21	10/22/2018	11945	12114.575	48	Marcellus
22	10/23/2018	11743.91	11913.485	48	Marcellus
23	10/23/2018	11542.82	11712.395	48	Marcellus
24	10/24/2018	11341.73	11511.305	48	Marcellus
25	10/24/2018	11140.64	11310.215	48	Marcellus
26	10/25/2018	10939.55	11109.125	48	Marcellus
27	10/25/2018	10738.46	10908.035	48	Marcellus
28	10/25/2018	10537.37	10706.945	48	Marcellus
29	10/26/2018	10336.28	10505.855	48	Marcellus
30	10/26/2018	10135.19	10304.765	48	Marcellus
31	10/26/2018	9934.1	10103.675	48	Marcellus
32	10/27/2018	9733.01	9902.585	48	Marcellus
33	10/27/2018	9531.92	9701.495	48	Marcellus
34	10/28/2018	9330.83	9500.405	48	Marcellus
35	10/28/2018	9129.74	9299.315	48	Marcellus
36	10/28/2018	8928.65	9098.225	48	Marcellus
37	10/29/2018	8727.56	8897.135	48	Marcellus
38	10/29/2018	8526.47	8696.045	48	Marcellus
39	10/29/2018	8325.38	8494.955	48	Marcellus
40	10/30/2018	8124.29	8293.865	48	Marcellus
41	10/30/2018	7923.2	8092.775	48	Marcellus
42	10/31/2018	7722.11	7891.685	48	Marcellus
43	10/31/2018	7521.02	7690.595	48	Marcellus
44	11/1/2018	7319.93	7489.505	48	Marcellus
45	11/1/2018	7118.84	7288.415	48	Marcellus
46	11/2/2018	6917.75	7087.325	48	Marcellus

API 47-017-06833 Farm Name Stanley Webb et al Well Number Cool Unit 1H

EXHIBIT 2

Stage No.	Stimulations Date	Avg Pump Rate	Avg Treatment Pressure (PSI)	Max Breakdown Pressure (PSI)	ISIP (PSI)	Amount of Proppant (lbs)	Amount of Water (bbls)	Amount of Nitrogen/ other (units)
1	10/11/2018	42.6593	8889.795	9258	4939	4500	3337	N/A
2	10/11/2018	70.3317	7973.706	6794	3422	402500	8235	N/A
3	10/11/2018	69.7486	7577.516	5856	3365	400500	8188	N/A
4	10/14/2018	73.2275	7876.334	6453	3300	399400	8187	N/A
5	10/14/2018	65.3961	8017.565	6101	3251	402300	7973	N/A
6	10/15/2018	74.805	7785.055	6055	3215	401550	8069	N/A
7	10/16/2018	65.4158	7679.579	5937	3159	400010	8265	N/A
8	10/16/2018	66.5483	7776.221	5088	3063	401800	8158	N/A
9	10/17/2018	71.1838	7955.782	6060	3129	400850	8113	N/A
10	10/17/2018	73.8673	7958.683	4592	3112	402500	8061	N/A
11	10/18/2018	74.0961	8118.896	5613	3002	401600	8096	N/A
12	10/18/2018	65.9079	8105.362	5815	3128	400060	7985	N/A
13	10/19/2018	75.471	8053.854	5617	3148	401200	8136	N/A
14	10/19/2018	74.4061	8035.42	6629	3241	403020	7972	N/A
15	10/20/2018	72.1921	7954.895	6254	3441	401350	8102	N/A
16	10/20/2018	74.8593	7755.728	5790	3755	404050	7964	N/A
17	10/21/2018	71.1481	7069.662	6172	3125	401500	7894	N/A
18	10/21/2018	77.7193	7614.381	5987	3172	400900	7861	N/A
19	10/22/2018	70.1833	7975.937	6369	3189	402850	7897	N/A
20	10/22/2018	78.5452	7822.896	5968	3117	401400	7895	N/A
21	10/22/2018	72.3901	8077.765	5993	3065	402500	8004	N/A
22	10/23/2018	73.7981	7877.955	5992	3234	402650	7944	N/A
23	10/23/2018	74.7513	7930.347	5650	3314	401400	9484	N/A
24	10/24/2018	72.2068	7865.182	6189	3113	402700	7774	N/A
25	10/24/2018	76.6676	7616.351	5734	3782	401250	7859	N/A
26	10/25/2018	78.97	7800.669	5834	3742	402500	7782	N/A
27	10/25/2018	79.0011	7481.582	5741	3496	402500	7861	N/A
28	10/25/2018	78.2158	7694.14	5911	3424	400700	9271	N/A
29	10/26/2018	78.1264	7616.274	5927	3407	401250	7832	N/A
30	10/26/2018	77.8751	7410.302	6279	3182	401500	7785	N/A
31	10/26/2018	74.0896	7971.139	6119	3010	400700	7786	N/A
32	10/27/2018	77.2261	7674.074	5856	3278	402800	7714	N/A
33	10/27/2018	77.1097	7365.085	6294	3029	400700	7734	N/A
34	10/28/2018	79.7777	7378.981	6545	3195	400700	7735	N/A
35	10/28/2018	77.5596	7134.034	6522	3093	402600	7740	N/A
36	10/28/2018	78.606	6886.983	5748	3320	400700	7689	N/A
37	10/29/2018	79.9288	6954.595	6780	3313	402700	7751	N/A
38	10/29/2018	79.9499	7329.06	6270	3656	401700	7668	N/A
39	10/29/2018	80.5453	7024.926	5933	3067	400700	7681	N/A
40	10/30/2018	79.0516	7095.331	6314	3462	406070	7708	N/A
41	10/30/2018	80.516	7430.798	6937	3242	402700	7762	N/A
42	10/31/2018	79.5354	7305.934	6219	3326	402300	7663	N/A
43	10/31/2018	80.3736	7431.666	7214	3960	400700	7666	N/A
44	11/1/2018	79.9365	7168.871	6189	3463	400650	7654	N/A
45	11/1/2018	80.4595	7634.206	6614	3338	400700	7650	N/A
46	11/2/2018	78.8849	7505.877	6057	3245	404050	7613	N/A
	AVG=	75	7,667	6,158	3,327	18,083,260	361,198	TOTAL

API 47-017-06833 Farm Name Stanley Webb et al Well Number Cool Unit 1H

EXHIBIT 3

LITHOLOGY/ FORMATION	TOP DEPTH (TVD)	BOTTOM DEPTH (TVD)	TOP DEPTH (MD)	BOTTOM DEPTH (MD)
	From Surface	From Surface	From Surface	From Surface
Freshwater	51'	N/A	51'	N/A
Silty Sandstone	0	335	0	335
Sandy siltstone	est 335	835	est 335	835
Sandstone	est 835	915	est 835	915
Silty Sandstone	est 915	1,055	est 915	1,055
limey siltstone	est 1055	1,175	est 1055	1,175
silty sandstone, tr. coal	est 1175	1,315	est 1175	1,315
silty sandstone	est 1315	1,375	est 1315	1,375
silty shale	est 1375	1,635	est 1375	1,635
sandstone, tr coal	est 1635	1,675	est 1635	1,675
silty sandstone	est 1675	1,815	est 1675	1,815
sandstone	est 1815	1,875	est 1815	1,875
sandy shale	est 1875	1,955	est 1875	1,955
shaly sand	est 1955	2,036	est 1955	2,055
Big Lime	2,036	2,225	2,055	2,249
Big Injun	2,225	2,575	2,249	2,606
Gantz Sand	2,575	2,894	2,606	2,930
Fifty Foot Sandstone	2,894	3,005	2,930	3,043
Gordon	3,005	3,155	3,043	3,197
Fifth Sandstone	3,155	3,416	3,197	3,461
Bayard	3,416	3,533	3,461	3,581
Warren	3,533	3,993	3,581	4,050
Speechley	3,993	4,221	4,050	4,283
Balltown	4,221	4,663	4,283	4,735
Bradford	4,663	5,038	4,735	5,118
Benson	5,038	5,302	5,118	5,386
Alexander	5,302	5,901	5,386	5,999
Rhinestreet	5,901	6,219	5,999	6,336
Sycamore	6,219	6,382	6,336	6,534
Middlesex	6,382	6,494	6,534	6,721
Burkett	6,494	6,524	6,721	6,795
Tully	6,524	6,549	6,795	6,873
Marcellus	6,549	NA	6,873	NA

*Please note Antero determines formation tops based on mud logs that are only run on one well on a multi-well pad. The measured depth (MD) data on subsequent wells may be slightly different due to the well's unique departure.

Hydraulic Fracturing Fluid Product Component Information Disclosure

Job Start Date:	10/10/2018
Job End Date:	11/2/2018
State:	West Virginia
County:	Doddridge
API Number:	47-017-06833-00-00
Operator Name:	Antero Resources Corporation
Well Name and Number:	Cool 1H
Latitude:	39.23681900
Longitude:	-80.87963300
Datum:	NAD83
Federal Well:	NO
Indian Well:	NO
True Vertical Depth:	6,604
Total Base Water Volume (gal):	15,759,418
Total Base Non Water Volume:	0



Hydraulic Fracturing Fluid Composition:

Trade Name	Supplier	Purpose	Ingredients	Chemical Service Abstract Number (CAS #)	Maximum Ingredient Concentration in Additive (% by mass)**	Maximum Ingredient Concentration in HF Fluid (% by mass)**	Comments
Water	Antero Resources	Carrier/Base Fluid	Water	7732-18-5	100.00000	87.70188	
Sand	J.S. Well Services, LLC	Proppant	Crystalline Silica, quartz	14808-60-7	100.00000	12.06645	
HCL Acid (12.6%-17.5%)	J.S. Well Services, LLC	Bulk Acid	Water	7732-18-5	87.40000	0.13362	
WFRA-405	J.S. Well Services, LLC	Friction Reducer	Hydrogen Chloride	7647-01-0	17.50000	0.03107	
			2-Propenoic acid, polymer with propenamide	29003-06-9	30.00000	0.01667	
			hydrated light distillate (petroleum)	64742-47-8	30.00000	0.01342	
LGC-15	J.S. Well Services, LLC	Gelling Agents	Guar Gum	9000-30-0	50.00000	0.01318	
			Petroleum Distillates	64742-47-8	60.00000	0.01249	
			Suspending agent (solid)	14808-60-7	3.00000	0.00202	
			Surfactant	68439-51-0	3.00000	0.00079	

Product Name	Manufacturer	Chemical Name	Product Code	Concentration	MSDS Number
Bioclear 2000	U.S. Well Services, LLC	Anti-Bacterial Agent			
		2,2-dibromo-3-nitropropionamide	10222-01-2	20.00000	0.00401
		Deionized Water	7732-18-5	28.00000	0.00229
SI-1200s	U.S. Well Services, LLC	Scale Inhibitor	Proprietary	10.00000	0.00122
AP One	U.S. Well Services, LLC	Gel Breakers			
		Ammonium Persulfate	7727-54-0	100.00000	0.00041
SI-1200	U.S. Well Services, LLC	Scale Inhibitor			
		Ethylene Glycol	107-21-1	40.00000	0.00031
		Proprietary Scale Inhibitor	Proprietary	10.00000	0.00008
AI-303	U.S. Well Services, LLC	Acid Corrosion Inhibitors			
		Ethylene glycol	107-21-1	40.00000	0.00005
		Formic acid	64-18-6	20.00000	0.00002
		Cinnamaldehyde	104-55-2	20.00000	0.00002
		Butyl cellosolve	111-76-2	20.00000	0.00001
		Polyether	60828-78-6	10.00000	0.00001
		Acetophenone,thiourea,formaldehyde polymer	68527-49-1	5.00000	0.00000

Ingredients shown above are subject to 29 CFR 1910.1200(i) and appear on Material Safety Data Sheets (MSDS). Ingredients shown below are Non-MSDS.

* Total Water Volume sources may include fresh water, produced water, and/or recycled water
 ** Information is based on the maximum potential for concentration and thus the total may be over 100%

Note: For Field Development Products (products that begin with FDP), MSDS level only information has been provided. Ingredient information for chemicals subject to 29 CFR 1910.1200(i) and Appendix D are obtained from suppliers Material Safety Data Sheets (MSDS)

LATITUDE 39°15'00" 1,312'

TO BOTTOM HOLE
LATITUDE 39°15'00"

LONGITUDE 80°52'00"

4,801'

LONGITUDE 80°52'30"

13,858' TO BOTTOM HOLE

Antero Resources Corporation
Well No. Cool Unit 1H

LINE	BEARING	DISTANCE
L1	S 77°58' E	1375.64'
L2	S 76°33' E	1804.51'
L3	S 75°04' E	1554.60'
L4	S 65°46' E	1596.34'
L5	S 64°01' E	1381.04'
L6	S 63°52' E	1636.75'
L7	S 60°37' E	1513.41'
L8	S 56°06' E	1345.06'
L9	S 51°10' E	1175.91'
L10	S 48°41' E	1080.76'
L11	S 44°24' E	1202.08'
L12	S 41°37' E	1125.94'
L13	S 32°54' E	947.63'
L14	S 28' E	1151.29'
L15	S 17°06' E	1113.08'
L16	S 08°23' E	1115.22'
L17	S 01°58' W	1414.85'
L18	S 05°17' W	1426.29'
L19	S 23°05' W	1806.45'
L20	S 42°21' W	1288.64'
L21	S 67°20' W	1416.97'
L22	S 73°44' W	1425.05'

- A - STANLEY WEBB D.B. 282 PG. 603 T.J. 15 PAR. 02.2 0.75 AC.
- B - STANLEY WEBB D.B. 172 PG. 322 T.J. 15 PAR. 02.3 4.03 AC.
- C - ELEAN WEBB D.B. 192 PG. 327 T.J. 15 PAR. 02.7 2.11 AC.
- D - ELEAN WEBB D.B. 192 PG. 327 T.J. 15 PAR. 02.4 0.47 AC.
- E - ROBERT F. HAROLD ET AL D.B. 249 PG. 494 T.J. 15 PAR. 02.9 1 AC.
- F - EDWARD WEBB ET AL D.B. 233 PG. 153 T.J. 15 PAR. 02.8 1.84 AC.
- G - DARLENE D. WIDENHILLER ET AL D.B. 246 PG. 540 T.J. 15 PAR. 02.2 0.12 AC.
- H - JAMES E. WEBB D.B. 273 PG. 443 T.J. 15 PAR. 02.13 0.26 AC.

AS DRILLED DATA:
WELL 1H TOP HOLE INFORMATION:
N: 271,365ft E: 1,609,229ft
LAT: 39°14'12.55" LON: 80°52'46.68"
BOTTOM HOLE INFORMATION:
N: 262,266ft E: 1,611,905ft
LAT: 39°12'43.03" LON: 80°52'10.91"
WEST VIRGINIA COORDINATE SYSTEM OF 1927 NORTH ZONE ZONE WAS DERIVED FROM MEASUREMENTS TAKEN WITH TRIMBLE GEOXT SUBMETER MAPPING GRADE GPS UNIT. PLAT ORIENTATION, CORNER, AND WELL REFERENCE TIE LINES ARE BASED ON GRID NORTH.

(NAD) 83 (UTM) ZONE 17 COORDS:
WELL 1H TOP HOLE INFORMATION:
N: 4,343,073m E: 510,403m
BOTTOM HOLE INFORMATION:
N: 4,340,315m E: 511,264m

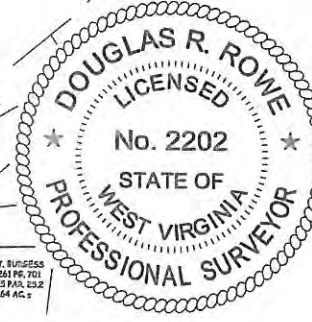

WV NORTH ZONE GRID NORTH

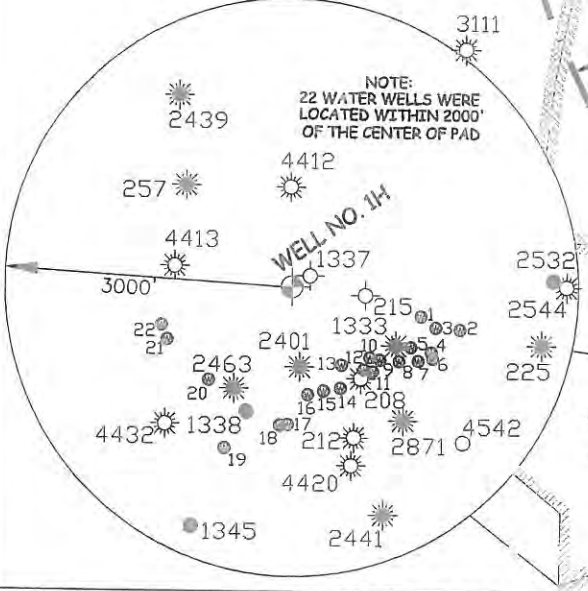

PAD LAYOUT

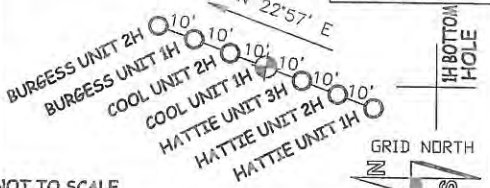

NOT TO SCALE

LEGEND

DOUGLAS R. ROWE P.S. 2202
DATE 01/29/19
OPERATOR'S WELL# COOL UNIT 1H
API WELL # 47 - 017 - 06833
STATE COUNTY PERMIT

- NOTE**
1. NO OCCUPIED DWELLINGS OR BUILDINGS TWO THOUSAND FIVE HUNDRED (2,500) SQUARE FEET OR LARGER USED TO HOUSE OR SHELTER DAIRY CATTLE OR POULTRY HUSBANDRY ARE LOCATED WITHIN SIX HUNDRED TWENTY-FIVE (625) FEET OF THE CENTER OF THE WELL PAD.
 2. TOP HOLE DATA SHOWN HEREON WAS PROVIDED BY ALLEGHENY SURVEYS, INC.
 3. AS DRILLED DATA WAS PROVIDED BY ANTERO RESOURCES CORPORATION.
 4. WLS IS NOT CERTIFYING THE DATA AND INFORMATION PROVIDED LISTED IN NOTES 2 AND 3, ONLY THE RELATIONSHIP TO THE DATA AND INFORMATION PROVIDED TO THE LEASE BOUNDARIES.
 5. WLS IS BY NO MEANS RESPONSIBLE FOR ANY ERRORS OR INACCURACIES WITH THE DATA AND INFORMATION THAT HAS BEEN PROVIDED.



STATE OF WEST VIRGINIA, DIVISION OF ENVIRONMENTAL PROTECTION, OFFICE OF OIL AND GAS

WILLOW LAND SURVEYING PLLC
220 MASONIC AVE. PENNSBORO WEST VIRGINIA 26415

I THE UNDERSIGNED, HEREBY CERTIFY THAT THIS PLAT IS CORRECT TO THE BEST OF MY KNOWLEDGE AND BELIEF AND SHOWS ALL THE INFORMATION REQUIRED BY LAW AND THE RULES ISSUED AND PRESCRIBED BY THE DEPARTMENT OF ENVIRONMENTAL PROTECTION.

STATE OF WEST VIRGINIA DEPARTMENT OF ENERGY DIVISION OF OIL AND GAS WELL TYPE: OIL GAS X LIQUID INJECTION WASTE DISPOSAL (IF "GAS") PRODUCTION X STORAGE DEEP SHALLOW X LOCATION: ELEVATION 1,095' AS BUILT WATERSHED NORTH FORK HUGHES RIVER QUADRANGLE PULLMAN 7.5' (TOP HOLE) OXFORD 7.5' (BOTTOM HOLE) DISTRICT CENTRAL COUNTY DODDRIDGE SURFACE OWNER STANLEY WEBB ET AL ACREAGE 59.18 ACRES +/- OIL & GAS ROYALTY OWNER RALPH LEGGETT ET UX; HAROLD BURGESS ET UX; HAROLD BURGESS ET UX; GUSSIE LEGGETT; SUE ELLEN ABERNATHY; S. BYRL ROSS ET UX; RUSSELL GRAY ET AL LEASE ACREAGE 75 ACRES +/-; 43.5 ACRES +/-; 29 ACRES +/-; 169 ACRES +/-; 65 ACRES +/-; 195 ACRES +/-; 225 ACRES +/- PROPOSED WORK: DRILL CONVERT DRILL DEEPER REDRILL FRACTURE OR STIMULATE PLUG OFF OLD FORMATION PERFORATE NEW FORMATION OTHER PHYSICAL CHANGE IN WELL (SPECIFY) AS DRILLED PLUG & ABANDON CLEAN OUT & REPLUG TARGET FORMATION MARCELLUS ESTIMATED DEPTH 6,591' TVD 16,227' MD

WELL OPERATOR ANTERO RESOURCES CORP. DESIGNATED AGENT DIANNA STAMPER
ADDRESS 1615 WYNKOOP STREET ADDRESS 5400 D BIG TYLER ROAD
FORM WW-6 DENVER, CO 80202 CHARLESTON, WV 25313