

WR-35
Rev. 8/23/13

State of West Virginia
Department of Environmental Protection - Office of Oil and Gas
Well Operator's Report of Well Work

API 47-017-06821 County Doddridge District West Union
 Quad West Union 7.5' Pad Name Middle Pad Field/Pool Name -----
 Farm name William Randall Lynch & Dixie Craig Well Number Goldsmith Unit 2H
 Operator (as registered with the OOG) Antero Resources Corporation
 Address 1615 Wynkoop Street City Denver State CO Zip 80202

As Drilled location NAD 83/UTM Attach an as-drilled plat, profile view, and deviation survey
 Top hole Northing 4352587.571m Easting 516693.493m
 Landing Point of Curve Northing 4352720.64m Easting 516772.33m
 Bottom Hole Northing 4355174.692m Easting 515708.939m

Elevation (ft) 843' GL Type of Well New Existing Type of Report Interim Final
 Permit Type Deviated Horizontal Horizontal 6A Vertical Depth Type Deep Shallow
 Type of Operation Convert Deepen Drill Plug Back Redrilling Rework Stimulate
 Well Type Brine Disposal CBM Gas Oil Secondary Recovery Solution Mining Storage Other _____
 Type of Completion Single Multiple Fluids Produced Brine Gas NGL Oil Other _____
 Drilled with Cable Rotary

Drilling Media Surface hole Air Mud Fresh Water Intermediate hole Air Mud Fresh Water Brine
 Production hole Air Mud Fresh Water Brine
 Mud Type(s) and Additive(s)
Air - Foam & 4% KCL
Mud - Polymer

Date permit issued 6/19/2017 Date drilling commenced 9/29/2017 Date drilling ceased 3/17/2018
 Date completion activities began 6/5/2018 Date completion activities ceased 10/1/2018
 Verbal plugging (Y/N) N/A Date permission granted N/A Granted by N/A

Please note: Operator is required to submit a plugging application within 5 days of verbal permission to plug

Freshwater depth(s) ft None Identified Open mine(s) (Y/N) depths No
 Salt water depth(s) ft None Identified Void(s) encountered (Y/N) depths No
 Coal depth(s) ft None Identified Cavern(s) encountered (Y/N) depths No
 Is coal being mined in area (Y/N) No

Reviewed by:

WR-35
Rev. 8/23/13

API 47-017 - 06821 Farm name William Randall Lynch & Dixie Craig Well number Goldsmith Unit 2H

CASING STRINGS	Hole Size	Casing Size	Depth	New or Used	Grade wt/ft	Basket Depth(s)	Did cement circulate (Y/ N) * Provide details below*
Conductor	24"	20"	112'	New	94#, H-40	N/A	Y
Surface	17-1/2"	13-3/8"	548'	New	54#, J-55	N/A	Y
Coal							
Intermediate 1	12-1/4"	9-5/8"	2620'	New	36#, J-55	N/A	Y
Intermediate 2							
Intermediate 3							
Production	8-3/4"/8-1/2"	5-1/2"	15769'	New	23#, HCP-110	N/A	Y
Tubing		2-3/8"	6569'		4.7#, P-110		
Packer type and depth set		N/A					

Comment Details _____

CEMENT DATA	Class/Type of Cement	Number of Sacks	Slurry wt (ppg)	Yield (ft ³ /sks)	Volume (ft ³)	Cement Top (MD)	WOC (hrs)
Conductor	Class A	204 sx	15.6	1.18	241	0'	8 Hrs.
Surface	Class A	445 sx	15.6	1.21	538	0'	8 Hrs.
Coal							
Intermediate 1	Class A	870 sx	15.6	1.22	1061	0'	8 Hrs.
Intermediate 2							
Intermediate 3							
Production	Class H	683 sx (Lead) 1470 sx (Tail)	13.5(Lead), 15.2 (Tail)	1.45 (Lead), 1.83 (Tail)	3671	-500' into Intermediate Casing	8 Hrs.
Tubing							

Drillers TD (ft) 15769' MD, 6419' TVD (BHL), 6434' (Deepest Point Drilled) Loggers TD (ft) 15769' MD

Deepest formation penetrated Marcellus Plug back to (ft) N/A

Plug back procedure N/A

Kick off depth (ft) 5800'

Check all wireline logs run caliper density deviated/directional induction
 neutron resistivity gamma ray temperature sonic

Well cored Yes No Conventional Sidewall Were cuttings collected Yes No

DESCRIBE THE CENTRALIZER PLACEMENT USED FOR EACH CASING STRING _____

Conductor - 0

Surface - 1 above guide shoe, 1 above insert float, 1 every 4th joint to surface

Intermediate - 1 above float joint, 1 above float collar, 1 every 4th joint to surface

Production - 1 above float joint, 1 below float collar, 1 every 3rd joint to top of cement

WAS WELL COMPLETED AS SHOT HOLE Yes No DETAILS _____

WAS WELL COMPLETED OPEN HOLE? Yes No DETAILS _____

WERE TRACERS USED Yes No TYPE OF TRACER(S) USED N/A

WR-35
Rev. 8/23/13

API 47- 017 - 06821 Farm name William Randall Lynch & Dixie Craig Well number Goldsmith Unit 2H

<u>PRODUCING FORMATION(S)</u>	<u>DEPTHS</u>		
<u>Marcellus</u>	<u>6355' (TOP)</u>	<u>TVD</u>	<u>6635' (TOP) MD</u>
_____	_____	_____	_____
_____	_____	_____	_____

Please insert additional pages as applicable.

GAS TEST Build up Drawdown Open Flow OIL TEST Flow Pump

SHUT-IN PRESSURE Surface 3600 psi Bottom Hole --- psi DURATION OF TEST --- hrs

OPEN FLOW Gas 13613.45 mcfpd Oil 139.21 bpd NGL --- bpd Water 662.17 bpd GAS MEASURED BY Estimated Orifice Pilot

LITHOLOGY/ FORMATION	TOP	BOTTOM	TOP	BOTTOM	DESCRIBE ROCK TYPE AND RECORD QUANTITY AND TYPE OF FLUID (FRESHWATER, BRINE, OIL, GAS, H ₂ S, ETC)
	DEPTH IN FT NAME TVD	DEPTH IN FT TVD	DEPTH IN FT MD	DEPTH IN FT MD	

***PLEASE SEE ATTACHED EXHIBIT 3**

Please insert additional pages as applicable.

Drilling Contractor Frontier Drilling LLC
Address 562 Spring Run Road City Pennsboro State WV Zip 26415

Logging Company Nine Energy Service
Address 125 Museum Rd City Washington State PA Zip 15301

Cementing Company C&J Energy Services
Address 1650 Hackers Creek City Lane Jew State WV Zip 26378

Stimulating Company Haliburton
Address 121 Champion Way City Canonsburg State PA Zip 15317

Please insert additional pages as applicable.

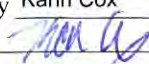
Completed by Karin Cox Telephone 303-357-6820
Signature  Title Permitting Agent Date 2/25/2019

Submittal of Hydraulic Fracturing Chemical Disclosure Information Attach copy of FRACFOCUS Registry

API 47-017-06821 Farm Name William Randall Lynch & Dixie Craig Well Number Goldsmith Unit 2H					
EXHIBIT 1					
Stage No.	Perforation Date	Perforated from MD ft.	Perforated to MD ft.	Number of Perforations	Formations
1	6/5/2018	15566.6	15666.1	60	Marcellus
2	7/16/2018	15369.278	15535.713	60	Marcellus
3	7/16/2018	15171.956	15338.391	60	Marcellus
4	7/17/2018	14974.634	15141.069	60	Marcellus
5	7/17/2018	14777.312	14943.747	60	Marcellus
6	7/18/2018	14579.99	14746.425	60	Marcellus
7	7/18/2018	14382.668	14549.103	60	Marcellus
8	7/19/2018	14185.346	14351.781	60	Marcellus
9	7/20/2018	13988.024	14154.459	60	Marcellus
10	7/20/2018	13790.702	13957.137	60	Marcellus
11	7/21/2018	13593.38	13759.815	60	Marcellus
12	7/21/2018	13396.058	13562.493	60	Marcellus
13	7/23/2018	13198.736	13365.171	60	Marcellus
14	7/23/2018	13001.414	13167.849	60	Marcellus
15	7/24/2018	12804.092	12970.527	60	Marcellus
16	7/24/2018	12606.77	12773.205	60	Marcellus
17	7/24/2018	12409.448	12575.883	60	Marcellus
18	7/25/2018	12212.126	12378.561	60	Marcellus
19	7/25/2018	12014.804	12181.239	60	Marcellus
20	7/26/2018	11817.482	11983.917	60	Marcellus
21	7/26/2018	11620.16	11786.595	60	Marcellus
22	7/26/2018	11422.838	11589.273	60	Marcellus
23	7/27/2018	11225.516	11391.951	60	Marcellus
24	7/28/2018	11028.194	11194.629	60	Marcellus
25	7/28/2018	10830.872	10997.307	60	Marcellus
26	7/28/2018	10633.55	10799.985	60	Marcellus
27	7/29/2018	10436.228	10602.663	60	Marcellus
28	7/29/2018	10238.906	10405.341	60	Marcellus
29	7/30/2018	10041.584	10208.019	60	Marcellus
30	7/30/2018	9844.262	10010.697	60	Marcellus
31	7/30/2018	9646.94	9813.375	60	Marcellus
32	7/31/2018	9449.618	9616.053	60	Marcellus
33	8/1/2018	9252.296	9418.731	60	Marcellus
34	8/2/2018	9054.974	9221.409	60	Marcellus
35	8/2/2018	8857.652	9024.087	60	Marcellus
36	8/3/2018	8660.33	8826.765	60	Marcellus
37	8/3/2018	8463.008	8629.443	60	Marcellus
38	8/3/2018	8265.686	8432.121	60	Marcellus
39	8/4/2018	8068.364	8234.799	60	Marcellus
40	8/4/2018	7871.042	8037.477	60	Marcellus
41	8/5/2018	7673.72	7840.155	60	Marcellus
42	8/5/2018	7476.398	7642.833	60	Marcellus
43	8/6/2018	7279.076	7445.511	60	Marcellus
44	8/6/2018	7081.754	7248.189	60	Marcellus
45	8/6/2018	6884.432	7050.867	60	Marcellus
46	8/7/2018	6687.11	6853.545	60	Marcellus

API 47-017-06821 Farm Name William Randall Lynch & Dixie Craig Well Number Goldsmith Unit 2H

EXHIBIT 2

Stage No.	Stimulations Date	Avg Pump Rate	Avg Treatment Pressure (PSI)	Max Breakdown Pressure (PSI)	ISIP (PSI)	Amount of Proppant (lbs)	Amount of Water (bbls)	Amount of Nitrogen/ other (units)
1	6/5/2018	74.54	7401	5341	4236	267130	6399.452	N/A
2	7/16/2018	75.39	6998	5400	3829	407860	8633.119	N/A
3	7/16/2018	74.86	7299	5167	3580	410000	8289.595	N/A
4	7/17/2018	75.2	7144	5102	3698	412080	8683.81	N/A
5	7/17/2018	77.56	7739	5436	3960	419500	8430.81	N/A
6	7/18/2018	77.8	7366	6112	3714	405940	8215.976	N/A
7	7/18/2018	73.73	7231	5551	5179	410060	8410.643	N/A
8	7/19/2018	76.8	7262	5114	4659	406280	8226	N/A
9	7/20/2018	72.04	7739	5933	4435	416460	8508.857	N/A
10	7/20/2018	73.3	7351	5315	6915	409880	8555.571	N/A
11	7/21/2018	72.04	7092	5625	3621	407700	8133.643	N/A
12	7/21/2018	70.3	7044	5628	4937	409200	8152.714	N/A
13	7/23/2018	69.34	6801	5477	4849	422620	8256.929	N/A
14	7/23/2018	68.6	6577	4608	4911	405400	8375.357	N/A
15	7/24/2018	73.2	6906	6642	3980	403180	8165.81	N/A
16	7/24/2018	77.2	7264	5750	3744	407960	9281.524	N/A
17	7/24/2018	74	6792	2578	5195	406620	8312.833	N/A
18	7/25/2018	74.1	6754	5200	4804	401720	8266.667	N/A
19	7/25/2018	71.08	6571	5314	4841	401800	8104.452	N/A
20	7/26/2018	72.46	7219	4928	4362	403400	8214.5	N/A
21	7/26/2018	69	7360	5999	5055	401200	8421.881	N/A
22	7/26/2018	68.12	7311	6018	3741	399420	8070.762	N/A
23	7/27/2018	66	7353	5860	4120	406840	8575.833	N/A
24	7/28/2018	70.19	7270	5456	4608	411300	8432.238	N/A
25	7/28/2018	68.7	7261	5672	3513	406240	8526.476	N/A
26	7/28/2018	72.87	6731	5408	4976	412980	8129.5	N/A
27	7/29/2018	70.33	6348	5447	4648	408280	8106.357	N/A
28	7/29/2018	72	6585	5649	4989	406280	8090.214	N/A
29	7/30/2018	72.15	6698	5864	4295	404620	8090.333	N/A
30	7/30/2018	78.8	7010	5948	5057	409340	8188.69	N/A
31	7/30/2018	77.8	6892	5833	5138	402000	8061.786	N/A
32	7/31/2018	77.59	7186	5876	4516	405740	7874.833	N/A
33	8/1/2018	72.6	7307	5834	3959	408360	9514.524	N/A
34	8/2/2018	69.5	7736	5685	5421	360220	10083.67	N/A
35	8/2/2018	71.51	7347	5582	4560	403400	9427.476	N/A
36	8/3/2018	69.64	7002	5804	3887	398220	8021.429	N/A
37	8/3/2018	67.08	7697	6363	4210	403620	9526.786	N/A
38	8/3/2018	74.92	7020	5774	5173	403880	8031.048	N/A
39	8/4/2018	75.02	6044	6044	5113	397820	7833.786	N/A
40	8/4/2018	69.14	7351	5948	3881	404420	11747.4	N/A
41	8/5/2018	74.37	7328	5656	3743	406500	8487.357	N/A
42	8/5/2018	75.51	6764	5875	4945	408960	8440.048	N/A
43	8/6/2018	74.66	6758	5821	4616	408160	8142.095	N/A
44	8/6/2018	71.89	6371	5854	3690	404820	8094.905	N/A
45	8/6/2018	76.98	6602	5755	6182	409740	8250.595	N/A
46	8/7/2018	76.29	6989	5764	4402	399360	8045.238	N/A
	AVG=	73	7,062	5,587	4,519	18,526,510	387,834	TOTAL

API 47-017-06821 Farm Name William Randall Lynch & Dixie Craig Well Number Goldsmith Unit 2H

EXHIBIT 3

LITHOLOGY/ FORMATION	TOP DEPTH (TVD)	BOTTOM DEPTH (TVD)	TOP DEPTH (MD)	BOTTOM DEPTH (MD)
	From Surface	From Surface	From Surface	From Surface
Sandstone	0	177	0	177
Sandstone tr coal	177	217	177	217
Sandy shale	217	232	217	232
Calcareous Shale	232	319	232	319
Sandstone	319	373	319	373
Calcareous Shale	373	1,065	373	1,065
Silty Sandstone	1,065	1,137	1,065	1,137
Silty shale	1,137	1,287	1,137	1,287
Sandy Shale	1,287	1,357	1,287	1,357
Shale	1,357	1,639	1,357	1,639
Big Lime	1,639	2,188	1,639	2,188
Fifty Foot Sandstone	2,188	2,440	2,188	2,440
Gordon	2,440	2,633	2,440	2,633
Fifth Sandstone	2,633	2,694	2,633	2,695
Bayard	2,694	3,482	2,695	3,493
Speechley	3,482	3,795	3,493	3,813
Balltown	3,795	4,276	3,813	4,306
Bradford	4,276	4,715	4,306	4,755
Benson	4,715	4,923	4,755	5,007
Alexander	4,923	5,977	5,007	6,049
Sycamore	5,977	6,156	6,049	6,262
Middlesex	6,156	6,285	6,262	6,458
Burkett	6,285	6,315	6,458	6,519
Tully	6,315	6,355	6,519	6,635
Marcellus	6,355	NA	6,635	NA

*Please note Antero determines formation tops based on mud logs that are only run on one well on a multi-well pad. The measured depth (MD) data on subsequent wells may be slightly different due to the well's unique departure.

Hydraulic Fracturing Fluid Product Component Information Disclosure

Job Start Date:	7/16/2018
Job End Date:	8/7/2018
State:	West Virginia
County:	Doddridge
API Number:	47-017-06821-00-00
Operator Name:	Antero Resources Corporation
Well Name and Number:	Goldsmith 2H
Latitude:	39.32245300
Longitude:	-80.80650600
Datum:	NAD83
Federal Well:	NO
Indian Well:	NO
True Vertical Depth:	6,687
Total Base Water Volume (gal):	16,672,248
Total Base Non Water Volume:	0



Hydraulic Fracturing Fluid Composition:

Trade Name	Supplier	Purpose	Ingredients	Chemical Abstract Service Number (CAS #)	Maximum Ingredient Concentration in Additive (% by mass)**	Maximum Ingredient Concentration in HF Fluid (% by mass)**	Comments
Fresh Water	Operator	Base Fluid					
			Water	7732-18-5	100.00000	88.09789	Density = 8.340
Ingredients	Listed Above	Listed Above					
			Water	7732-18-5	100.00000	0.11746	

HYDROCHLORIC ACID	Halliburton	Solvent							
					Listed Below				
HAI-OS ACID INHIBITOR	Halliburton	Corrosion Inhibitor							
					Listed Below				
EXCELERATE PS-2	Halliburton	Friction Reducer							
					Listed Below				
SAND-PREMIUM WHITE-40/70, BULK	Halliburton	Proppant							
					Listed Below				
SP BREAKER	Halliburton	Breaker							
					Listed Below				
SCALECHEK LP-70	Halliburton	Scale Inhibitor							
					Listed Below				
MC B-8614	Halliburton	Biocide							
					Listed Below				
WG-36 GELLING AGENT	Halliburton	Gelling Agent							
					Listed Below				

SAND-COMMON WHITE - 100 MESH, 3307 LB BAG	Halliburton	Proppant											
					Listed Below								
Items above are Trade Names with the exception of Base Water. Items below are the individual ingredients.													
			Crystalline silica, quartz		14808-60-7	100.00000	11.73804						
			Guar gum		9000-30-0	100.00000	0.01840						
			Inorganic salt		Proprietary	30.00000	0.01597						
			Acrylamide acrylate polymer		Proprietary	30.00000	0.01597						Denise Tuck, Halliburton, 3000 N. Sam Houston Pkwy E., Houston, TX 77032, 281-871-6226
			Hydrotreated light petroleum distillate		64742-47-8	30.00000	0.01597						
			Hydrochloric acid		7647-01-0	15.00000	0.01030						
			Ethylene glycol		107-21-1	60.00000	0.00599						
			Glutaraldehyde		111-30-8	30.00000	0.00393						
			Teimer		Proprietary	10.00000	0.00100						
			Quaternary ammonium compounds, benzyl-C12-16-alkyldimethyl chlorides		68424-85-1	5.00000	0.00066						
			Sodium persulfate		7775-27-1	100.00000	0.00057						
			Ethanol		64-17-5	1.00000	0.00013						
			Sodium polyacrylate		9003-04-7	1.00000	0.00010						
			Methanol		67-56-1	60.00000	0.00009						
			Modified thiourea polymer		Proprietary	30.00000	0.00004						
			Ethoxylated alcohols		Proprietary	30.00000	0.00004						
			Fatty acids, tall oil		Proprietary	30.00000	0.00004						
			Olefins		Proprietary	5.00000	0.00001						
			Phosphoric acid		7664-38-2	0.10000	0.00001						
			Propargyl alcohol		107-19-7	10.00000	0.00001						

7,562' to Bottom Hole

4,255' to Top Hole

BTM HOLE LATITUDE 39 - 22 - 30
TOP HOLE LATITUDE 39 - 20 - 00

LONGITUDE 80 - 47 - 30

3,902' to Top Hole

10,532' to Bottom Hole

Ralph McCutchan II Chipps
Revocable Living Trust
260/379 132.61 Ac.

TM/Par	Bk / Pg	Acres	Owner(s)	
1	6/2	214 / 279	32.19	William Randall Lynch & Dixie Janet Craig
2	6/2.5	253 / 222	8.66	
3	6/2.8	305 / 419	2.68	
4	6/2.6	266 / 36	3.52	Dominion Field Services, Inc.
5	6/1.3	305 / 416	4.68	
6	6/2.4	163 / 44	14.98	Equitrans, L.P.
7	6/2.3	197 / 659	4.15	Carol & Alfreda Painter
8	4/28	WB 28/314	357.75	John Paul Strickling, et al
9	3/18.4	286 / 473	16.58	John & Jennifer Layton
10	3/18	228 / 723	6.84	Thomas K. Jr. / Penny A. Porter
11	3/18.2	232 / 135	6.00	David J. & Debra S. Smith
12	3/23	WB 47/723	3.00	Connie Ruckman
13	3/17.1	261 / 508	9.90	Michael A. Montgomery
14	3/16	AP 40/512	26.00	Doris F. Wisman
15	3/19.1	265 / 582	7.00	Glen H. Montgomery, et al
16	3/19	WB 47/333	21.64	Skylar Ora & Clifford Warren Montgomery, et al
17	3/10	259 / 310	75.00	James W. & Lynda S. Beatty
18	3/10.1	259 / 312	0.25	
19	3/9	239 / 114	7.39	Mary Hill Frame
20	3/5	170 / 587	53.00	Dale Bradford & Dewight R. Husk
21	3/8	202 / 8	49.52	Joseph L. & Marla McConnell
22	3/8.1	286 / 218	4.48	Charles A. & Ronda Gay Ford

**Antero Resources
Well No. Goldsmith
Unit 2H
As-Drilled Plat
Antero Resources
Corporation**

03/08/2019

Legend

- ⊙ Proposed gas well
- ⊗ Found corner, as noted
- ⊙ Existing Well, as noted
- Creek or Drain
- Existing Road
- Surface boundary (approx.)
- Interior surface tracts (approx.)



Bearing	Dist.
L1 S 82°46' W	559.8'
L2 N 12°19' E	488.8'
L3 N 27°33' E	832.5'
L4 S 32°32' W	624.1'

Note: It appears 23 water wells were found within 2000' of proposed well. No occupied dwellings or buildings 2,500 square feet or larger used to house or shelter dairy cattle or poultry husbandry are located within 625' of the center of the well pad.

Notes:
West Virginia Coordinate System of 1927, North Zone based upon Differential GPS Measurements.
Well No. Goldsmith Unit 2H Top Hole coordinates are
N: 302,241.67' Latitude: 39°19'20.83"
E: 1,630,393.47' Longitude: 80°48'23.42"
Bottom Hole coordinates are
N: 310,785.35' Latitude: 39°20'44.82"
E: 1,627,304.27' Longitude: 80°49'04.32"
UTM Zone 17, NAD 1983
Top Hole Coordinates Bottom Hole Coordinates
N: 4,352,587.571m N: 4,355,174.692m
E: 516,693.493m E: 515,708.939m
Plat orientation and corner and well references are based upon the grid north meridian.
Well location references are based upon the magnetic meridian.

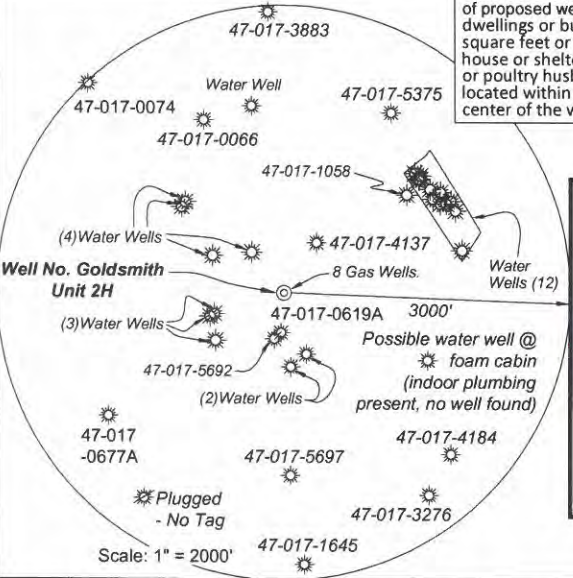

I, the undersigned, hereby certify that this plat is correct to the best of my knowledge and belief and shows all the information required by law and the rules issued and prescribed by the Department of Environmental Protection.

Bradley D. Miller
Bradley D. Miller, P.S. 2167

Wellhead Layout
Detail Not to Scale

FILE NO: 201-30-WU-14
DRAWING NO: Goldsmith 2H As-Drilled Well Plat
SCALE: 1" = 1200'
MINIMUM DEGREE OF ACCURACY: Submeter
PROVEN SOURCE OF ELEVATION: CORS, Marietta, OH

STATE OF WEST VIRGINIA
DEPARTMENT OF ENVIRONMENTAL PROTECTION
OIL AND GAS DIVISION

DATE: January 16 2019
Operator's Well No. Goldsmith Unit 2H
API WELL NO
47 - 017 - 06821
STATE COUNTY PERMIT

WELL TYPE: OIL GAS LIQUID INJECTION WASTE DISPOSAL
(IF GAS) PRODUCTION: STORAGE DEEP SHALLOW
LOCATION: ELEVATION: As-Built Grade - 843' WATERSHED: Headwaters Middle Island Creek QUADRANGLE: West Union
DISTRICT: West Union WV Division of Natural Resources; William Mark Smith; Black Gold Group, LTD; William Randall Lynch & Dixie Craig; COUNTY: Doddridge 20.49; 56.07; 82.21; 290; 150; 168; 61.361; 105
SURFACE OWNER: William Randall Lynch & Dixie Craig ACREAGE: 32.19
ROYALTY OWNER: Clarence W. Mutschelknaus, et ux; James Douglas White; Lewis Maxwell, et al LEASE NO: ACREAGE: 82.21; 290; 150; 168; 61.361; 105
PROPOSED WORK: DRILL CONVERT DRILL DEEPER FRACTURE OR STIMULATE PLUG OFF OLD FORMATION
 PERFORATE NEW FORMATION OTHER PHYSICAL CHANGE IN WELL (SPECIFY) As-Drilled 6,419' TVD
 PLUG AND ABANDON CLEAN OUT AND REPLUG TARGET FORMATION: Marcellus Shale ESTIMATED DEPTH: 15,769' MD

WELL OPERATOR: Antero Resources Corporation DESIGNATED AGENT: Dianna Stamper - CT Corporation System
ADDRESS: 1615 Wynkoop Street ADDRESS: 5400 D Big Tyler Road
Denver, CO 80202 Charleston, WV 25313