

Note: It appears 13 water wells, 7 springs and a pond were found within 2000' of proposed well. No occupied dwellings and no buildings 2,500 square feet or larger used to house or shelter dairy cattle or poultry husbandry are located within 625' of the center of the well pad. See well location references for details.

Denotes Location of Well on United States Topographic Maps

TM/Par	Owner	Bk/Pg	Acres
1 3/17	Antero Resources Corp.	349/553	25.90
2 3/17.1	Antero Resources Corp.	358/562	9.90
3 3/21.1	Charles & Carol Cottrill	256/479	3.00
4 3/21	Addie Marie Leadmon	250/84	19.84
5 7/1	Mason Memorial Park	96/487	6.54
6 7/4	Robert P. Holden & Sherri M. Bailey	301/464	6.14
7 7/21	Elizabeth Anne Spencer, et al	AP 41/583	14.00
8 29/22	Imogen E. Lynch	WB 40/123	Lot 180
9 29/23	Imogen E. Lynch	WB 40/123	Lot 179
10 29/24	James L. & Martha Williams	182/265	Lot 178
11 29/25	James L. & Martha Williams	160/443	Lot 177
12 29/26	James L. & Martha Williams	182/265	Lot 176
13 29/72	Joseph L. & Marla B. McConnell	301/507	Lot 27
14 29/73	James & Charlotte Marsden	266/195	Lot 28
15 29/74	James & Charlotte Marsden	266/195	Lot 29
16 7/33	Freeman Cemetery	79/39	1.90
17 7/3.1	Masonic Memorial Park, Inc.	237/371	8.78
18 7/3.2	Andrew E. & Loria A. Lett	297/311	12.00
19 35/2,31-35	Rebecca H. Hicholson	248/185	2.29 Total
20 35/3,90-95	Barbara Travis & Sharon Weekley	WB 62/674	1.74 Total
21 35/6,13,36,37	Brandon Rogers	264/421	2.31 Total
22 11/2	Sharon K. & Paul D. Weekley	220/499	12.00
23 11/3	Genevieve V. Freeman	228/15	16.50

Bearing	Dist.
L1 S 75°40' E	1061.1'
L2 N 21°14' E	1163.3'
L3 N 81°39' E	1369.9'
L4 S 67°51' W	524.7'
L5 S 49°56' W	690.4'

Notes:  
Well No. Michels Unit 2H  
UTM Zone 17, NAD 1927  
Top Hole Coordinates  
N: 14,283,414.60'  
E: 1,695,335.41'  
Point of Entry Coordinates  
N: 14,283,635.98'  
E: 1,696,686.78'  
Bottom Hole Coordinates  
N: 14,272,384.72'  
E: 1,701,388.02'

- Legend
- Proposed gas well
  - Found corner, as noted
  - Existing Well, as noted
  - Creek or Drain
  - Existing Road
  - Surface boundary (approx.)
  - Interior surface tracts (approx.)

I, the undersigned, hereby certify that this plat is correct to the best of my knowledge and belief and shows all the information required by law and the rules issued and prescribed by the Department of Environmental Protection.

*Kenneth J. Plum*  
Kenneth J. Plum, P.S. 2216

- Leases
- A. Champion Agate Co., Inc. Lease
  - B. Champion Agate Co., Inc. Lease
  - C. Andrew Lett, et ux Lease
  - D. Champion Agate Co., Inc. Lease
  - E. Claude L. Smith, et ux Lease

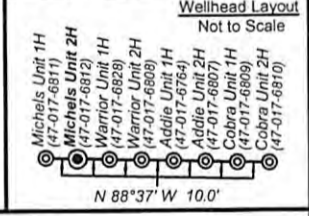
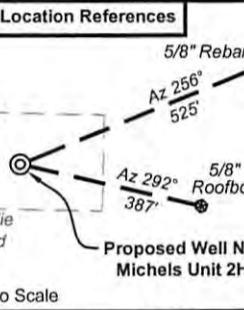

FILE NO: 53-30-WU-15  
DRAWING NO: Michels 2H Well Plat  
SCALE: 1" = 1500'  
MINIMUM DEGREE OF ACCURACY: Submeter  
PROVEN SOURCE OF ELEVATION: WVDOT, Harrisville, WV

STATE OF WEST VIRGINIA  
DEPARTMENT OF ENVIRONMENTAL PROTECTION  
OIL AND GAS DIVISION

DATE: May 17 20 17  
OPERATOR'S WELL NO. Michels Unit 2H  
API WELL NO. 47-017-06812  
STATE COUNTY PERMIT

WELL TYPE:  OIL  GAS  LIQUID INJECTION  WASTE DISPOSAL  
(IF GAS) PRODUCTION:  STORAGE  DEEP  SHALLOW  
LOCATION: ELEVATION: Proposed 890' Existing 895' WATERSHED: Headwaters Middle Island Creek QUADRANGLE: West Union  
DISTRICT: West Union COUNTY: Doddridge  
SURFACE OWNER: Antero Resources Corp. COUNTY: Doddridge  
ROYALTY OWNER: J.C. Smith, Agent for Jacob Smith Estate; Ida F. Ford (2); Joseph B. Hammond; LEASE NO: ACREAGE: 58.70; 112; 82.21  
PROPOSED WORK:  DRILL  CONVERT  DRILL DEEPER  FRACTURE OR STIMULATE  PLUG OFF OLD FORMATION  
 PERFORATE NEW FORMATION  OTHER PHYSICAL CHANGE IN WELL (SPECIFY) Modify Bottom Hole Location  
 PLUG AND ABANDON  CLEAN OUT AND REPLUG TARGET FORMATION: Marcellus Shale ESTIMATED DEPTH: 19,400' MD

WELL OPERATOR: Antero Resources Corporation DESIGNATED AGENT: Dianna Stamper - CT Corporation System  
ADDRESS: 1615 Wynkoop Street ADDRESS: 5400 D Big Tyler Road  
Denver, CO 80202 Charleston, WV 25313