

Antero Resources
Well No. Addie Unit 2H
Antero Resources Corporation

Leases

A J.C. Smith, Agent for Jacob Smith Estate
 B R.E. McCabe, Jr. Trustee & Brooke F. McCabe Jr., Agent

Notes:
 Well No. Addie Unit 2H
 UTM Zone 17, NAD 1927
 Top Hole Coordinates
 N: 14,283,414.31'
 E: 1,695,375.39'
 Point of Entry Coordinates
 N: 14,283,733.23'
 E: 1,696,662.72'
 Bottom Hole Coordinates
 N: 14,291,088.87'
 E: 1,693,697.62'

Note: It appears 13 water wells, 7 springs and a pond were found within 2000' of proposed well. No occupied dwellings or buildings 2,500 square feet or larger used to house or shelter dairy cattle or poultry husbandry are located within 625' of the center of the well pad.

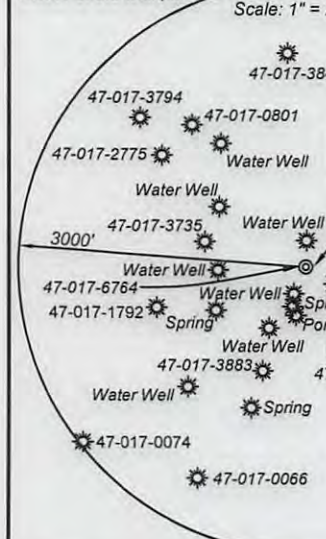

| ID | TM/Par | Owner | Bk / Pg | Acres |
|----|--------|-----------------------------|-----------|-------|
| 1 | 3/17.1 | Antero Resources Corp. | 358/562 | 9.90 |
| 2 | 3/21.1 | Charles & Carol Cottrill | 256/479 | 3.00 |
| 3 | 3/17 | Antero Resources Corp. | 349/553 | 25.90 |
| 4 | 3/6 | Thomas R. Prock | 252/308 | 25.00 |
| 5 | 3/24 | Charles L. & Carol Cottrill | 256/474 | 2.45 |
| 6 | 1/7 | Perry Gains & Aaron Gain | 329/229 | 20.0 |
| 7 | 23/5 | Richard/Lisa Hendrickson | 334/209 | 0.25 |
| 8 | 3/21 | Addie Marie Leadmon | 250/84 | 19.84 |
| 9 | 1/10 | Judith Ann Bagley | WB 32/342 | 10.09 |
| 10 | 23/3.1 | Kathryn McNulty | 323/206 | 50.18 |

7,719' to Bottom Hole

4,169' to Top Hole

LATITUDE 39 - 22 - 30

LONGITUDE 80 - 47 - 30

7,380' to Bottom Hole

15,064' to Top Hole

Denotes Location of Well on United States Topographic Maps

Well Location References

Not to Scale

Az 254° 48' 5/8" Rebar

Az 293° 34' 5/8" Roofbolt

Proposed Well No. Addie Unit 2H

Wellhead Layout

Michels Unit 1H
 Michels Unit 2H
 Warrior Unit 1H
 Warrior Unit 2H
 Addie Unit 1H (47-017-6764)
 Proposed Addie Unit 2H
 Addie Unit 2H
 Cobra Unit 1H
 Cobra Unit 2H

Not to Scale S 88°37' E 10.0'

Notes:
 West Virginia Coordinate System of 1927, North Zone based upon Differential GPS Measurements
 Well No. Addie Unit 2H Top Hole coordinates are
 N: 306,253.13' Latitude: 39°20'00.52"
 E: 1,630,698.01' Longitude: 80°48'20.29"
 Bottom Hole coordinates are
 N: 313,937.30' Latitude: 39°21'16.24"
 E: 1,629,147.63' Longitude: 80°48'41.45"
 UTM Zone 17, NAD 1983
 Top Hole Coordinates Bottom Hole Coordinates
 N: 4,353,811.220m N: 4,356,144.326m
 E: 516,765.881m E: 516,254.497m
 Plat orientation and corner and well references are based upon the grid north meridian.
 Well location references are based upon the magnetic meridian.

| Bearing | Dist. |
|---------------|---------|
| L1 S 65°59' W | 488.3' |
| L2 S 47°39' W | 661.0' |
| L3 S 76°08' E | 1100.1' |
| L4 N 65°39' W | 981.5' |
| L5 N 77°02' E | 1326.7' |

Legend

- Proposed gas well
- Monument, as noted
- Existing Well, as noted
- Creek or Drain
- Existing Road
- Surface boundary (approx.)
- Interior surface tracts (approx.)



I, the undersigned, hereby certify that this plat is correct to the best of my knowledge and belief and shows all the information required by law and the rules issued and prescribed by the Department of Environmental Protection.

Kenneth J. Plum

Kenneth J. Plum, P.S. 2216



FILE NO: 55-30-WU-15
 DRAWING NO: Addie 2H Well Plat Extend
 SCALE: 1" = 1200'
 MINIMUM DEGREE OF ACCURACY: Submeter
 PROVEN SOURCE OF ELEVATION: WVDOT, Harrisville, WV

STATE OF WEST VIRGINIA
 DEPARTMENT OF ENVIRONMENTAL PROTECTION
OIL AND GAS DIVISION

DATE: February 6 20 17
 OPERATOR'S WELL NO. Addie Unit 2H
 API WELL NO
 47 - 017 - 06807
 STATE COUNTY PERMIT

WELL TYPE: OIL GAS LIQUID INJECTION WASTE DISPOSAL
 (IF GAS) PRODUCTION: STORAGE DEEP SHALLOW

LOCATION: ELEVATION: Existing 895' Proposed 890' WATERSHED: Headwaters Middle Island Creek QUADRANGLE: West Union

DISTRICT: West Union LARRY P. SMITH; S.A. SMITH & C. BURKE MORRIS Virginia Dotson, et vir; Carolyn Sue Gaston COUNTY: Doddridge

SURFACE OWNER: Antero Resources Corp. J.C. Smith, Agent for Jacob Smith Estate; Union National Bank of WV ACREAGE: 25.9 20; 25; 20; 53

ROYALTY OWNER: R. E. McCabe, Jr. Trustee & Brooke F. McCabe, Jr. Agent; Corma Buck LEASE NO: ACREAGE: 290; 75; 20; 28.1

PROPOSED WORK: DRILL CONVERT DRILL DEEPER FRACTURE OR STIMULATE PLUG OFF OLD FORMATION
 PERFORATE NEW FORMATION OTHER FORMATION CHANGE IN WELL (SPECIFY) _____

PLUG AND ABANDON CLEAN OUT AND REPLUG TARGET FORMATION: Marcellus Shale ESTIMATED DEPTH: 6,900' TVD 15,000' MD

WELL OPERATOR: Antero Resources Corporation DESIGNATED AGENT: Dianna Stamper - CT Corporation System
 ADDRESS: 1615 Wynkoop Street ADDRESS: 5400 D Big Tyler Road
 Denver, CO 80202 Charleston, WV 25313

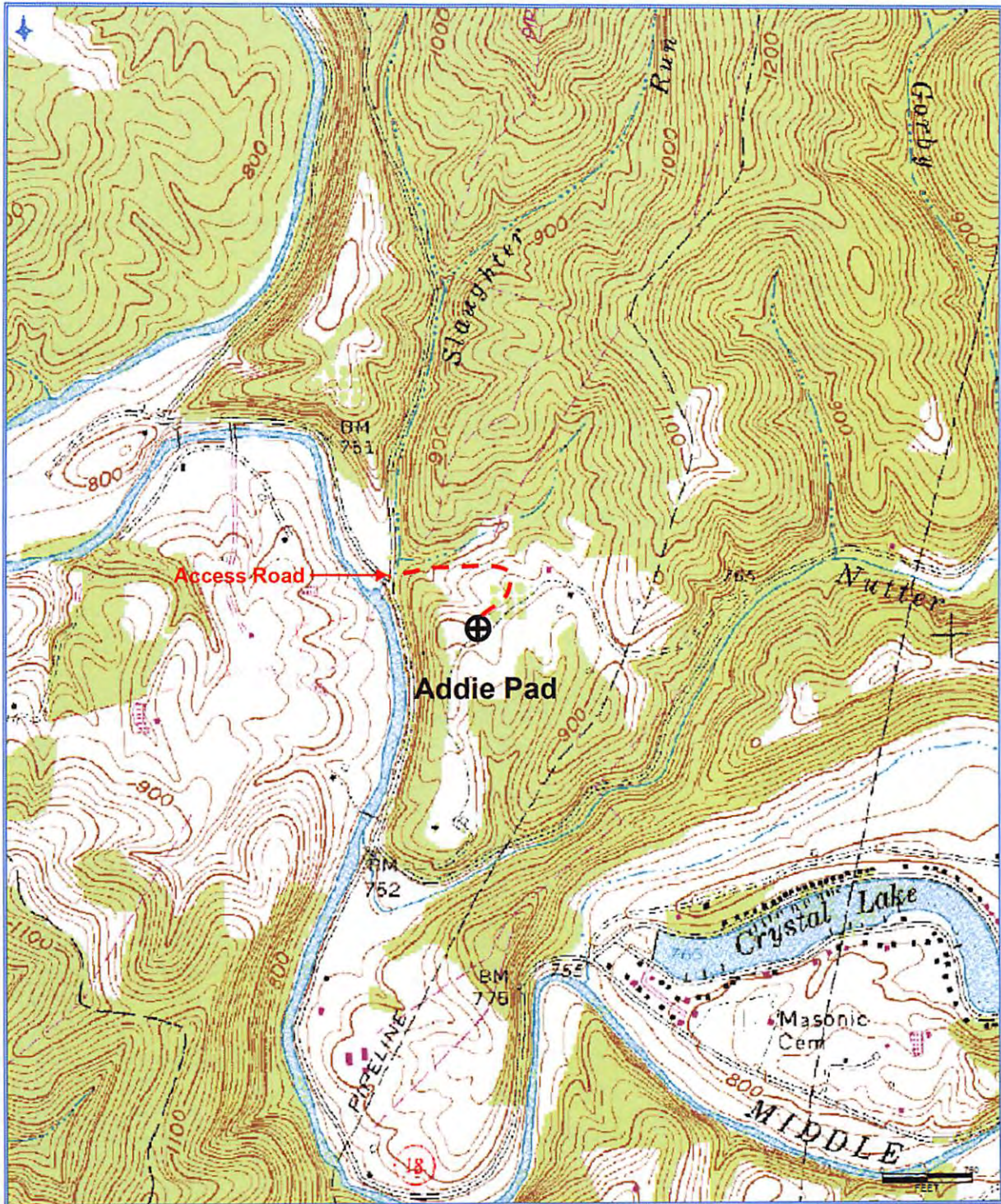

Antero Resources Corporation
Appalachian Basin
Addie Unit 2H
Doddridge County
Quadrangle: West Union
Watershed: Middle Island Creek
District: West Union
Date: 11-3-2015

Received
Office of Oil & Gas
FEB 13 2017