

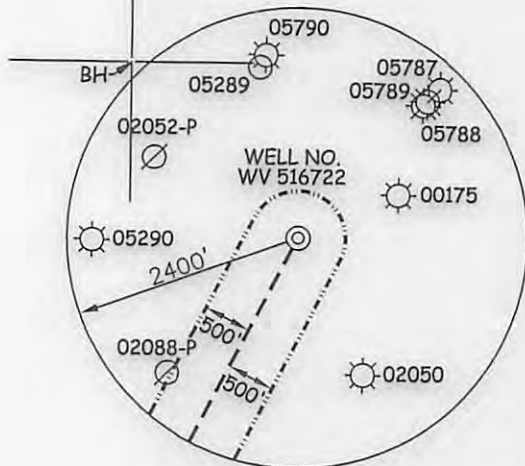

**OXF387**  
**WV 516722**  
**EQT PRODUCTION COMPANY**

(S.P.C. NORTH ZONE) (UTM(M) ZONE 17 NORTH)  
 NAD'27 S.P.C.(FT) N. 235,830.64 E. 1,629,918.43  
 NAD'27 GEO. LAT-(N) 39.140115 LONG-(W) 80.804776  
 NAD'83 UTM (M) N. 4,332,353.20 E. 516,886.38  
**LANDING POINT**  
 NAD'27 S.P.C.(FT) N. 231,389.79 E. 1,627,807.88  
 NAD'27 GEO. LAT-(N) 39.127839 LONG-(W) 80.811988  
 NAD'83 UTM (M) N. 4,330,989.58 E. 516,265.99  
**BOTTOM HOLE**  
 NAD'27 S.P.C.(FT) N. 228,806.00 E. 1,628,691.68  
 NAD'27 GEO. LAT-(N) 39.120781 LONG-(W) 80.808740  
 NAD'83 UTM (M) N. 4,330,206.95 E. 516,548.37



**NOTES ON SURVEY**

1. NO WATER WELLS WERE FOUND WITHIN 250' OF PROPOSED GAS WELL. NO AGRICULTURAL BUILDINGS ≥ 2500 SQ. FT. OR DWELLINGS WERE FOUND WITHIN 625' OF THE CENTER OF PROPOSED WELL PAD.
2. WELL SPOT CIRCLE & TOPO MARK SCALE IS 1"=2000'.

**ROYALTY OWNERS**

HAUGHT FAMILY TRUST ET AL	402 AC±	LEASE NO. 105953
MICHAEL M. MCKENZIE ET AL	199.75 AC±	LEASE NO. 987351

C-TM-04-03	MANSFIELD LEESON	123.52 ACRES±
C-TM-04-28	RANDY HUFF DECEDENTS TRUST B ET AL	63 ACRES±
C-TM-04-28.1	JERRY HOSAFLOOK ET AL	119.05 ACRES±
C-TM-04-43	JERRY HOSAFLOOK ET AL	85.31 ACRES±
C-TM-08-01	JERRY HOSAFLOOK ET AL	118 ACRES±
SW-TM-16-06	BETTY RYAN	217 ACRES±
SW-TM-16-8.2	COASTAL FOREST RESOURCES COMPANY d/b/a COASTAL TIMBERLANDS COMPANY	416.61 ACRES±
SW-TM-16-09	MANSFIELD LEESON	189 ACRES±
SW-TM-16-9.1	MANSFIELD LEESON ET AL	1 ACRE±
SW-TM-17-01	RANDY HUFF DECEDENTS TRUST B ET AL	473.4 ACRES±
SW-TM-18-02	MARVIN EDWARDS JR.	94.5 ACRES±
SW-TM-18-05	PAUL M. MCKENZIE (LIFE) ET AL	228.75 ACRES±
SW-TM-18-06	CHARLES ADAMS	109.5 ACRES±

**REFERENCES**

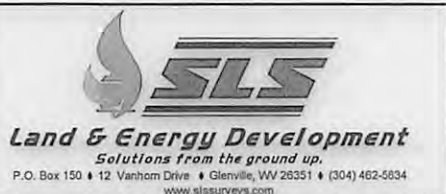
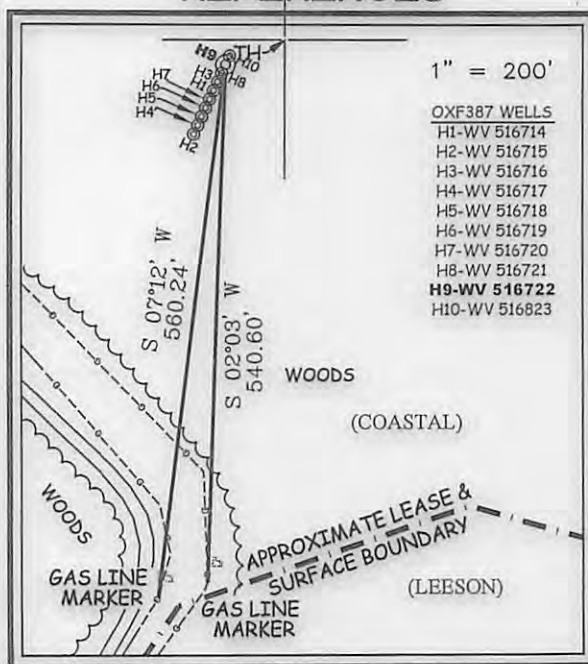

I THE UNDERSIGNED, HEREBY CERTIFY THAT THIS PLAT IS CORRECT TO THE BEST OF MY KNOWLEDGE AND BELIEF AND SHOWS ALL THE INFORMATION REQUIRED BY LAW AND THE REGULATIONS ISSUED AND PRESCRIBED BY THE DIVISION OF ENVIRONMENTAL PROTECTION.

P.S. C. Victor Moyers  
 849



(+) DENOTES LOCATION OF WELL ON UNITED STATES TOPOGRAPHIC MAPS.  
 DATE AUGUST 26, 20 16  
 REVISED \_\_\_\_\_, 20 \_\_\_\_\_  
 OPERATORS WELL NO. WV 516722  
 API WELL NO. 47-017-06785  
 STATE COUNTY PERMIT

MINIMUM DEGREE OF ACCURACY 1 / 2500 FILE NO. 8537P516722.dwg  
 HORIZONTAL & VERTICAL CONTROL DETERMINED BY DGPS (SURVEY GRADE TIE TO CORS NETWORK) SCALE SEE NOTE 2

STATE OF WEST VIRGINIA  
 DIVISION OF ENVIRONMENTAL PROTECTION  
 OFFICE OF OIL AND GAS

WELL TYPE: OIL \_\_\_ GAS X LIQUID INJECTION \_\_\_ WASTE DISPOSAL \_\_\_ IF "GAS" PRODUCTION X STORAGE \_\_\_ DEEP \_\_\_ SHALLOW X  
 LOCATION: (GROUND) (PROPOSED)  
 ELEVATION 1,228' 1,137' WATERSHED LONG RUN OF MIDDLE FORK OF SOUTH FORK HUGHES RIVER  
 DISTRICT SOUTHWEST COUNTY DODDRIDGE QUADRANGLES OXFORD & AUBURN 7.5'  
 SURFACE OWNER COASTAL FOREST RESOURCES COMPANY d/b/a COASTAL TIMBERLANDS COMPANY ACREAGE 416.61±  
 ROYALTY OWNER ADELE McDOUGAL ET AL ACREAGE 2000±  
 PROPOSED WORK: LEASE NO. 109481  
 DRILL X CONVERT \_\_\_ DRILL DEEPER \_\_\_ REDRILL \_\_\_ FRACTURE OR STIMULATE X PLUG OFF OLD FORMATION \_\_\_ PERFORATE NEW FORMATION \_\_\_ PLUG AND ABANDON \_\_\_ CLEAN OUT AND REPLUG \_\_\_ OTHER \_\_\_  
 PHYSICAL CHANGE IN WELL (SPECIFY) \_\_\_\_\_ TARGET FORMATION MARCELLUS  
 ESTIMATED DEPTH 6,629'

WELL OPERATOR EQT PRODUCTION COMPANY DESIGNATED AGENT REX C. RAY  
 ADDRESS 115 PROFESSIONAL PLACE P.O. BOX 280 BRIDGEPORT, WV 26330 ADDRESS 115 PROFESSIONAL PLACE P.O. BOX 280 BRIDGEPORT, WV 26330

COUNTY NAME PERMIT

12/29/2016