

Antero Resources
Well No. Manzarek Unit 1H MOD
Antero Resources Corporation

Well Location References

Scale: 1" = 300' 5/8" Rebar w/ Cap

Az 87° 285' Az 226° 309'

Well No. Manzarek Unit 1H MOD

5/8" Rebar w/ Cap

Yvonne Drill Pad

Warren C. Putman 227/722 147.77 Acres

47-017-3853

D&D Spencer Enterprises Co Lease 22173

Bradford D. Reed, et ux Lease DAD38193

Billy Ray & Dixie Lee Elmore 253/327 126 Acres

Eric K. & Stephanie G. Hardman & Martin F. Tanner 259/128 92.63 Ac.

Robert J. Smith 245/324 112.92 Ac.

S. C. Chippis Hair 7/149 78 Ac.

Yvonne Foster WB 40/419 125.48 Ac.

Freeman Paul Smith et ux, et al Lease

Wayne C. & Edythe B. Ravenscroft 217/412 100.25 Ac.

Johnny B. Hooper 250/59 39 Ac.

Johnny B. Hooper 250/59 39 Ac.

Johnny B. Hooper 250/59 39 Ac.

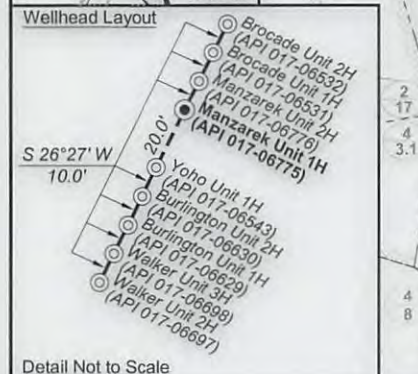

| ID | Mineral Owners |
|----|--|
| A | Ed Broome Inc, Memorandum of Oil & Gas Lease |
| B | Ed Broome Inc, Memorandum of Oil & Gas Lease |
| C | Joseph C. Moffatt, et al Lease |

| ID | TM/Par | Owner | Bk / Pg | Acres |
|----|--------|-----------------------------------|-----------|-------|
| 1 | 2/16 | David & Lucy Mae Sparling | 219/213 | 20.95 |
| 2 | 4/4.2 | David & Lucy Mae Sparling | 219/213 | 10.69 |
| 3 | 4/4 | David & Lucy Mae Sparling | 219/213 | 20.75 |
| 4 | 2/15 | Ronnie D. Smith, et al | 253/696 | 23.07 |
| 5 | 2/14 | Ronnie D. Smith & Thomas G. Smith | 259/232 | 31.00 |
| 6 | 4/11 | Gary Lynn McMillan | 195/237 | 7.19 |
| 7 | 4/3.3 | James A. Smith | 266/94 | 20.00 |
| 8 | 4/19 | Naomi Beagle, et al | AP 19/594 | 33.25 |
| 9 | 4/20 | Stella E. Spencer, et al | 103/53 | 31.50 |
| 10 | 4/4.1 | David & Lucy Mae Sparling | 219/213 | 31.50 |

Legend

- Proposed gas well
- Found corner, as noted
- Existing Well, as noted
- Creek or Drain
- Existing Road
- Surface boundary (approx.)
- Interior surface tracts (approx.)

Notes:

West Virginia Coordinate System of 1927, North Zone based upon Differential GPS Measurements.

Well No. Manzarek Unit 1H MOD Top Hole coordinates are
 N: 311,679.02' Latitude: 39°20'55.60"
 E: 1,640,994.69' Longitude: 80°46'10.23"

Bottom Hole coordinates are
 N: 317,696.78' Latitude: 39°21'54.67"
 E: 1,638,066.88' Longitude: 80°46'48.59"

UTM Zone 17, NAD 1983

Top Hole Coordinates Bottom Hole Coordinates
 N: 4,355,516.651m E: 4,357,335.074m
 E: 519,875.194m E: 518,952.646m

Plat orientation and corner and well references are based upon the grid north meridian. Well location references are based upon the magnetic meridian.

Notes: Well No. Manzarek Unit 1H MOD UTM Zone 17, NAD 1927

Top Hole Coordinates
 N: 14,289,009.26'
 E: 1,705,576.57'

Point of Entry Coordinates
 N: 14,288,619.32'
 E: 1,705,078.76'

Bottom Hole Coordinates
 N: 14,294,975.27'
 E: 1,702,549.83'

| Bearing | Dist. |
|---------------|----------|
| L1 S 36°40' W | 759.7' |
| L2 N 87°30' W | 590.8' |
| L3 N 66°35' W | 2,144.2' |
| L4 N 36°10' W | 2,750.3' |
| L5 S 52°53' W | 632.6' |

(⊙) Denotes Location of Well on United States Topographic Maps



I, the undersigned, hereby certify that this plat is correct to the best of my knowledge and belief and shows all the information required by law and the rules issued and prescribed by the Department of Environmental Protection.

Bradley D. Miller

Bradley D. Miller, P.S. 2167

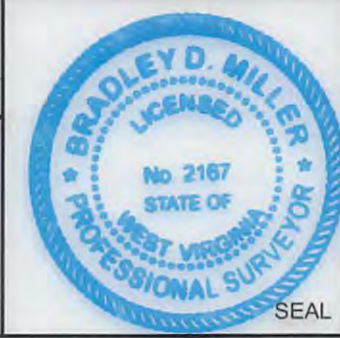

FILE NO: 264-30(54)-M(G)-14

DRAWING NO: Manzarek 1H POE-MOD Well Plat

SCALE: 1" = 1500'

MINIMUM DEGREE OF ACCURACY: Submeter

PROVEN SOURCE OF ELEVATION: WVDOT, Harrisville, WV

STATE OF WEST VIRGINIA
 DEPARTMENT OF ENVIRONMENTAL PROTECTION
OIL AND GAS DIVISION

DATE: May 24 20 18

OPERATOR'S WELL NO. Manzarek Unit 1H

API WELL NO. 47 - 017 - 06775 MOD

STATE COUNTY PERMIT

WELL TYPE: OIL GAS LIQUID INJECTION WASTE DISPOSAL

(IF GAS) PRODUCTION: STORAGE DEEP SHALLOW

LOCATION: ELEVATION: 1229' WATERSHED: Headwaters Middle Island Creek QUADRANGLE: West Union

DISTRICT: West Union COUNTY: Doddridge 06/29/2018

SURFACE OWNER: Yvonne Foster ACREAGE: 125.48

ROYALTY OWNER: Freeman Paul Smith, et ux, et al; Joseph C. Moffatt, et al; Vurl Vore, et ux; LEASE NO: 22173 ACREAGE: 20.75; 125; 283;

PROPOSED WORK: DRILL CONVERT DRILL DEEPER FRACTURE OR STIMULATE PLUG OFF OLD FORMATION

PERFORATE NEW FORMATION OTHER PHYSICAL CHANGE IN WELL (SPECIFY) POE-MOD

PLUG AND ABANDON CLEAN OUT AND REPLUG TARGET FORMATION: Marcellus Shale ESTIMATED DEPTH: 14,020' MD

WELL OPERATOR: Antero Resources Corporation DESIGNATED AGENT: Dianna Stamper - CT Corporation System

ADDRESS: 1615 Wynkoop Street ADDRESS: 5400 D Big Tyler Road

Denver, CO 80202 Charleston, WV 25313