



Antero Resources
Well No. Manzarek Unit 1H
Antero Resources Corporation

Well Location References

Scale: 1" = 300' 5/8" Rebar w/ Cap

Wellhead Layout

S 26°27' W 10.0'

20.0'

Proposed Manzarek Unit 1H (47-017-6775)

Yoho Unit 1H (47-017-6543)

Burlington Unit 2H (47-017-6630)

Burlington Unit 1H (47-017-6629)

Walker Unit 3H (47-017-6698)

Walker Unit 2H (47-017-6697)

Walker Unit 1H (47-017-6696)

Detail Not to Scale

Notes:

West Virginia Coordinate System of 1927, North Zone based upon Differential GPS Measurements.

Well No. Manzarek Unit 1H Top Hole coordinates are
 N: 311,679.52' Latitude: 39°20'55.61"
 E: 1,640,995.27' Longitude: 80°46'10.23"

Bottom Hole coordinates are
 N: 317,479.07' Latitude: 39°21'52.52"
 E: 1,638,115.38' Longitude: 80°46'47.93"

UTM Zone 17, NAD 1983

Top Hole Coordinates Bottom Hole Coordinates
 N: 4,355,516.806m N: 4,357,268.995m
 E: 519,875.368m E: 518,968.528m

Plat orientation and corner and well references are based upon the grid north meridian.

Well location references are based upon the magnetic meridian.

ID	TM/Par	Owner	Bk / Pg	Acres
1	2/16	David & Lucy Mae Sparling	219/213	20.95
2	4/4.2	David & Lucy Mae Sparling	219/213	10.69
3	4/4	David & Lucy Mae Sparling	219/213	20.75
4	2/15	Ronnie D. Smith, et al	253/696	23.07
5	2/14	Ronnie D. Smith & Thomas G. Smith	259/232	31.00
6	4/11	Gary Lynn McMillan	195/237	7.19
7	4/3.3	James A. Smith	266/94	20.00
8	4/19	Naomi Beagle, et al	AP 19/594	33.25
9	4/20	Stella E. Spencer, et al	103/53	31.50
10	4/4.1	David & Lucy Mae Sparling	219/213	31.50

Legend

- Proposed gas well
- Found corner, as noted
- Existing Well, as noted
- Creek or Drain
- Existing Road
- Surface boundary (approx.)
- Interior surface tracts (approx.)

Notes:

Well No. Manzarek Unit 1H UTM Zone 17, NAD 1927

Top Hole Coordinates
 N: 14,289,009.77'
 E: 1,705,577.14'

Point of Entry Coordinates
 N: 14,288,727.24'
 E: 1,705,037.01'

Bottom Hole Coordinates
 N: 14,294,758.47'
 E: 1,702,601.93'

Bearing	Dist.
L1 S 63°20' W	609.4'
L2 S 36°41' E	759.6'
L3 N 87°28' W	590.6'
L4 N 66°35' W	2,144.2'
L5 N 36°10' W	2,750.5'

(---) Denotes Location of Well on United States Topographic Maps

Allegany Surveys, Inc.

STATE OF WEST VIRGINIA
 DEPARTMENT OF ENVIRONMENTAL PROTECTION
OIL AND GAS DIVISION

BRADLEY D. MILLER
 LICENSED PROFESSIONAL SURVEYOR
 No. 2167
 STATE OF WEST VIRGINIA

FILE NO: 264-30(54)-M(G)-14
 DRAWING NO: Manzarek 1H Well Plat_09-22-16
 SCALE: 1" = 1500'
 MINIMUM DEGREE OF ACCURACY: Submeter
 PROVEN SOURCE OF ELEVATION: WVDOT, Harrisville, WV

DATE: September 22 20 16
 OPERATOR'S WELL NO. Manzarek Unit 1H
 API WELL NO
 47 - 017 - 6775
 STATE COUNTY PERMIT

WELL TYPE: OIL GAS LIQUID INJECTION WASTE DISPOSAL
 (IF GAS) PRODUCTION: STORAGE DEEP SHALLOW
 Proposed Grade-1227'
 LOCATION: ELEVATION: Original Grade-1253' WATERSHED: Headwaters Middle Island Creek QUADRANGLE: West Union
 DISTRICT: West Union COUNTY: Doddridge

SURFACE OWNER: Yvonne Foster Patrick A. Costlow, et ux, et al; D&D Spencer Enterprises Co ACREAGE: 125.48 78,973; 73; 23
 Ed Broome Inc, Memorandum of Oil & Gas Lease
 ROYALTY OWNER: Freeman Paul Smith, et ux, et al; Joseph C. Moffatt, et al; Diana Lynne Knight LEASE NO: 22173 ACREAGE: 20.75; 125; 283
 PROPOSED WORK: DRILL CONVERT DRILL DEEPER FRACTURE OR STIMULATE PLUG OFF OLD FORMATION
 PERFORATE NEW FORMATION OTHER PHYSICAL CHANGE IN WELL (SPECIFY) SHL-MOD 7,400' TVD
 PLUG AND ABANDON CLEAN OUT AND REPLUG TARGET FORMATION: Marcellus Shale ESTIMATED DEPTH: 15,300' MD

WELL OPERATOR: Antero Resources Corporation DESIGNATED AGENT: Dianna Stamper - CT Corporation System
 ADDRESS: 1615 Wynkoop Street ADDRESS: 5400 D Big Tyler Road
 Denver, CO 80202 Charleston, WV 25313

I, the undersigned, hereby certify that this plat is correct to the best of my knowledge and belief and shows all the information required by law and the rules issued and prescribed by the Department of Environmental Protection.

Bradley D. Miller
 Bradley D. Miller, P.S. 2167

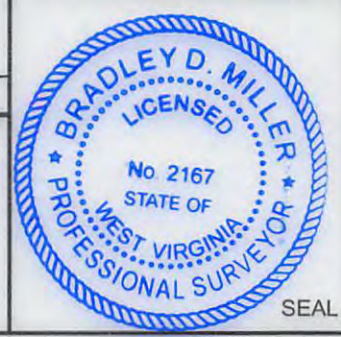

09/23/2016