

LATITUDE 39°15'00"

11,359'

LATITUDE 39°17'30"

LONGITUDE 80°52'30"

LONGITUDE 80°50'00"

Antero Resources Corporation Well No. King Unit 2H A.P.I. #47-017-06749

- NOTE**
1. NO OCCUPIED DWELLINGS OR BUILDINGS TWO THOUSAND FIVE HUNDRED (2,500) SQUARE FEET OR LARGER USED TO HOUSE OR SHELTER DAIRY CATTLE OR EQUINE LIVESTOCK ARE LOCATED WITHIN SIX HUNDRED TWENTY-FIVE (625) FEET OF THE CENTER OF THE WELL PAD.
 2. TOP HOLE DATA SHOWN HEREON WAS PROVIDED BY ALLEGHENY SURVEYS, INC.
 3. AS DRILLED DATA WAS PROVIDED BY ANTERO RESOURCES CORPORATION.
 4. WLS IS NOT CERTIFYING THE DATA AND INFORMATION PROVIDED LISTED IN NOTES 2 AND 3, ONLY THE RELATIONSHIP TO THE DATA AND INFORMATION PROVIDED TO THE LEASE BOUNDARIES.
 5. WLS IS BY NO MEANS RESPONSIBLE FOR ANY ERRORS OR INACCURACIES WITH THE DATA AND INFORMATION THAT HAS BEEN PROVIDED.

LINE	BEARING	DISTANCE
L1	N 72°15' E	1424.3'
L2	N 88°07' E	1508.6'
L3	S 38°12' E	1107.9'
L4	S 17°19' E	1023.9'
L5	S 01°48' W	1039.8'
L6	S 13°28' W	1388.1'
L7	S 14°41' W	1309.9'
L8	S 18°45' W	1081.0'
L9	S 19°07' W	1434.9'
L10	S 24°11' W	1332.7'
L11	S 28°13' W	1000.5'
L12	S 28°18' W	1517.4'
L13	S 32°47' W	1748.1'
L14	S 32°53' W	1605.3'
L15	S 35°35' W	1789.2'
L16	S 38°23' W	1644.9'
L17	S 42°08' W	1009.8'

AS DRILLED DATA:
WELL 2H TOP HOLE INFORMATION:
 N: 271,965ft E: 1,610,994ft
 LAT: 39°14'18.74" LON: 80°52'24.36"
BOTTOM HOLE INFORMATION:
 N: 281,773ft E: 1,605,912ft
 LAT: 39°15'54.91" LON: 80°53'30.88"
 WEST VIRGINIA COORDINATE SYSTEM OF 1927 NORTH ZONE. ZONE WAS DERIVED FROM MEASUREMENTS TAKEN WITH TRIMBLE GEOXT SUBMETER MAPPING GRADE GPS UNIT. PLAT ORIENTATION, CORNER, AND WELL REFERENCE TIE LINES ARE BASED ON GRID NORTH.

(NAD) 83 (UTM) ZONE 17 COORDS:
WELL 2H TOP HOLE INFORMATION:
 N: 4,343,265m E: 510,937m
BOTTOM HOLE INFORMATION:
 N: 4,346,227m E: 509,339m

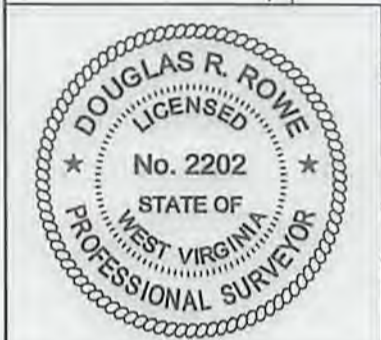
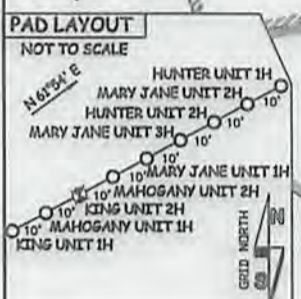

API WELL # 47 - 017 - 06749
 STATE COUNTY PERMIT

I THE UNDERSIGNED, HEREBY CERTIFY THAT THIS PLAT IS CORRECT TO THE BEST OF MY KNOWLEDGE AND BELIEF AND SHOWS ALL THE INFORMATION REQUIRED BY LAW AND THE RULES ISSUED AND PERSCRIBED BY THE DEPARTMENT OF ENVIRONMENTAL PROTECTION.

STATE OF WEST VIRGINIA, DIVISION OF ENVIRONMENTAL PROTECTION, OFFICE OF OIL AND GAS
 WILLOW LAND SURVEYING PLLC
 220 MASONIC AVE. PENNSBORO WEST VIRGINIA 26415

JOB # 14-104WA
 DRAWING # KING2HAD
 SCALE 1" = 1000'
 MINIMUM DEGREE OF ACCURACY SUBMETER
 PROVEN SOURCE OF ELEV. SUBMETER MAPPING GRADE GPS
 STATE OF WEST VIRGINIA DEPARTMENT OF ENERGY DIVISION OF OIL AND GAS

LEGEND
 - - - Surface Owner Boundary Lines +/-
 - - - Interior Surface Tracts +/-
 - - - Proposed Well Path
 - - - As Drilled Well Path

DOUGLAS R. ROWE P.S. 2202
 DATE 11/07/17
 OPERATOR'S WELL# KING UNIT #2H

WELL TYPE: OIL GAS LIQUID INJECTION WASTE DISPOSAL
 (IF "GAS") PRODUCTION STORAGE DEEP SHALLOW
 LOCATION: ELEVATION 991.4' WATERSHED NORTH FORK HUGHES RIVER
 QUADRANGLE OXFORD 7.5 (TOP HOLE) PENNSBORO 7.5 (BOTTOM HOLE) DISTRICT CENTRAL COUNTY DODDRIDGE
 SURFACE OWNER JAMES E. WEBB ACREAGE 84.89 ACRES +/-
 OIL & GAS ROYALTY OWNER CHARLEY WILSON ET UX; RALPH LEGGETT ET UX; H.B. WILLIAMS ET UX; L.L. MORRIS; LEASE ACREAGE 91 ACRES +/-; 75 ACRES +/-; 307 ACRES +/-; 40.9 ACRES +/-
 DONNA HELMICK ET AL; GERALDINE WILLARD; ETTA ORDER ET VIR; V. OLIVE ELLIFRIT 67.25 ACRES +/-; 131.5 ACRES +/-; 201 ACRES +/-; 130 ACRES +/-
 PROPOSED WORK: DRILL CONVERT DRILL DEEPER REDRILL FRACTURE OR STIMULATE
 PLUG OFF OLD FORMATION PERFORATE NEW FORMATION OTHER PHYSICAL CHANGE IN WELL
 (SPECIFY) AS DRILLED PLUG & ABANDON CLEAN OUT & REPLUG
 TARGET FORMATION MARCELLUS ESTIMATED DEPTH 6,380' TVD 17,351' MD
 WELL OPERATOR ANTERO RESOURCES CORP. DESIGNATED AGENT DIANNA STAMPER
 ADDRESS 1615 WYNKOOP STREET ADDRESS CT CORPORATION SYSTEM
 FORM WW-6 DENVER, CO 80202 ADDRESS 5400 D BIG TYLER ROAD CHARLESTON, WV 25313

01/05/2018

COUNTY NAME PERMIT